

Benchmarks

BM #4: COW BM North R/W of K-96 and West R/W of North Hoover Road, 6.9' ESE of PP, and 42.5' west of center line.
Elev. = 1333.14 MSL (145.74 City Datum)

BM #5: Hoover and 37th St. N - COW Benchmark at SW corner of Intersection, 16.40' W of PP, 7.40' n of PP, 3.00' N of 4' high chain link fence, 15.20' WNW of chain link fence corner, 48.50' SW of Section corner Iron, 17.20' S of Centerline, 48.00' W of Centerline.
Elev. = 1333.68

Reseed 758 L.F. According to General Note 13 as Measured Along the Water Line from Sta. 17+60 to Sta. 25+18.

PK-213
Leslie A. Eck Revocable Trust
3955 N. Hoover

B.L. 3 Sta. 225+08.29,
18.13' Rt.
Cont. Point # 6

W.L. Sta. 24+59.46, Line 2 =
B.L. 3 Sta. 224+99.59, 36.00' Rt.
L = 14.00'
Install 1-Fire Hydrant Assy. (W)
Valve Box Elev. = 1333.18
Bury Line Elev. = 1333.38

Remove and Reset Ex. Drive and 15" RCP as Necessary for Construction.

B.L. 3 Sta. 226+21.30,
Cont. Point # 4
(1-COR)

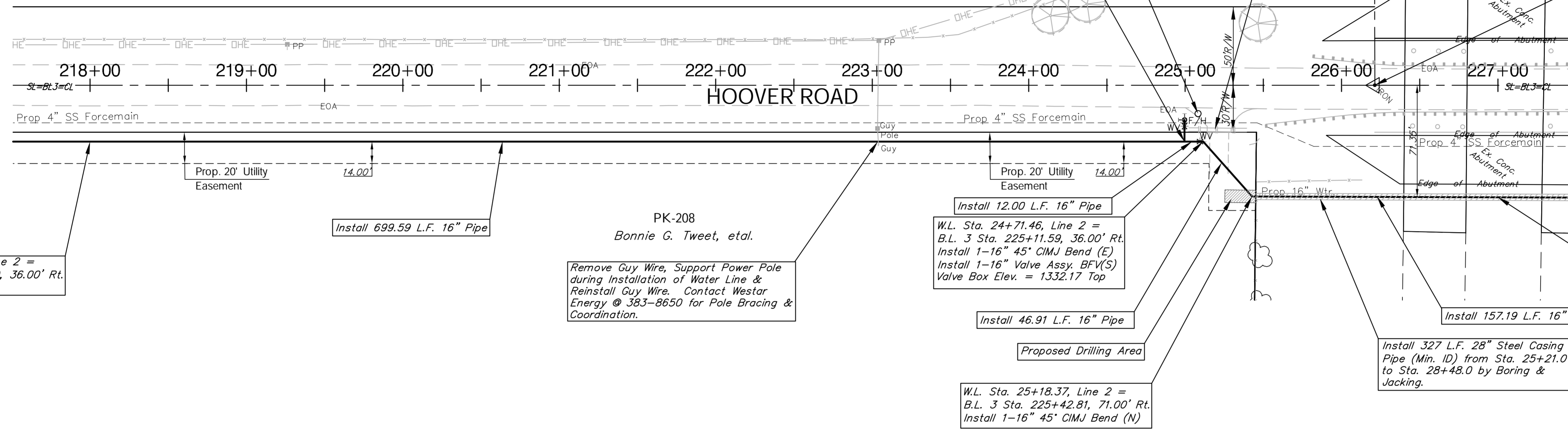
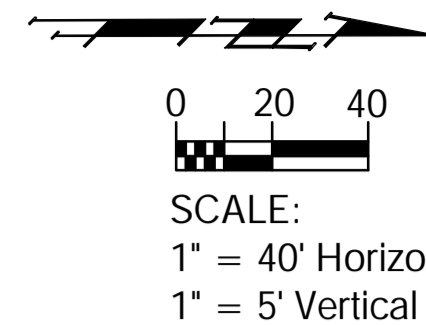

W.L. Sta. 17+59.87 Line 2 =
B.L. 3 Sta. 218+00.00, 36.00' Rt.
Match Point

Prop. 20' Utility Easement

Install 699.59 L.F. 16" Pipe

PK-208
Bonnie G. Tweet, et al.

Remove Guy Wire, Support Power Pole during Installation of Water Line & Reinstall Guy Wire. Contact Westar Energy @ 383-8650 for Pole Bracing & Coordination.

Install 12.00 L.F. 16" Pipe
W.L. Sta. 24+71.46, Line 2 =
B.L. 3 Sta. 225+11.59, 36.00' Rt.
Install 1-16" 45° CIMJ Bend (E)
Install 1-16" Valve Assy. BFV(S)
Valve Box Elev. = 1332.17 Top

Install 46.91 L.F. 16" Pipe

Proposed Drilling Area

W.L. Sta. 25+18.37, Line 2 =
B.L. 3 Sta. 225+42.81, 71.00' Rt.
Install 1-16" 45° CIMJ Bend (N)

Install 157.19 L.F. 16" Pipe

Install 327 L.F. 28" Steel Casing Pipe (Min. ID) from Sta. 25+21.0 to Sta. 28+48.0 by Boring & Jacking.

W.L. Sta. 26+75.56 Line 2 =
B.L. 3 Sta. 227+00.00, 71.49' Rt.
Match Point

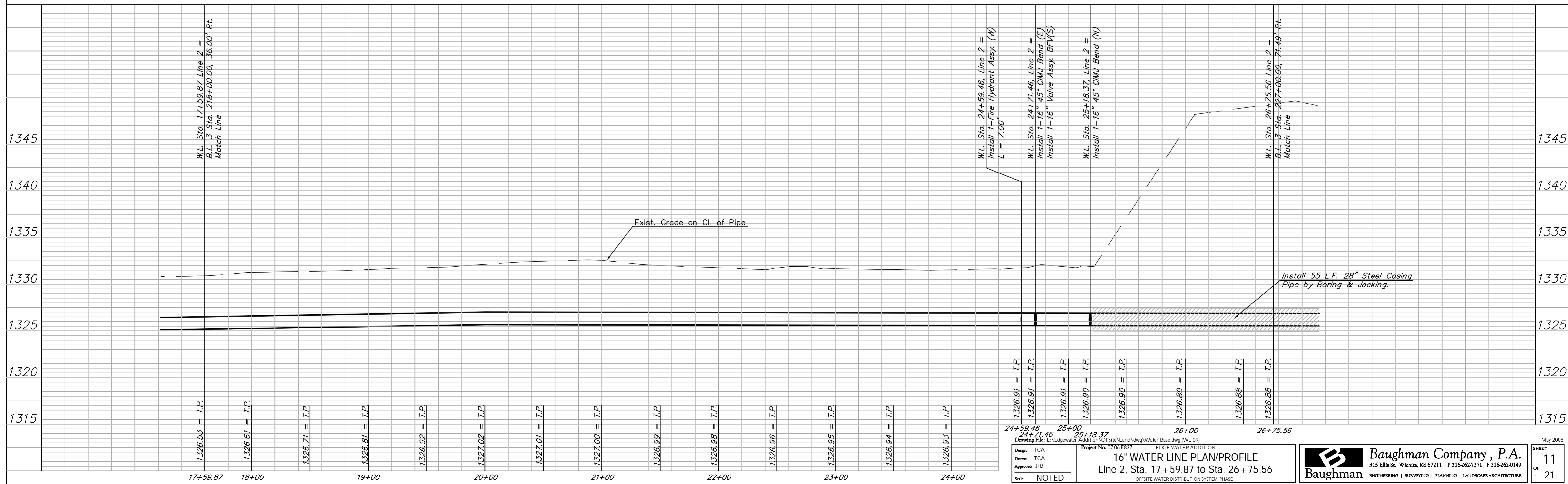

16" WATER LINE PLAN/PROFILE
Line 2, Sta. 17+59.87 to Sta. 26+75.56

Project No. 0706-EB37

Design: TCA
Drawn: TCA
Approved: JFB
Scale: NOTED

EDGE WATER ADDITION

16" WATER LINE PLAN/PROFILE
Line 2, Sta. 17+59.87 to Sta. 26+75.56

OFFSITE WATER DISTRIBUTION SYSTEM, PHASE 1

May 2008

11 OF 21

Baughman **Baughman Company, P.A.**
315 Ellis St. Wichita, KS 67211 P 316-262-7171 F 316-262-0149
ENGINEERING | SURVEYING | PLANNING | LANDSCAPE ARCHITECTURE