

GENERAL NOTES:

1. Contractor will be required to provide notice to utility companies a minimum of twenty-four (24) hours prior to any excavation, as follows:

Kansas One-Call (316)687-2470

The Contractor must notify the following in case of an emergency:

Cox Communications (316)262-4270 or (316)263-2061

Westar Energy/ Kansas Gas & Electric Company (800)482-4950 AT&T 1-555-1212

City of Wichita Water Department (316)268-4908

City of Wichita Sewer Department (316)268-4071

Aquila Natural Gas (316)941-1608 or (800)303-0357

2. Exist. utilities and their locations, as shown on the plans, represent the best information attainable for design. Location information has been obtained from the various utility companies and is either from company record drawings or company-provided field locations. The Contractor will be required to work around existing utilities which do not conflict with proposed constructions.

3. The Contractor to verify utility locations prior to construction of this project.

4. Utility service and installation shall be coordinated with the respective utility owner. Contacts are:

Kansas Gas Service Jim Coe (316)832-3126
 Westar Energy Miles Capps (316)261-6251
 Aquila Networks Calvin Briggs (316)942-8811
 Wichita Water & Sewer Kerry Gibson (316)268-4555
 AT&T Jim Toben (316)268-2759
 Cox Communications Mark Anaya (316)262-4270

5. All lawn/turf areas disturbed by construction of proposed improvements shall be restored with the same grass as existing. Restoration of disturbed areas shall include, but not limited to, top soil preparation, fertilizing, seeding, mulching (all seeded areas, outside the limits of erosion mat placement), and/or reseeding, and installation of erosion control mat. All seeding work shall be in accordance with the City of Wichita Standard Specifications and the City of Wichita Administrative Regulations No. AR 6.5 which governs cleanup and respiration or replacement following construction. All cost for the soil preparation, seeding and mulching (all seeded areas, outside the limits of erosion mat placement) shall be paid for through the lump sum bid item for "Seeding." All seeded areas within eight feet of the back of new curb shall be covered with an approved erosion mat, which shall be paid for by the measured quantity bed item "Back of Curb Protection (8' wide)."

6. Traffic affected by the construction of this project shall be handled in accordance with the latest edition of the Manual on Uniform Traffic Control Devices.

7. It is the contractor's responsibility to visit this site to better understand the extent of site clearing and restoration to be performed. Site Clearing and Restoration shall include all costs for removal of items which a pay item is not provided.

8. The contractor shall be responsible for preserving property irons. The contractor will be required to re-establish any property irons which are damaged or destroyed by the construction operations. Such irons shall be re-established by a licensed land surveyor in accordance with state laws.

9. Properties within the project limits may have underground sprinkler systems in public right-of-way which conflict with new construction. Contractor will be required to remove such improvements should they not be removed by their owner at the time of construction of the project. The contractor will be required to salvage all sprinkler heads and/or valves and give such material to owner. Portions of underground sprinkler systems not in conflict with new construction shall be protected from damage and shall remain in place. All work in connection with underground sprinkler systems shall be considered as subsidiary to the contract pay items for work.

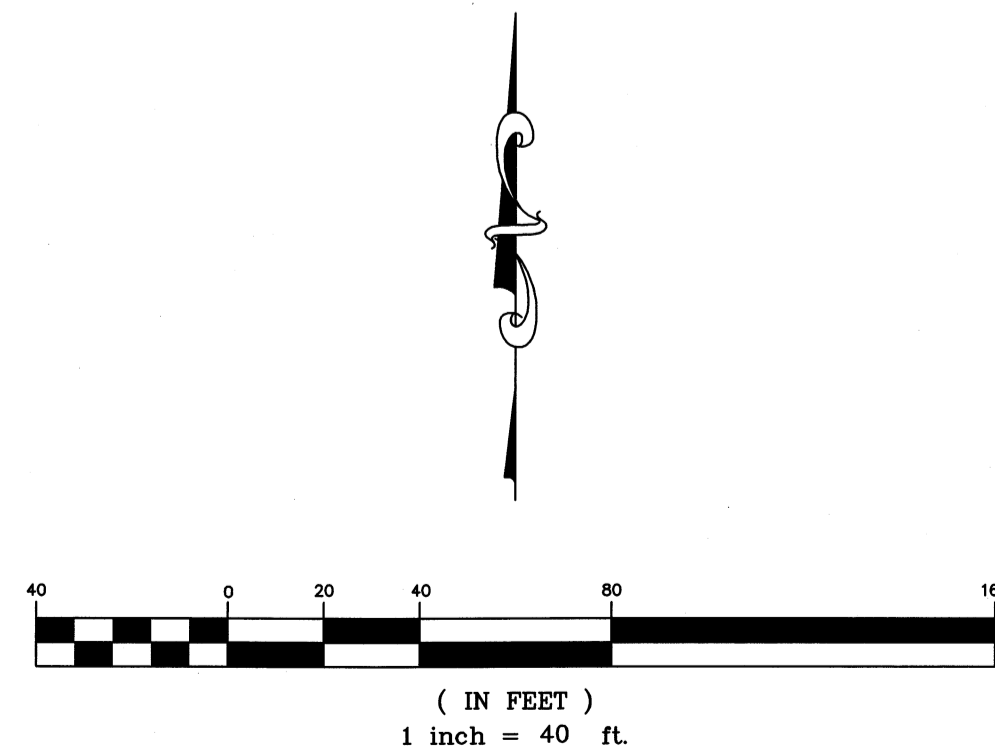
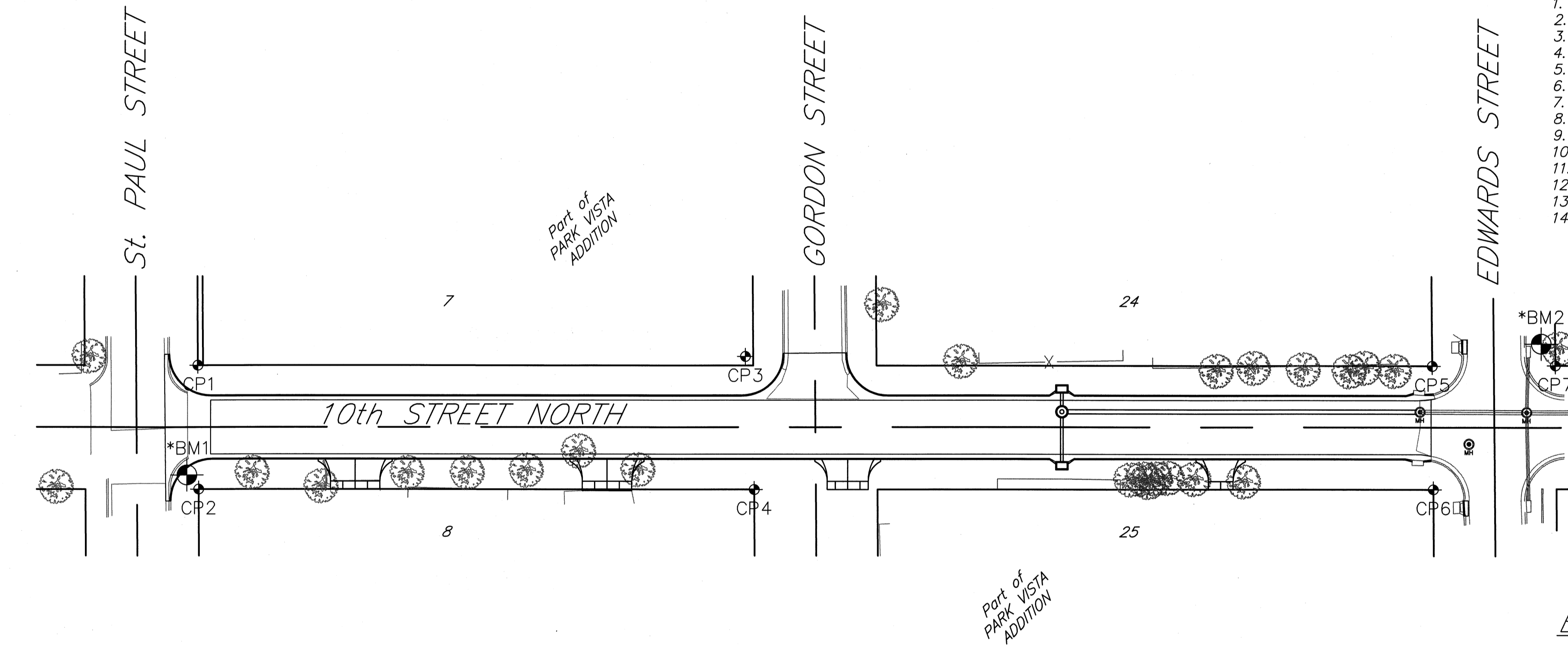

STREET IMPROVEMENTS TO SERVE 10th Street North Project Number 472-84454 OCA No : 766117 CITY OF WICHITA, KANSAS Jim Armour, P.E., City Engineer

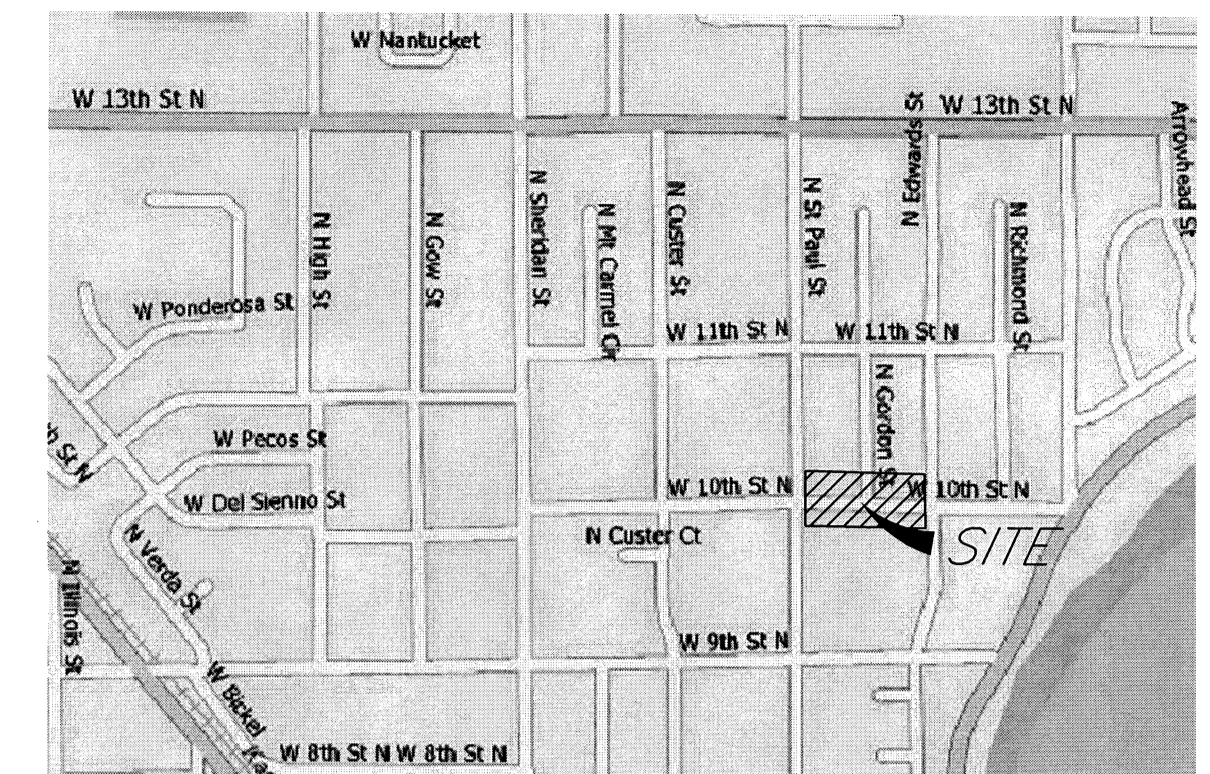

LOCATION MAP

INDEX OF SHEETS:

1. Cover Sheet
2. Pavement Details
3. Paving Plan Sta. 00+00 - 04+00
4. Paving Plan Sta. 04+00 - 16+30
5. Driveway Details
6. Valley Gutter Details
7. Storm Water Sewer Plan
8. Inlet Details
9. Manhole Details
10. Erosion Plan
11. Street Erosion Details
12. Back of Curb Details
13. Inlet Protector Details
14. Cross Sections

BASELINE:

Sta. 10+00.00 starting at Intersection of 10th Street North and St. Paul Street. Following 10th Street North Eastward to Intersection with Edwards Street.

BENCHMARK: COW

Sheridan and 9th St. North SE Corner of Intersection

Elev. = 1308.10



CONTROL POINTS				
NAME	ELEVATION	BL STATION	OFFSET	DESCRIPTION
*BM1	1310.39	10+24.50	23.05 R	"M" in Mueller on FH
*BM2	1305.70	16+82.97	40.48 L	"M" in Mueller on FH
CP1	1307.17	10+29.79	29.95 L	Top of Pipe
CP2	1308.38	10+30.21	29.95 R	Top of Pipe
CP3	1303.24	12+96.04	34.16 L	Top of Pipe
CP4	1302.62	13+00.33	30.13 R	Top of Pipe
CP5	1302.44	16+29.97	29.64 L	Top of Pipe
CP6	1301.79	16+30.49	30.01 R	Top of Pipe
CP7	1302.78	16+89.83	30.01 L	Top of Pipe

* DENOTES THAT BENCHMARK IS TEMPORARY

January 2008



516 S. Market,
 Wichita, KS 67202

316/264-0242