

SUBMAIN 16, W. I. S.
 CITY OF WICHITA, KANSAS
 B. E. SMITH, CITY ENGINEER
 PROJECT NO. C26-52
 DATE: AUG. 1966

Survey by Henry G. Schaefer
 Checked by D. Chalmers



1/2

SYPHON PLAN
 STA. 1190 TO STA. 2190
 SCALE 1"=4'

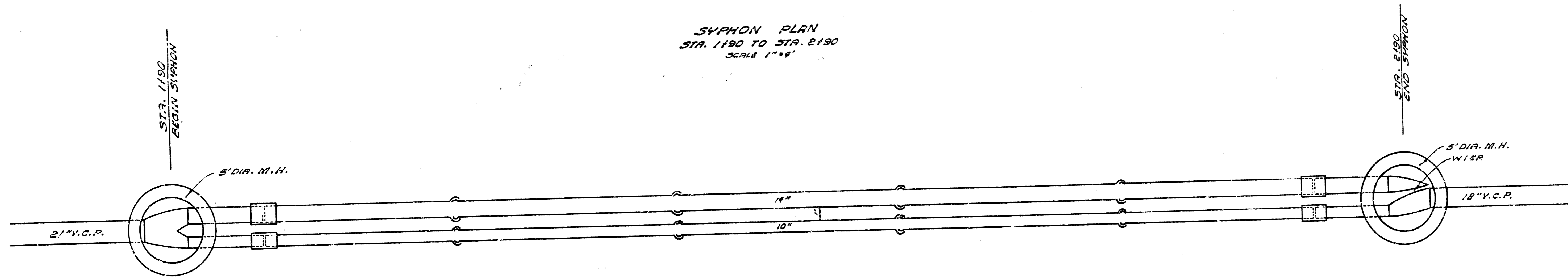

SYPHON PROFILE
 STA. 1190 TO STA. 2190
 SCALE 1"=4' HOR.
 1"=8' VERT.

- 2-10" DOUBLE X SLEEVES
- 2-14" DOUBLE X SLEEVES
- 2-10" X 18" R.E.-R.E. C.I.P.
- 2-14" X 18" R.E.-R.E. C.I.P.
- 1-10" X 18" BELL - R.E. FLEXIBLE JOINT C.I.P. MOLDX OR USIFLEX
- 1-14" X 18" BELL - R.E. " " " " " "
- 1-10" X 18" R.E. - BELL " " " " " "
- 1-14" X 18" R.E. - BELL " " " " " "
- 3-10" X 18" R.E. - BELL " " " " " "
- 3-14" X 18" BELL & BELL " " " " " "

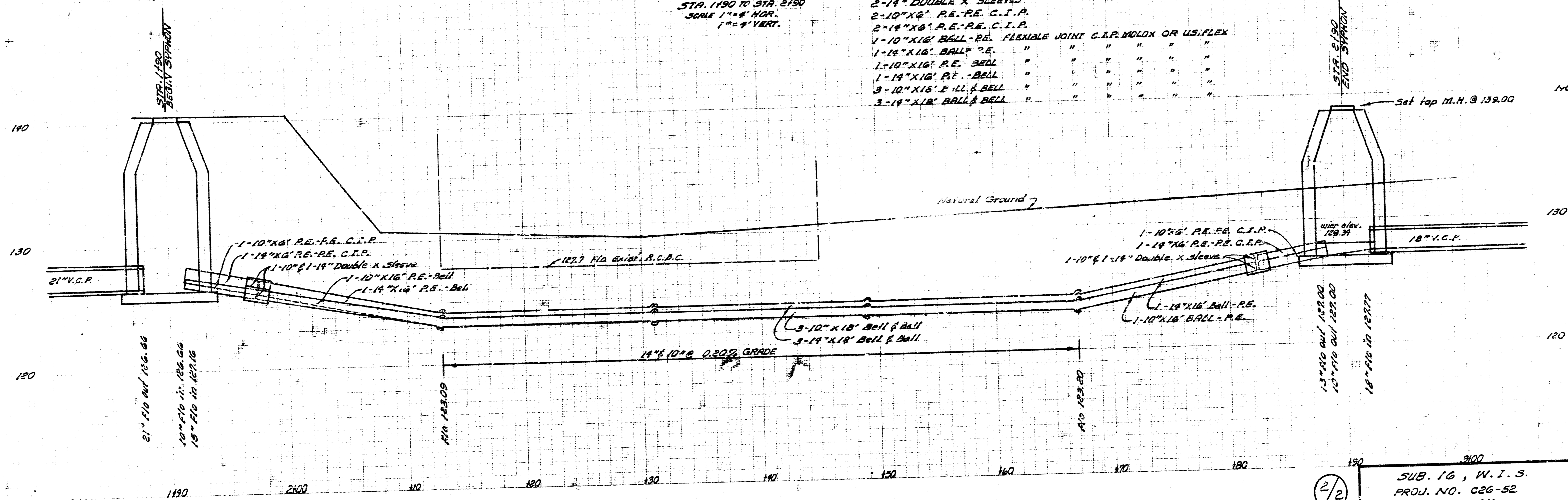

2/2

SUB. 16, W. I. S.
 PROJ. NO. C26-52
 SYPHON DETAIL