

B.M. 140.72 R.R. Spike W. face of life pole E. side Byron Rd. Ref. No. #170 & 156 N. Byron Rd.
 B.M. 144.195 R.R. spike S. face P. Pole N. side Douglas 1/2 Blk. W. of Tyler Rd.

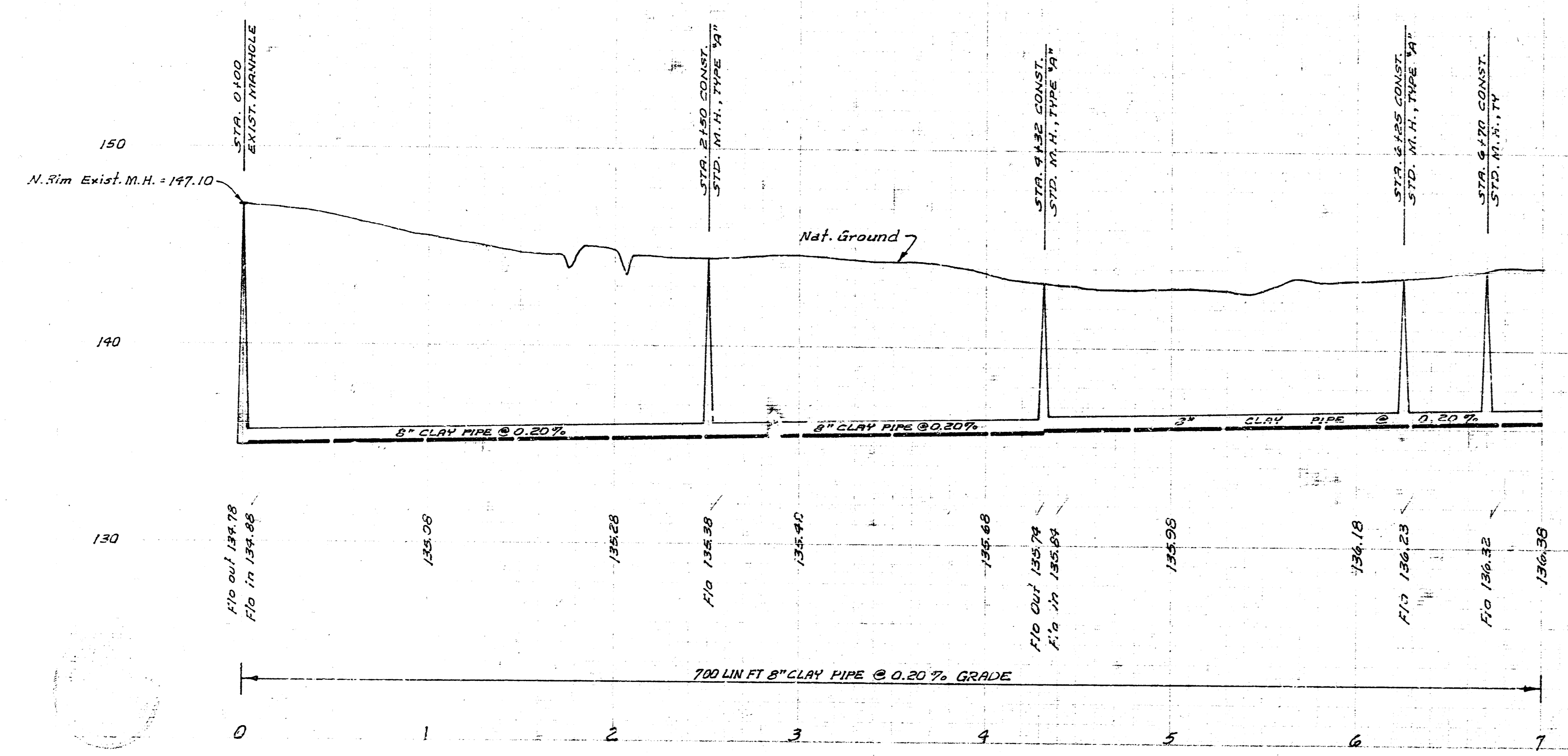

NOTE:
 Contractor to replace all fences
 Cost of fence relocation of 4" steel irrigation pipeline to be incidental to the project.
 Cost of grass vine removal to be incidental to the project.

Plan Scale 1"=40'
 Profile Scale 1"=4' Vert.



LAT. 13, SUB. 1, WESTLINK SEWER
 CITY OF WICHITA, KANSAS
 B.E. SMITH, CITY ENGINEER
 PROJ. NO. PBK1570021
 DATE: DEC. 1971

1/2

