

B.M. 150.39 Stop Spike N. face P.P. 25 ft. N. and 44.5 ft. W. of center of Sec 21, T27S, R1W.

B.M. 151.58 R.R. spike N. face H.L.P. 25 ft. N. and 176 ft. E. of center of Sec. 21, T27S, R1W. (2nd and Woodchuck)

Scale Plan 1"=40'
Profile 1"=40' Horiz.
1"=5' Vert.

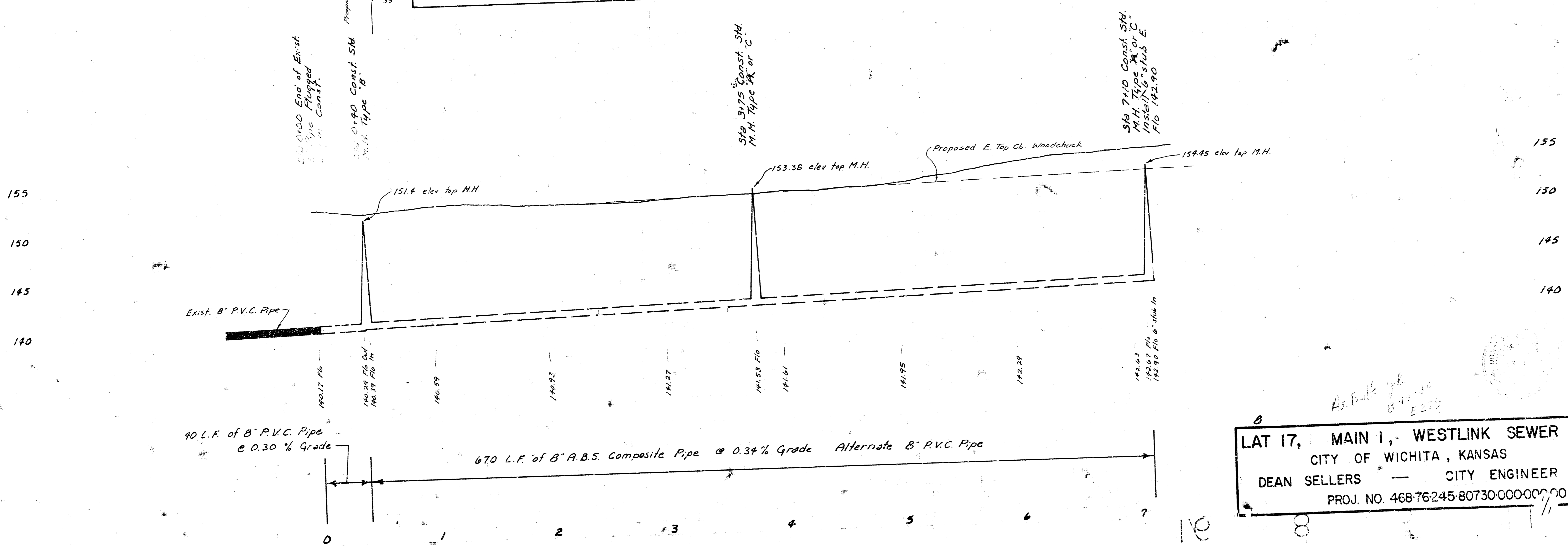
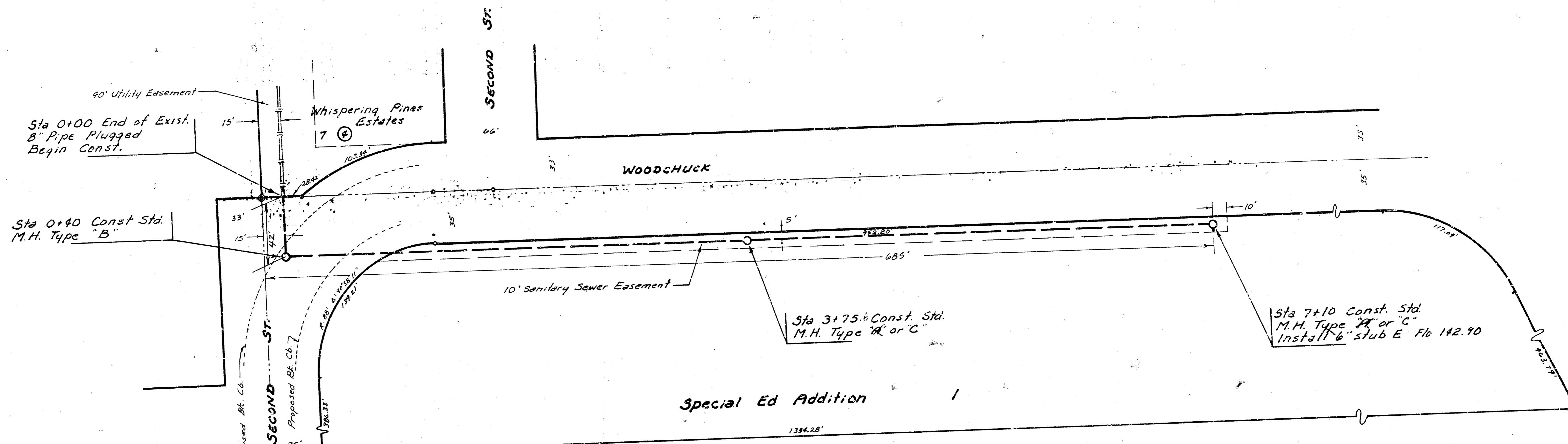

40 L.F. of 8" P.V.C. Pipe @ 0.30% Grade

670 L.F. of 8" A.B.S. Composite Pipe @ 0.34% Grade Alternate 8" P.V.C. Pipe

LAT 17, MAIN 1, WESTLINK SEWER
CITY OF WICHITA, KANSAS
DEAN SELLERS — CITY ENGINEER
PROJ. NO. 46876245-80730-00000001