

B.M. 120.16 R.R. Spike N.S. P.P. at N.E. corner Julia and Garst.

B.M. 118.35 #60 Spike in washer S.E. Ace P.P. of S.E. corner Lot 6, Blk. A, Garst Gardens.

Garst Street

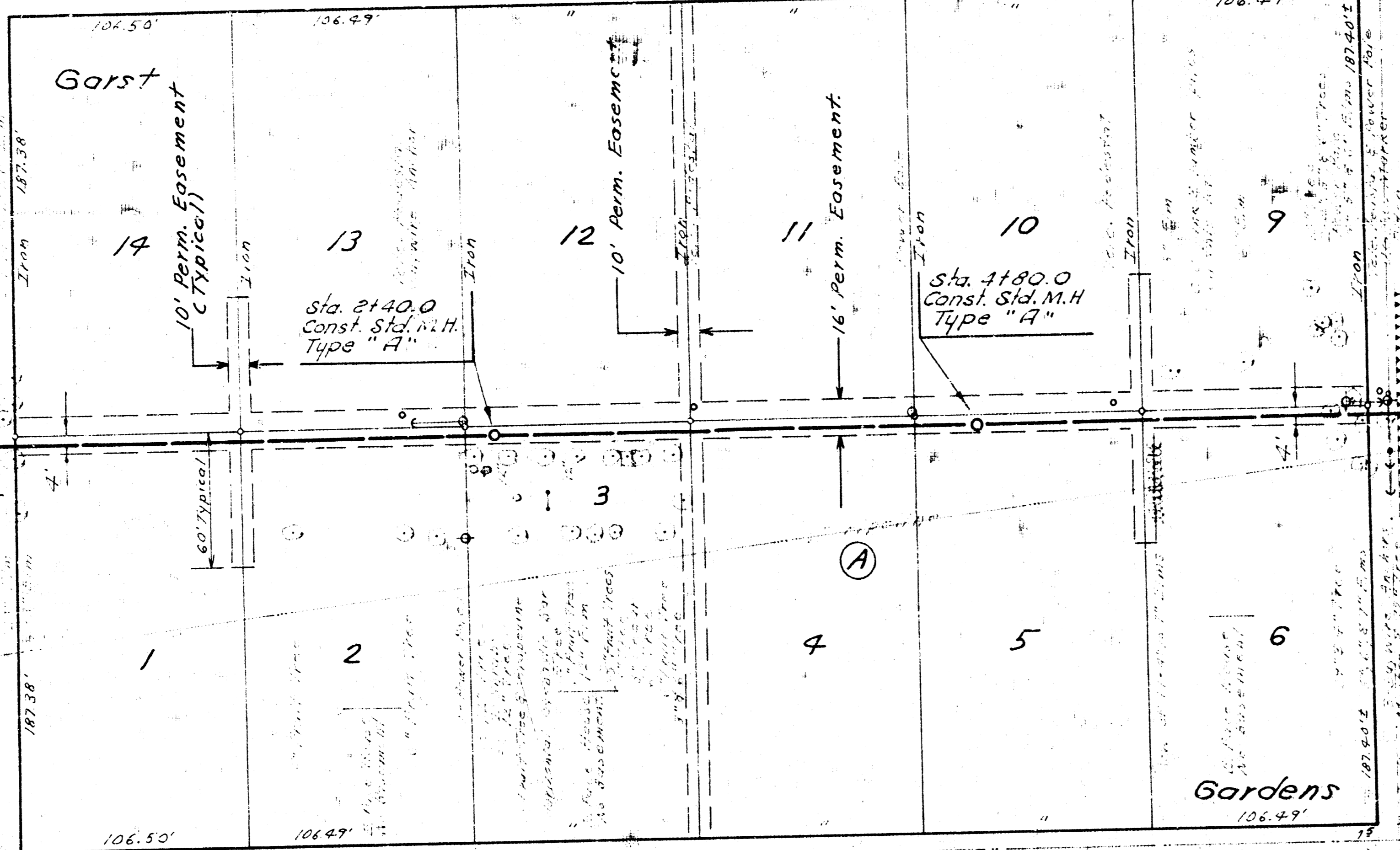

NOTE:
CONTRACTOR TO CO-ORDINATE
THIS PROJECT WITH CONTRACTOR
ON TRUNK & S.W. INTERCEPTOR

LAT. 30, S.W. INTERCEPTOR SEWER
CITY OF WICHITA, KANSAS
R. W. LINN - CITY ENGINEER
197 PROJECT NO. DBKL 5 69057