

B.M. 10165 R.R. Spike N. face light pole. S. Side 31st St. 100' W. of 4th WEST STREET.
 B.M. 10402 #40 Spike E. face 4th H.L.P. North of 31st St. W. Side WEST ST. 856' W. 31st
 B.M. 10414 #40 Spike W. face Telephone pole. E. Side WEST ST. 10' N. S.W. Cor. WESTERN CONTROL 3RD ADD.
 B.M. 10452 #40 Spike E. face H.L.P. W. Side WEST ST. 30' S. S.W. Cor. WESTERN CONTROL 3RD ADD.

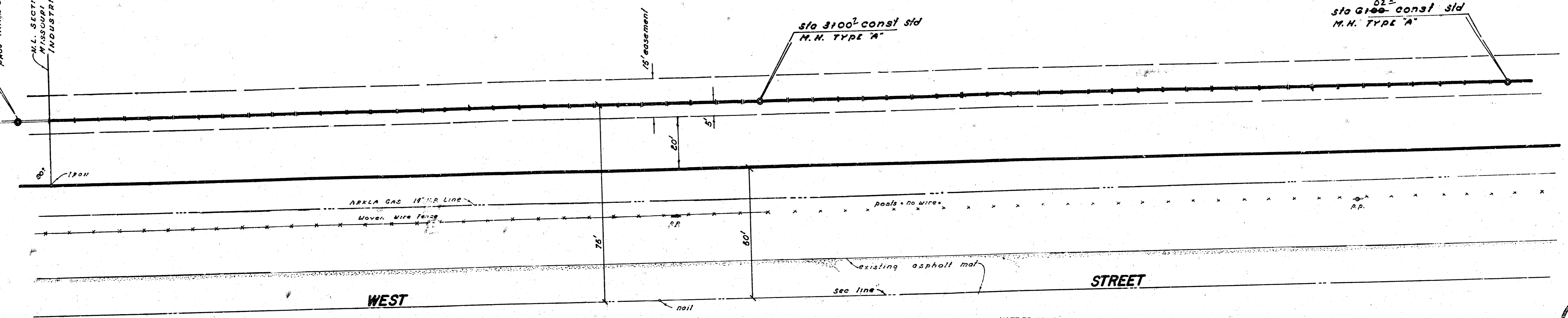

Sta 0+00 Existing
 TYPE "A" M.H. by others
 PROJ. BKHK 503001

M.L. SECTION ONE
 MISSOURI PACIFIC
 INDUSTRIAL PARK



NOTE TO CONTRACTOR
 This project will be constructed under the supervision of the CITY ENGINEER and conforming to the SPECIFICATIONS of the CITY OF WICHITA. The CONTRACTOR will reimburse the City of Wichita for an audit of engineering plans, specifications, etc.

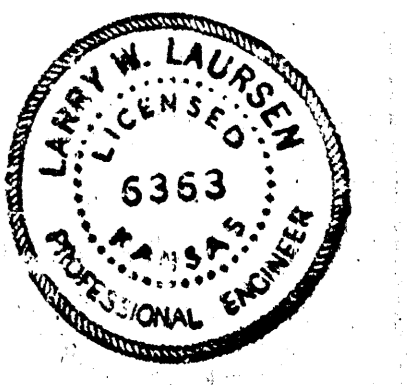

PLAN SCALE 1" = 20'
 PROFILE 1" = 20' HORIZ
 1" = 5' VERT

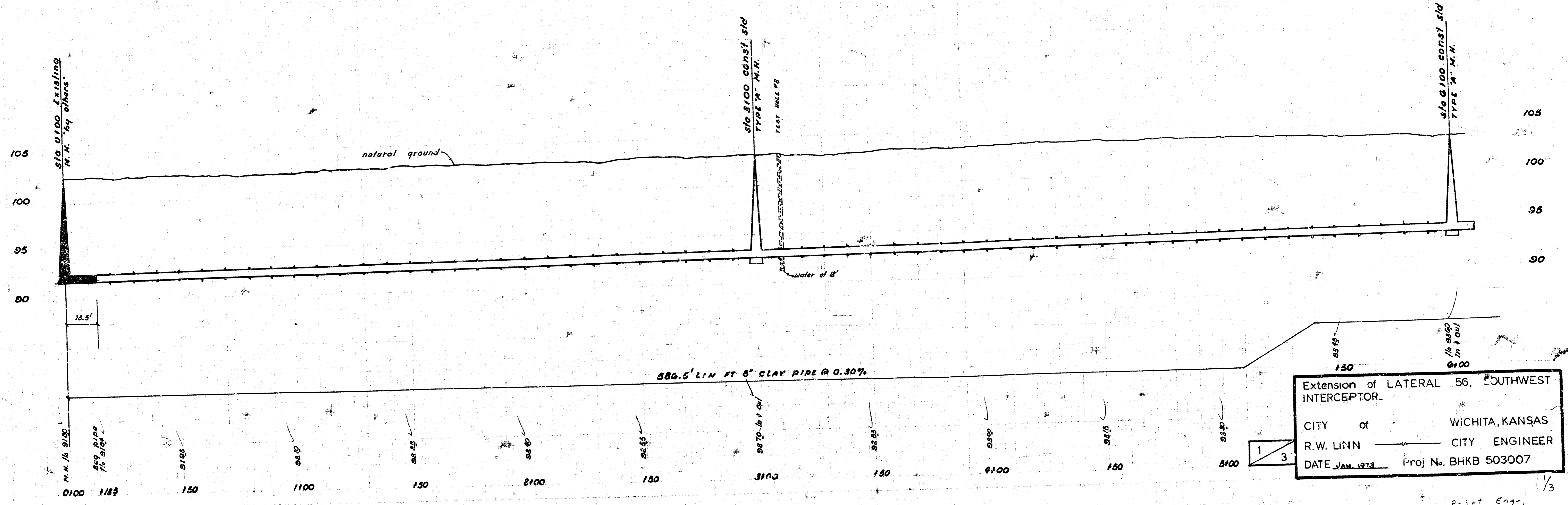

Extension of LATERAL 56, SOUTHWEST INTERCEPTOR.
 CITY of WICHITA, KANSAS
 R.W. LINN CITY ENGINEER
 DATE Jan. 1973 Proj. No. BKHK 503007

2-Set Engr.
 1-Set Water

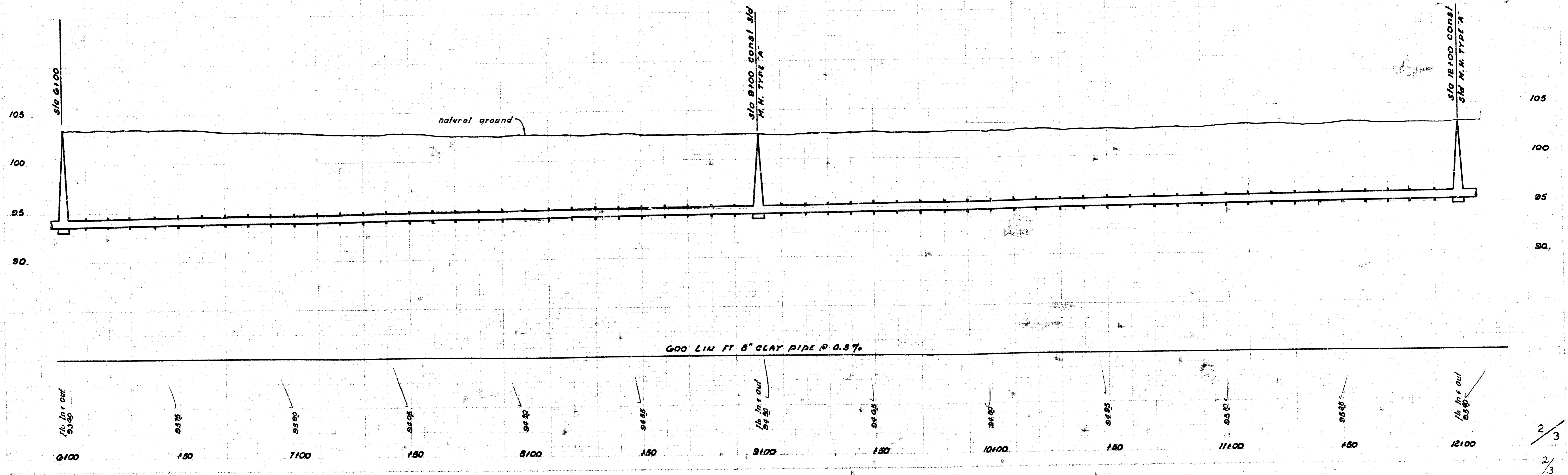
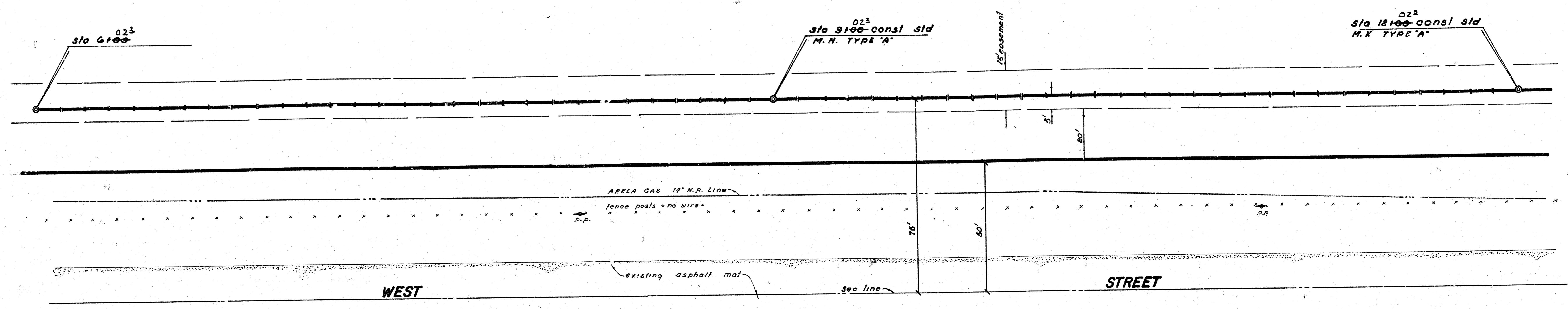

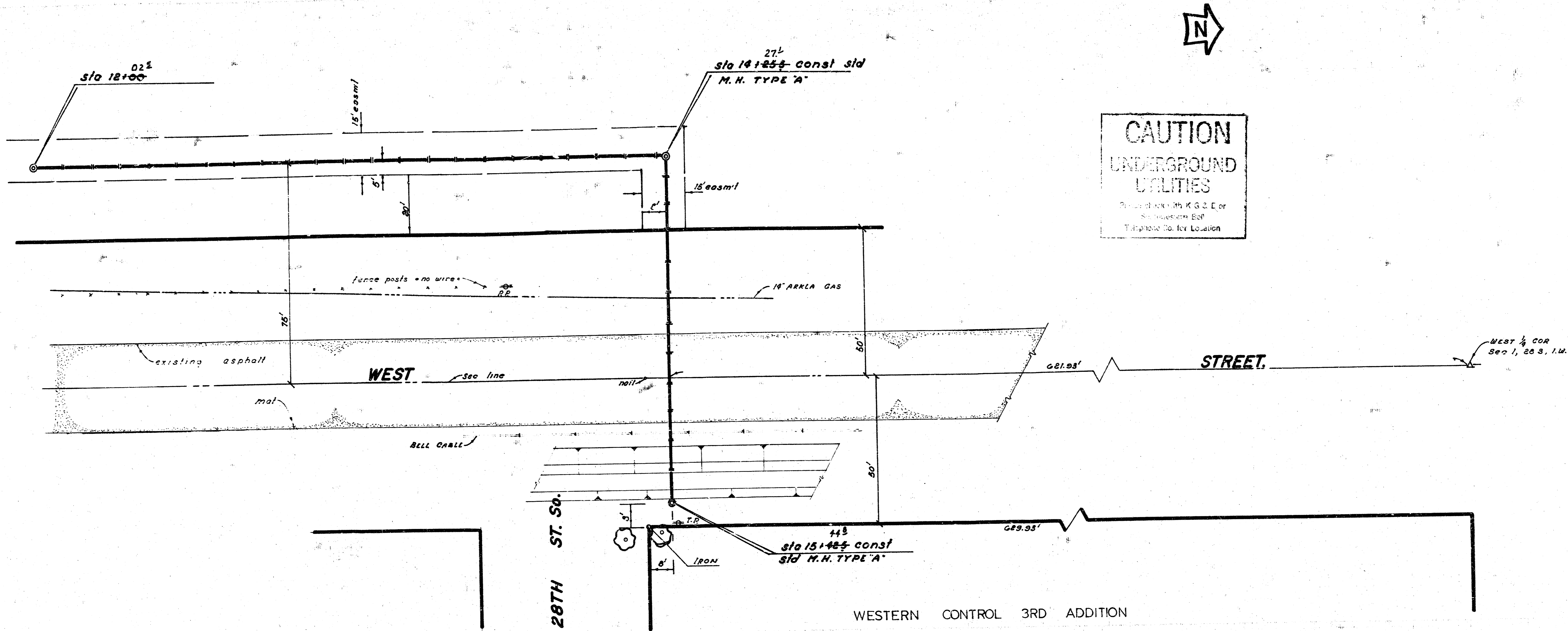

CAUTION
 UNDERGROUND
 UTILITIES
 Call 311 for K.G.S.E. or
 Sanitation Dept.
 Telephone No. for Location

