

B.M. - 156.19 - CITY B.M. DISC, 42.3 E. + 44 N. of 1/4 SEC. CORNER of 13TH STREET & WOODCHUCK.
 B.M. - 150.27 - 4' at W. END of RETURN, N.W. CORNER of MORGANTOWN and NANTUCKET.
 B.M. - 137.55 - RR SPIKE in E.S. of P.P., 1016' N. of E. of 13TH ST and 46' W. of E. of RIDGE ROAD.
 B.M. - 144.83 - 2' on TOP of CURB at WEST END of RADUS, N.W. CORNER of NORTHWEST PARKWAY and MORGANTOWN AVE.

SCALE: PLAN: 1" = 40'
 PROFILE: HORIZONTAL: 1" = 40'
 VERTICAL: 1" = 5'

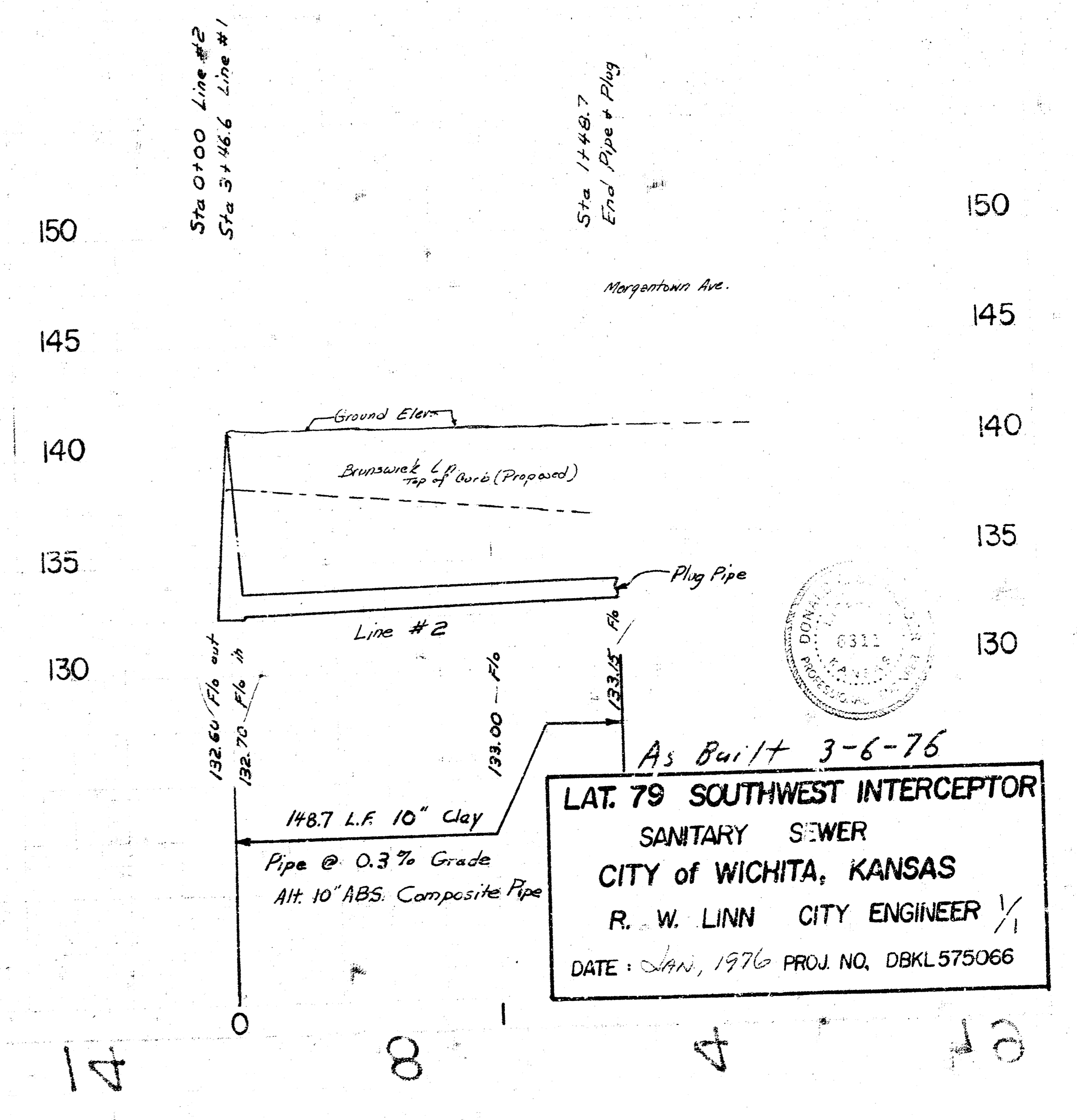
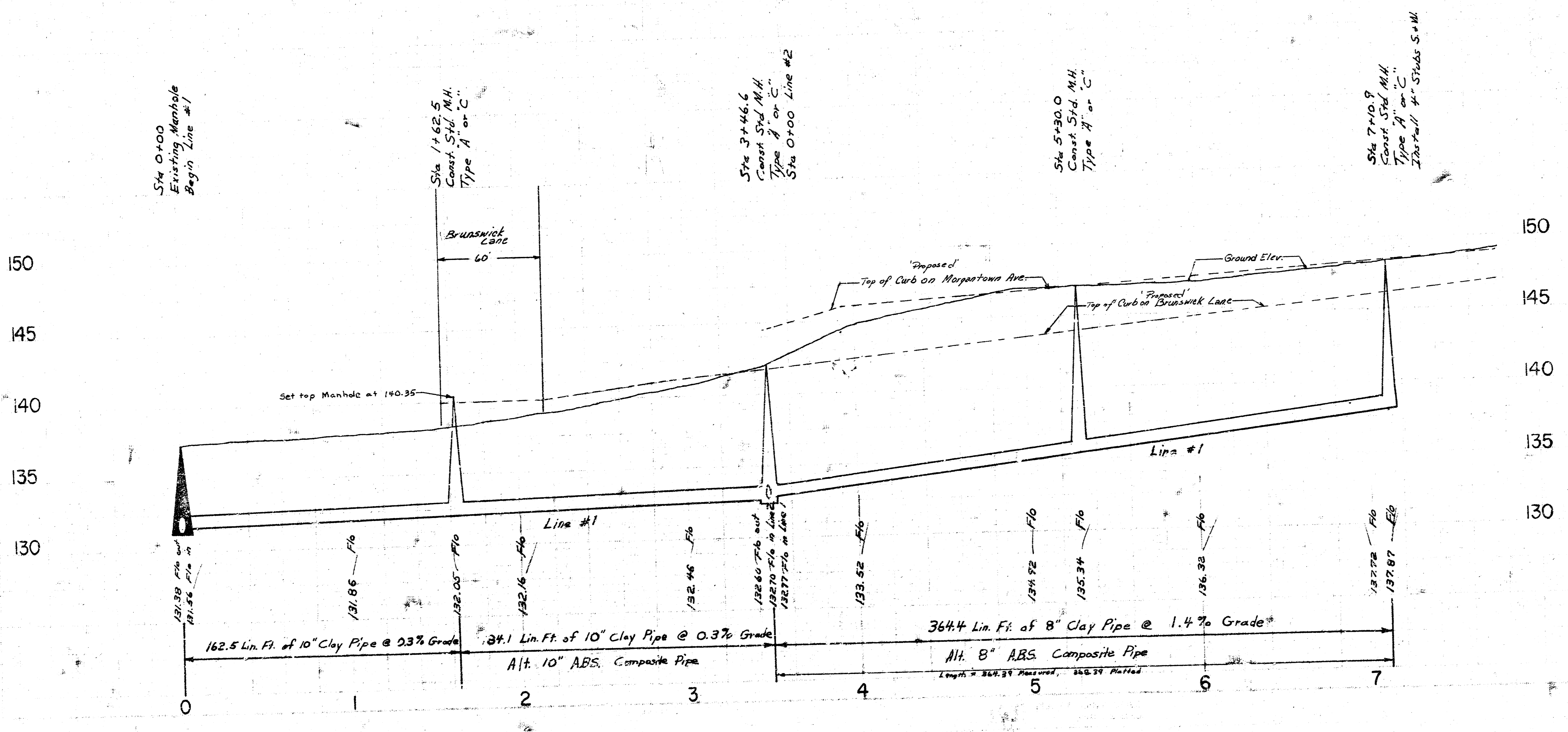

As Built 3-6-76
LAT. 79 SOUTHWEST INTERCEPTOR
 SANITARY SEWER
 CITY OF WICHITA, KANSAS
 R. W. LINN CITY ENGINEER
 DATE: JAN, 1976 PROJ. NO. DBKL575066