

Sta 5+00 5700.2  
 Const. Std. M.H.  
 Type "A" or "C"  
 Sta 0+00 Line 2A

Sta 5+76  
 Const. Std. M.H.  
 Type "A" or "C"  
 Install 4" Stub S.E.  
 End Line 2

Sta 3+41 3110.1  
 Const. Std. M.H.  
 Type "A" or "C"  
 Install 4" Stub N.W.  
 End Line 1

Sta 0+99  
 Const. Std. M.H.  
 Type "A" or "C"

Sta 0+00 Line 1  
 Begin 8" Pipe

Sta 0+00  
 Const. Std. M.H.  
 Type "A" or "C"  
 Begin Line 2

Sta 0+65 077.2  
 Const. Std. M.H.  
 Type "A" or "C"

Sta 2+83 213.2  
 Const. Std. M.H.  
 Type "A" or "C"

Plan Scale 1" = 40'  
 Profile Scale 1" = 5'

NOTE: PIPE FROM STATION 0 + 20 TO 0 + 31 ON LINE NO. 1 AND FROM STATION 0 + 00 TO 0 + 18 ON LINE NO. 2 SHALL BE SAME TYPE OF PIPE AS PIPE SOUTH OF STATIONS 0 + 00 WHICH IS TO BE INSTALLED BY THE CONTRACTOR FOR LATERAL TOP, SOUTHWEST INTERCEPTOR.

BM 162.11 R.R. Spike W. fc. P.P. N.W. cor. Maize Rd. & Bartlett  
 BM 164.49 R.R. Spike W. fc. P.P. S.W. cor. 17th & Maize Rd.

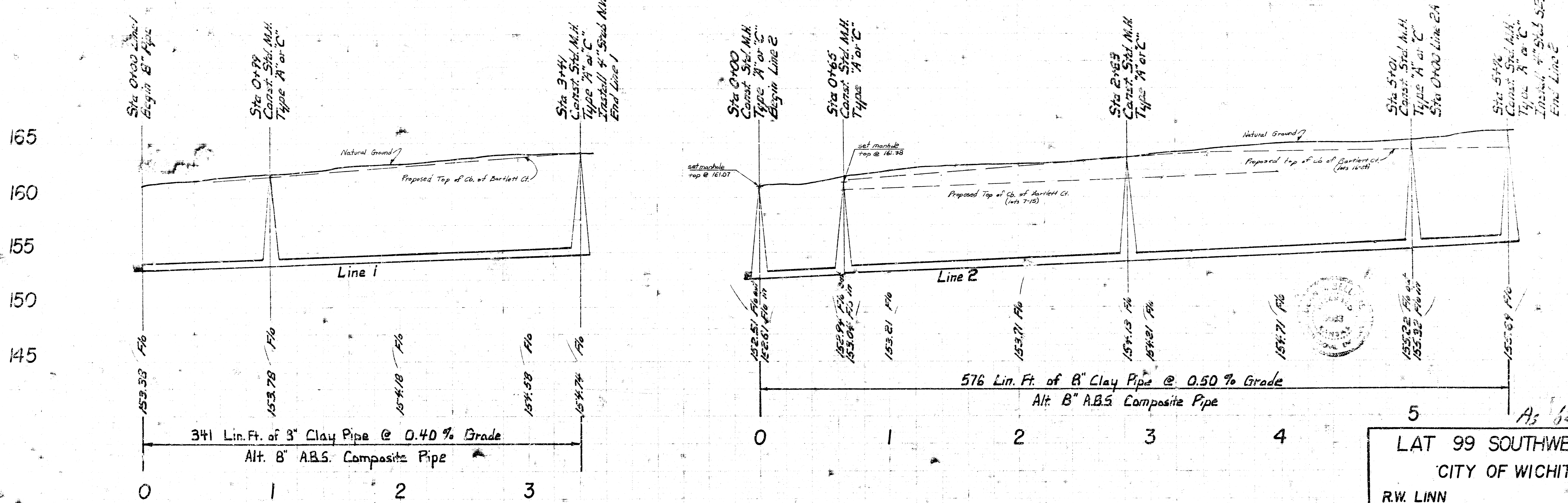

341 Lin. Ft. of 8" Clay Pipe @ 0.40% Grade  
 Alt. 8" A.B.S. Composite Pipe

576 Lin. Ft. of 8" Clay Pipe @ 0.50% Grade  
 Alt. 8" A.B.S. Composite Pipe

LAT 99 SOUTHWEST INTERCEPTOR  
 CITY OF WICHITA, KANSAS

R.W. LINN CITY ENGINEER  
 DATE: PROJECT NUMBER: DRK157

As built 2-22

