

B. M. 81.86 R.P. Spk. SW face Street light pole SW cor Spruce & 47th St. So.
 B. M. 86.52 City Sta. west end North Suburban to River Bridge 1/2 Mile E. of Hydraulic on 47th St. So.
 B. M. 85.00 NW cor conc. porch # 4732 So. Madison.

NOTE:
 Replace all asphalt pavement.

CAUTION
UNDERGROUND UTILITIES
 Please check with K. G. & E. of Southwestern Gas Telephone Co. for location.

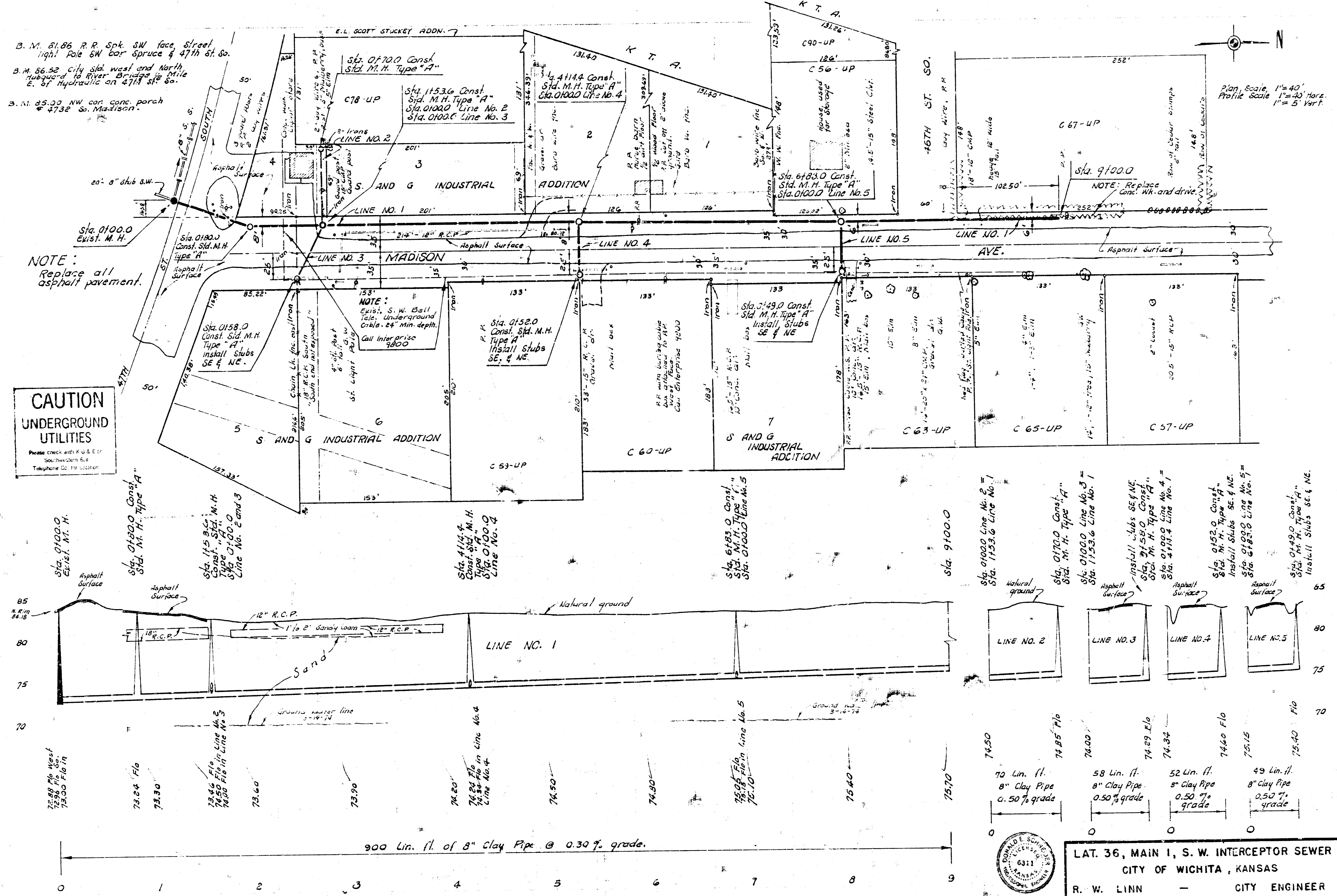

Plan Scale 1"=40'
 Profile Scale 1"=10' Horiz.
 1"=5' Vert.

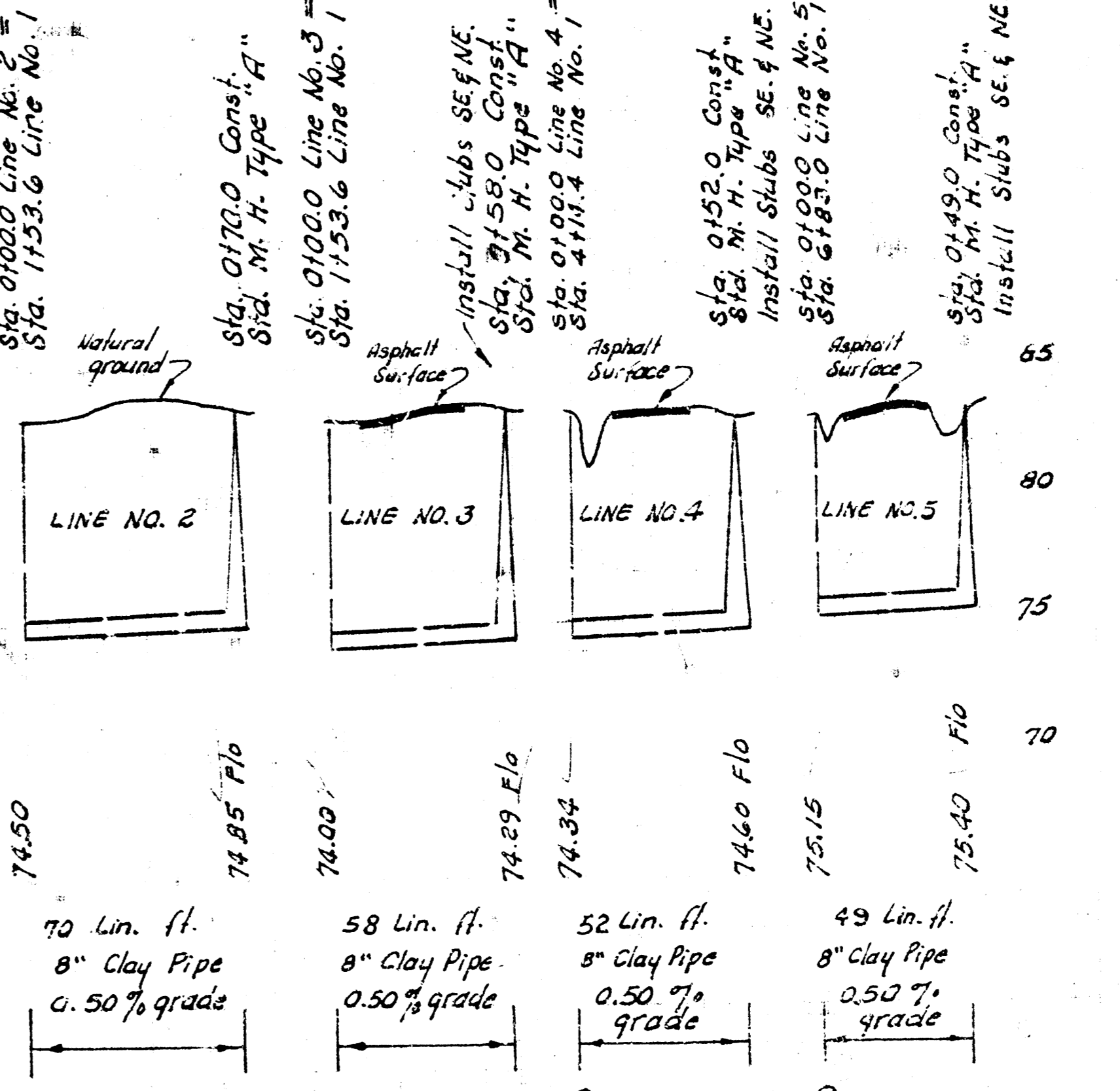

LAT. 36, MAIN 1, S. W. INTERCEPTOR SEWER
CITY OF WICHITA, KANSAS
R. W. LINN - CITY ENGINEER
APRIL 1974 PROJECT NO. DBKL 573037

CAUTION
UNDERGROUND UTILITIES

CAUTION
S. W. Bell Telephone underground Cable

NOTE: Replace all asphalt Pavement.

NOTE: Exist. S. W. Bell Telephone underground Cable, 24" min. depth, Call Enterance 4350

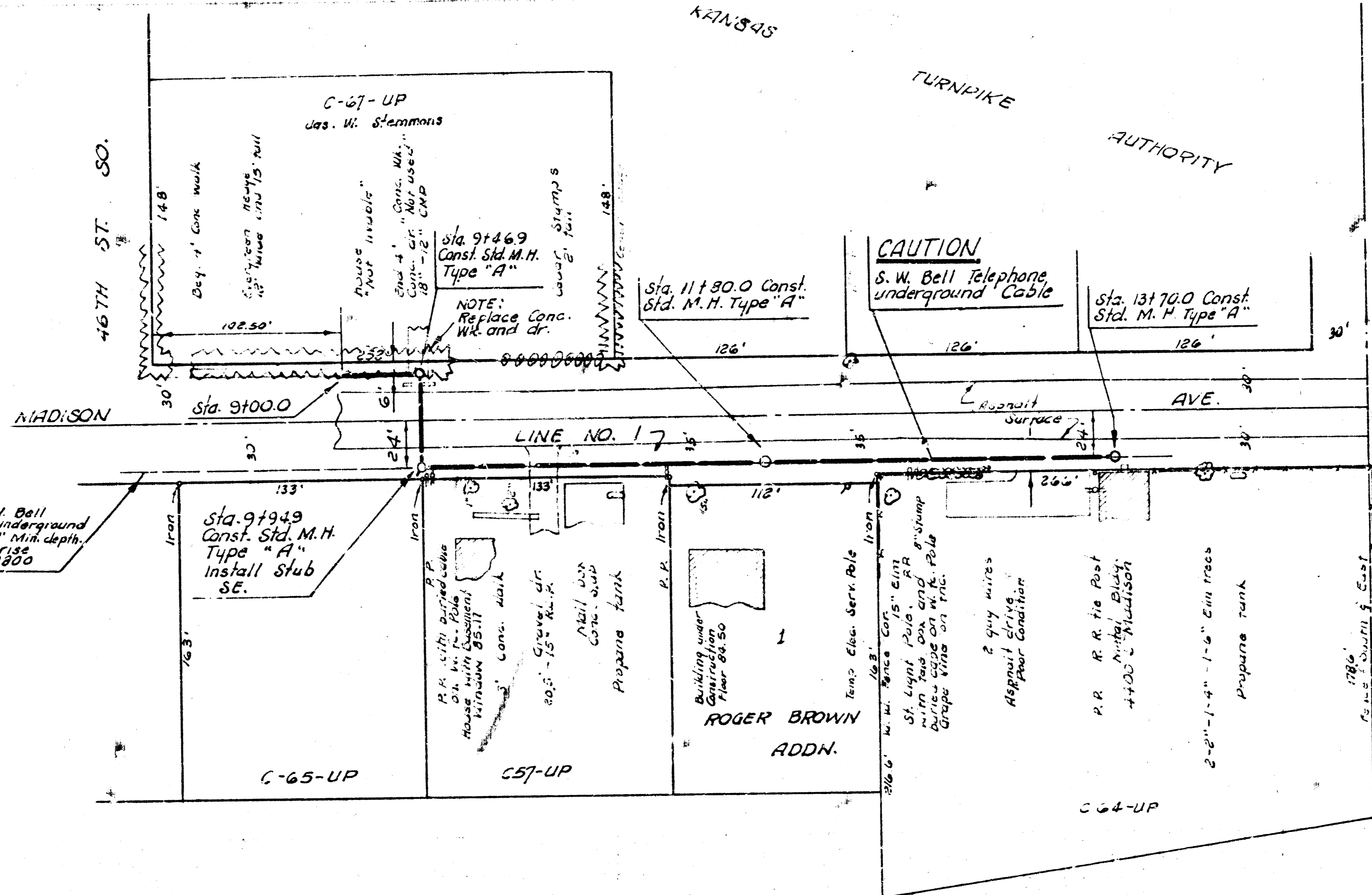

E. M. 85.50 NW cor. bot. conc
Step 4644 So. Madison.

85
80
75
70

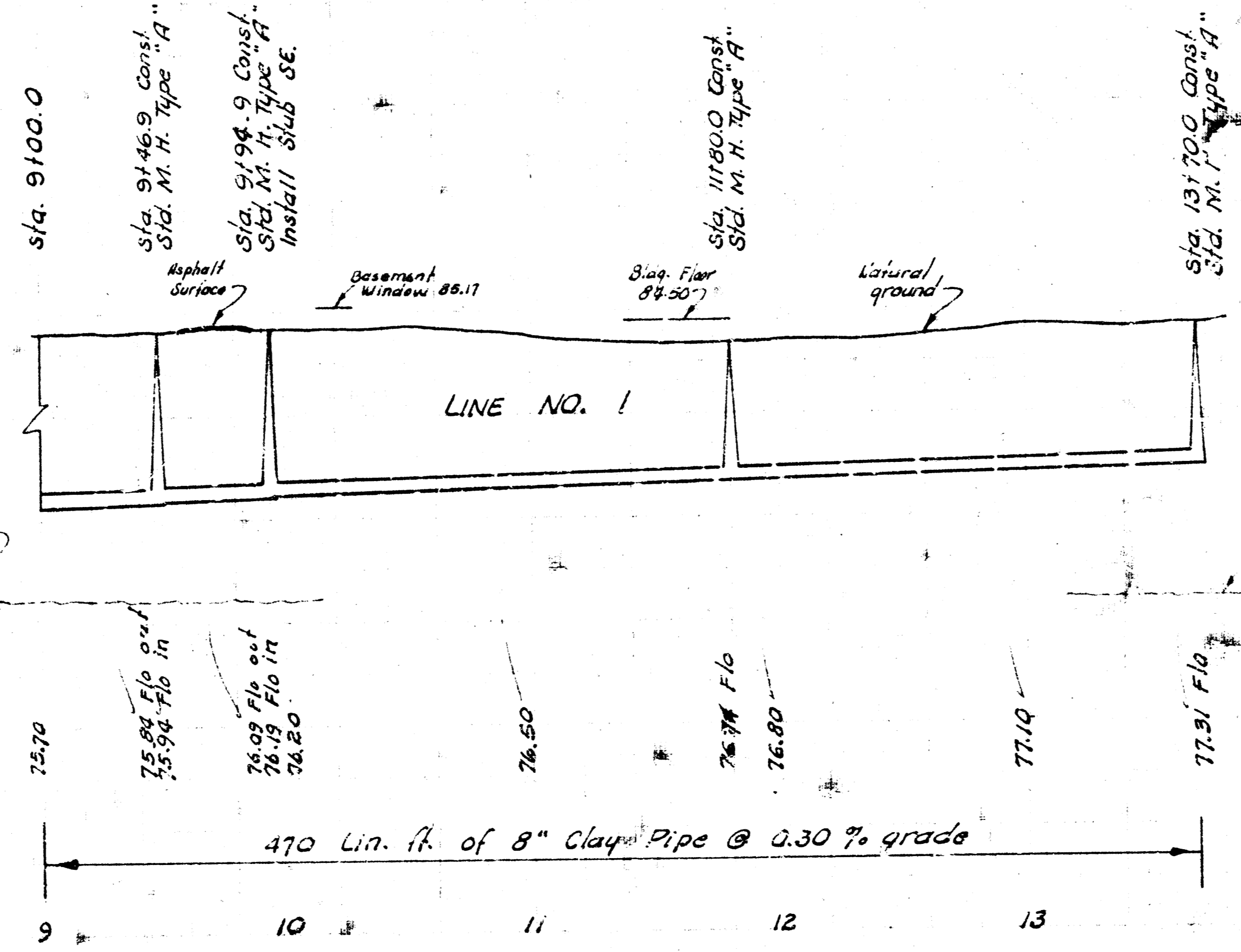

85
80
75
70

L. AT. 36, MAIN 1 S. W. INTERCEPTOR SEWER
PROJECT NO. DBK L 573037

14 e 3 50