

LATERAL 49, MAIN 1 SOUTHWEST INTERCEPTOR SEWER

Project no. 468-76-245-80511-000-000-001

CITY OF WICHITA, KANSAS
MIKE LINDEBAK CITY ENGINEER

*As Built
12-84
J. Love*

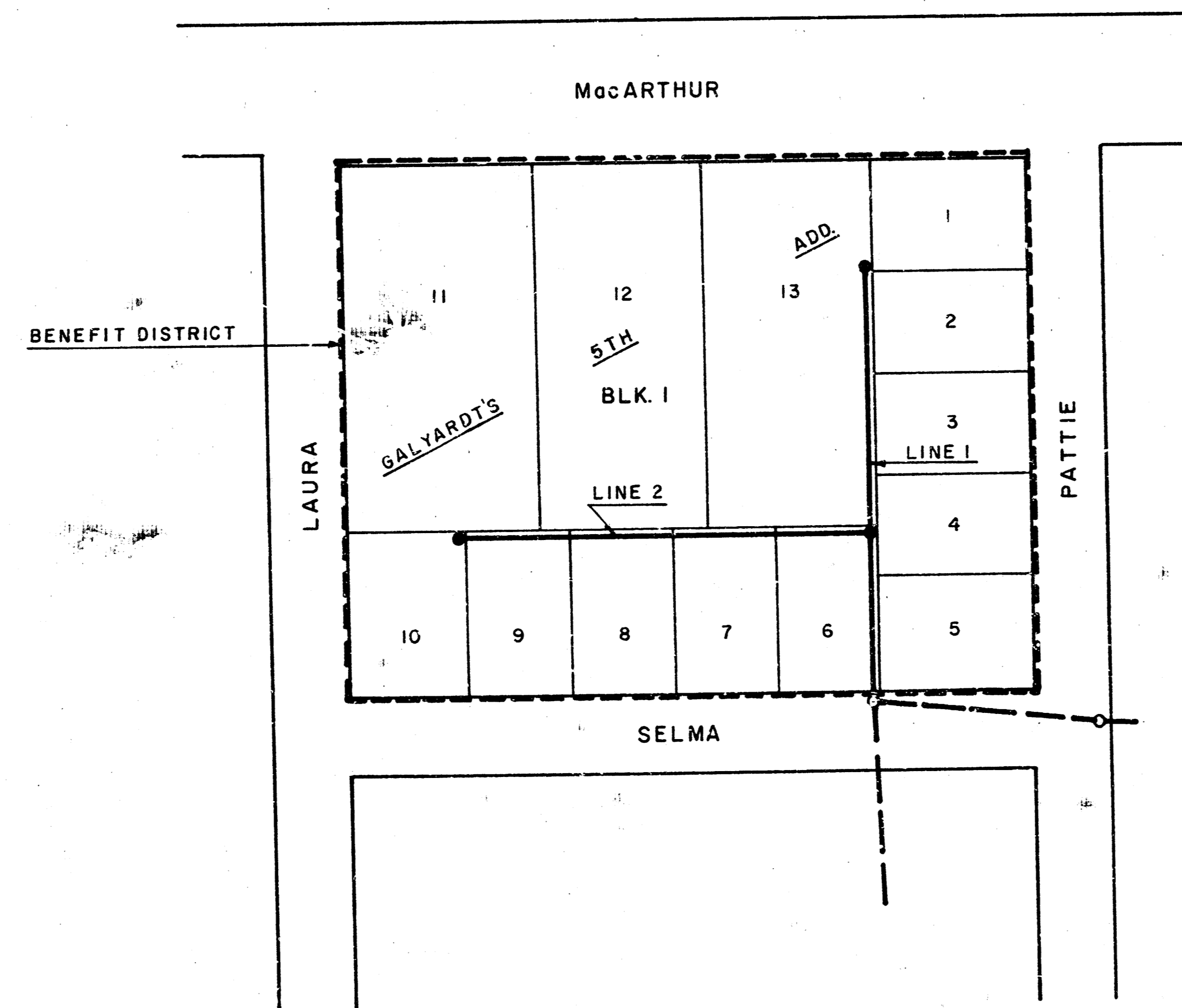

LOCATION MAP

GENERAL NOTES

The contractor shall be responsible for preserving property irons. The contractor shall be required to re-establish any property irons which are damaged or destroyed by his construction operations. Such irons shall be re-established by a licensed land surveyor or a professional engineer in accordance with state laws.

The contractor shall contact the utility companies for a field verification of any underground lines.



JUNE 1984

BAUGHMAN COMPANY, P.A.
SURVEYING & ENGINEERING
316/322-7271 • 330 LAURA • WICHITA, KANSAS 67211

1/2

