

Scale Plan 1" = 40'
 Profile 1" = 40' Horiz.
 1" = 5' Vert.

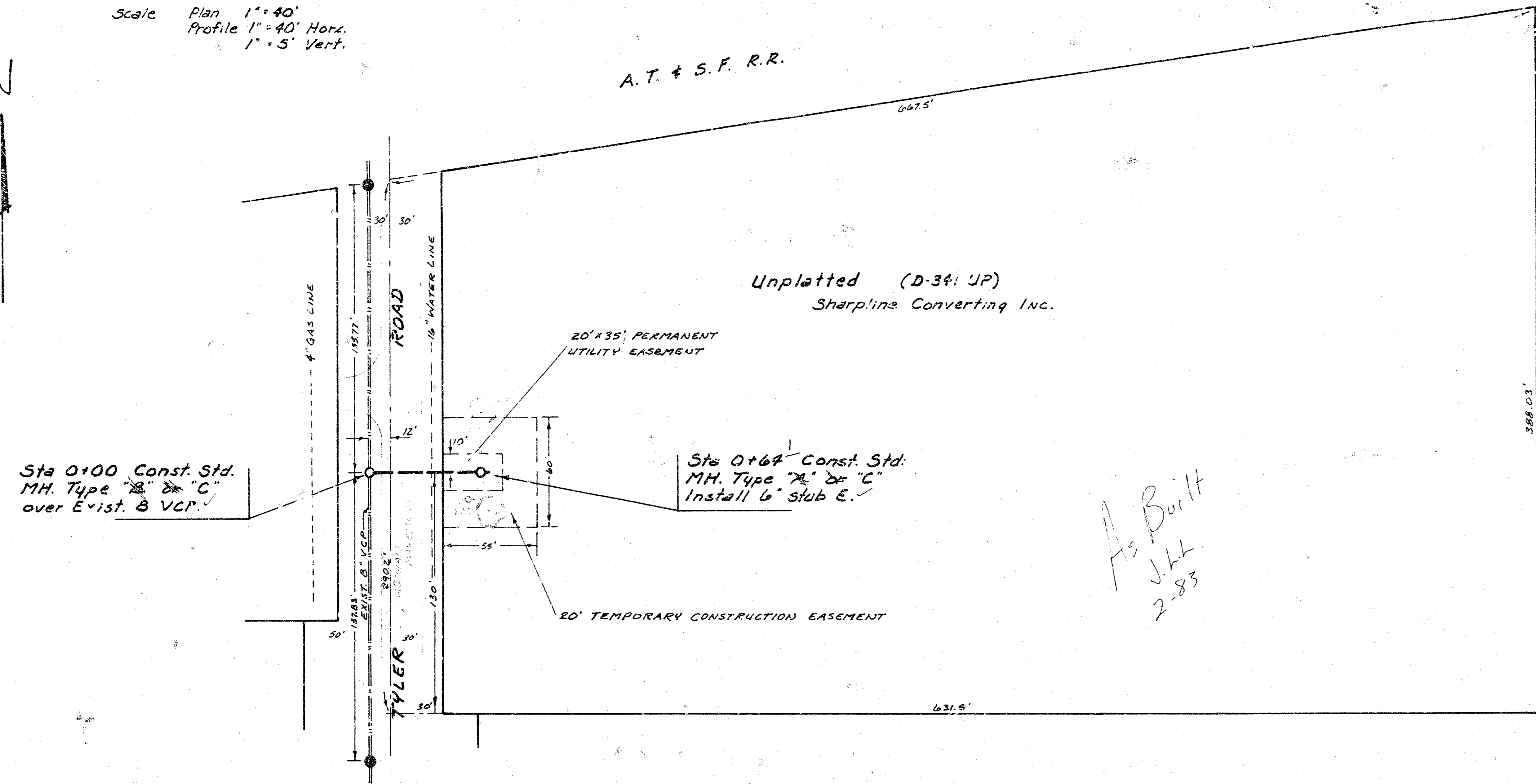
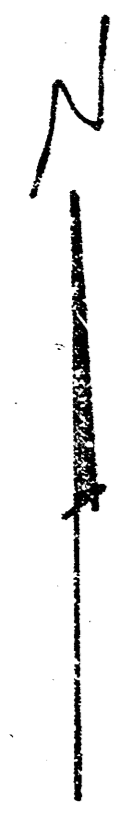

*As Built
 J.H.
 2-83*

THE CONTRACTOR SHALL BE RESPONSIBLE FOR PRESERVING PROPERTY IRONS. THE CONTRACTOR SHALL BE REQUIRED TO RE-ESTABLISH ANY PROPERTY IRONS WHICH ARE DAMAGED OR DESTROYED BY HIS CONSTRUCTION OPERATIONS. SUCH IRONS SHALL BE RE-ESTABLISHED BY A LICENSED LAND SURVEYOR OR A LICENSED PROFESSIONAL ENGINEER IN ACCORDANCE WITH STATE LAWS.

TBM: Top of the SW 3" x 4" Steel Guard Post of Guard Posts around a Gas Regulator in the NW Quad of the Intersection of Harry St. and Tyler Road. Elev. 143.78
 TBM: "M" in Mueller on the Top Flange of Fire Hydrant in the SE Quad of the Intersection of Kellogg (HWY #4) and Tyler Road. Elev. 142.85

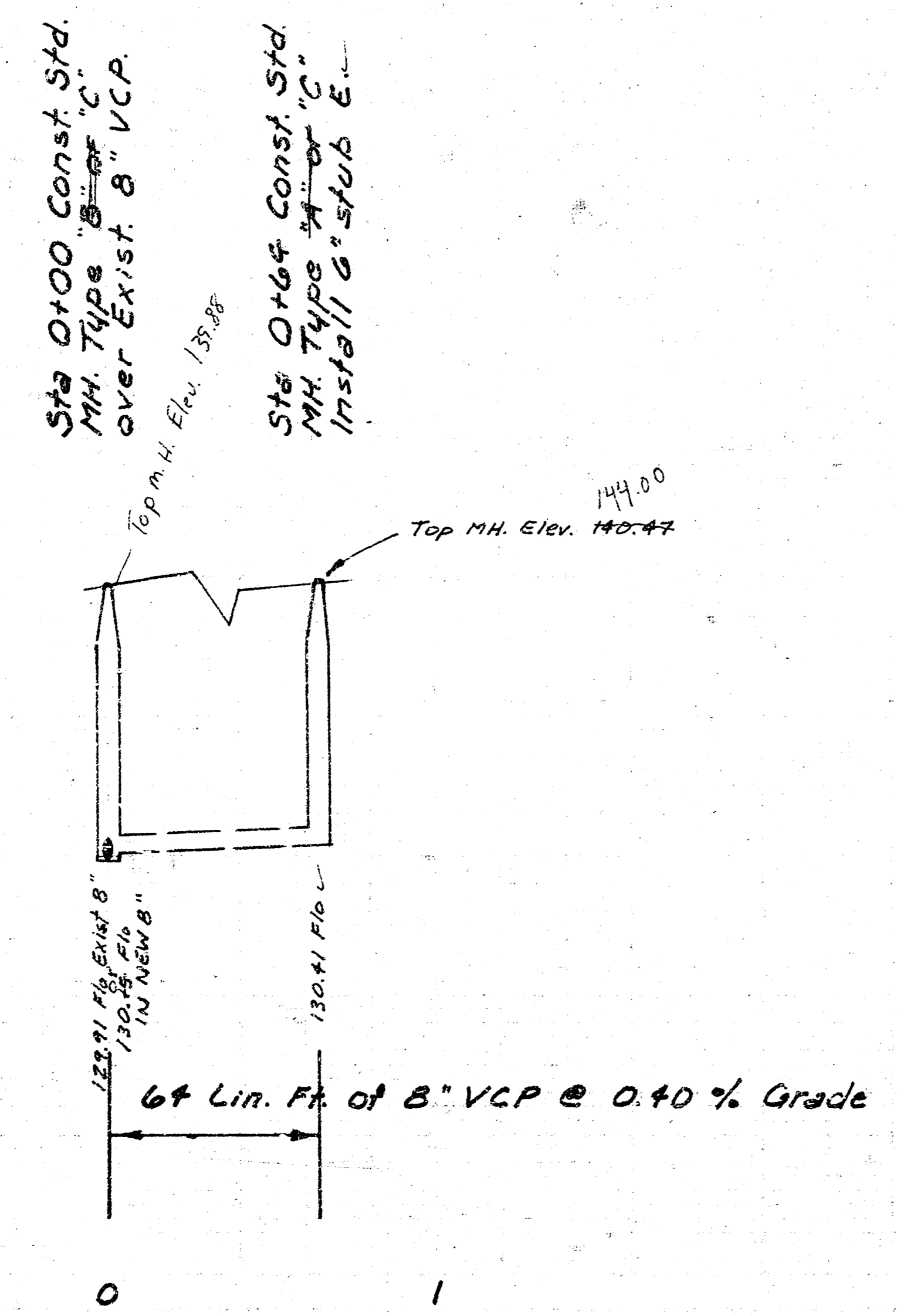

140
 135
 130

140
 135
 130



PROJECT DESCRIPTION	
LAT 2, MAIN 3, SOUTHWEST INTERCEPTOR	
PROJECT NUMBER	
468-76-245-81237-000-001	
BOOK NO.	APPROVED BY
DRAWN BY 100/4/5	DATE
REVIS	
CITY OF WICHITA	
DEPARTMENT OF ENGINEERING	
DIRECTOR OF ENG./CITY ENGINEER	SCALE
R. W. BRUGGEMAN	