

Scale: 1"=20' Plan  
Vert. 1"=5'

B.M. = 114.07 ~ NE Cor. Conc. Base RR. Signal Box, SW. Cor. 3rd & Wichita.  
B.M. = 112.71 ~ "B" Bk. Wk. N.L. 3rd St., 5' E. of E.L. Main  
B.M. = 111.75 ~ RR. Spike in PP. N. Side, SE. Cor. Waco & 3rd  
B.M. = 112.15 ~ RR. Spike, N. Fe. PP., SW. Cor. 3rd & Riverview

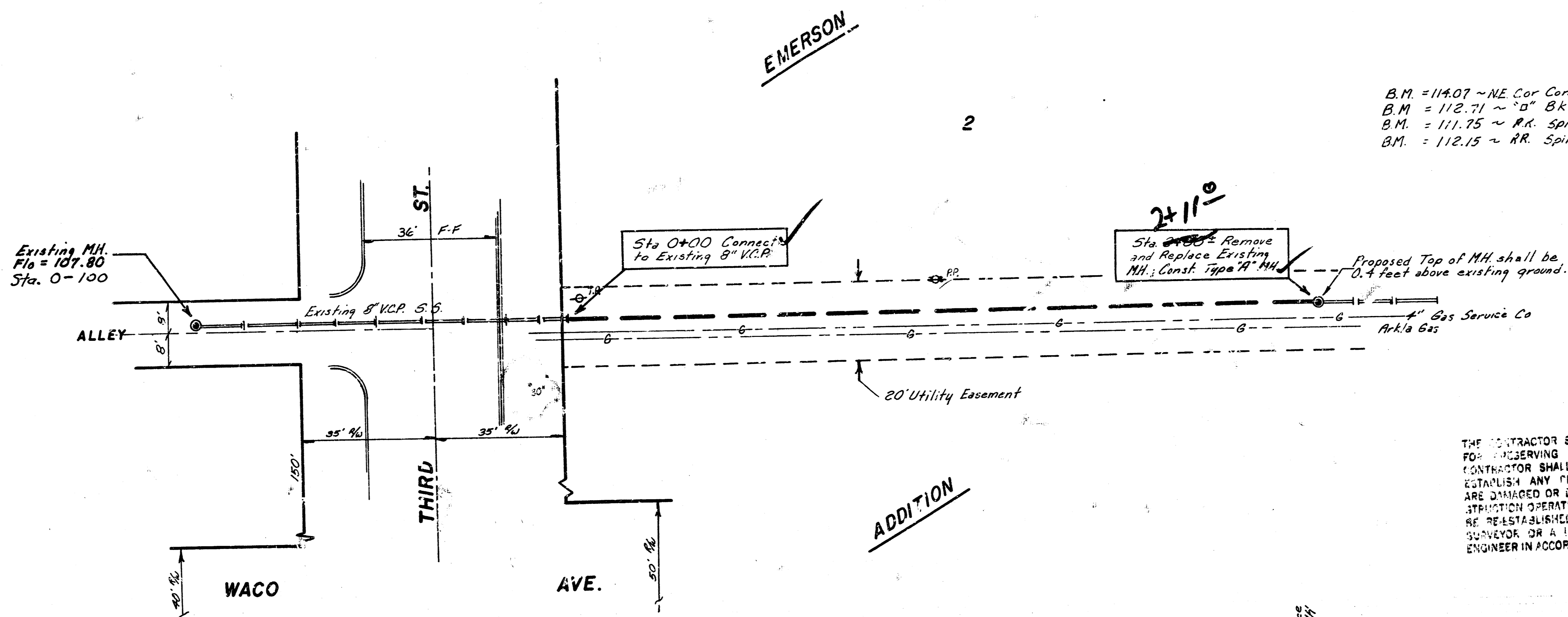

Note: Contact Gas Companies -  
24 Hr. Notice for location of Gas  
Lines and service connections before  
starting construction.

THE CONTRACTOR SHALL BE RESPONSIBLE  
FOR PRESERVING PROPERTY ADJACENT TO THE  
CONSTRUCTION. THE CONTRACTOR SHALL BE REQUIRED TO RE-  
ESTABLISH ANY PROPERTY LINES WHICH  
ARE DAMAGED OR DESTROYED BY HIS CON-  
STRUCTION OPERATIONS. SUCH LINES SHALL  
BE RE-ESTABLISHED BY A LICENSED LAND  
SURVEYOR OR A LICENSED PROFESSIONAL  
ENGINEER IN ACCORDANCE WITH STATE LAWS.

**CAUTION**  
**UNDERGROUND**  
**UTILITIES**  
Please check with K & E or  
Southern Bell  
Telephone Co. for location

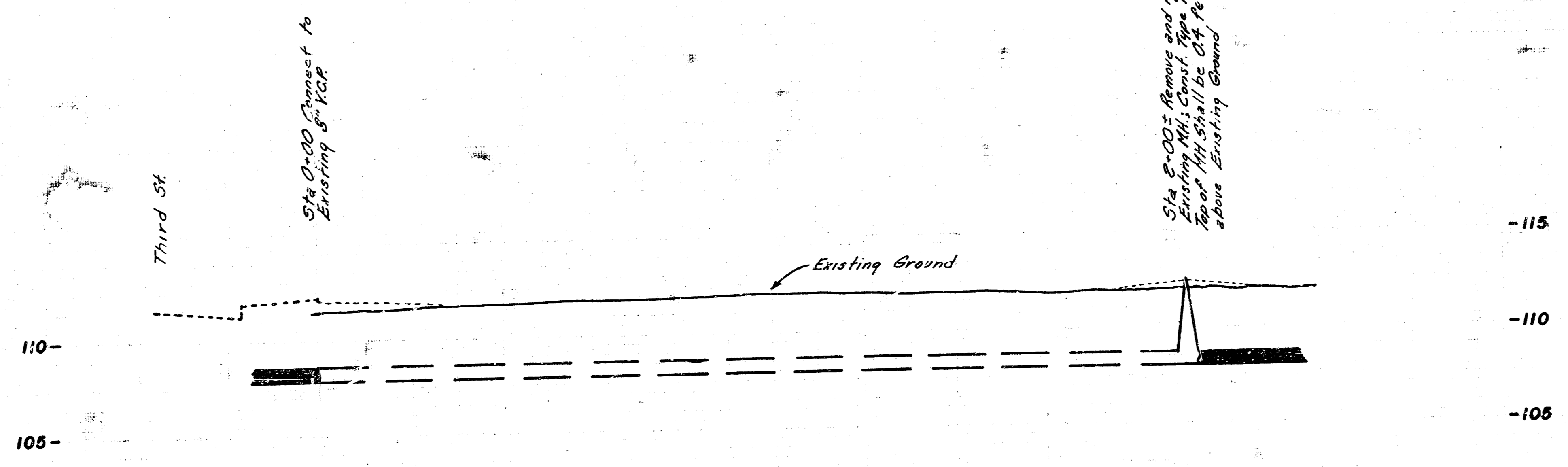

As Built  
1/82  
J. J.

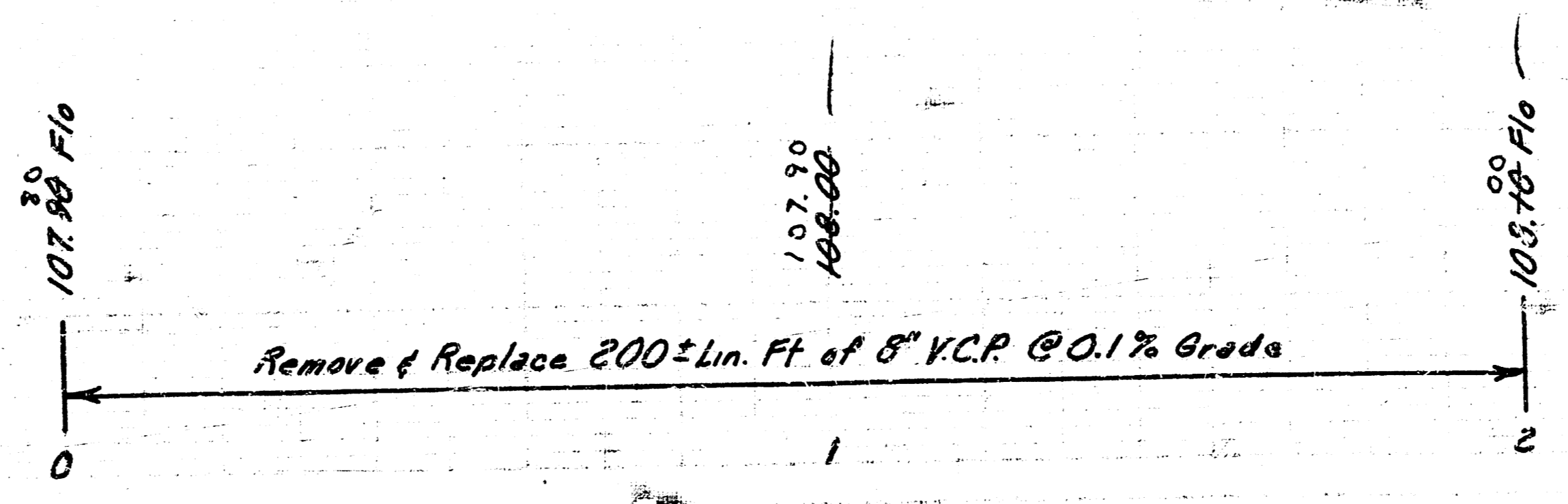
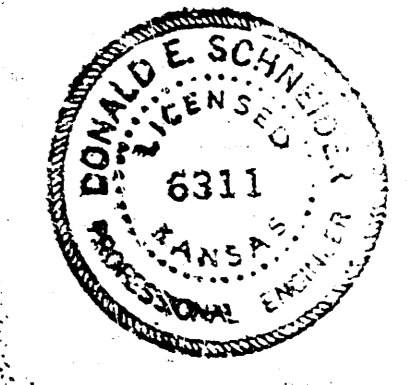

Reconstruction of a portion of SANITARY  
SEWER NO. 17, North of Third St.  
between Riverview & Waco  
CITY OF WICHITA, KANSAS  
R.W. BRUGGEMAN - DIRECTOR OF ENGINEERING / CITY ENGINEER  
PRG. NO. 468-76-245-81151-000-000-001  
Date \_\_\_\_\_ Sheet 1 of 1

FILMED FROM THE BEST  
AVAILABLE COPY.....

DeCasso  
J. Lindsey

8-11  
7-14

J. DeCasso  
J. Lindsey