

B.M. 118.57 'G' in Globe 1.5'± West of West Radius, North side of 16th Street at Mosley Avenue.

B.M. 120.12 'G' in Globe South end of Curb 22' East of C of Mosley at 19th Street.

B.M. 120.12 'G' in Globe South end of curb 22' East of C of Mosley at 19th Street.

Plan Scale : 1" = 20'
 Profile Scale : 1" = 20' Horiz.
 1" = 5' Vert.

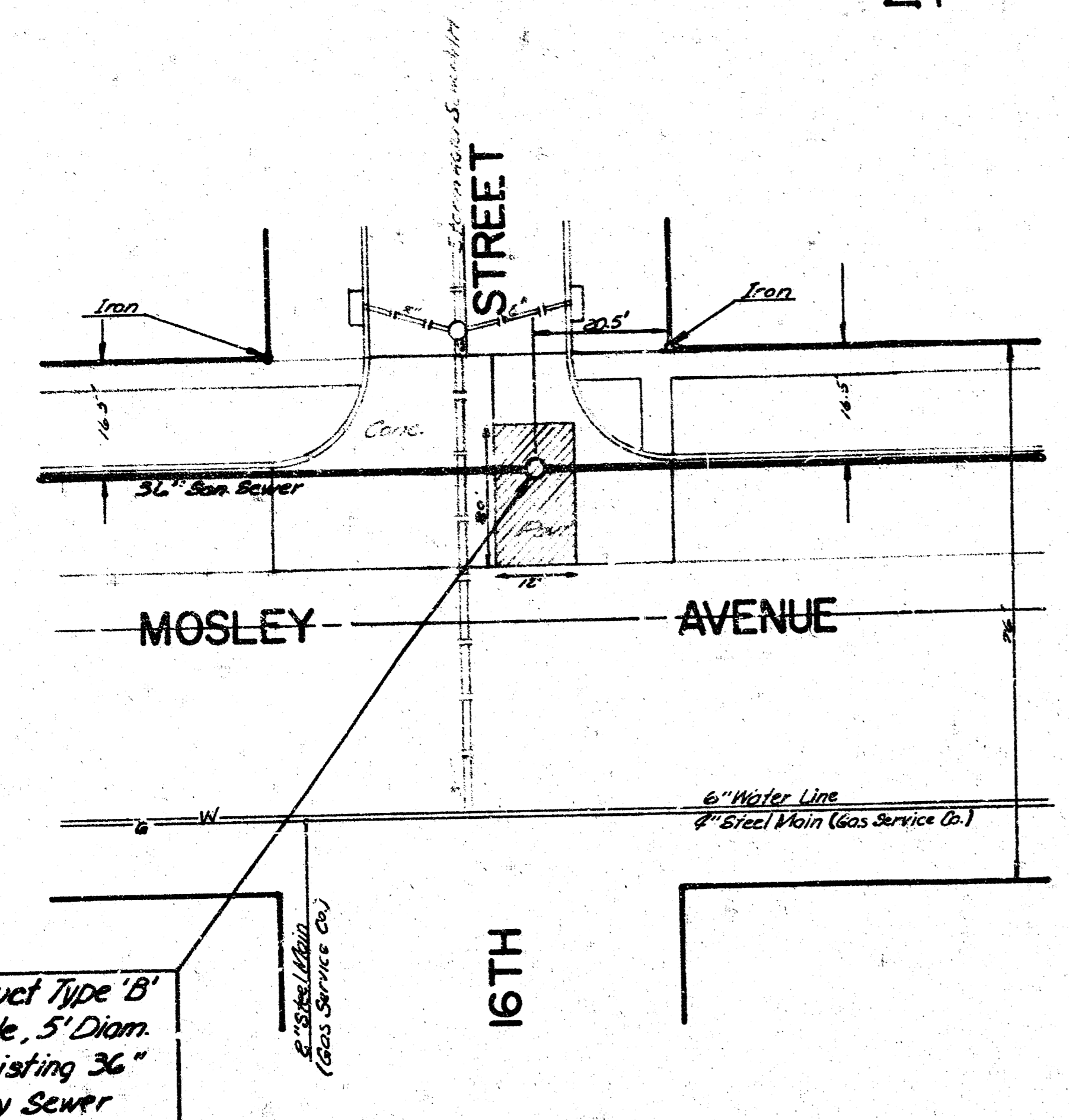

Construct Type 'B' Manhole, 5' Diam. Over existing 36" Sanitary Sewer

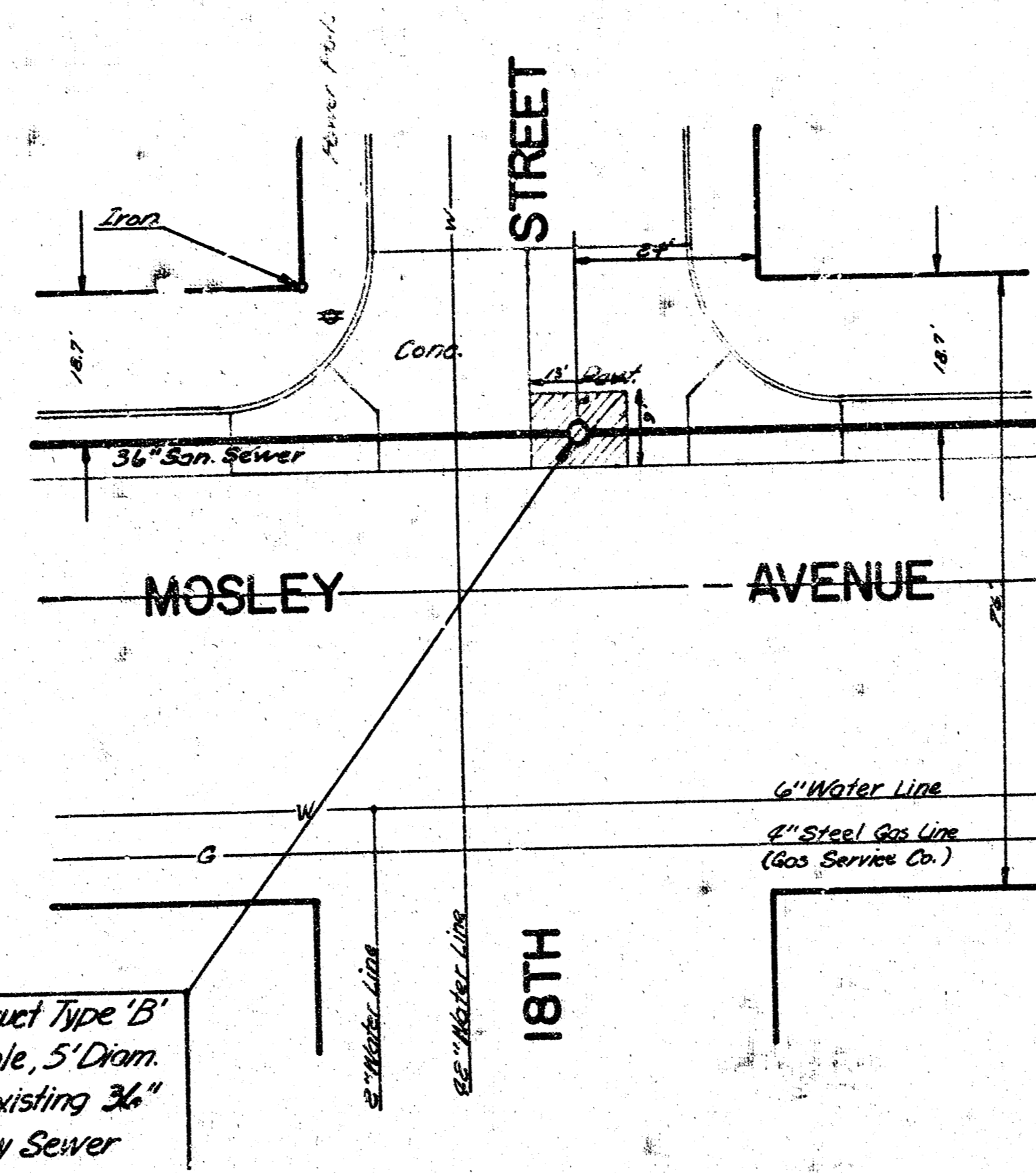

Construct Type 'B' Manhole, 5' Diam. Over existing 36" Sanitary Sewer

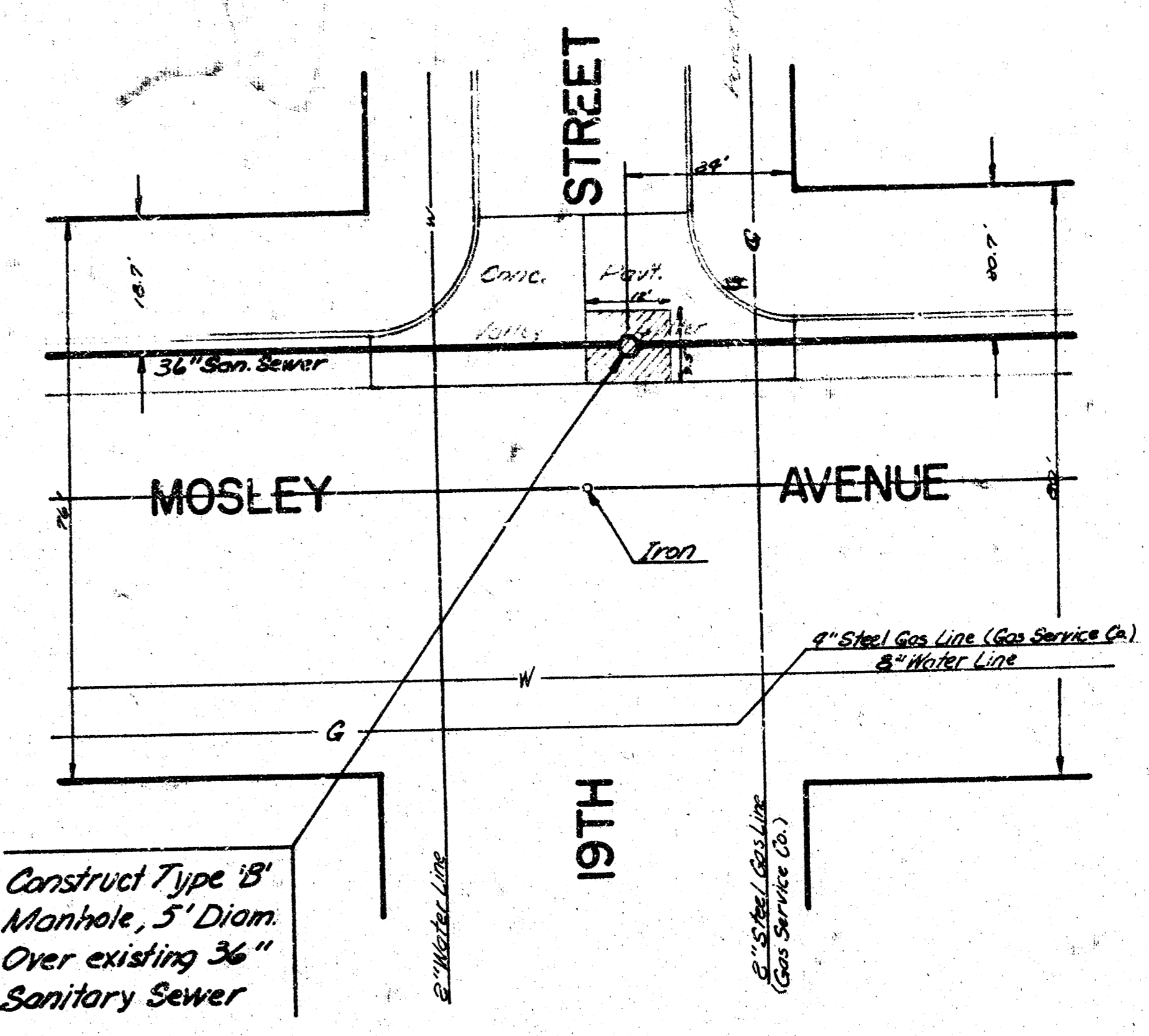

Construct Type 'B' Manhole, 5' Diam. Over existing 36" Sanitary Sewer

Note: Pavement to be replaced of the existing grades at all intersections.

Indicates approximate limits of pavement removal and replacement, actual limits to be ascertained by the Field Engineer.

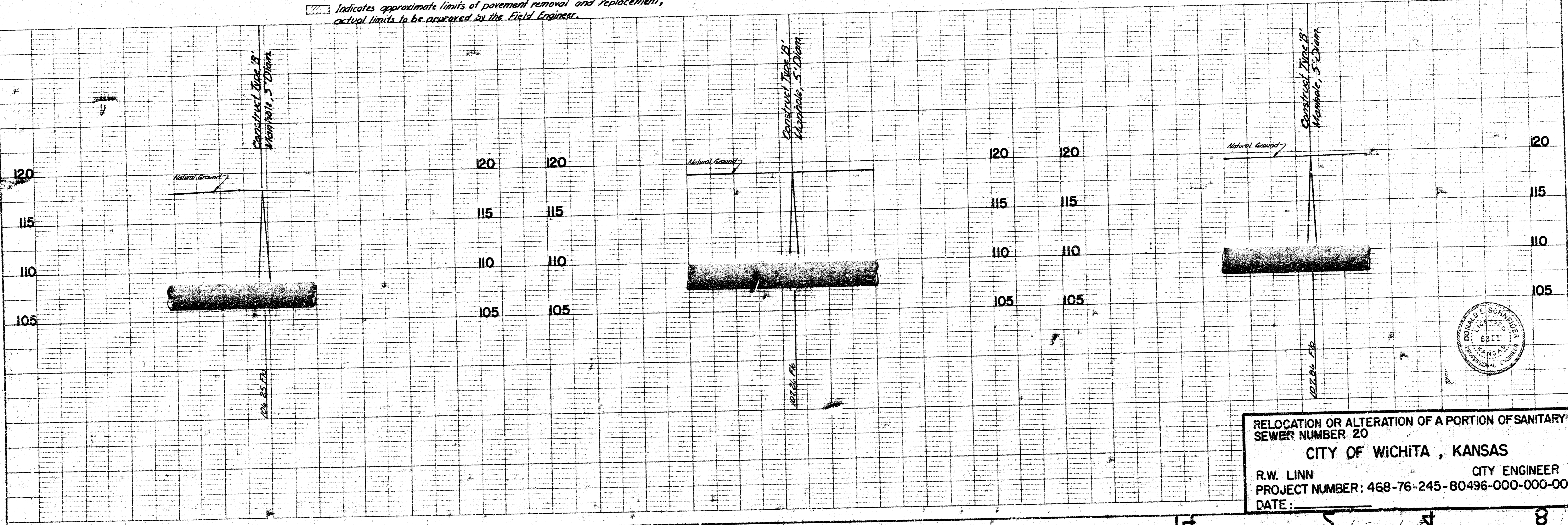

PLAN
 SHEET NO. 1 OF 1
 DATE: 5/1/14

PROFILE
 SHEET NO. 1 OF 1
 DATE: 5/1/14

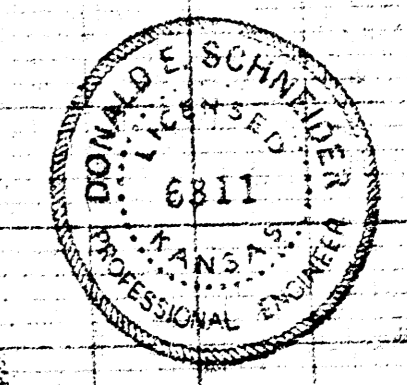

RELOCATION OR ALTERATION OF A PORTION OF SANITARY SEWER NUMBER 20
 CITY OF WICHITA, KANSAS
 R.W. LINN CITY ENGINEER
 PROJECT NUMBER: 468-76-245-80496-000-000-001
 DATE: 5/1/14