

# RECONSTRUCTION OF A PORTION OF LATERAL 32 SANITARY SEWER NO. 20

PROJECT NO.  
468-76-245-81333-000-000-001

CITY OF WICHITA, KANSAS  
MIKE LINDEBAK, CITY ENGINEER

MARCH, 1984

H. S. Bault  
J. L. L.  
3/85

### GENERAL NOTES

1. ALL UTILITY LOCATIONS ARE APPROXIMATE. CONTRACTOR SHALL COORDINATE WITH RESPECTIVE UTILITY OWNERS TO FIELD LOCATE UTILITY EXCAVATION.
  2. SERVICE LINE LOCATIONS AND QUANTITIES ARE APPROXIMATE AND ARE FROM EXISTING CITY RECORDS. CONTRACTOR SHALL TELEPHONE ALL SUPPLIERS OF NEW SERVICE ENLARGEMENT TO VERIFY LOCATIONS OF ACTIVE SERVICE LINES. ONLY ACTIVE SERVICE LINES ARE TO BE RECONSTRUCTED.
  3. TELEVISION TAPES AND LOGS OF SPURS TO BE SHELPHED OR PLACES ARE AVAILABLE FROM THE CITY SEWER MAINTENANCE DIVISION.
  4. ALL RECONSTRUCTION SHALL BE CITY OF WICHITA DESIGN. CITY MANUAL 8 - 1187.A USCS.
  5. IF DAMAGED DURING CONSTRUCTION, EXISTING MANHOLES, SEWER LINES, AND OTHER APPROPRIATE LANCES TO REMAIN IN SERVICE SHALL BE REPAIRED TO ORIGINAL CONDITION.
  6. ~~CONTRACTOR SHALL BE RESPONSIBLE FOR OBTAINING THE SPICE LOCATION OF ALL UTILITIES PRIOR TO CONSTRUCTION.~~
  7. OBTAIN SAFETY BY RAILROAD (248-7517) PRIOR TO BEGINNING OF CONSTRUCTION.
  8. CONTRACTOR IS RESPONSIBLE FOR OBTAINING THE SPICE LOCATION OF ALL UTILITIES PRIOR TO CONSTRUCTION.
- NOTE: CONTRACTOR'S METHOD FOR HANDLING SEWAGE FLOWS DURING CONSTRUCTION OF THIS PROJECT SHALL BE AS APPROVED BY THE ENGINEER. ONLY ACTIVE BUILDING SEWER LINES WHICH CONNECT ACTUAL BUILDINGS TO THE SEWER SYSTEM ARE TO BE RECONNECTED TO THE NEW SEWER CONSTRUCTION. BUILDING SEWER LINES AND/OR CONNECTIONS WHICH HAVE BEEN ABANDONED ARE NOT TO BE RECONNECTED TO THE NEW SEWER CONSTRUCTION. IT WILL BE THE SOLE RESPONSIBILITY OF THE CONTRACTOR TO ASCERTAIN WHICH BUILDING SEWER LINES AND/OR CONNECTIONS ARE ACTIVE AND WHICH SUCH SEWERS AND/OR CONNECTIONS HAVE BEEN ABANDONED. ALL WORK INVOLVED WITH BUILDING SEWER CONSTRUCTION AND/OR BUILDING SEWER CONNECTIONS SHALL CONFORM TO THE APPLICABLE SECTIONS OF THE STANDARD SPECIFICATIONS.
- CONTRACTOR SHALL GIVE ALL PROPERTY OWNERS AND/OR TENANTS AFFECTED BY THE CONSTRUCTION OF THIS PROJECT A MINIMUM OF 24 HOURS ADVANCE NOTICE PRIOR TO START OF CONSTRUCTION.

NOTE: NOTIFY THE FOLLOWING COMPANIES PRIOR TO ANY TRENCHING:

|                       |          |
|-----------------------|----------|
| AVELA COMPANY         | 942-8350 |
| BELL TELEPHONE CO.    | 268-2256 |
| CARLISLE              | 269-3349 |
| GAS SERVICE COMPANY   | 263-7511 |
| KANSAS GAS & ELECTRIC | 261-4375 |
| KAN-TEL               | 267-2889 |

NOTE: ALTERNATE II SPOT REPAIRS SHALL CONSIST OF REMOVING APPROXIMATELY 10± LINEAL FEET OF EXISTING PIPE AND INSTALLING 10± LINEAL FEET OF NEW 6" V.C.P. AT THE FOLLOWING LOCATIONS:

STATION 2 + 37±  
STATION 2 + 97±  
STATION 3 + 26±  
STATION 3 + 77±

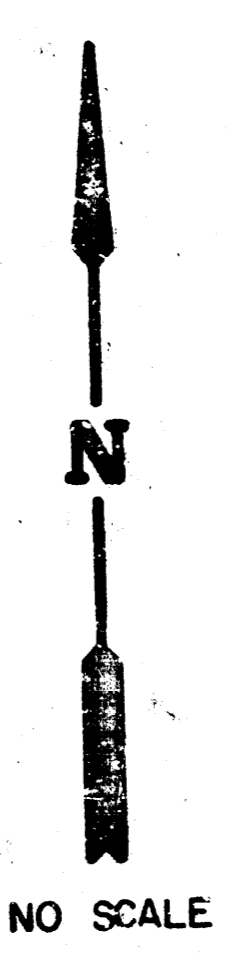
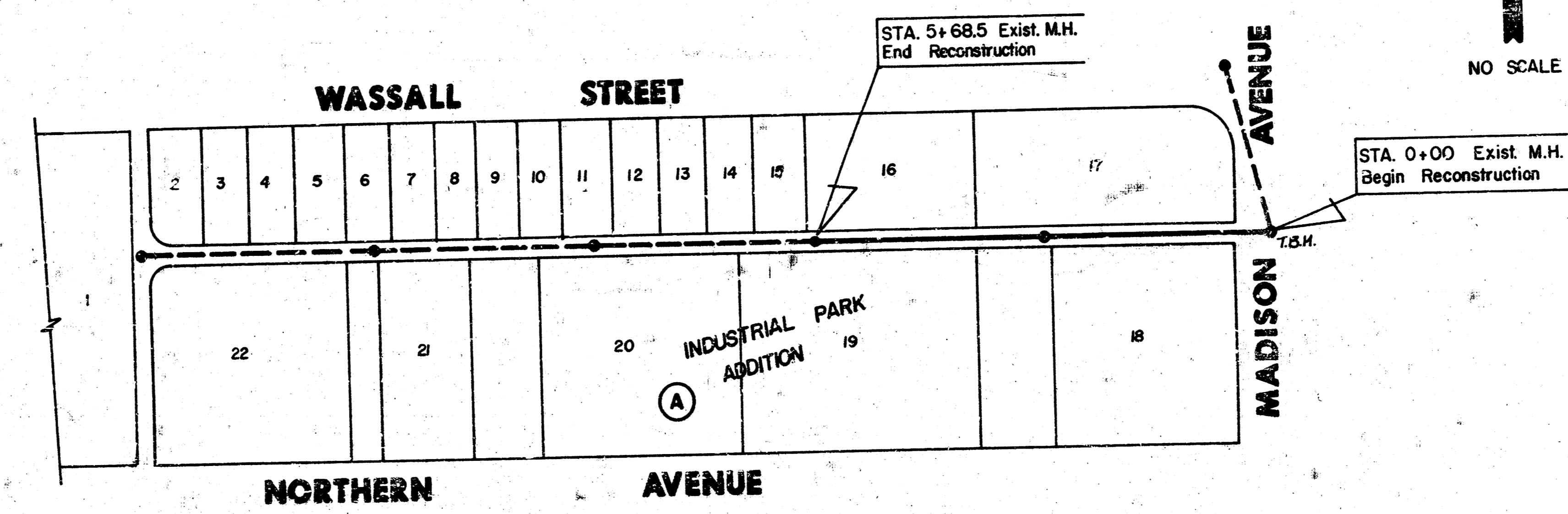

### INDEX TO DRAWINGS

| SHEET NO. | DESCRIPTION      |
|-----------|------------------|
| 1         | TITLE SHEET      |
| 2         | PLAN AND PROFILE |

### BENCH MARKS

- T.B.M #1 - Sta. 0+00 Existing Manhole Rim ELEVATION = 92.90
- B.M #2 - City Sid. Southeast corner Hydraulic 8 Wassall ELEVATION = 93.07



|  |   |   |
|--|---|---|
|  | <b>SANITARY SEWER<br/>RECONSTRUCTION OF A<br/>PORTION OF<br/>LATERAL 32<br/>SANITARY SEWER NO. 20</b> | Design<br>Drawn by<br>Checked by<br>Date<br>Job no. |
|  | MID-KANSAS ENGINEERING CONSULTANTS PA<br>240 NORTH ROCK ROAD<br>SUITE 130<br>WICHITA, KANSAS 67206    | 682-6561  |

RECONSTRUCTION OF A PORTION OF  
LAT. 32 SAN. SEWER NO. 20  
PROJ. NO. 468-76-245-81333-000-001

Handwritten: Built J.L.L. 3/85

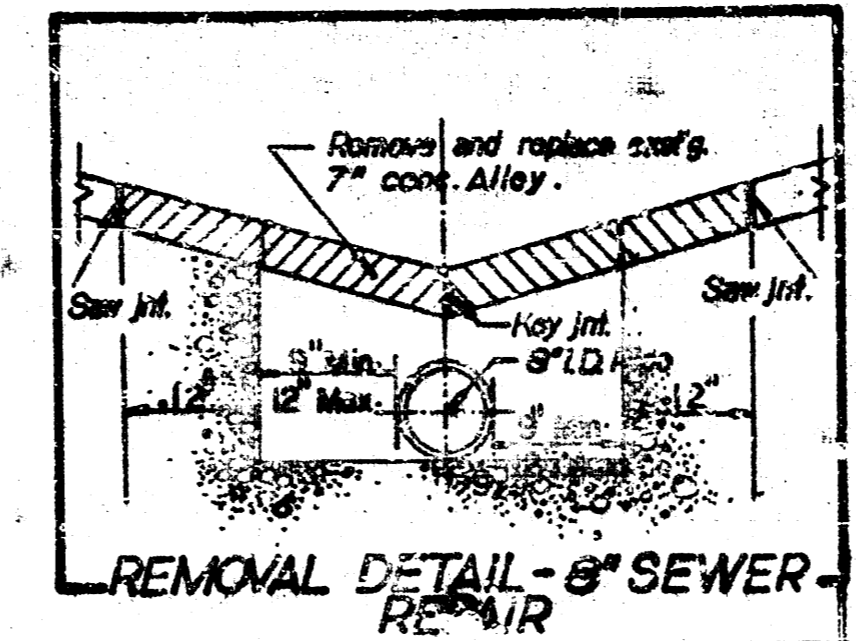
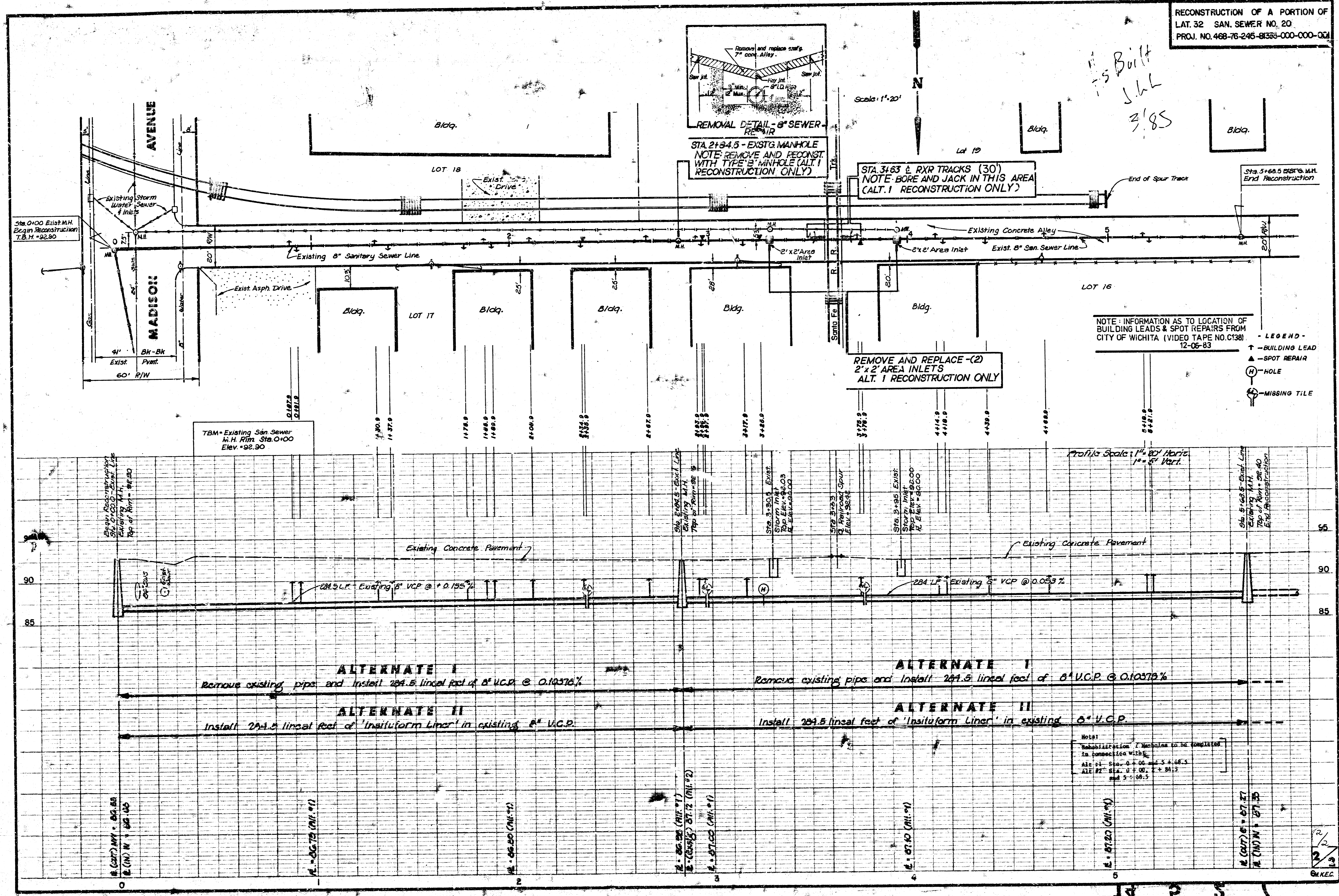

STA. 21+34.5 - EXIST'G MANHOLE  
NOTE: REMOVE AND RECONST.  
WITH TYPE 'B' MANHOLE (ALT. I  
RECONSTRUCTION ONLY)

STA. 31+63 & RXR TRACKS (30')  
NOTE: BORE AND JACK IN THIS AREA  
(ALT. I RECONSTRUCTION ONLY)

REMOVE AND REPLACE -(2)  
2' x 2' AREA INLETS  
ALT. I RECONSTRUCTION ONLY

NOTE: INFORMATION AS TO LOCATION OF  
BUILDING LEADS & SPOT REPAIRS FROM  
CITY OF WICHITA (VIDEO TAPE NO. C138)  
12-05-83

- LEGEND
- ▲ - BUILDING LEAD
  - ▲ - SPOT REPAIR
  - ⊙ - HOLE
  - ⊙ - MISSING TILE

Profile Scale: 1" = 20' Horiz.  
1" = 5' Vert.

Notes:  
Rehabilitation / Methods to be completed  
in connection with:  
ALT. #1 Sta. 0+00 to 5+08.5  
ALT. #2 Sta. 0+08.5 to 34+15  
and 5+08.5

GNKEC