

SANITARY SEWER PLANS
LAT. 46, S.S. NO. 20
PROJECT NO
468-76-245-81497-000-000-001

CITY OF WICHITA KANSAS
MICHAEL E. LINDEBAK, CITY ENGINEER
 DEC. 1985

GENERAL NOTES

1. CONTRACTOR SHALL AVOID UNCOVERING EXISTING WATER LINES UNLESS ABSOLUTELY NECESSARY. UNCOVERING SHALL BE DONE ONLY IN THE PRESENCE OF A WATER DEPARTMENT ENGINEER.
2. THE CONTRACTOR SHALL BE RESPONSIBLE FOR PRESERVING PROPERTY IRONS. THE CONTRACTOR SHALL BE REQUIRED TO RE-ESTABLISH ANY PROPERTY IRONS WHICH ARE DAMAGED OR DESTROYED BY HIS CONSTRUCTION OPERATIONS. SUCH IRONS SHALL BE RE-ESTABLISHED BY A LICENSED LAND SURVEYOR OR A LICENSED PROFESSIONAL ENGINEER IN ACCORDANCE WITH STATE LAWS.
3. CONTRACTOR SHALL NOTIFY THE UTILITY COMPANIES OF CONSTRUCTION SCHEDULING.
4. EXISTING UTILITIES AND THEIR LOCATIONS, AS SHOWN ON THE PLANS, REPRESENT THE BEST INFORMATION OBTAINABLE FOR DESIGN. LOCATION INFORMATION HAS BEEN OBTAINED FROM THE VARIOUS UTILITY COMPANIES AND IS EITHER FROM COMPANY RECORD DRAWINGS OR COMPANY PROVIDED FIELD LOCATIONS. THE PLAN LOCATIONS SHOWN ARE NOT GUARANTEED. ADDITIONAL EXISTING UTILITIES MAY ALSO BE ENCOUNTERED.
5. COST OF SEEDING AND MULCHING SHALL BE SUBSIDIARY TO PROJECT.

NOTE: NOTIFY THE FOLLOWING COMPANIES PRIOR TO ANY EXCAVATION:

BELL TELEPHONE COMPANY	268-2256
CABLEVISION	262-0661
GAS SERVICE COMPANY	263-7511
KANSAS GAS & ELECTRIC	261-6248
KANSAS ONE-CALL	1-800-344-7233

INDEX TO DRAWINGS

SHEET NO.	DESCRIPTION
1	TITLE & LOCATION
2	PLAN & PROFILE

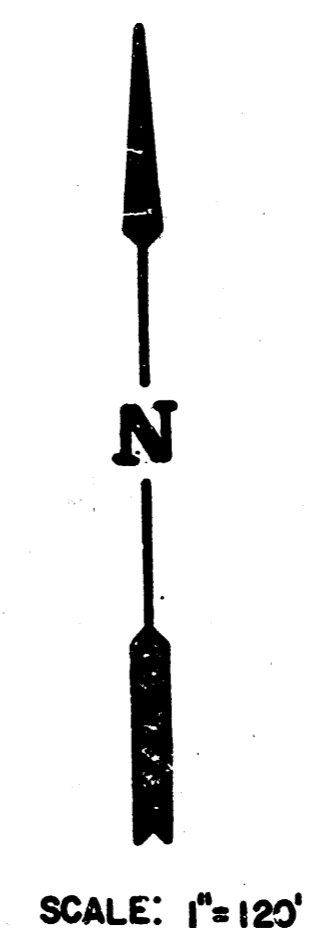
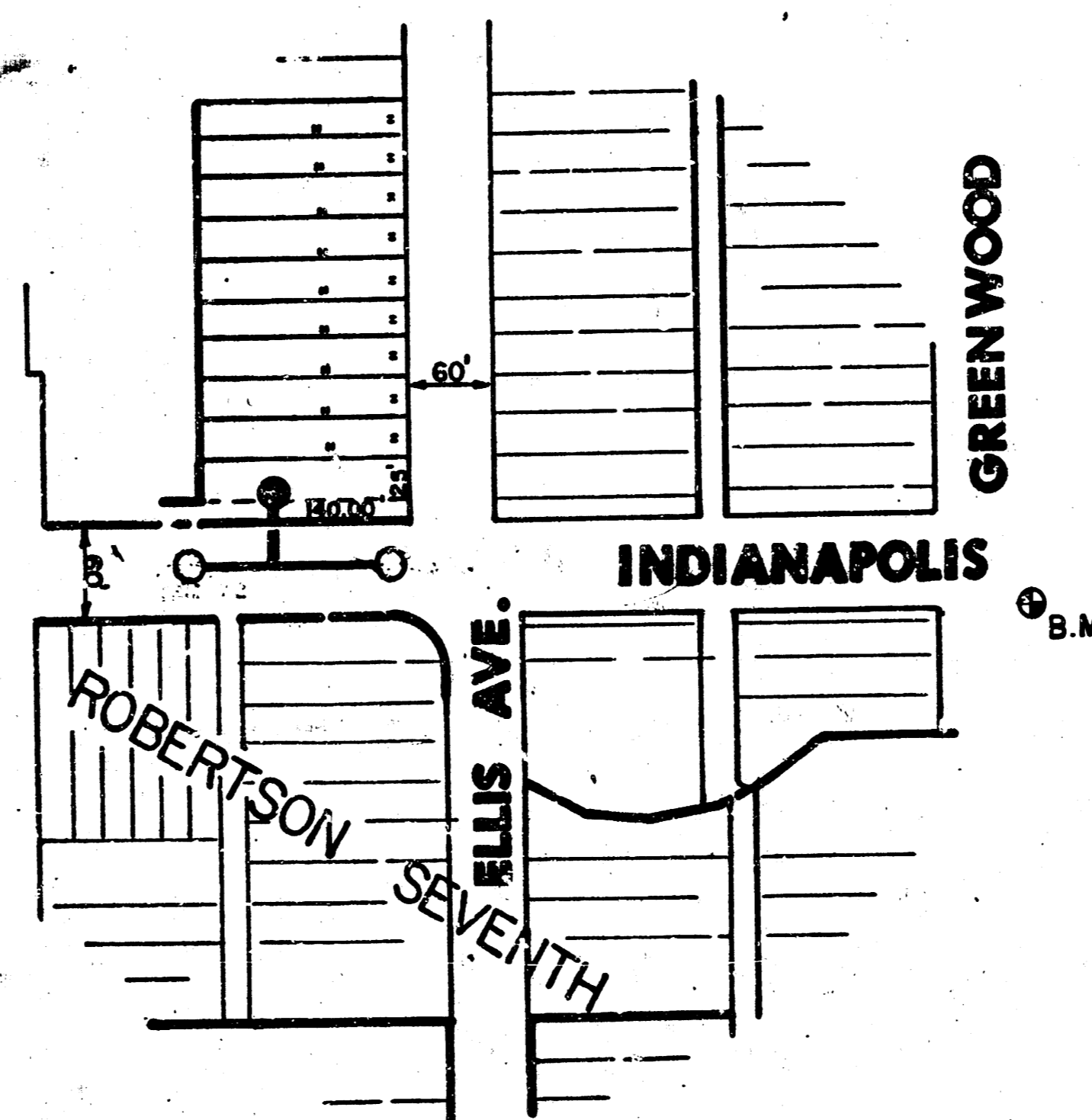

BENEFIT DISTRICT:

The east 70 feet of Lot 63 and the east 70 feet of the north 10.33 feet of Lot 65 on Ellis Avenue in New York 2nd Addition.

BENCH MARKS

B.M. 103.44 "6" IN GLOR. ON 725' CURB IN SIDEWALK
 EL GREENWOOD - SS. INDIANAPOLIS

*AS BUILT
 3-18-86
 RDL*

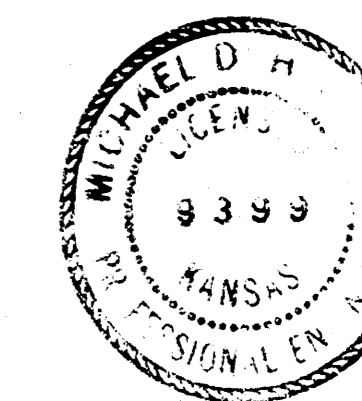

MK EL	SANITARY SEWER EXTENSION	Design
	LAT. 46 S.S. NO 20	Drawn by
		Checked by
		Date
		Job no.
MID-KANSAS ENGINEERING CONSULTANTS PA 3500 NORTH ROCK ROAD BUILDING #900 WICHITA, KANSAS 67226		Sheet 1 of 2
682-6561		

FILMED FROM THE BEST AVAILABLE COPY.....

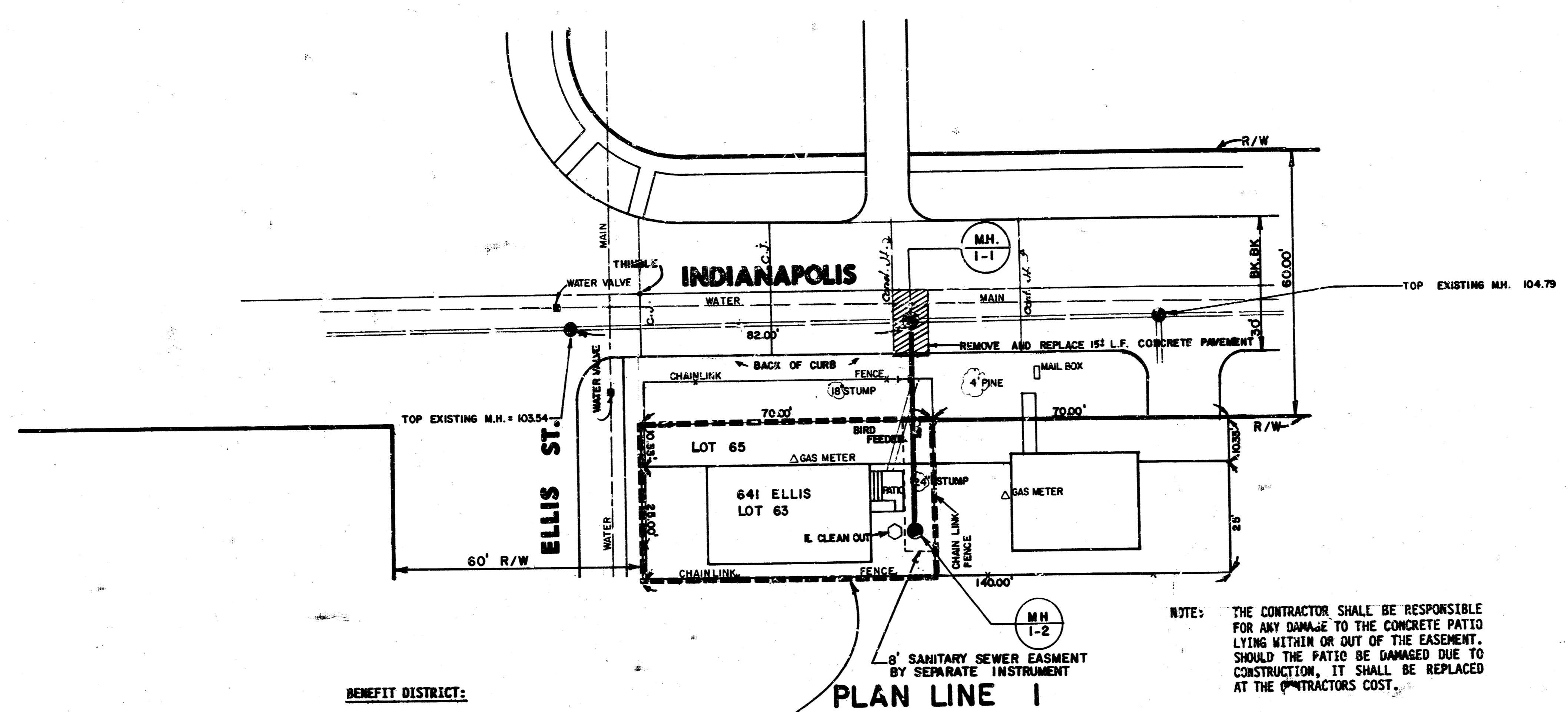

BENEFIT DISTRICT:
 The east 70 feet of Lot 63 and the east 70 feet of the north 10.33 feet of Lot 65 on Ellis Avenue in New York 2nd Addition.

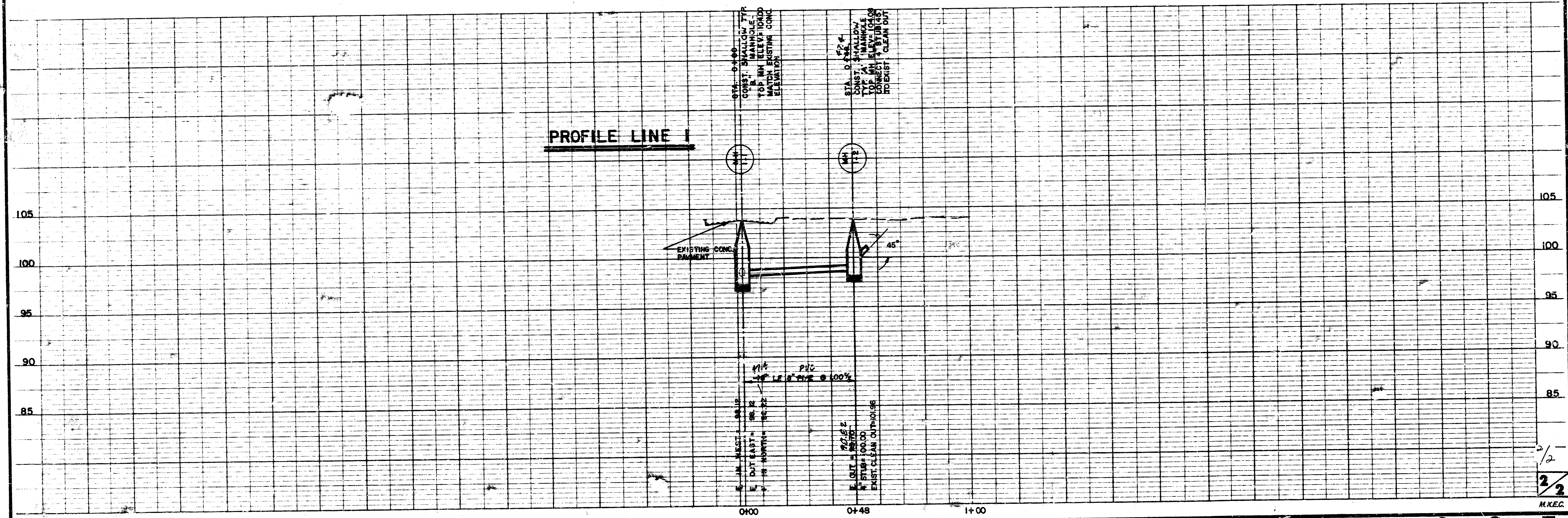
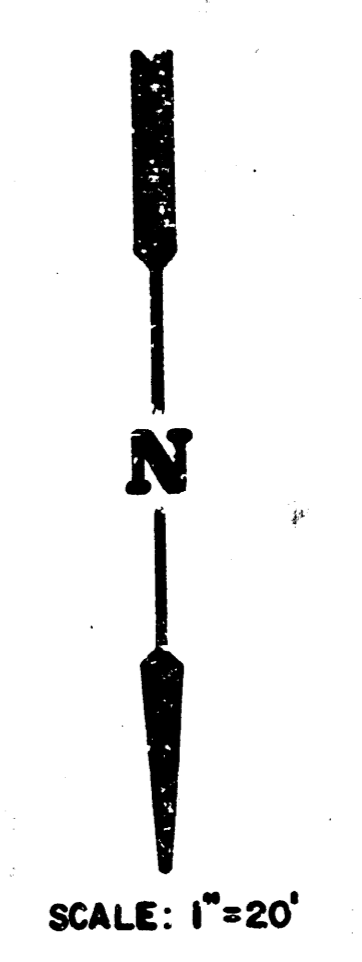

10 2 3 5