

3  
8

ELLIS

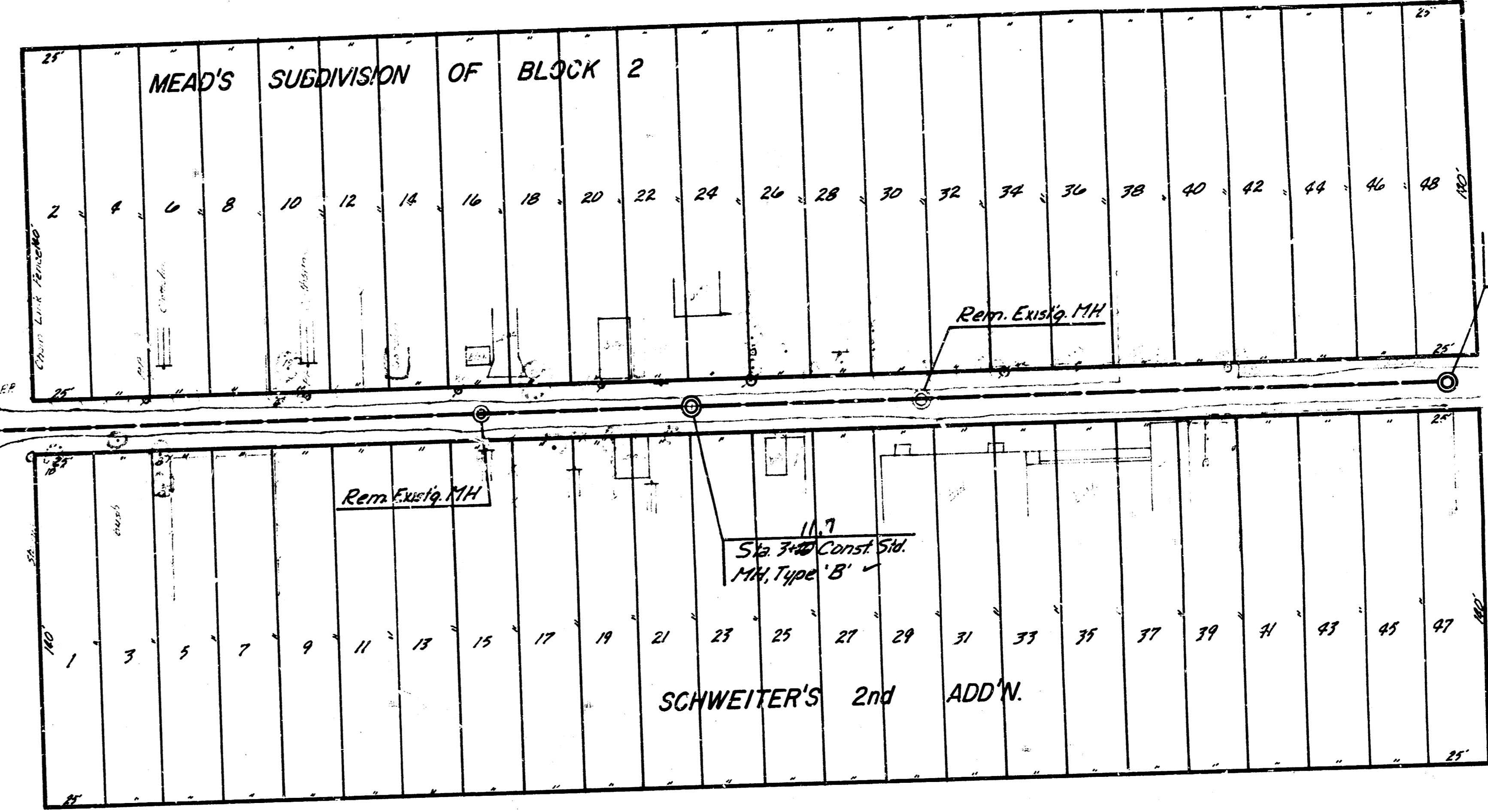

NOTE: CONTRACTOR'S METHOD FOR HANDLING SEWAGE FLOWS DURING CONSTRUCTION OF THIS PROJECT SHALL BE APPROVED BY THE ENGINEER. CONTRACTOR WILL BE REQUIRED TO OBTAIN PERMITS FROM PUBLIC WORKS ADMINISTRATION BEFORE RECONNECTING BUILDING SERVICE LINES. PERMIT FEE WILL BE WAIVED. BID ITEM FOR SERVICE CONNECTIONS SHALL COVER ALL COSTS FOR FURNISHING AND INSTALLING SADDLE INCLUDING TAPPING FEE. PIPE TAPS ARE TO BE MADE BY CITY MAINTENANCE DEPARTMENT PERSONNEL UNLESS APPROVED OTHERWISE BY THE ENGINEER. ONLY ACTIVE BUILDING SANITARY SEWER LINES ARE TO BE RECONNECTED TO THE NEW SEWER. CONTRACTOR SHALL VERIFY WHICH LINES ARE ACTIVE. EVERY BUILDING SEWER RECONNECTED TO THE NEW SEWER SHALL BE TRAPPED. CLEAN OUTS SHALL BE INSTALLED WITH THE TRAPS. CLEAN OUTS SHALL BE CLASS 50-CAST IRON PIPE AND WILL BE PAID FOR AT THE UNIT PRICE BID PER LINEAL FOOT OF CAST IRON PIPE. LOCATION OF TRAPS AND CLEAN OUTS SHALL BE AS APPROVED BY THE ENGINEER.

CONTRACTOR SHALL GIVE ALL PROPERTY OWNERS AND TENANTS AFFECTED BY THE CONSTRUCTION OF THIS PROJECT A MINIMUM OF 24 HOURS ADVANCE NOTICE PRIOR TO START OF CONSTRUCTION.

Contractor to Contact Utility Companies for Location of any Underground Lines.

GREENWOOD

B.M. 102.26 N.E. Cor. Conc. Pump Island E Side Amoco Station Harry & Hydraulic.

SCALE  
Plan 1"=40'  
Profile Vert 1"=4'  
Vert 1"=5'

NOTE: ALL 4" AND 6" SEWER CONSTRUCTION SHALL CONFORM TO THE APPLICABLE SECTIONS OF THE CITY OF WICHITA CODE.

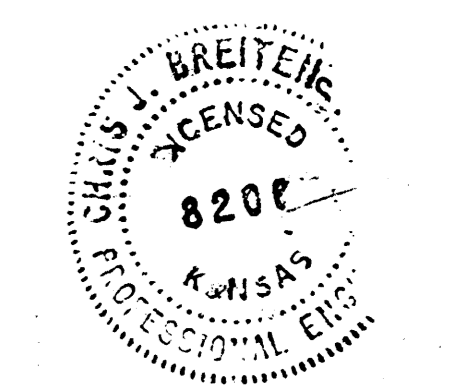
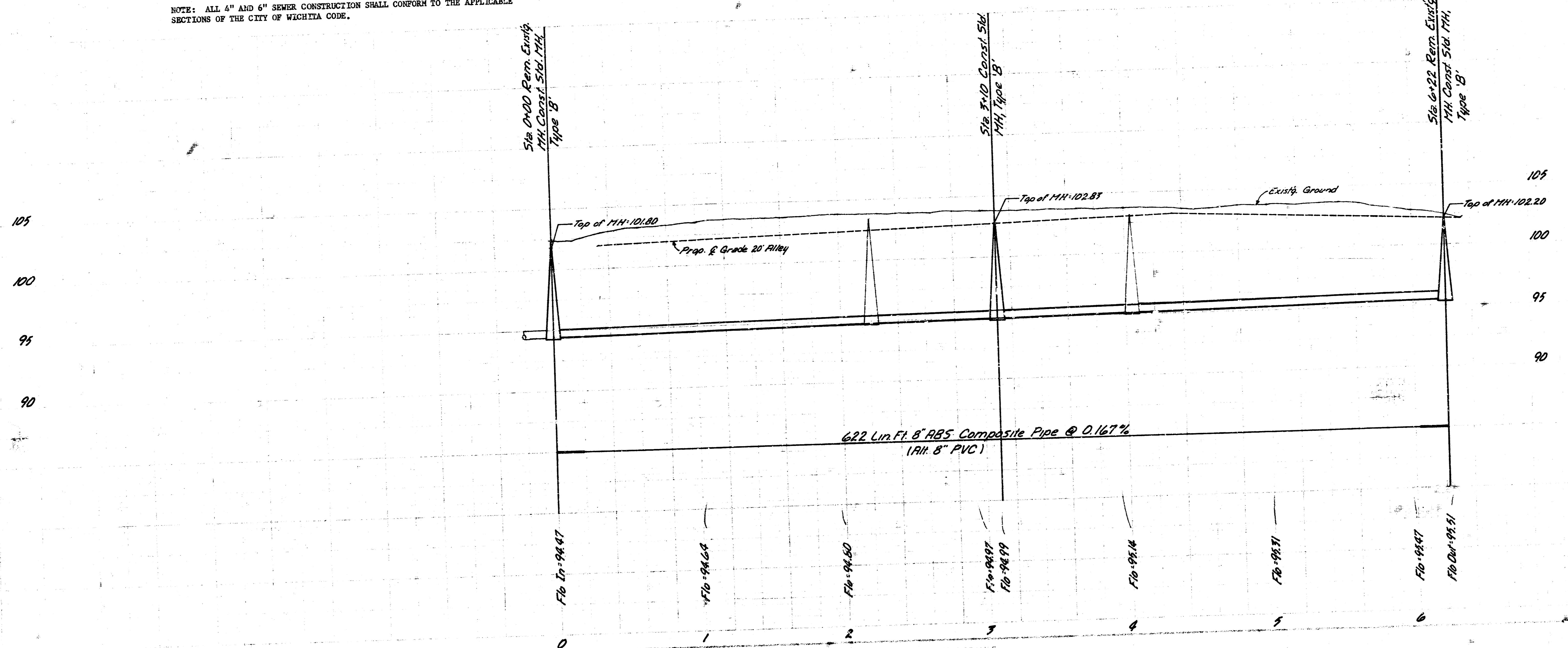

As Built 12/80  
J.R.  
B-136

Reconst. a Portion of Lot 6, Dist. C, S.S. # 20 in the Alley between Ellis & Greenwood from Osie to Harry  
542-80-245-30007-000-0001  
CITY of WICHITA, KANSAS  
DEPT. of PUBLIC WORKS-ENG. DIV.  
DEAN S. SELLERS-Act. City Engineer  
DATE \_\_\_\_\_