

LAT. 22, DIST. C, SS #20

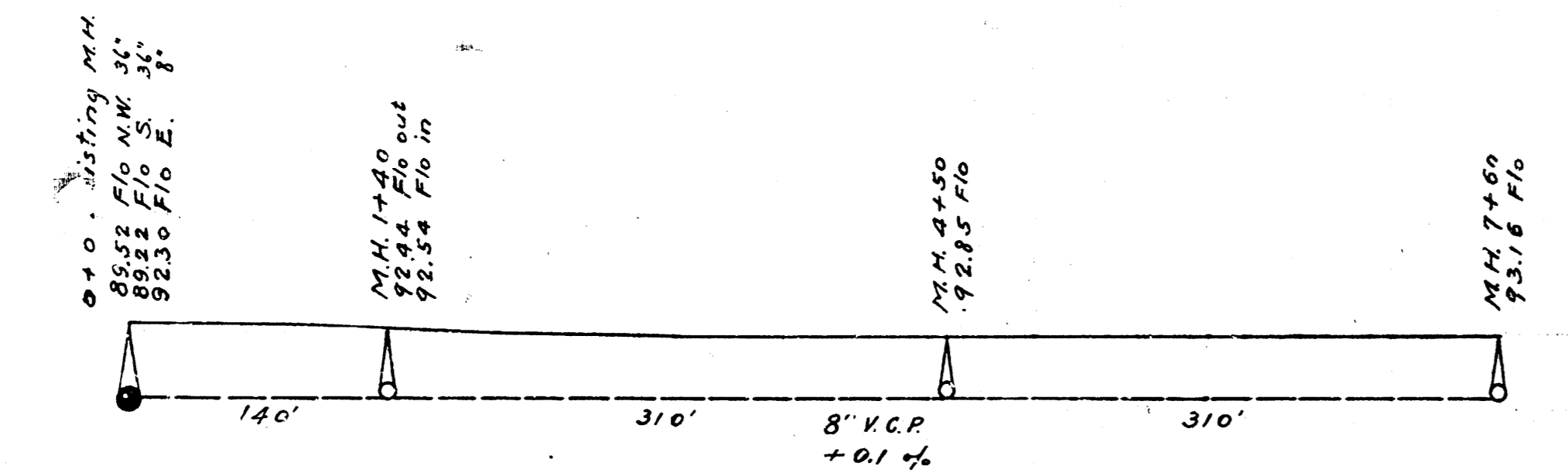

BM 100.32 X on coping lug N.W. cor Gold & Levy
 BM 101.97 Step bench 1st P Pole N. of Levy & W.S. of Silver N.
 BM 100.31 N.W. of end of walk E., S.E. cor Silver & Skinner

Lat 22, SS #20

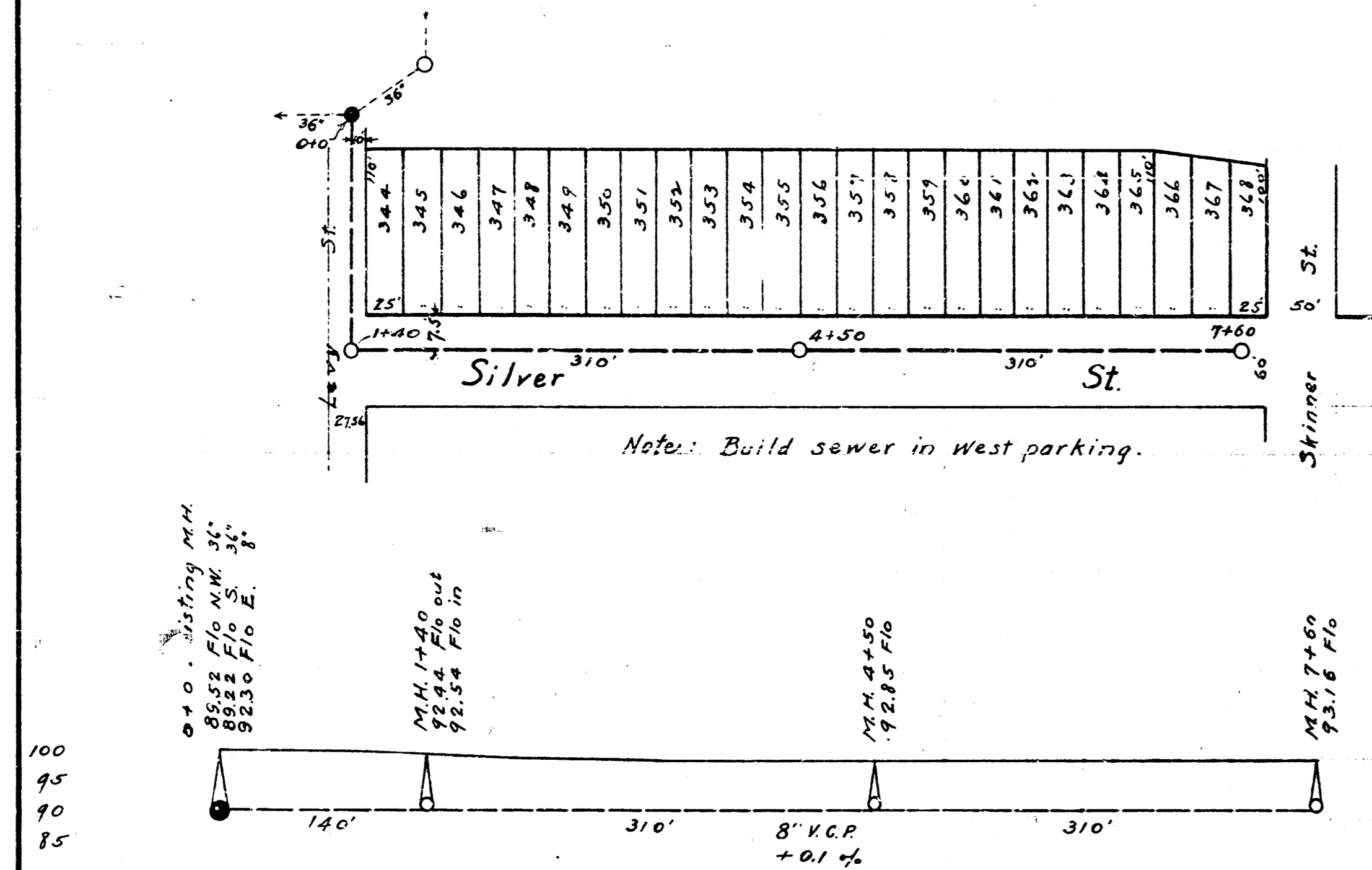
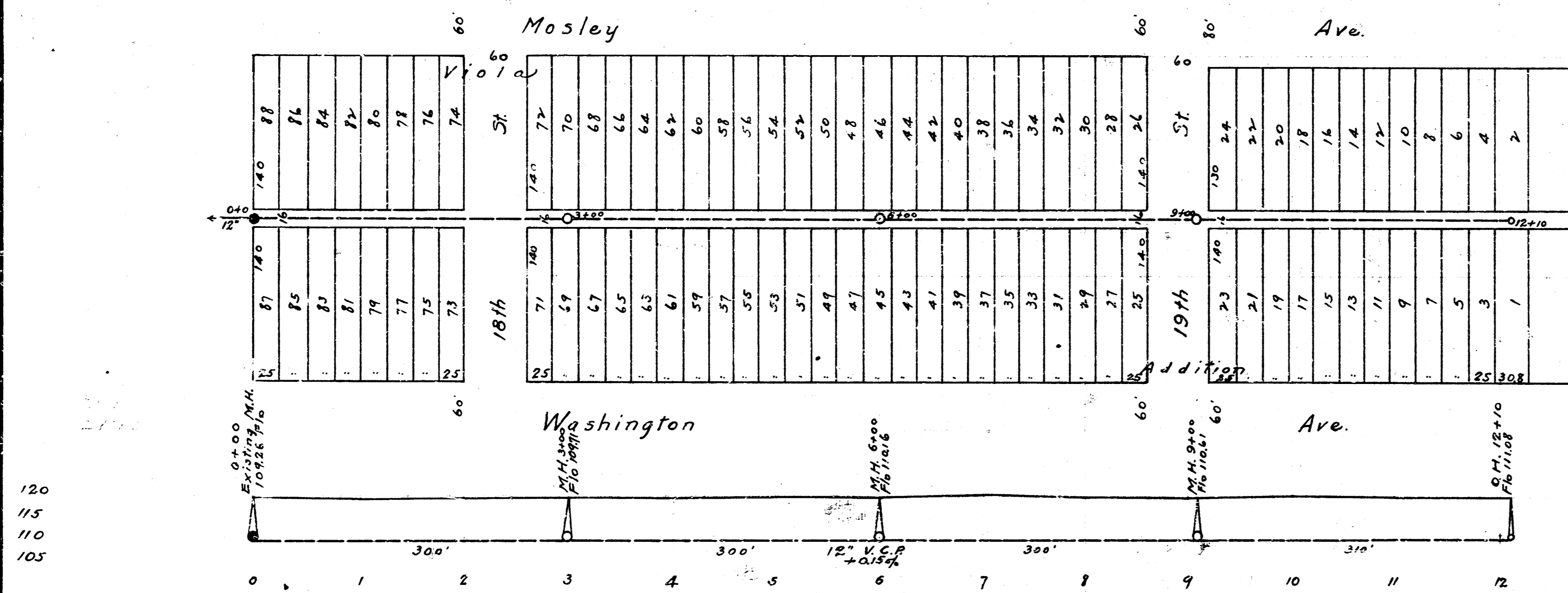

BM 11888 X in Keeler on push block S, N.E. cor Mosley & 17th.
 BM 12040 P.R. & Alley, Step bench in P.P. 35. of 19th bet Wash. & Mosley.

CITY OF WICHITA, KANSAS
 PUBLIC SERVICE DEPARTMENT
 ENGINEERING DIVISION
 L.K. WHITE, CITY ENGINEER
 DR. BY C.H. MILLS AUG. 1945