

LATERAL '1' DISTRICT 'C'
SANITARY SEWER No. 20

LAT. 16 - DIST. 'A'
S.S. No. 12

LAT 17 - DIST. A.
S.S. No 12

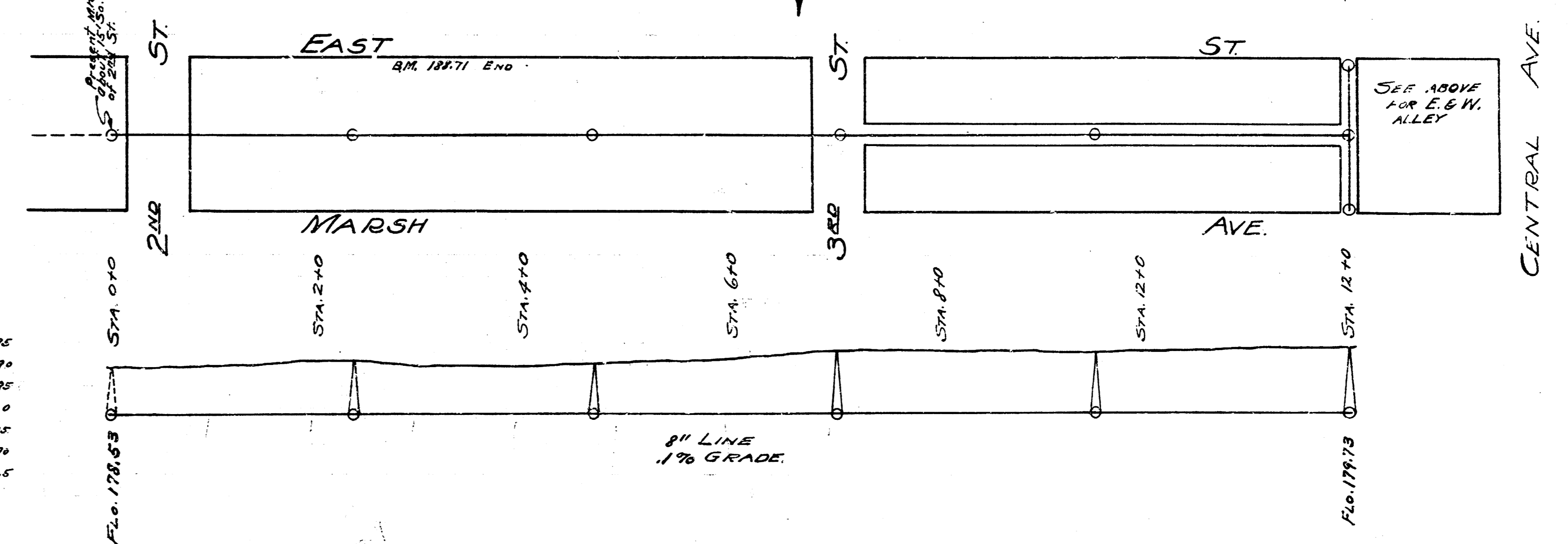
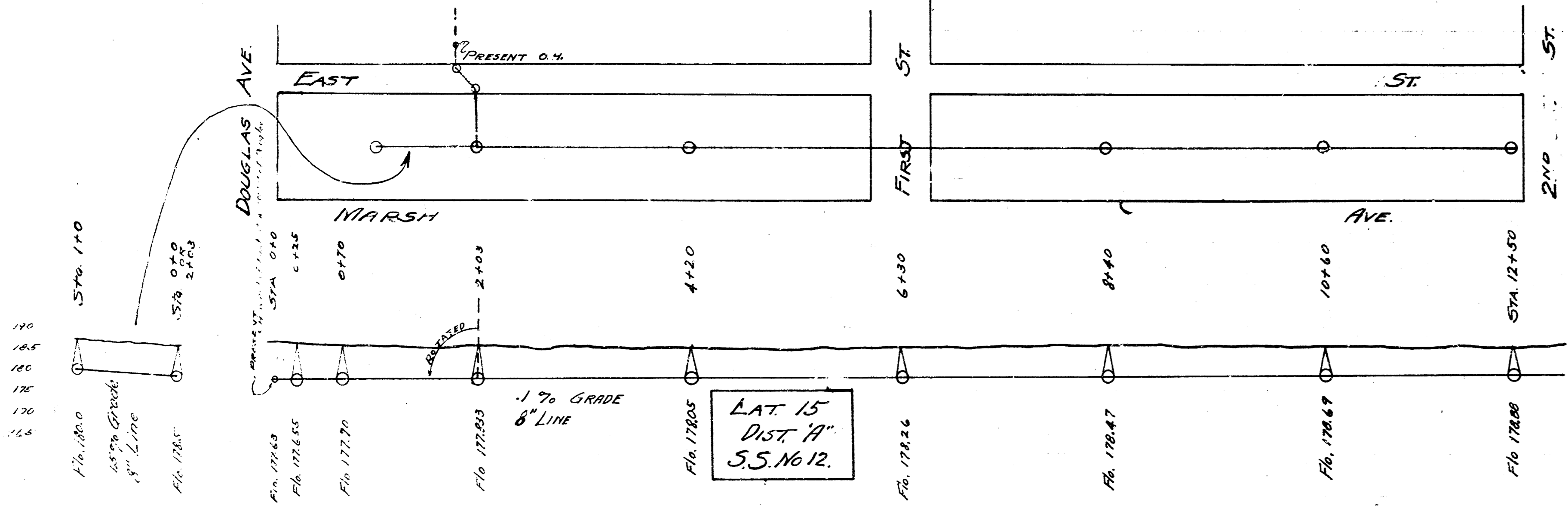

LAT 15
DIST. 'H'
S.S. No. 12

LAT. 2.
DIST. N-O.
S.S. No. 20.

DIST. 1 S.S. No. 20.

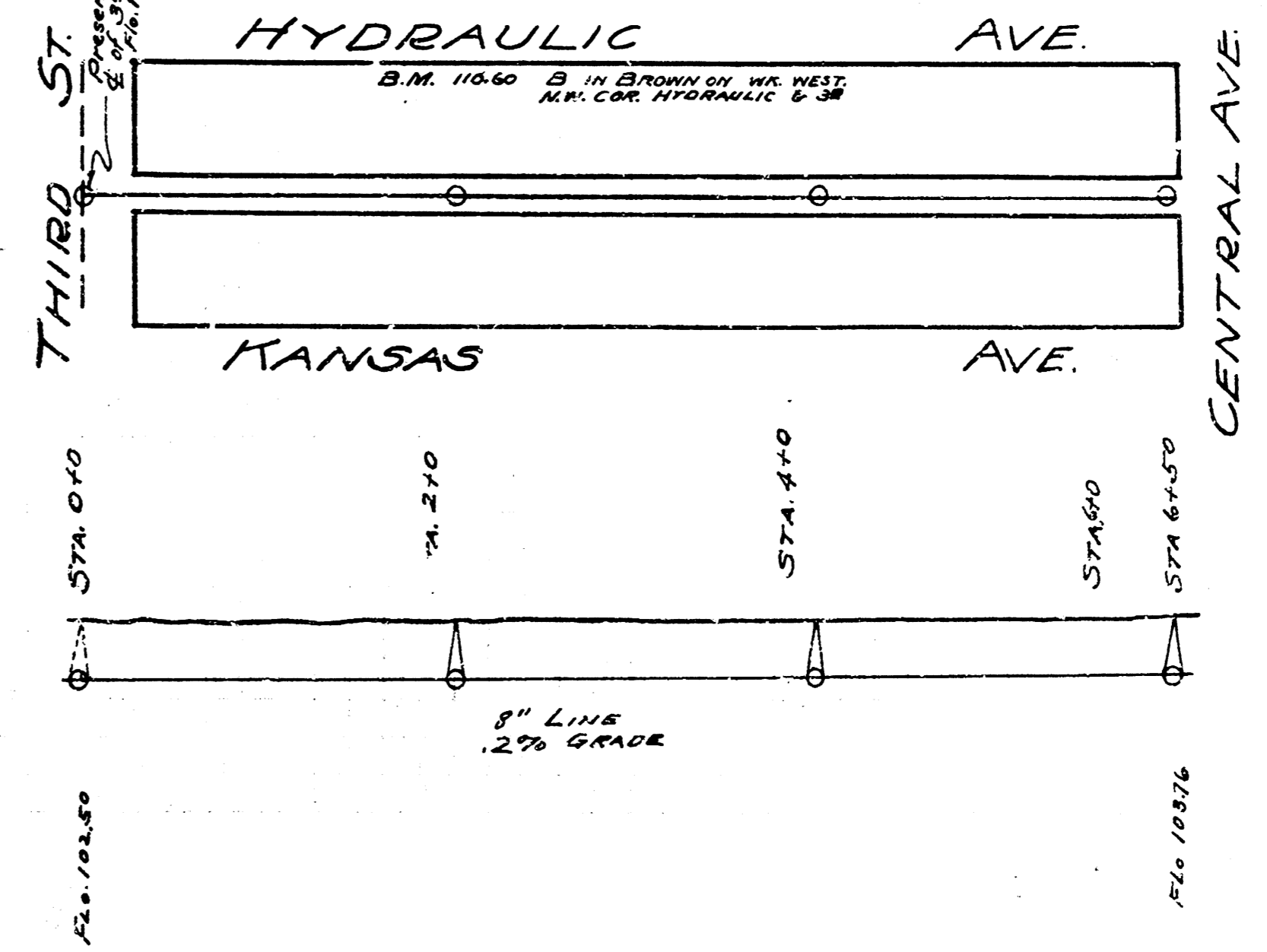

Print to right of this line only