

Denker St.									
1	2	3	4	5	6	7	8	9	10
11	12	13	14	15	16	17	18	19	20
21	22	23	24	25	26	27	28	29	30
31	32	33	34	35	36	37	38	39	40
41	42	43	44	45	46	47	48	49	50
51	52	53	54	55	56	57	58	59	60
61	62	63	64	65	66	67	68	69	70
71	72	73	74	75	76	77	78	79	80
81	82	83	84	85	86	87	88	89	90
91	92	93	94	95	96	97	98	99	100

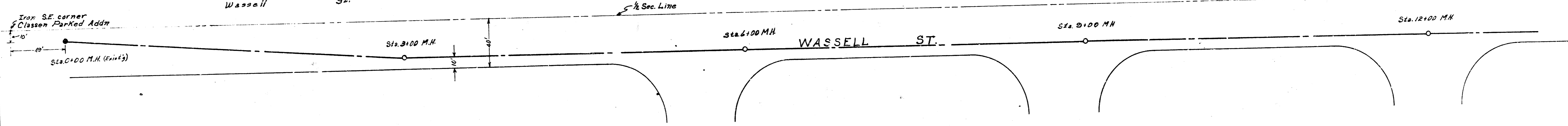

B.M. 9431 So. rim of M.H. Sta. 0+00

Sta. 0+00 (Existing M.H. on 60' width)
81.55' H. and Group

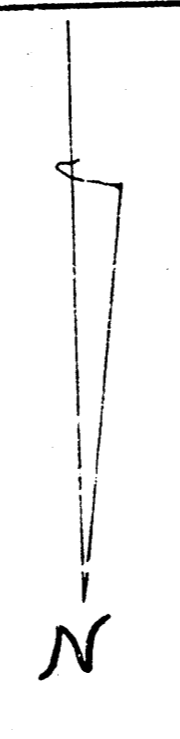
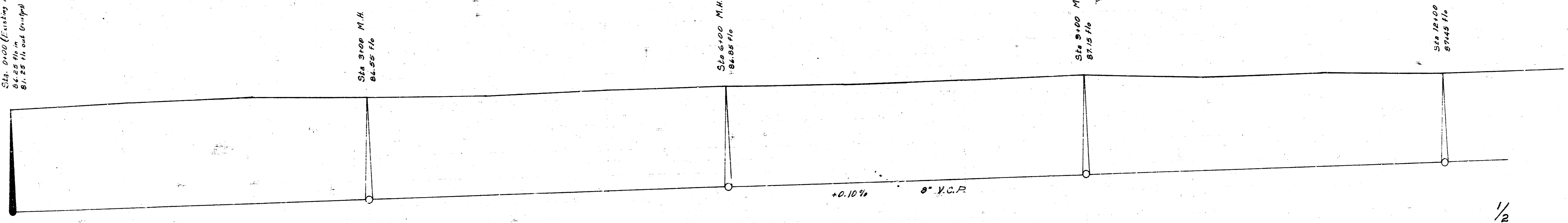

0+00 1+00 2+00 3+00 4+00 5+00 6+00 7+00 8+00 9+00 10+00 11+00 12+00 13+00

Submain Z, SS #20
City of Wichita, Kansas
L. White City Engineer
March 1951 Proj. No. C21-B

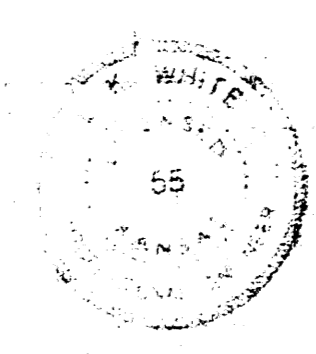

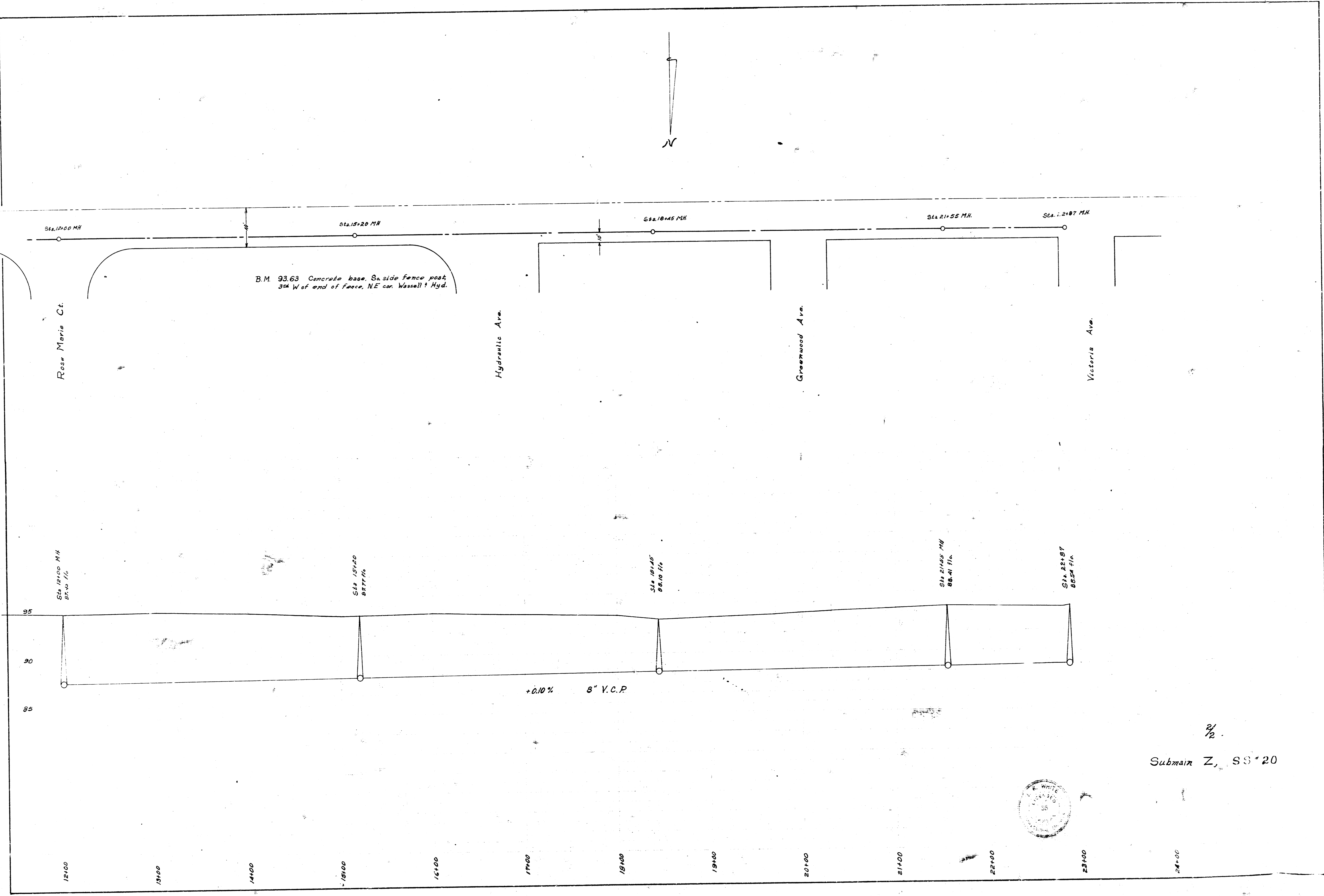

2/2
 Submain Z, SS*20

