

Survey City Mills, November 1951  
 City of Wichita  
 Date August 1955

B.M. 104.112 STD SE GLENN & MAY  
 B.M. 104.30 "G" IN GLOBE S Co DORA, N END RAD, W EUCLID

PLAN SCALE 1" = 40'  
 PROFILE SCALE 1" = 40' HOR. 1" = 4' VERTICAL

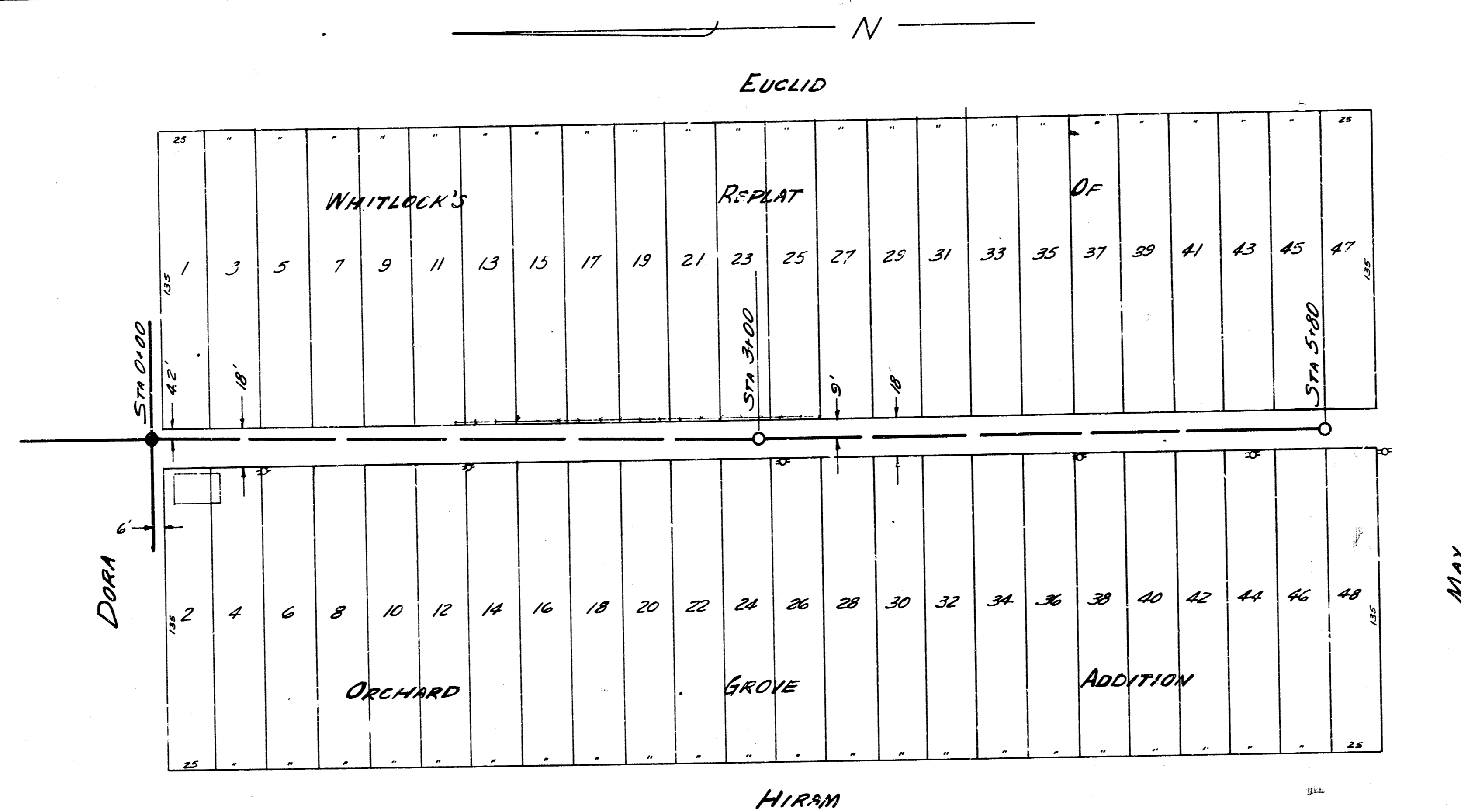

NOTE  
 The south side of the rampole  
 floor is el. 99.80. The floor must  
 be reshaped to the east with  
 the new line coming in from the  
 south at el. 99.58. The cost of  
 reshaping the floor shall be  
 included in the bid price per  
 lin. ft. of 8" Y.C.P.

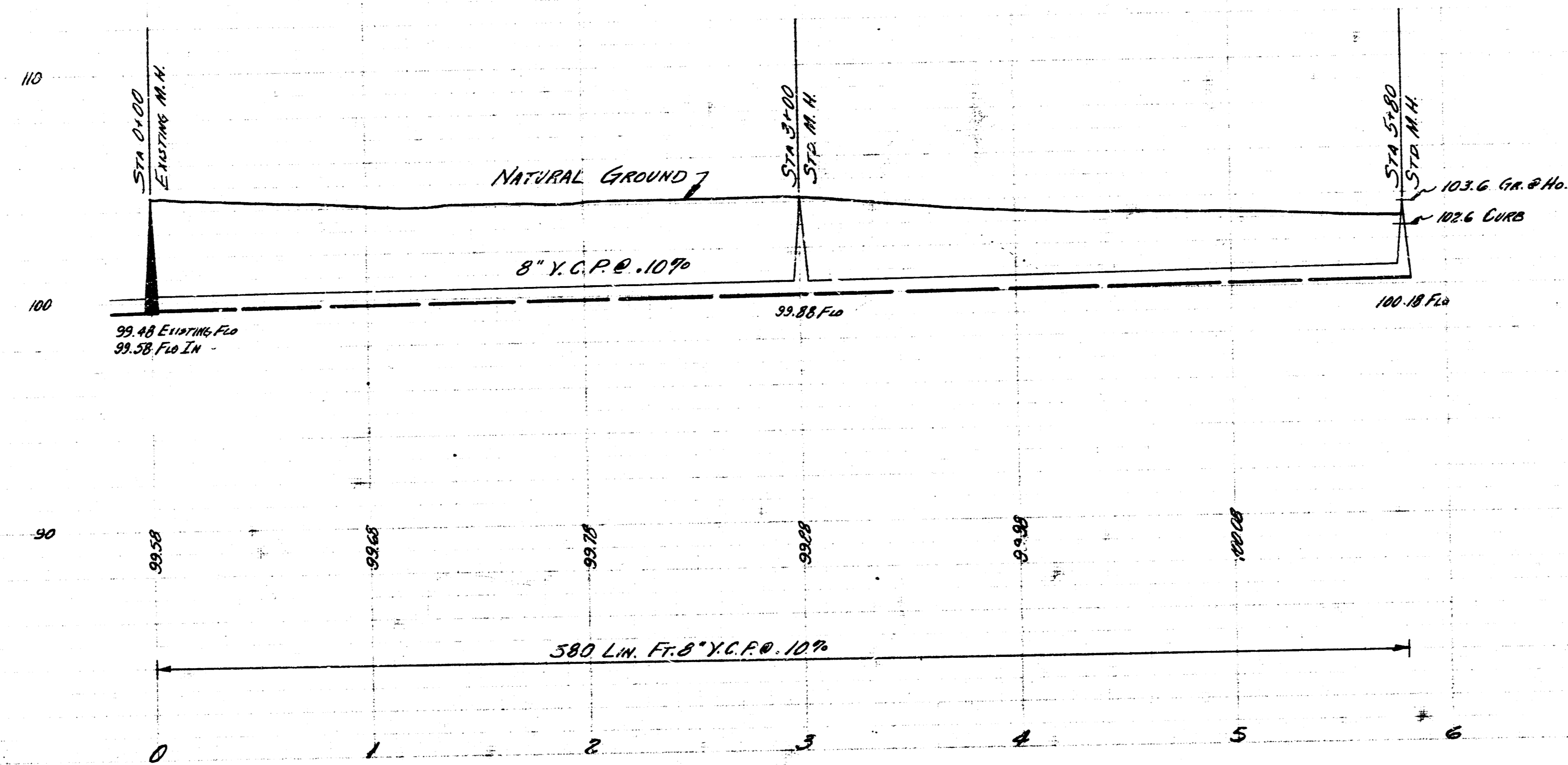

LAT. 6 DIST. E. SS. 21

CITY OF WICHITA

B.E. SMITH CITY ENGINEER

APR. 1955 PROJ. No. C25-53

