

**Benchmarks**

BM #1: "□" Cut in Top of Curb at Northwest Corner of Parking Lot, Lot 7, Block A, St. Peter the Apostle Catholic Church 2nd Addition.  
Elev. = 150.34 (City Datum)

BM #2: "□" Cut in E of Curb Inlet Top Adjacent to Northeast Corner of Lot 17, Block C, Harvest Ridge Addition  
Elev. = 145.89 (City Datum)

BM #3: "+" Cut in E of Curb Adjacent to Southwest Corner of Tract "H" Block A, Harvest Ridge Addition  
Elev. = 148.67 (City Datum)

Scale: 1" = 20'  
• = Iron

Scale: 1" = 20'  
• = Iron

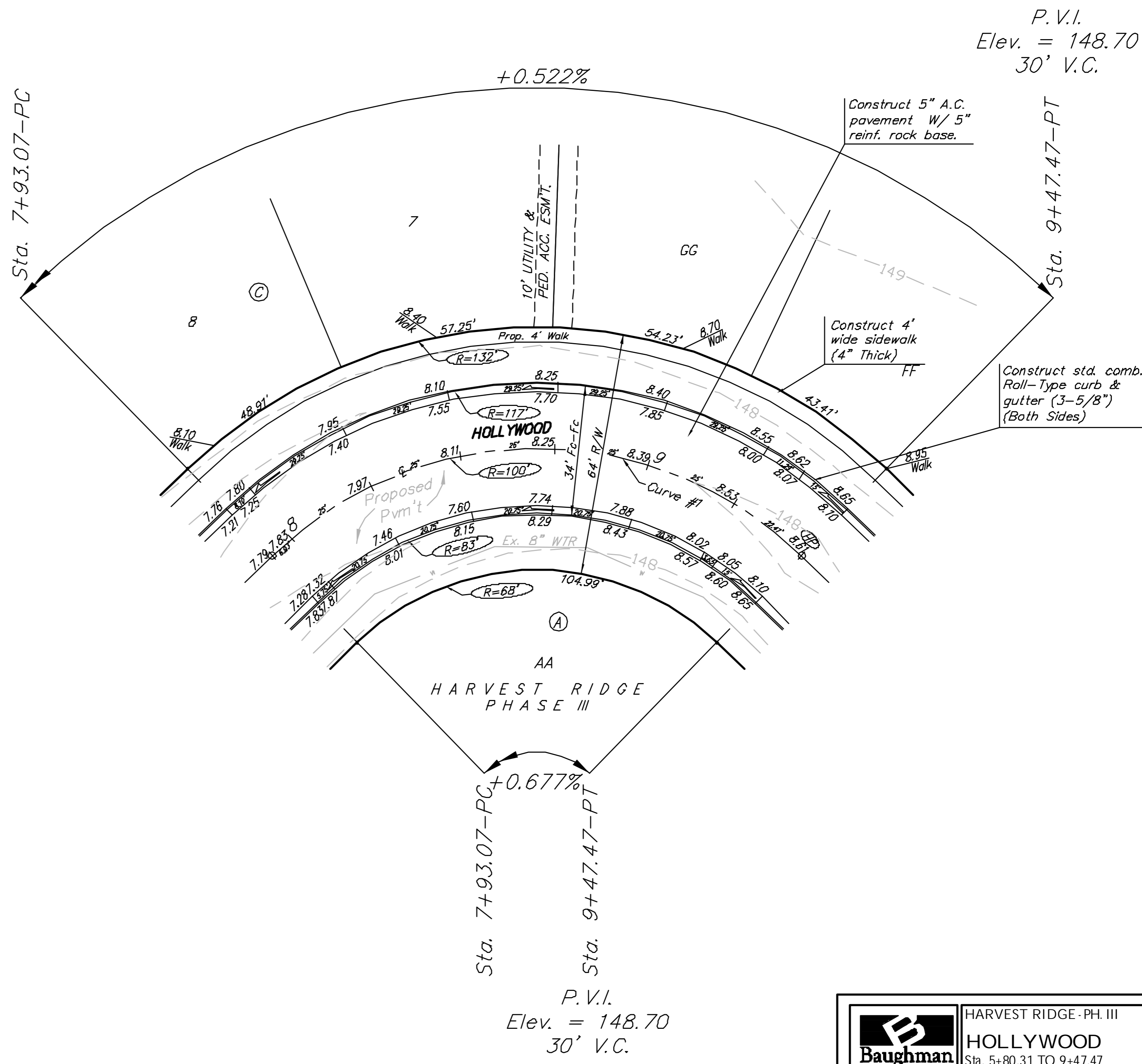
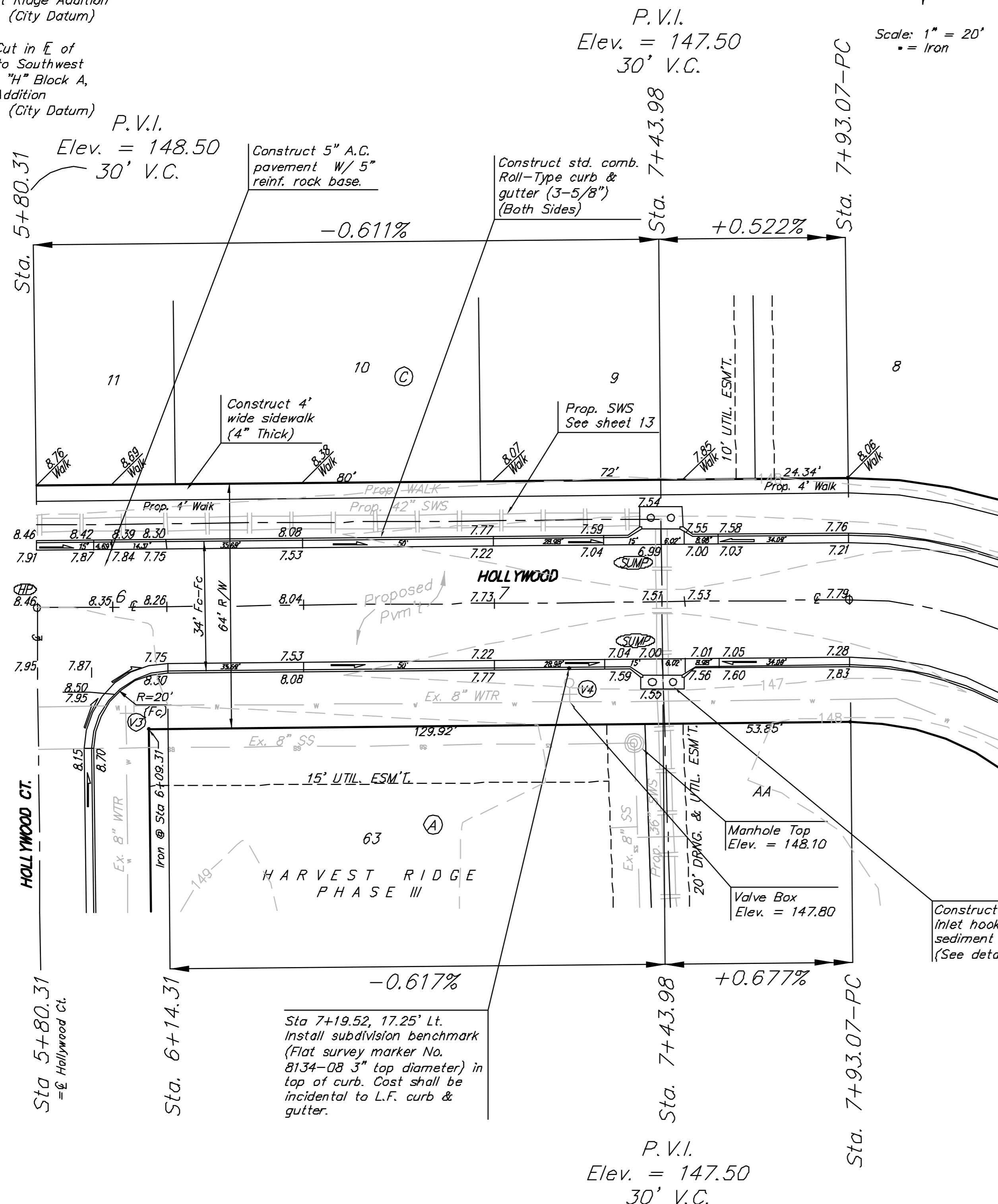

**VALVE LOCATION TABLE**

| VALVE NUMBER | BASELINE STATION | OFFSET DISTANCE | OFFSET DIRECTION |
|--------------|------------------|-----------------|------------------|
| 4            | 7+19.52          | 26              | Rt.              |

Paving contractor will be responsible to operate all water valves on the project, in the presence of the inspector, to ensure accessibility to the valves, and that all valves are left in the "ON" position when the project is completed.

Note:  
Contours shown represent the site after Mass Grading has been completed. Cross sections are based on the site after Mass grading

NOTE:  
ROLL TYPE CURB & GUTTER TO BE CONSTRUCTED ON THE PAVEMENT SHOWN ON THIS SHEET. TOP OF CURB ELEVATIONS ARE GIVEN FOR FULL HEIGHT CURB.

|   |                                      |
|---|--------------------------------------|
|   | HARVEST RIDGE - PH. III              |
|   | HOLLYWOOD<br>Sta. 5+80.31 TO 9+47.47 |
| Baughman Company, P.A. 315 Main St., Waltham, MA 02451 P: 617-251-7771 F: 617-251-7772<br>ENGINEERING   SURVEYING   PLANNING   LANDSCAPE ARCHITECTURE |                                      |
| PROJECT NUMBER<br>47283807  | DESIGN<br>MWS<br>APPROVED<br>MWS     |
| DRAWN<br>JRW<br>DATE<br>3/24/08   | SCALE<br>Noted<br>SHEET<br>7 OF 38   |
| E:\Harvest Ridge\Phase 3\STRV06-11_STR.dwg 06/12/08   |                                      |