

Benchmarks

BM #1: "□" Cut in Top of Curb at Northwest Corner of Parking Lot, Lot 1, Block A, St. Peter the Apostle Catholic Church 2nd Addition.
Elev. = 150.34 (City Datum)

BM #2: "□" Cut in E of Curb Inlet Top Adjacent to Northeast Corner of Lot 17, Block C, Harvest Ridge Addition.
Elev. = 145.89 (City Datum)

BM #3: "+" Cut in E of Curb Adjacent to Southwest Corner of Tract "H" Block A, Harvest Ridge Addition.
Elev. = 148.67 (City Datum)

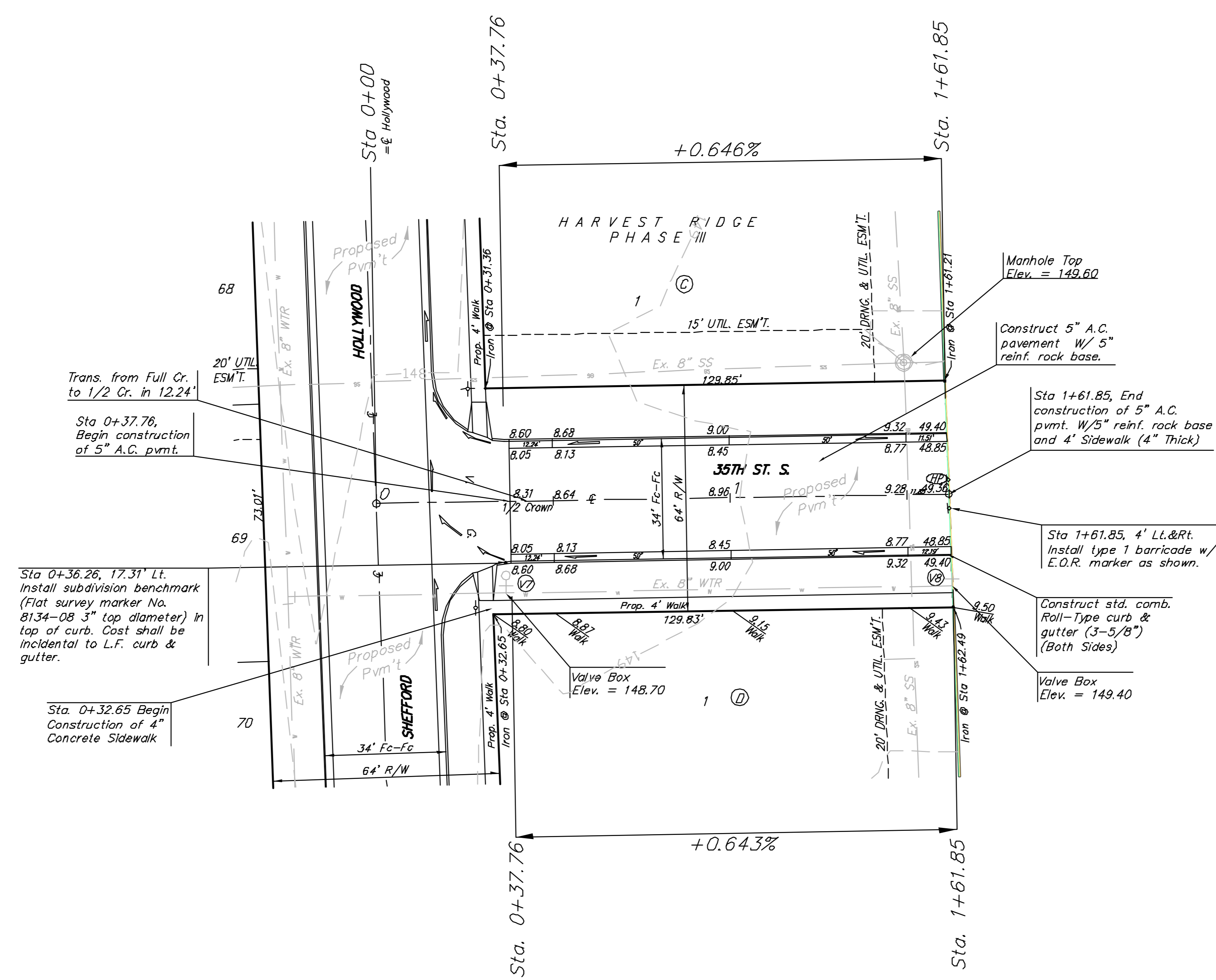
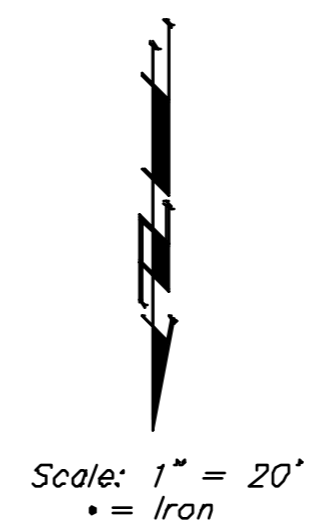

Trans. from Full Cr. to 1/2 Cr. in 12.24'
Sta 0+37.76, Begin construction of 5" A.C. pvmt.

Sta 0+36.26, 17.31' Lt. Install subdivision benchmark (Flat survey marker No. 8134-08 3" top diameter) in top of curb. Cost shall be incidental to L.F. curb & gutter.

Sta. 0+32.65 Begin Construction of 4" Concrete Sidewalk

Manhole Top Elev. = 149.60

Construct 5" A.C. pavement W/ 5" reinf. rock base.

Sta 1+61.85, End construction of 5" A.C. pvmt. W/ 5" reinf. rock base and 4' Sidewalk (4" Thick)

Sta 1+61.85, 4' Lt.&Rt. Install type 1 barricade w/ E.O.R. marker as shown.

Construct std. comb. Roll-Type curb & gutter (3-5/8") (Both Sides)

Valve Box Elev. = 149.40

Subdivision Bench Marks

Street & Station	Location Description	Elevation
Hollywood (_____) 7+19.52, 26' Rt.	Adjacent to Fire Hydrant Between Lots 63 and AA, Block A.	
35th St. S. 0+36.26, 26' Rt.	Adjacent to Fire Hydrant at NW End of W Curb Return of 35th St S and Sheffield.	
Hollywood Ct 2+01.03, 23' Rt.	Adjacent to Fire Hydrant Between Lots R and Q, Block A.	
Hollywood Ct (_____) 2+01.16, 23' Rt.	Adjacent to Fire Hydrant Between Lots Y and Z, Block A.	

VALVE LOCATION TABLE

VALVE NUMBER	BASELINE STATION	OFFSET DISTANCE	OFFSET DIRECTION
7	0+36.26	26	Rt.
8	1+62.37	26	Rt.

Paving contractor will be responsible to operate all water valves on the project, in the presence of the inspector, to ensure accessibility to the valves, and that all valves are left in the "ON" position when the project is completed.

Note: Contours shown represent the site after Mass Grading has been completed. Cross sections are based on the site after Mass grading

NOTE: ROLL TYPE CURB & GUTTER TO BE CONSTRUCTED ON THE PAVEMENT SHOWN ON THIS SHEET. TOP OF CURB ELEVATIONS ARE GIVEN FOR FULL HEIGHT CURB.

Baughman HARVEST RIDGE - PH. III
35TH. STREET SOUTH
Sta. 0+37.76 to 1+61.85

Engineering | Surveying | Planning | Landscape Architecture

PROJECT NUMBER 47283807	DESIGN MWS	DRAWN JRW
REVISIONS	APPROVED MWS	DATE 3/24/08
SCALE Noted		SHEET 9 OF 38

E:\Harvest Ridge\Phase 3\STRV06-11_SRDwg 06-12-07