

**Benchmarks**

BM #1: "□" Cut in Top of Curb at Northwest Corner of Parking Lot, Lot 1, Block A, St. Peter the Apostle Catholic Church 2nd Addition.  
Elev. = 150.34 (City Datum)

BM #2: "□" Cut in E of Curb Inlet Top Adjacent to Northeast Corner of Lot 17, Block C, Harvest Ridge Addition  
Elev. = 145.89 (City Datum)

BM #3: "+" Cut in E of Curb Adjacent to Southwest Corner of Tract "H" Block A, Harvest Ridge Addition  
Elev. = 148.67 (City Datum)

Scale: 1" = 60'

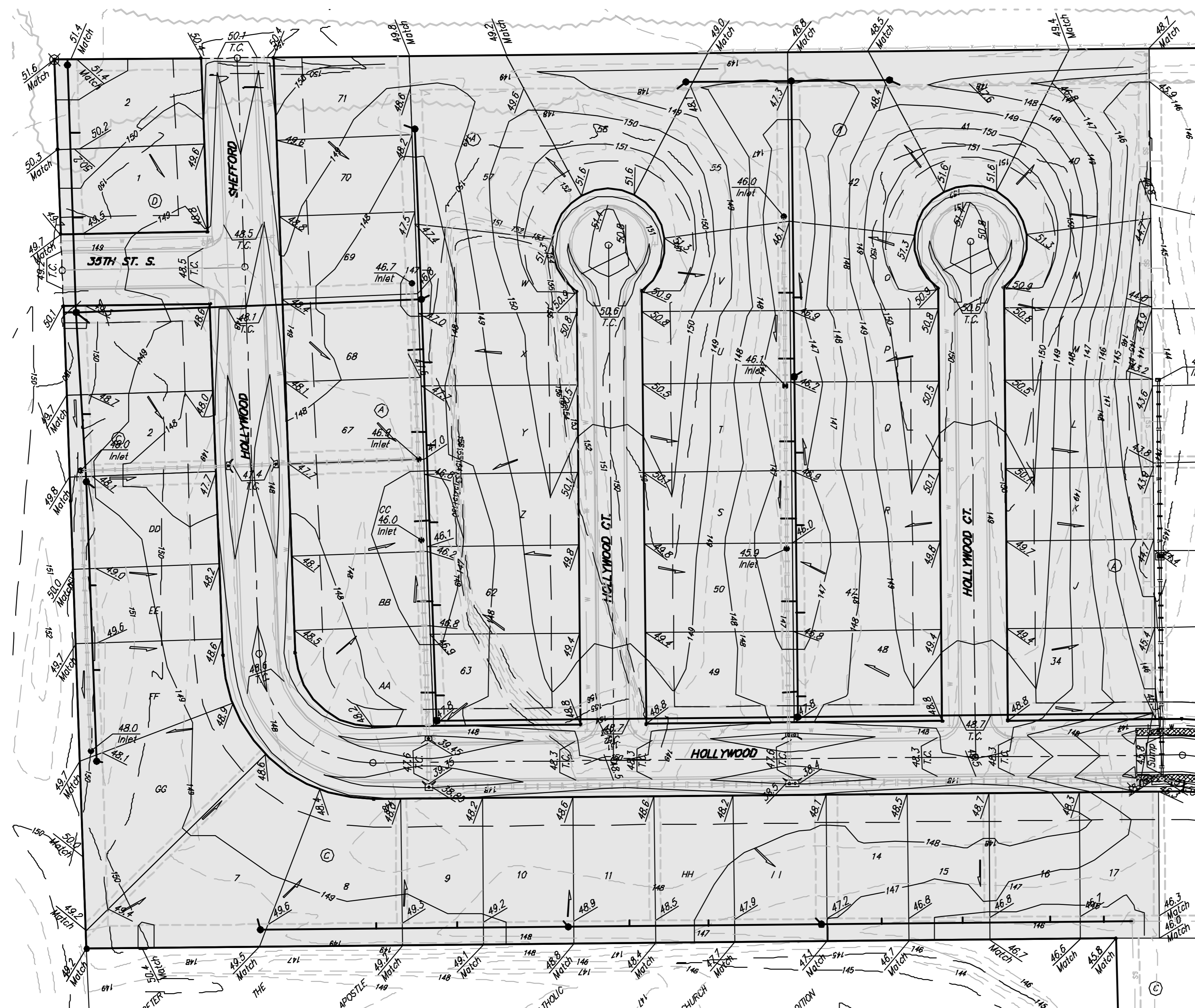

All areas disturbed by construction within easements and street R/W's are to be seeded and mulched as follows:  
SEED -- Rye grass (PLS)--3#/1000 Sq. Ft.  
MULCH -- 2 Tons Prairie Hay / Acre

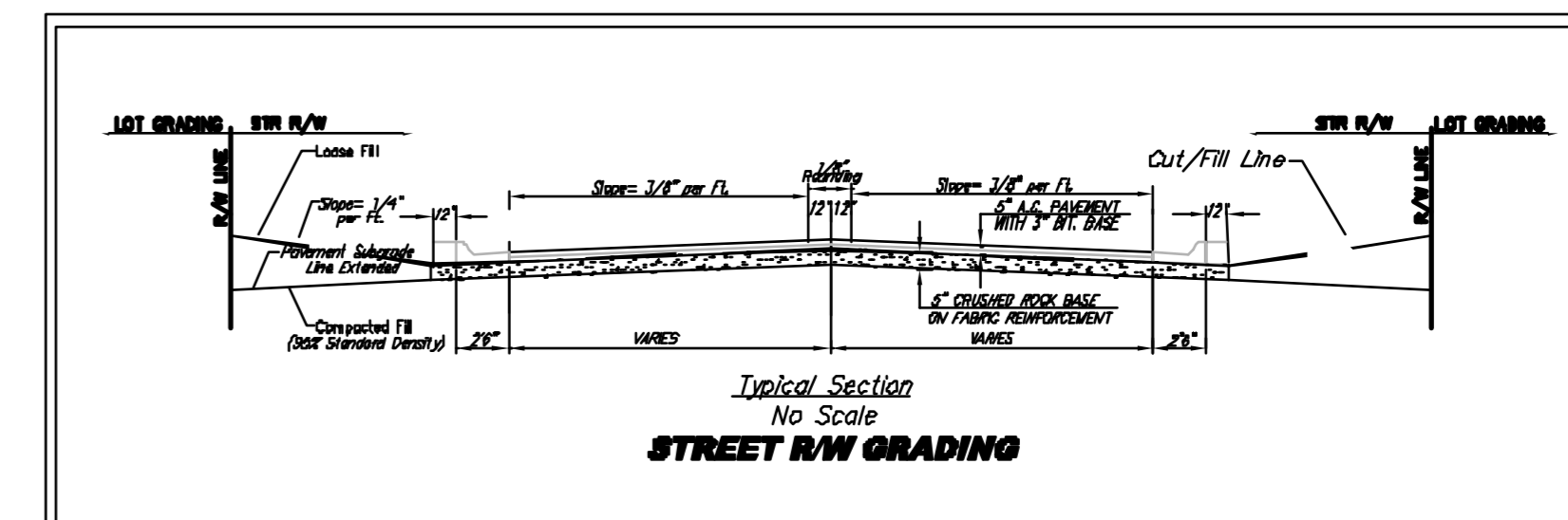
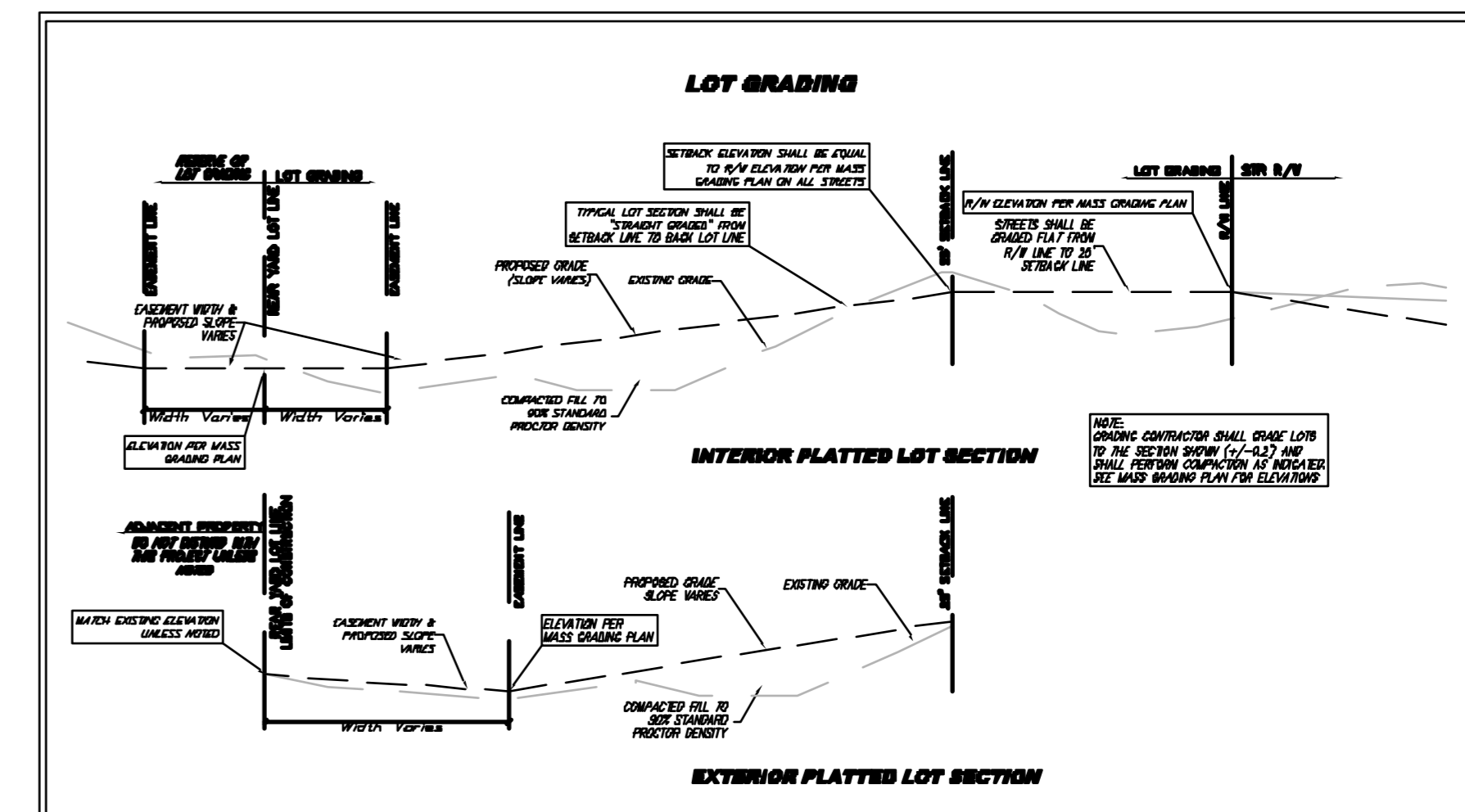

**EARTH WORK TOTALS**

	C.Y. Excavation	C.Y. Fill	C.Y. Compacted Fill
Mass Grading	17,000	3,000	N/A
Street (R/W)	2,714	370	3
Project Total	19,714	3,370	3

Earthwork quantities are unadjusted and are for reference only. All cost associated with mass grading shall be incidental to lump sum bid item "Mass Grading".

**MASS GRADING GENERAL NOTES:**

1. Compaction of 95% shall be obtained in all street R/W's, 90% in all other areas.
2. It shall be the Contractor's responsibility to protect any existing utilities during mass grading. Any damage done to these systems by Contractor or subcontractor shall be repaired at no additional cost to the project.
3. All existing concrete rubble, existing construction debris, tires, and all other existing trash shall be removed by contractor immediately after the contract is accepted. This work shall be incidental to "Site Clearing & Restoration".
4. Excess Excavation and any remaining material in existing stockpile shall be stored off-site at a location next to the site. The final site location shall be marked prior to project bidding. Contact a representative of St. Peters @ 734-5900 for stockpile site location.
5. Numbers above represent site at time of plan preparation. Contractor to visit site and make themselves aware of the site due to continual dumping and removing of soil on the site.

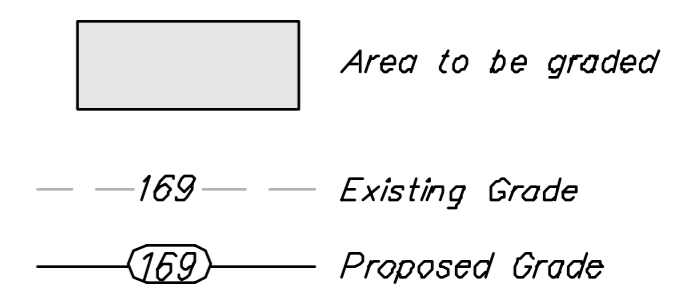

Harvest Ridge Addition - Phase III  
**Mass Grading**  
Street & SWS Improvements

**Baughman**

Engineering | Surveying | Planning | Landscape Architecture

PROJECT NUMBER 47283807	DESIGN MWS	DRAWN JRW
REVISIONS	APPROVED MWS	DATE 3/24/08
SCALE 1" = 60'		SHEET 24 of 38

E:\Harvest Ridge\Phase 3\Mass Grading.dwg 0612-E710