

Scale: 1" = 60'

**NOTES:**  
 1. This Plan is Not To Be Used As A Comprehensive Grading Plan. All Spot Elevations Are Proposed & Subject To Change.

2. Each Lot Area Disturbed By Construction Shall Be the Responsibility of Each Individual Homeowner. Owner Responsible to Follow All SWPP Plans & Guidelines For The Area.

3. Erosion Control Matting and/or Other Approved Bank Stabilization w/Seeding & Fertilizer Shall Be Installed at Engineered Channels or Sedimentation Basins Where the Designed Slopes Will be Greater Than 3:1. All Other Disturbed Areas Shall be Seeded, Fertilized, & Mulched per General Note 11.

4. Install 6' Wide Curlex/Excelsior Blanket, or Approved Equal, on Prepared Surface Back of Curb. Edge of Blanket Will Be At Back of Curb. Install Per Manufacturers Recommendation, Including Staples.

5. The Earth Dikes Constructed Around the Ponds May be Substituted with Silt Fence with Approval of Developer.

6. All Seeding Shall be Drilled During Spring or Fall Planting Seasons. Fall Seeding Shall be September 1 thru Mid October. Spring Seeding Shall be From March 15 thru Mid May.

7. Install Curlex/Excelsior Blanket, or Approved Equal, on Prepared Surface where Soil Has Been Disturbed Due To Construction of Drive Entrances Joining into the Exis. Arterial Street.

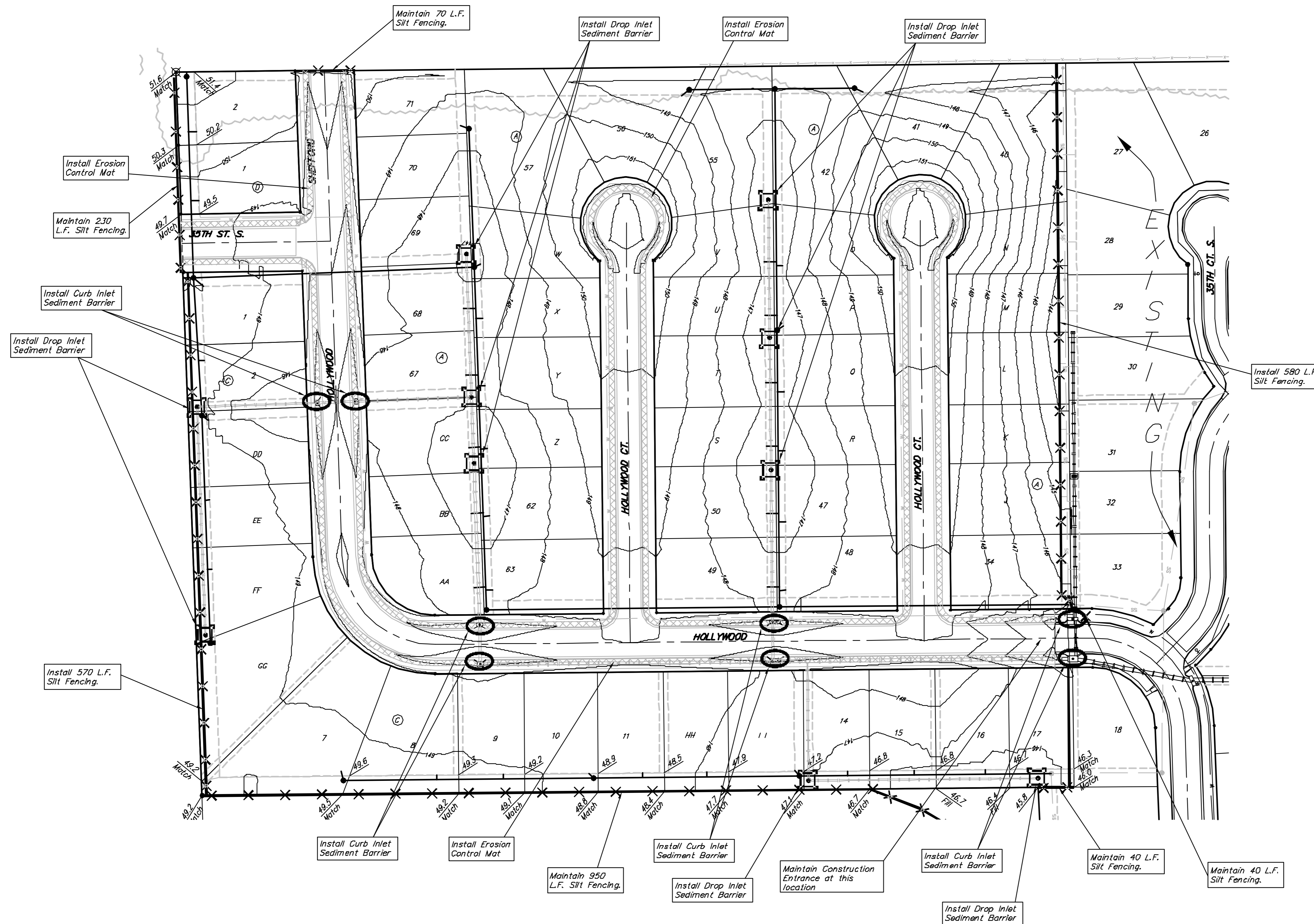

**EROSION CONTROL PLAN LEGEND**  
 (Installation Details Found in the SWP2 Plan)

- LIGHT STONE RIP-RAP
- DROP INLET PROTECTION
- CURB INLET PROTECTION
- SILT FENCING
- EARTH DIKES
- EROSION CONTROL MAT

NO SCALE

EROSION CONTROL MEASURE	UNITS	QUANTITY
SILT FENCE	L.F.	1,150
RIPRAP	S.Y.	-
DROP INLET BARRIER (See Plan Sheets)	EA.	10
CURB INLET BARRIER (See Plan Sheets)	EA.	8
STRAW BALE DITCH CHECK	EA.	-
EARTHEN DIKES	L.F.	-
CURLEX	S.Y.	-
EROSION CONTROL MAT	S.Y.	3,234
Construction Entrance	EA.	maintain

QUANTITIES ARE FOR INFORMATION ONLY!  
 CONTRACTOR SHALL VERIFY QUANTITIES PER SPECIFIC ENGINEERING PLAN SHEET.

**Baughman** Harvest Ridge Addition - Phase III  
**Erosion Control Plan**  
 Street & SWS Improvements

Baughman Company, P.A. 313 1/2 W. Main, St. Paul, MN 55102-2771 F516423771 F516423771  
 ENGINEERING | SURVEYING | PLANNING | LANDSCAPE ARCHITECTURE

PROJECT NUMBER 47283807	DESIGN MWS	DRAWN JRW
REVISIONS	APPROVED MWS	DATE 3/24/08
SCALE 1" = 60'		SHEET 24A of 38

E:\Harvest Ridge\Phase 3\STR24 ECP\LAND.dwg 0612-ET10