

**BENCHMARK:**  
 BM # 1 - City of Wichita Disc in the Northwest Corner of 37th Street North and Womer Elev. = 1324.06 MSL  
 BM # 2 - "C" Cut on the Top of Curb in the NE Corner of the Parking Lot for The Word of Life Church at 37th Street North & Meridian. Elev. = 1323.11 MSL  
 BM # 3 - RR Spike in the East Face of Light Pole at the Southwest Corner of 34th Street North & Meridian. Elev. = 1320.32 MSL

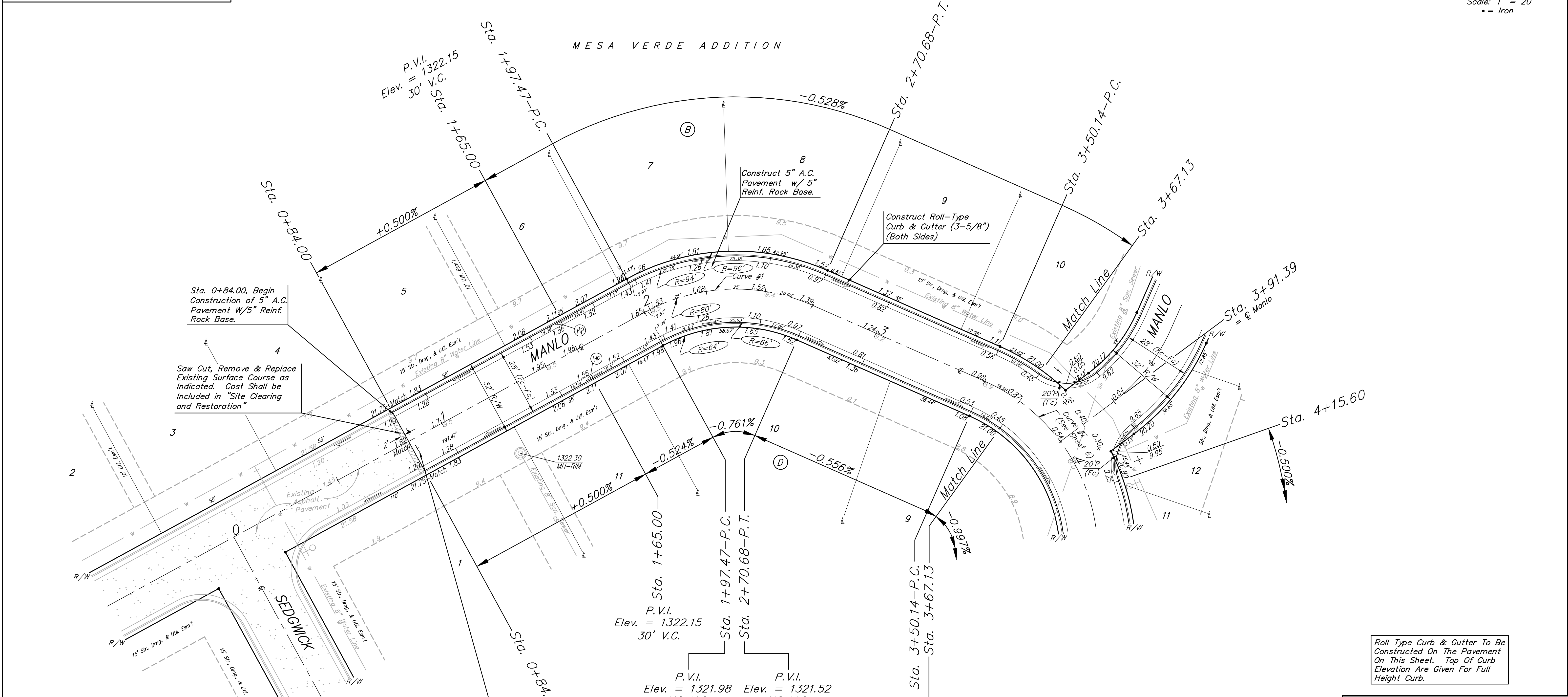
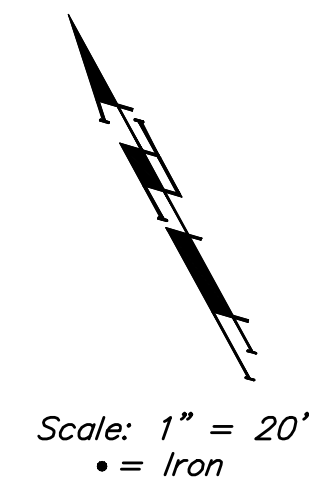

**BENCHMARK:**  
 BM # 1 - City of Wichita Disc in the Northwest Corner of 37th Street North and Womer Elev. = 1324.06 MSL  
 BM # 2 - "C" Cut on the Top of Curb in the NE Corner of the Parking Lot for The Word of Life Church at 37th Street North & Meridian. Elev. = 1323.11 MSL  
 BM # 3 - RR Spike in the East Face of Light Pole at the Southwest Corner of 34th Street North & Meridian. Elev. = 1320.32 MSL

Remove Existing End of Road Markers and Relocate to Sta. 1+26.95, Sheet 6. Cost to be Included in "Site Clearing and Restoration."

Roll Type Curb & Gutter To Be Constructed On The Pavement On This Sheet. Top Of Curb Elevation Are Given For Full Height Curb.

Curve #1  
 Curve Data Based on Centerline  
 Rad. = 80' Delta = 52° 26' 05" Tangent = 39.39'  
 Arc = 73.21' L.C. = 70.68' Def/ft. = 21.48671 Min.

Station	Arc	FACE CHORD LENGTHS		Defl.	T. Defl.
		8' Lt.	8' Rt.		
1+97.47	-	-	-	0'00"00"	0'00"00"
2+00.00	2.53'	3.23'	1.83'	0'54"22"	0'54"22"
2+25.00	25.00'	31.75'	18.05'	8'57"10"	9'51"32"
2+50.00	25.00'	31.75'	18.05'	8'57"10"	18'48"42"
2+70.68	20.68'	26.29'	14.95'	7'24"21"	26'13"03"

	Mesa Verde Addition - Phase II	
	<b>MANLO</b> STA. 0+84.00 TO STA. 3+67.13	
<small>Baughman Company, P.A. 315 Ellis St. Wichita, KS 67211 P 316-262-7771 F 316-262-0149          ENGINEERING   SURVEYING   PLANNING   LANDSCAPE ARCHITECTURE</small>		
PROJECT NUMBER <b>47284482</b>	DESIGN JAK	DRAWN JAK
REVISIONS:	APPROVED JAK	DATE 5/13/08
SCALE Noted		SHEET <b>4 OF 16</b>
<small>Mesa Verde/Phase2/Str1</small>		<small>08-03-E075</small>