

BENCHMARK:
 BM # 1 - City of Wichita Disc in the Northwest Corner of 37th Street North and Womer Elev. = 1324.06 MSL
 BM # 2 - "C" Cut on the Top of Curb in the NE Corner of the Parking Lot for The Word of Life Church at 37th Street North & Meridian. Elev. = 1323.11 MSL
 BM # 3 - RR Spike in the East Face of Light Pole at the Southwest Corner of 34th Street North & Meridian. Elev. = 1320.32 MSL

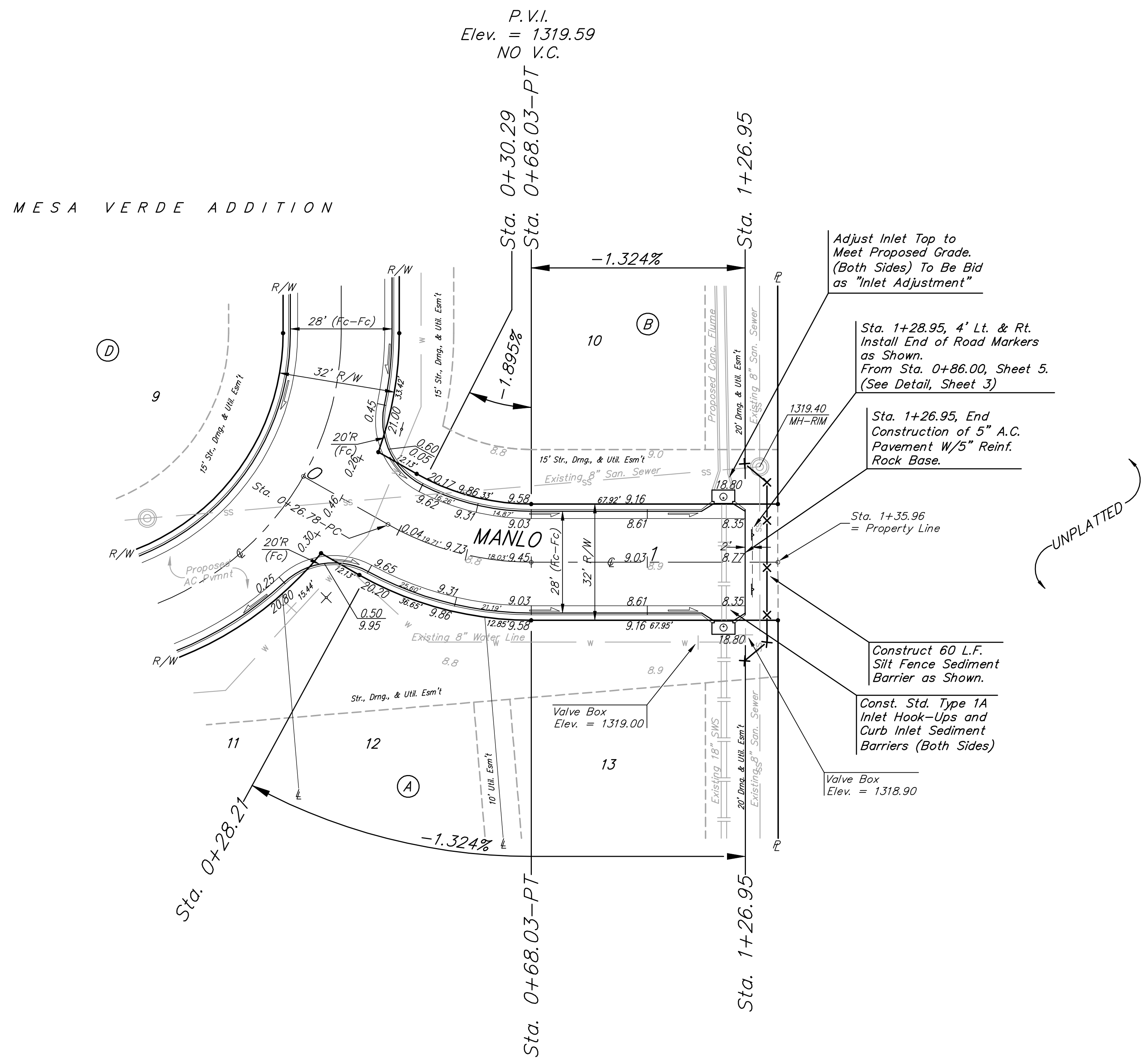
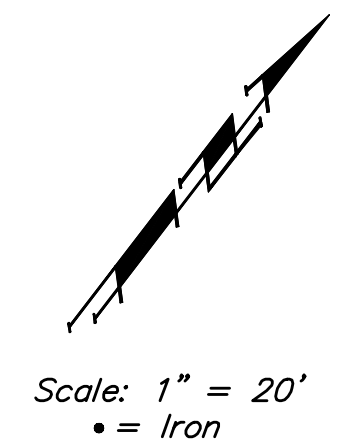

MESA VERDE ADDITION

Curve #3
 Curve Data Based on Centerline
 Rad. = 80' Delta = 29°32'26" Tangent = 21.09'
 Arc = 41.25' L.C. = 40.79' Def./Ft. = 21.48404 Min.

Station	Arc	Face Chord Lengths		Defl.	Total Defl.
		8' Left	8' Right		
0+26.78	-	-	-	0°00'00"	0°00'00"
0+30.29	3.51'	4.47'	2.54'	1°15'25"	1°15'25"
0+50.00	19.71'	25.06'	14.25'	7°03'27"	8°18'52"
0+68.03	18.03'	22.94'	13.04'	6°27'21"	14°46'13"

Roll Type Curb & Gutter To Be Constructed On The Pavement On This Sheet. Top Of Curb Elevation Are Given For Full Height Curb.

	Mesa Verde Addition - Phase II	
STA. 0+00 TO STA. 1+26.95		
<small>Baughman Company, P.A. 315 Ellis St. Wichita, KS 67211 P 316-262-7771 F 316-262-0149 ENGINEERING SURVEYING PLANNING LANDSCAPE ARCHITECTURE</small>		
PROJECT NUMBER 47284482	DESIGN JAK	DRAWN JAK
REVISIONS:	APPROVED JAK	DATE 5/13/08
SCALE Noted		SHEET 6 OF 16
<small>Mesa Verde\Phase2\Str3</small>		<small>08-03-E075</small>