

INDEX OF SHEETS:

1. Cover Sheet
2. Plan - Fire Line
- 3.-4. Plan - Line 2
5. FH Details

GENERAL NOTES:

1. Contractor will be required to provide notice to utility companies a minimum of twenty-four (24) hours prior to any excavation, as follows:

Kansas One-Call (316)687-2470

The Contractor must notify the following in case of an emergency:

Cox Communications (316)262-4270
or (316)263-2061

Westar Energy/ (800)482-4950
Kansas Gas & Electric Company 1-555-1212
AT&T (316)268-4908
City of Wichita Water Department (316)268-4071
City of Wichita Sewer Department (316)941-1608
Aquila Natural Gas (800)303-0357
or (316)268-4071

2. Exist. utilities and their locations, as shown on the plans, represent the best information obtainable for design. Location information has been obtained from the various utility companies and is either from company record drawings or company-provided field locations. The Contractor will be required to work around existing utilities which do not conflict with proposed constructions.

3. The Contractor to verify utility locations prior to construction of this project.

4. Utility service and installation shall be coordinated with the respective utility owner. Contacts are:

Kansas Gas Service	Jim Coe	(316)832-3126
Westar Energy	Miles Capps	(316)261-6251
Aquila Networks	Calvin Briggs	(316)942-8811
Wichita Water & Sewer	Kerry Gibson	(316)268-4555
AT&T	Jim Toben	(316)268-2759
Cox Communications	Mark Anaya	(316)262-4270

5. All lawn/turf areas disturbed by construction of proposed improvements shall be restored with seeding. All seeding work shall be in accordance with the City of Wichita standard specifications and the City of Wichita administrative regulation No. AR78 which governs cleanup and replacement following construction. All costs for this work shall be subsidiary to the lump sum price bid for "Site Restoration."

6. Traffic affected by the construction of this project shall be handled in accordance with the latest edition of the Manual on Uniform Traffic Control Devices.

7. It is the contractor's responsibility to visit this site to better understand the extent of site clearing and restoration to be performed. Site Clearing and Restoration shall include all costs for removal of items which a pay item is not provided.

8. The contractor shall be responsible for preserving property irons. The contractor will be required to re-establish any property irons which are damaged or destroyed by the construction operations. Such irons shall be re-established by a licensed land surveyor in accordance with state laws.

9. Properties within the project may have underground irrigation systems (lawn sprinklers) which conflict with the new construction. Contractor shall remove such components as needed during construction of the project. The irrigation system shall be reinstalled in like kind before project completion. Any irrigation system modifications required because of project improvements shall be coordinated with the property owner. Portions of underground irrigation systems not in conflict with construction shall be protected from damage and shall remain in place. All work related to underground irrigation/sprinklers shall be subsidiary to Site Restoration.

As Built Plans:

CONTRACTOR: Mies, Fire Protection
INSPECTOR: Larry Gann & Tom Jones,
K E Miller Engineering
PDF by: NWS, 06-25-08

WATER LINE TO SERVE
WASI Phase 3
1371 PPW (607853)
CITY OF WICHITA, KANSAS
Jim Armour, P.E., City Engineer

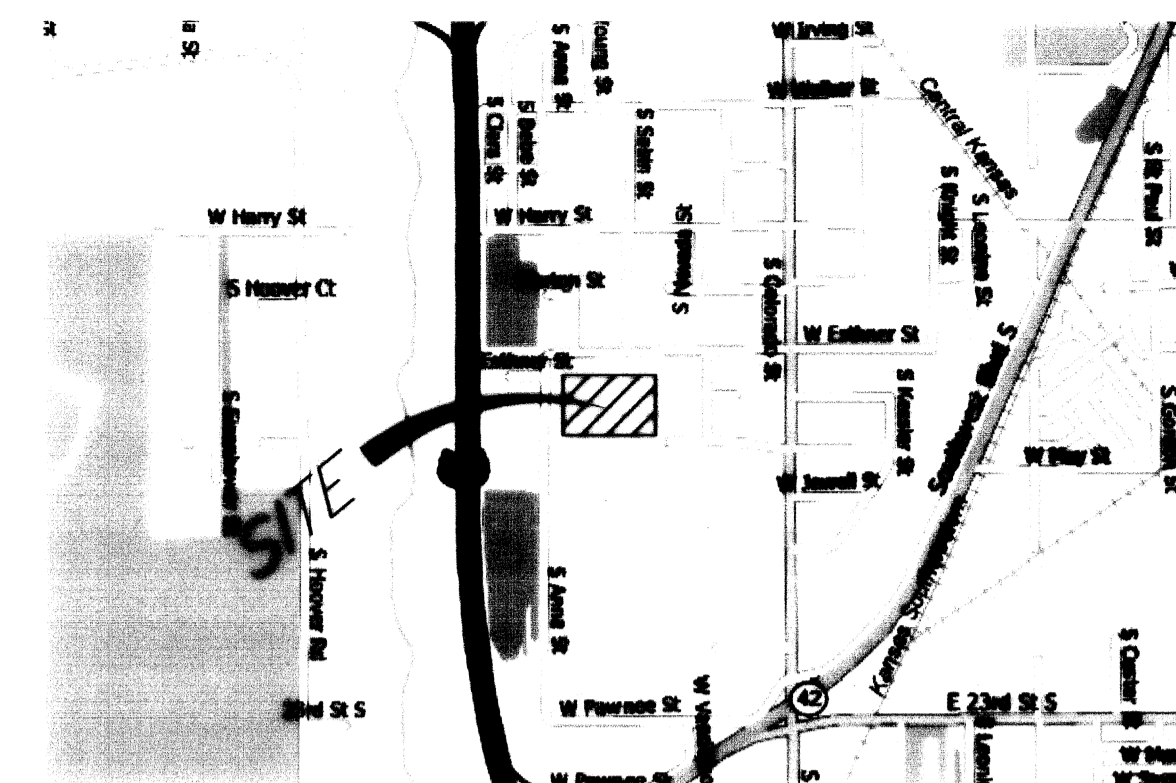

LOCATION MAP

Baseline:

10+00 at the Property
Corner of Tracy and May.

Benchmarks:

BM 1 Temporary bench mark.
SE corner of intersection. Box
cut in NE corner of concrete
base of sign "May Central Park"
Elev.=1299.07 MSL

BM 2 COW Bench mark. NW
corner of intersection of West St.
and May. 65' W of centerline of
West St. 50' N of centerline of
May. 28.8' N of center of median.
14.4' W of west face of sidewalk.
2.5' N of back of curb. 2.2' W
of west face of SWS inlet.
Elev. 1296.03 MSL

BM 3 COW Bench Mark, West side of Anna
and south line of drive into trailer park,
located by 2201 S. Anna.
Elev. = 1297.50 MSL

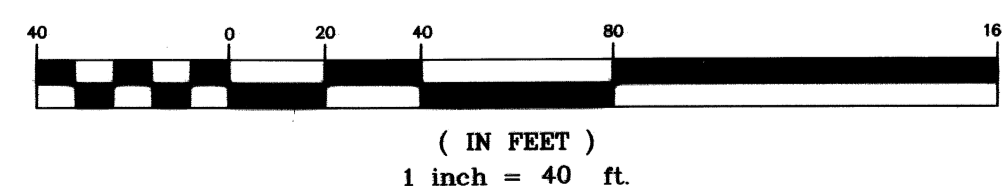
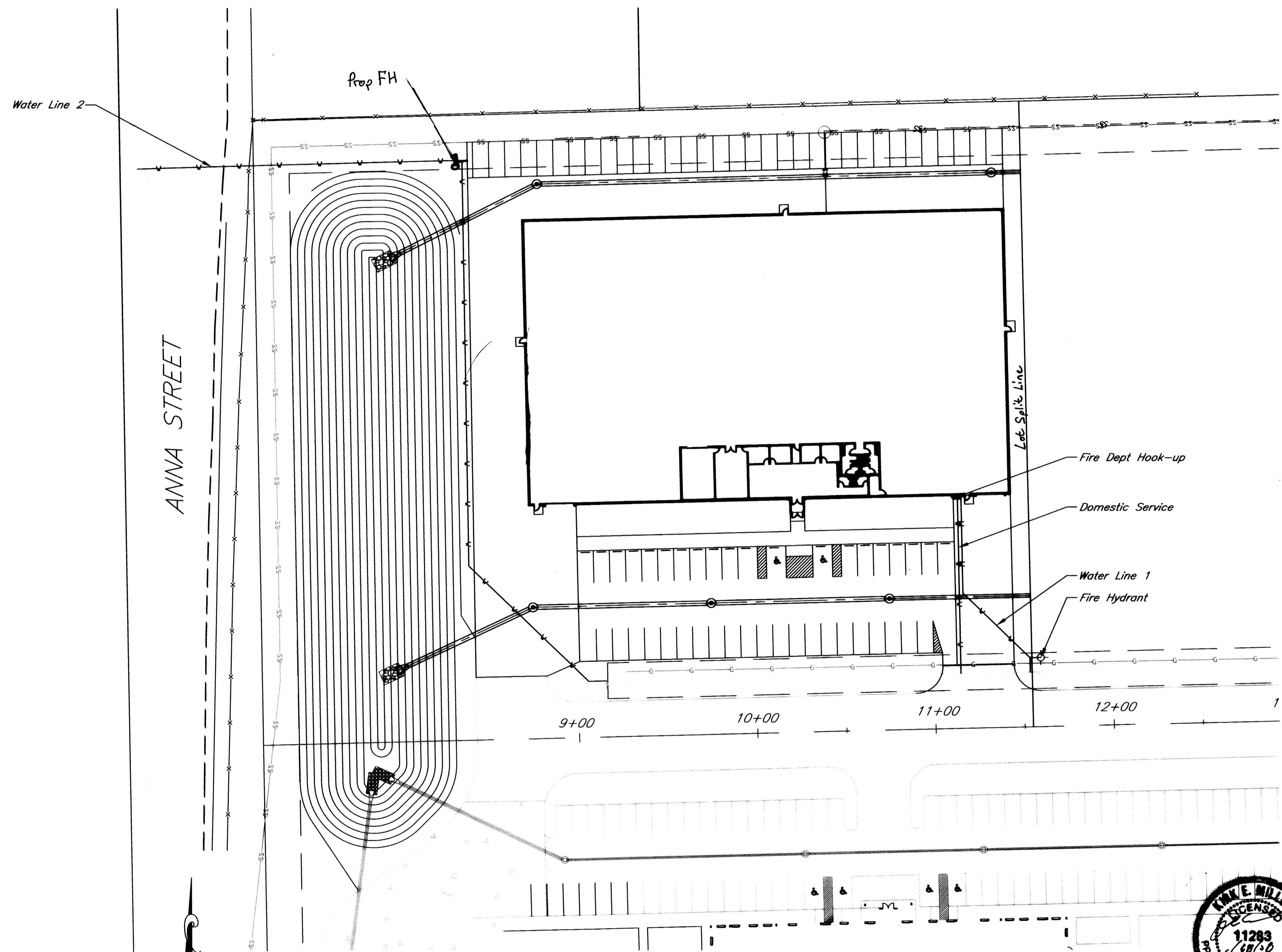

December 2007

APPROVED AS NOTED
BY CITY ENGINEER OF WICHITA,
BY WICHITA WATER & SEWER DEPARTMENT,
& BY WICHITA FIRE DEPARTMENT

Public Works: *[Signature]* 1/23/08
Water & Sewer: *[Signature]*
Fire: *[Signature]* 1-25-08

NOTE TO CONTRACTORS
Public Property:
Inspection and testing for the waterline is to be provided by a Licensed Consulting Engineering Firm under contract with the Owner/Developer. Said inspection to be in accordance with the City of Wichita standard construction engineering practices and certified by a Professional Engineer Licensed in the state of Kansas. No work shall be performed in dedicated easements or public right-of-way by the Contractor without such inspection nor shall any work be commenced without written authorization by the City Engineer. All Construction and Materials shall comply with the City or Wichita Specifications and Standards (on file and available in the City Engineer's Office).

Private Property:
Installation and testing for the fire protection line is to be performed by a City of Wichita licensed fire protection contractor in accordance with the fire codes as adopted by the City of Wichita. All material and construction practices for the fire protection line shall comply with the fire codes as adopted by the City of Wichita (available from the City of Wichita Fire Department). The Contractor shall not commence work without notification and approval of the Wichita Fire Department. Inspection of the fire protection line is to be provided by a licensed Engineering Firm under contract with the Owner/Developer and the Fire Department. The contractor shall not start work until the project inspector is assigned to the project and present on the site. Any work done without inspection will be required to be uncovered for inspection.

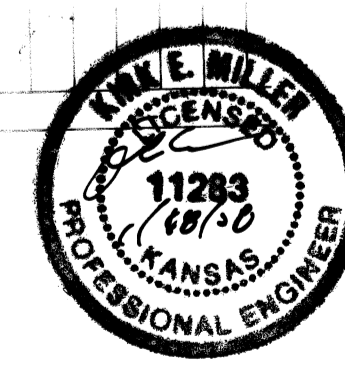

AS BUILTS:

CONTRACTOR:	Mies & Fire Protection Services
INSPECTOR:	Larry Gann & Tom Jones
COMPANY:	K.E. Miller
DATE:	06/25/2008



516 S. Market,
Wichita, KS 67202
316/264-0242