

# PRIVATE WATER MAIN AND SERVICES

## TO SERVE SISTERS OF ST. JOSEPH APARTMENT BUILDING

### PRIVATE PROJECT NUMBER 1337 PPW (607853)

### As Built Plans:

CONTRACTOR: McCullough Excavation  
 INSPECTOR: Larry Gann, K E Miller Engineering  
 .PDF by: NWS, 06-25-08

### GENERAL NOTES

- Contractor will be required to provide a minimum notice of 48 hours to utility companies prior to starting any excavation as follows:  
 Kansas One-Call 687-2470  
 The Contractor must notify the following in case of an emergency:  
 Cox Communications 262-0661  
 Kansas Gas Service 383-8600  
 Westar Energy 383-8600  
 Aquila Energy 1-800-303-0357  
 Southwestern Bell Telephone Company 1-800-286-8313  
 City of Wichita Water Department 268-6000  
 City of Wichita Sewer Maintenance 268-6000
- All water mains and appurtenances shall be installed in accordance with City of Wichita, Kansas, Standard Specifications for the Construction of City Projects, and current policy on construction of public works improvements by private contract.
- Opening and closing water valves shall be done slowly to prevent damage to the water distribution system from water hammer. All valves closed by the Contractor must be reopened as new construction permits. Project inspector must ascertain that any valve closed by the Contractor is reopened. Contractor will be permitted to operate 8" and smaller water valves only when the project inspector assigned to the project is present.
- The Contractor shall give all property owners and/or tenants of developed property directly abutting the construction of this project a minimum of ten (10) days advance notice prior to start of construction.
- The Contractor shall be responsible for preserving property irons. The Contractor will be required to re-establish any property irons which are damaged or destroyed by his construction operations. Such irons shall be re-established by a licensed land surveyor in accordance with state laws.
- No work shall begin on this project before required bonds are submitted to the City of Wichita, and the project inspector has been notified.
- All areas of public R/W disturbed by construction of this project are to be restored in accordance with Administrative Regulation AR 78 of the City of Wichita.
- Erosion control will be handled by the General Contractor as part of the erosion control master plan for this site.

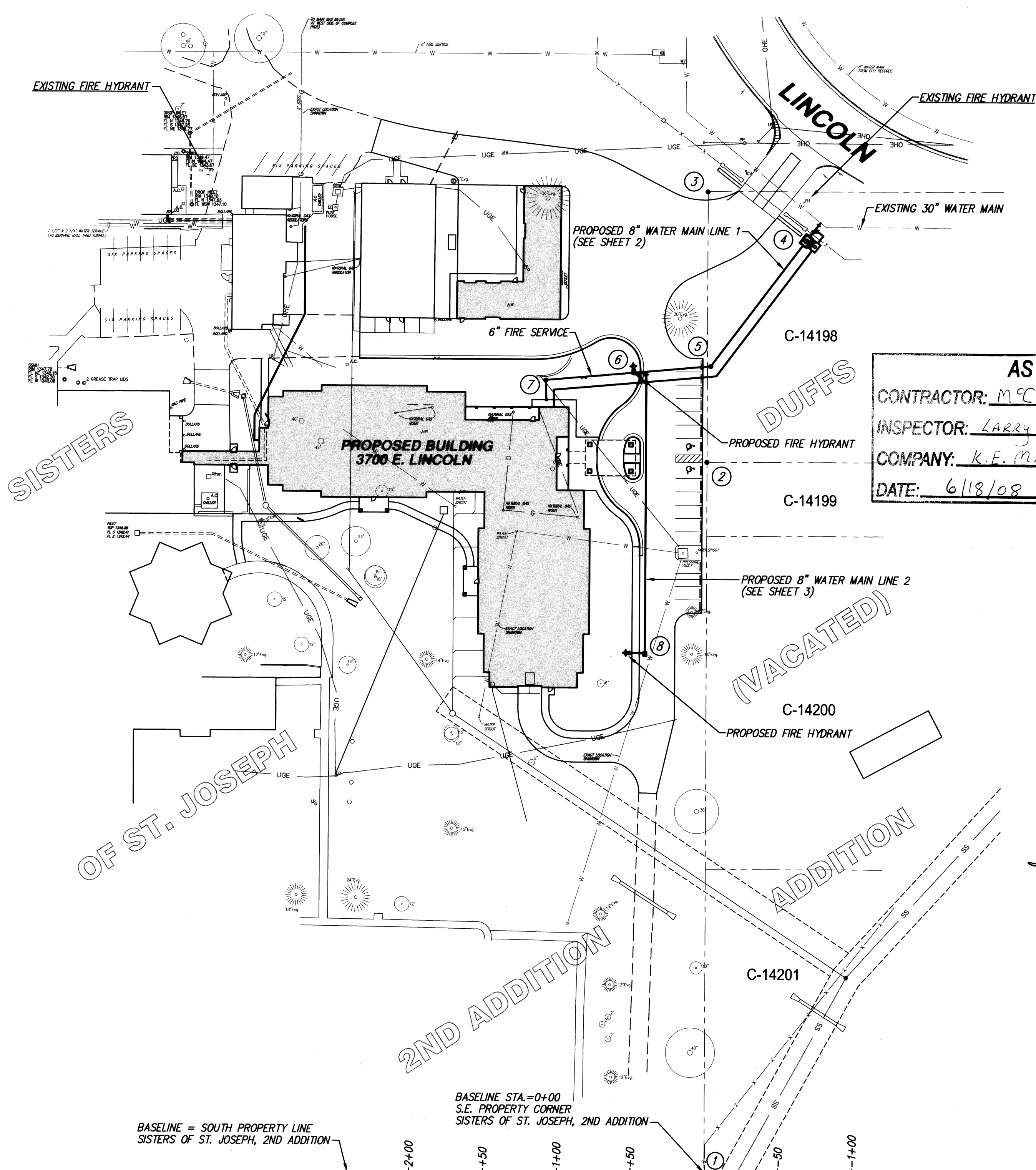

**AS BUILTS:**  
 CONTRACTOR: McCullough Exc.  
 INSPECTOR: LARRY GANN  
 COMPANY: K.E. Miller  
 DATE: 6/18/08

### INDEX OF SHEETS

- (CITY SUBMITTAL INDEX)
- INDEX SHEET
  - WATER PLAN & PROFILE
  - WATER PLAN & PROFILE
  - WATER ASSEMBLY DETAILS
  - METER VAULT DETAILS

### BENCHMARKS

CITY OF WICHITA  
 BLUFF & LINCOLN - IN TURN ISLAND  
 29.5 W. OF E. BLUFF; 44.5 S. OF E. MORRIS  
 TO EAST 24' S.W. OF L.P.  
 ELEV.=1349.65

**APPROVED AS NOTED**  
 BY CITY ENGINEER OF WICHITA  
 BY WICHITA FIRE DEPARTMENT  
 BY WICHITA PUBLIC WORKS

Public Works 7/31/07  
 Water & Sewer 7/31/07  
 Fire Prot. Line 10-4-07

### NOTE TO CONTRACTORS

**Public Property:**  
 Inspection and testing for the waterline is to be provided by a Licensed Consulting Engineering Firm under contract with the Owner/Developer. Said inspection to be in accordance with the City of Wichita standard construction engineering practices and certified by a Licensed Professional Engineer. No work shall be performed in dedicated easements or public right-of-way by the Contractor without such inspection nor shall any work be commenced without written authorization by the City Engineer. All Construction and Materials shall comply with the City of Wichita Specifications and Standards (as file and available in the City Engineer's Office).

**Private Property:**  
 Inspection and testing for the fire protection line is to be performed by a City of Wichita certified fire protection contractor in accordance with the fire codes as adopted by the City of Wichita. All materials and construction practices for the fire protection line shall comply with the fire codes as adopted by the City of Wichita (available from the City of Wichita Fire Department). The Contractor shall not commence work without notification to and approval of the Wichita Fire Department.

### COORDINATE CONTROL TABLE

CONTROL NO.	DESCRIPTION	NORTHING	EASTING
①	S.E. COR. LOT 1, BLOCK 1 (3/4" I.P.)	19337.44	20000.82
②	3/4" I.P.	19817.49	20000.20
③	3/4" I.P.	20000.00	20000.00
④	8" DETECTOR CHECK VAULT	19967.28	20066.68
⑤	8" 45° BEND (H)	19882.16	20002.52
⑥	FIRE HYDRANT ASSEMBLY	19877.62	19950.47
⑦	6" 90° BEND (H)	19872.40	19890.72
⑧	FIRE HYDRANT ASSEMBLY	19688.34	19958.86

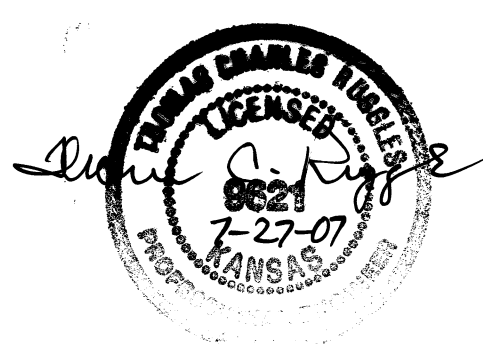

SCALE: 1"=50'

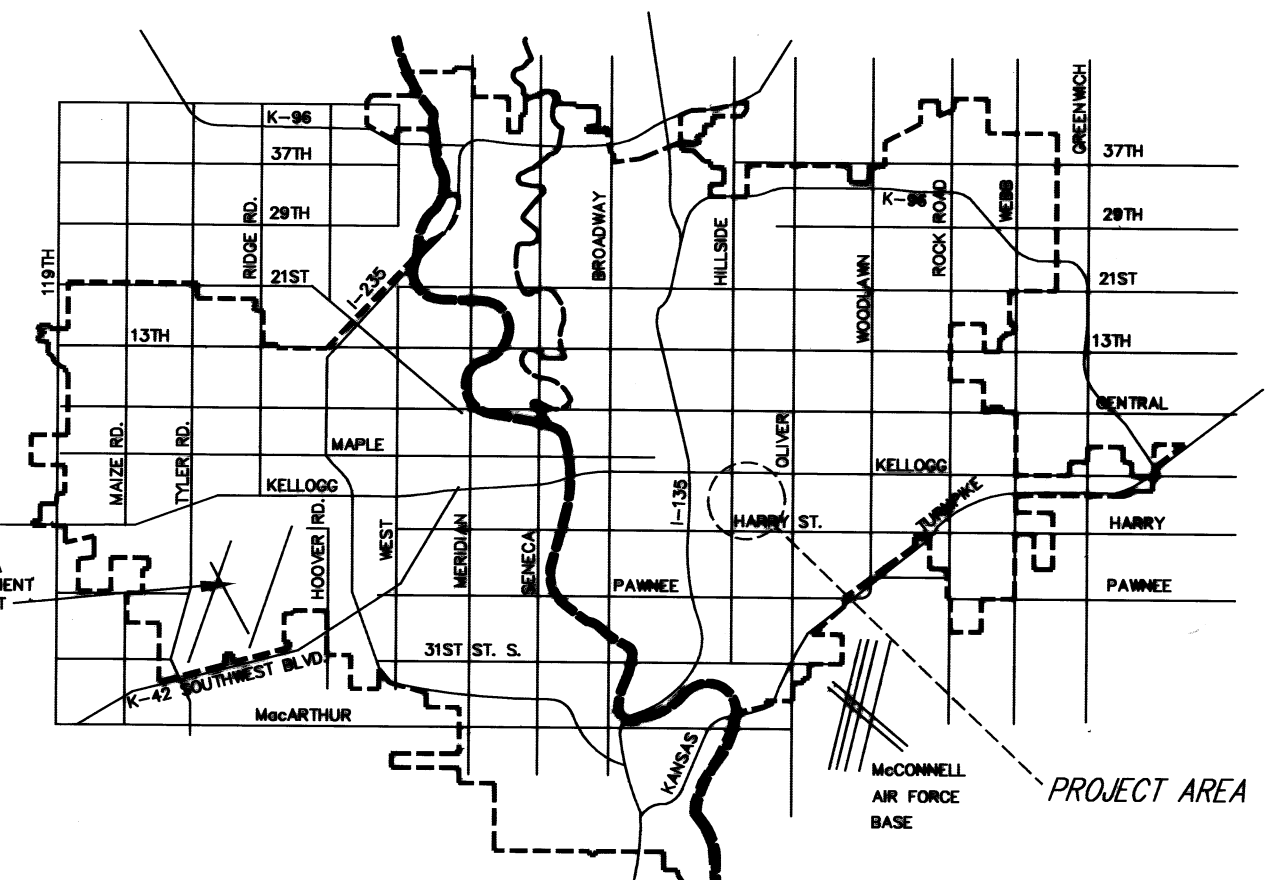

**CITY OF WICHITA, KANSAS**  
**JAMES L. ARMOUR, P.E., CITY ENGINEER**

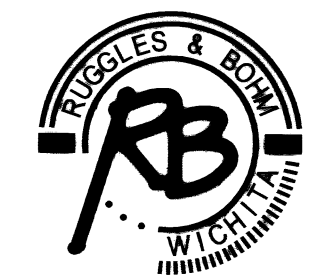

**Ruggles & Bohm, P.A.**  
 Engineering, Surveying, Land Planning  
 924 North Main (316) 264-8008  
 Wichita, Kansas 67203 (316) 264-4621 fax  
 www.rbkansas.com E-mail: info@rbkansas.com