

# PRIVATE STORM WATER SEWER IMPROVEMENTS

TO SERVE

## CROSS POINTE 2ND ADDITION

CITY OF WICHITA PRIVATE PROJECT NO. 1835 PPS (607861)

### CITY OF WICHITA, KANSAS

JAMES L. ARMOUR, P.E.-CITY ENGINEER

INDEX OF SHEETS

1. TITLE SHEET
2. KEY MAP AND GENERAL NOTES
3. PLAT
4. PLAN/PROFILE-CHANNEL GRADING
5. PLAN/PROFILE-SWS LINE NO. 2
6. STANDARD TYPE 1A CURB INLET (5' OPENING)
7. PRECAST MANHOLE DETAILS
8. MANHOLE FRAME AND COVER DETAILS
9. MISCELLANEOUS DRAINAGE AND RIPRAP DETAILS
10. EROSION CONTROL PLAN
- 11-14. EROSION CONTROL DETAILS

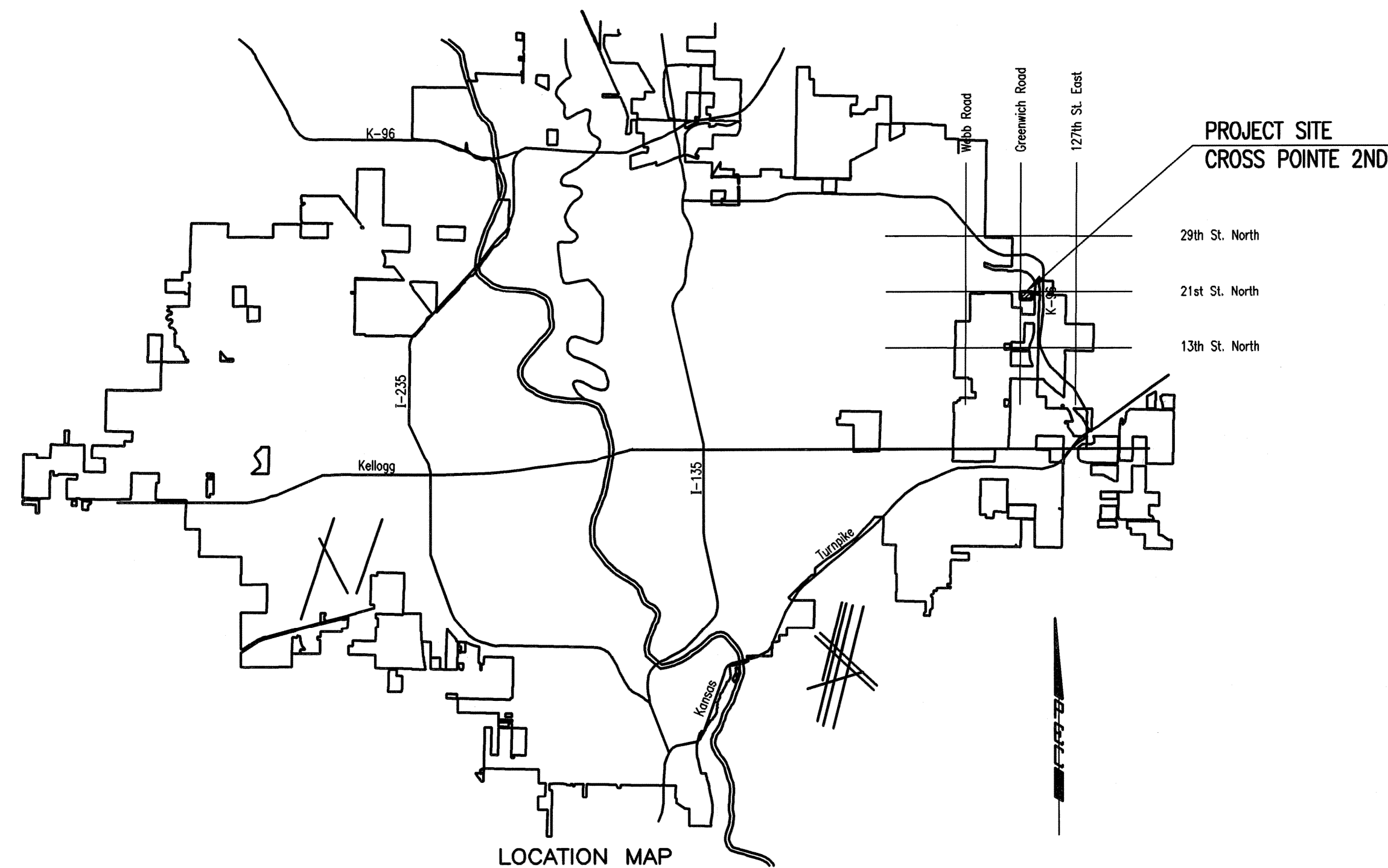

**As Built Plans:**  
 CONTRACTOR: Mies  
 INSPECTOR: Larry Gann, K E Miller Engineering  
 .PDF by: NWS, 06-27-08

APPROVED AS NOTED  
 By CITY ENGINEER OF WICHITA

Storm Sewers URH 1/8/08

NOTE TO CONTRACTOR

INSPECTION AND TESTING FOR THIS PROJECT IS TO BE PROVIDED BY A LICENSED CONSULTING ENGINEERING FIRM CONTRACTED BY THE OWNER/DEVELOPER. SAID INSPECTION TO BE IN ACCORDANCE WITH THE CITY OF WICHITA STANDARD CONSTRUCTION ENGINEERING PRACTICES AND CERTIFIED BY A LICENSED PROFESSIONAL ENGINEER. NO WORK SHALL BE PERFORMED IN DEDICATED EASEMENTS OR PUBLIC RIGHT-OF-WAY BY THE CONTRACTOR UNTIL SUCH INSPECTION IS ARRANGED FOR AND REQUIRED BONDS HAVE BEEN SUBMITTED TO AND APPROVED BY THE CITY NOR SHALL ANY WORK BE COMMENCED IN DEDICATED EASEMENTS OR PUBLIC RIGHT-OF-WAY WITHOUT WRITTEN AUTHORIZATION BY THE CITY ENGINEER. IMPROVEMENTS PERFORMED UNDER THIS PROJECT SHALL NOT BE ACCEPTED BY THE CITY UNTIL ALL APPLICABLE DOCUMENTATION HAS BEEN SUBMITTED TO THE CITY ENGINEER. THIS MAY INCLUDE: RECORD DRAWINGS, INSPECTION LOGS, TEST DOCUMENTATION, TV TAPES, AND A CERTIFICATE OF COMPLETION. THE ABOVE SHALL BE PERFORMED BY THE CONSULTING FIRM CONTRACTED TO INSPECT THIS PROJECT.

## DECEMBER 2007

PLANS PREPARED BY  
**PROFESSIONAL ENGINEERING CONSULTANTS, P.A.**  
 ENGINEERS  
 WICHITA, KANSAS

