

PLAN AND PROFILE OF PROPOSED

MT VERNON STREET AND DRAINAGE IMPROVEMENTS FROM GREENWAY TO BROADWAY

MTC
ENGINEERING
CONSULTANTS, INC.
411 N. WEBB ROAD
WICHITA, KS. 67206
316-684-9600

INDEX TO DRAWINGS

SHEET NO	DESCRIPTION
1	TITLE SHEET
2	GENERAL NOTES
3	TYPICAL SECTIONS
4-11	PLAN SHEETS
12-15	PAVING BUBBLE MAPS
16-19	INTERSECTION DETAILS
20-24	PAVING DETAILS
25	STORM SEWER KEY MAP
26-40	STORM SEWER PLAN AND PROFILE
41-43	STORM SEWER BUBBLE MAPS
44-60	STORM SEWER DETAILS
61	MISCELLANEOUS DETAILS
62-65	WATER PLAN AND PROFILE
66-68	WATER DETAILS
69-70	WATER BUBBLE MAPS
71-75	SANITARY SEWER PLAN AND PROFILE
76	SANITARY SEWER BUBBLE MAP
77-78	SUMMARY OF QUANTITIES
79	EROSION CONTROL PLAN
80-84	EROSION CONTROL BMP'S
85	TRAFFIC SIGNAL PLAN
86	TRAFFIC WIRING PLAN
87-89	TRAFFIC SIGNAL DETAILS
90-91	PAVEMENT MARKING & SIGNING PLAN
92-93	SIGNING DETAILS
94	CONSTRUCTION SEQUENCING
95-98	TRAFFIC CONTROL PLAN
99-101	TRAFFIC CONTROL DETAILS
102-120	CROSS SECTIONS

CITY OF WICHITA
SEDGWICK COUNTY, KANSAS

PAVING PROJECT NO. 472-84289
WATER PROJECT NO. 448-90385
SANITARY SEWER PROJECT NO. 468-84514

JIM ARMOUR, P.E. - CITY ENGINEER

PAVING O.C.A. NO. 706946
WATER O.C.A. NO. 636204
SANITARY SEWER O.C.A. NO. 620509

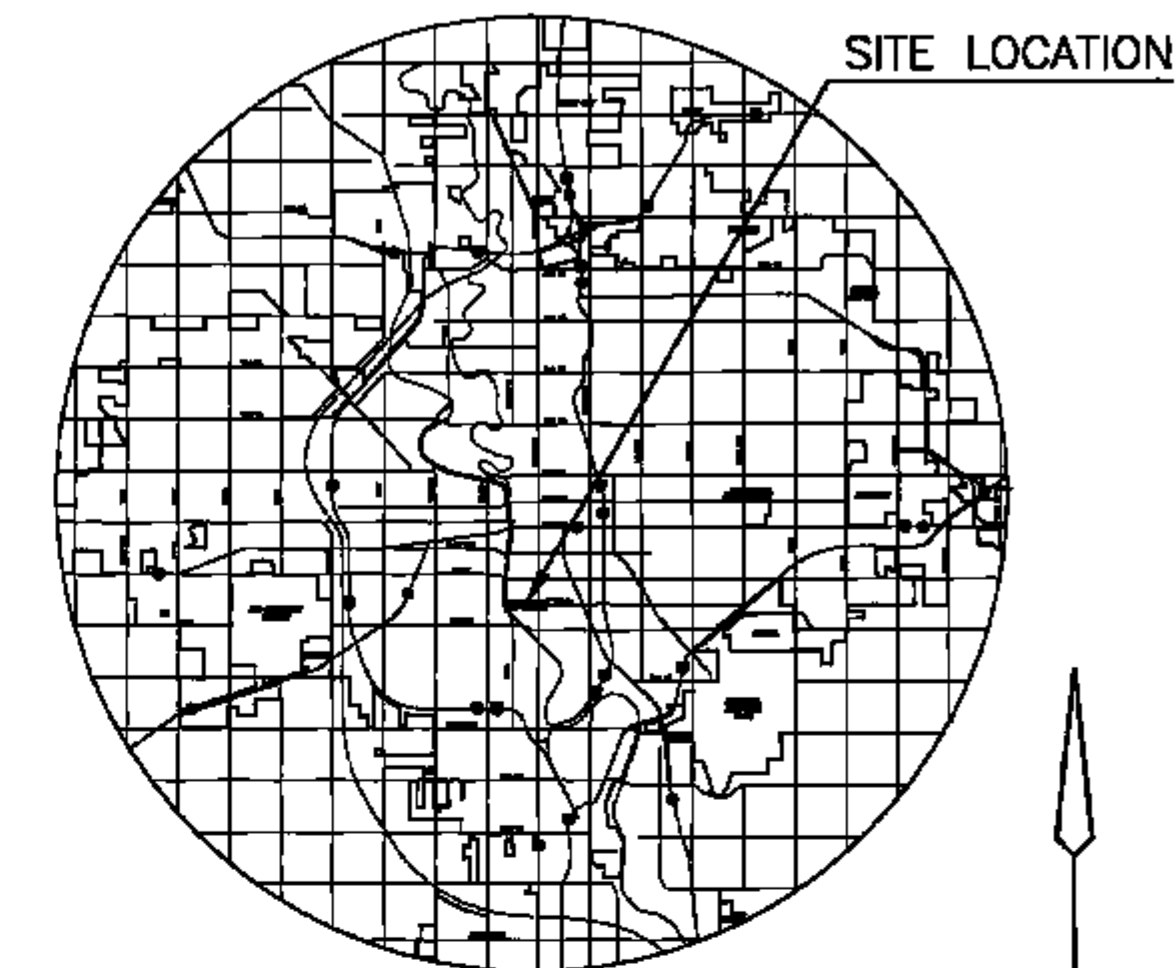

LOCATION MAP



SCALE: 1" = 100'
LEGEND

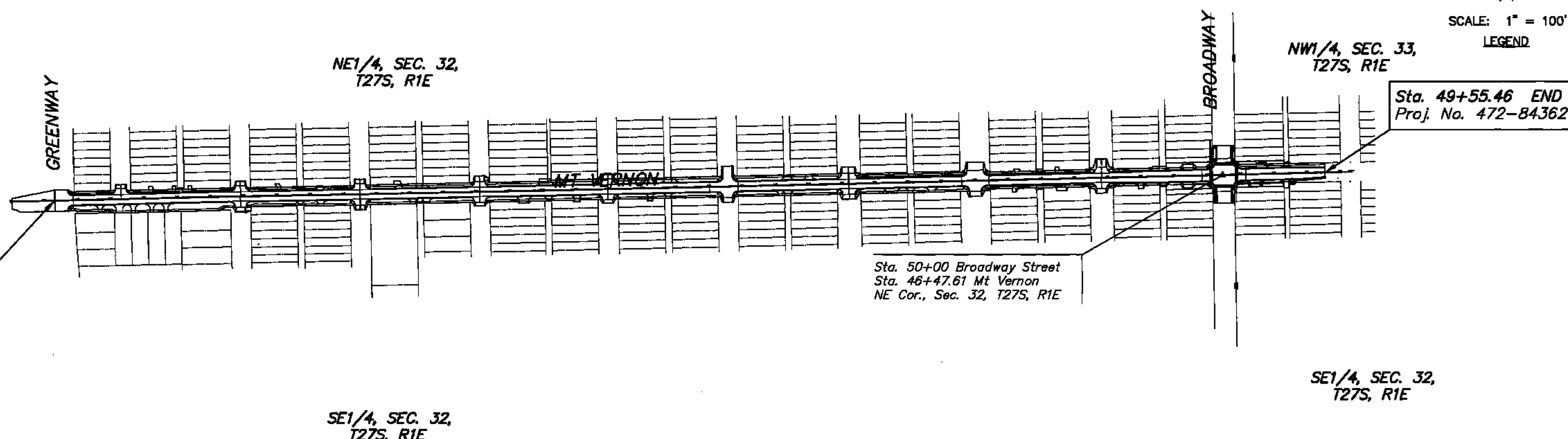

**MT VERNON STREET AND
DRAINAGE IMPROVEMENTS
FROM GREENWAY TO BROADWAY**

Title Sheet
SHEET TITLE 472-84289
448-90385
468-84514
PROJECT NUMBER

DESIGN BY JRA
DRAWN BY JSB
CHECKED BY JRA



ISSUED May 5, 2008
REVISED

SHEET NO.
1 of 120

P:\CITRIS\Bentley\May 05, 2008 @ 08:40AM

J:\CIVIL\06820\WORK\TITLE\06820E1.DWG