

**MT VERNON STREET AND  
DRAINAGE IMPROVEMENTS  
FROM GREENWAY TO BROADWAY**

**PLAN SHEET  
STA. 36+50  
TO  
STA. 42+00**  
SHEET TITLE 472-84289  
448-90385  
468-84514  
PROJECT NUMBER

JRA  
DESIGN BY  
JSB  
DRAWN BY  
JRA  
CHECKED BY

ISSUED  
May 27, 2008  
REVISED

SHEET NO.  
**9 of 120**

**NOTE:**

The ground water influent line is a black-colored 8" SDR-11 HDPE pipe with green stripes associated with the City's Gilbert and Mosley project. This pipe contains ground water that is potentially contaminated and contact with the water should be avoided. The elevation of the pipe is based off of available record information and should be confirmed by the contractor at the beginning of construction. Relocation of the pipe around proposed utilities may be required. The contractor shall coordinate work with and around the pipe with the City of Wichita. Contact Doris Leslie with City of Wichita Environmental Services at 268-8359.

Install new 1" service and connect to existing 8" water main in Main St. Setter to be connected to existing customer's water service. City of Wichita will remove existing water meter, vault, setter, and lid. The Contractor shall coordinate this work.  
0 - Long Service  
1 - Short Service

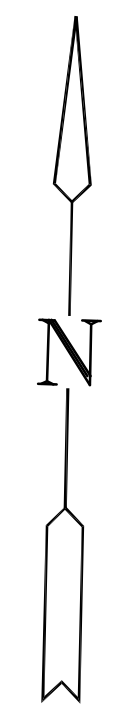

SCALE: 1"=20'  
20 10 0 10 20

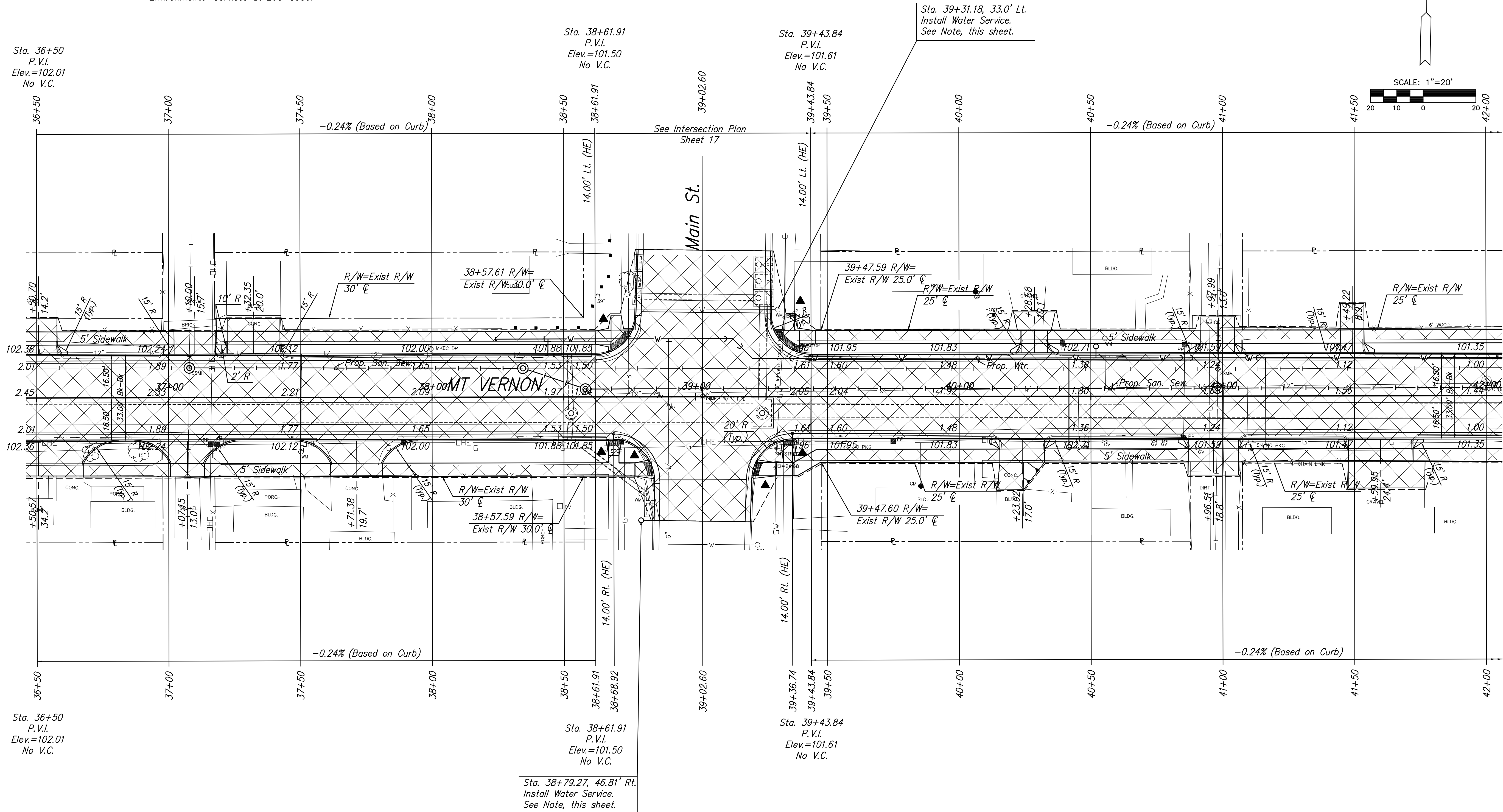

STATION	OFFSET	REMARKS
38+85.20	1.36' Lt.	Abandon Water Valve
40+98.17	10.24' Lt.	Abandon San. Swr. Manhole

STATION	OFFSET	EXISTING ELEVATION	PROPOSED ELEVATION	REMARKS
37+50.22	20.58' Rt.	102.4	102.2	Adj. Water Valve Box
38+89.82	3.11' Rt.	101.43	101.57	Adj. Water Valve Box
39+31.18	33.00' Lt.	x	x	Adj. Water Meter Box

- LEGEND**
- ▣ Pavement/Walk Removal
  - ▲ Construct Wheelchair Ramp See Sht. No. 24

PLOTTED: Tuesday, May 27, 2008 @ 04:27PM