

**MT VERNON STREET AND
DRAINAGE IMPROVEMENTS
FROM GREENWAY TO BROADWAY**

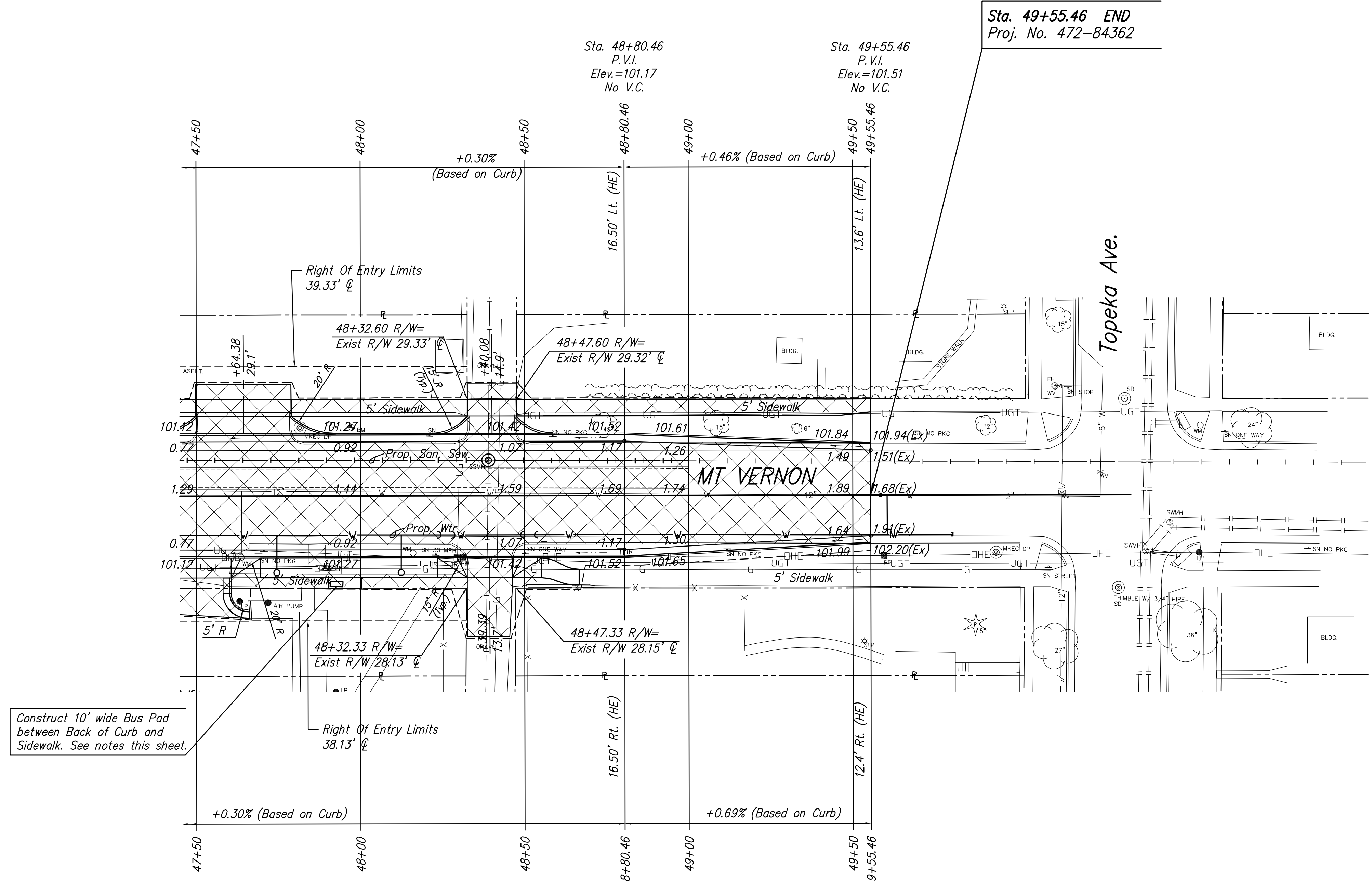

BUS PAD GENERAL NOTES

1. Bus Pad thickness to be 4". Bus Pads paid for as "Sidewalk Construction, 4".
2. Except as otherwise noted, Sidewalk slope must not exceed 5% in the direction of travel, or 2% perpendicular to the direction of travel.
3. All Sidewalk within 5' of Back-of-Curb must be constructed as a Landing Area, with slopes not in excess of 2% in any direction.
4. Bus Pads and all Proposed Sidewalk immediately adjacent to pads will require the Subgrade below to be Compacted to 95% Standard Density. Cost of Subgrade preparation is Subsidiary to "Sidewalk Construction, 4".

LEGEND

- Pavement/Walk Removal
- Construct Wheelchair Ramp See Sht. No. 24

**PLAN SHEET
STA. 47+50
TO
STA. 51+00**
SHEET TITLE 472-84289
448-90385
468-84514
PROJECT NUMBER

DESIGN BY **JRA**
DRAWN BY **JSB**
CHECKED BY **JRA**

ISSUED **May 27, 2008**
REVISED

SHEET NO.
11 of 120