

**MT VERNON STREET AND  
DRAINAGE IMPROVEMENTS  
FROM GREENWAY TO BROADWAY**

**Storm Sewers  
Lines 2, 3  
4, 5, & 6**  
SHEET TITLE 472-84289  
448-90385  
468-84514  
PROJECT NUMBER

JRA  
DESIGN BY  
JSB  
DRAWN BY  
JRA  
CHECKED BY

ISSUED  
May 27, 2008  
REVISED

SHEET NO.  
**34 of 120**

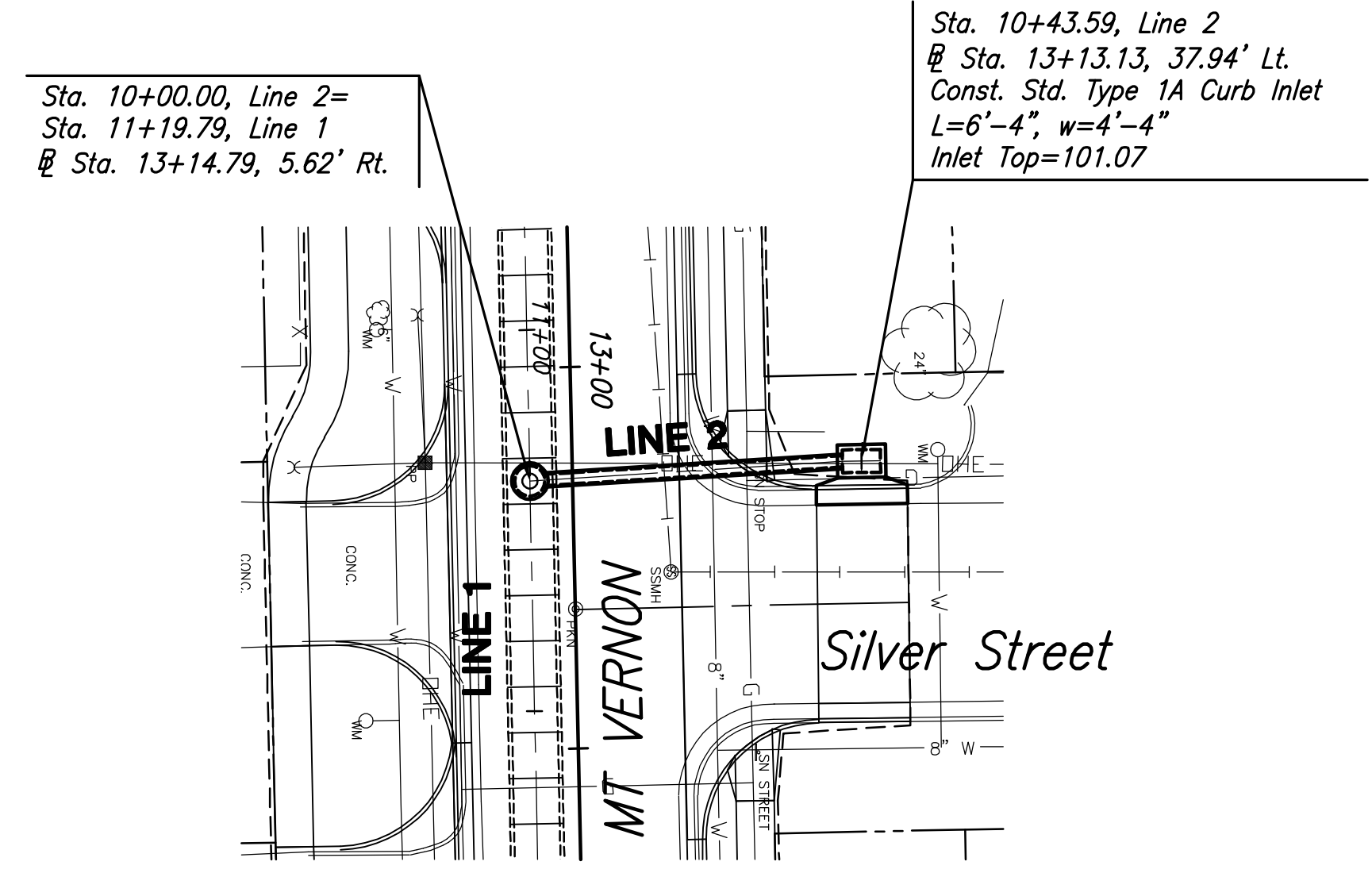
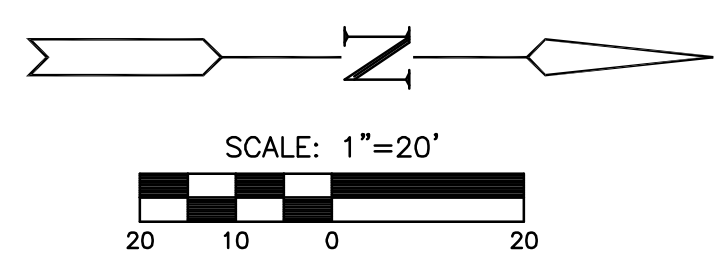

**PLAN-LINE 2**  
SCALE: 1"=20'

Sta. 10+42.40, Line 3  
@ Sta. 16+74.57, 38.78' Rt.  
Const. Std. Type 1 Curb Inlet  
L=11'-4", W=6'-4"  
Inlet Top=99.94

Sta. 10+00.00, Line 3=  
Sta. 10+00.00, Line 4=  
Sta. 10+00.00, Line 5=  
Sta. 10+00.00, Line 6=  
Sta. 14+73.79, Line 1  
@ Sta. 16+68.79, 5.96' Rt.

Sta. 10+17.33, Line 6  
@ Sta. 16+53.80, 17.50' Rt.  
Const. Std. Type 1 Inlet  
L=11'-4", W=4'-4"  
Inlet Top=100.03

Sta. 10+30.45 Line 5  
@ Sta. 16+74.23, 38.62' Rt.  
Const. Std. Type 1 Inlet  
L=11'-4", W=5'-4"  
Inlet Top=100.52

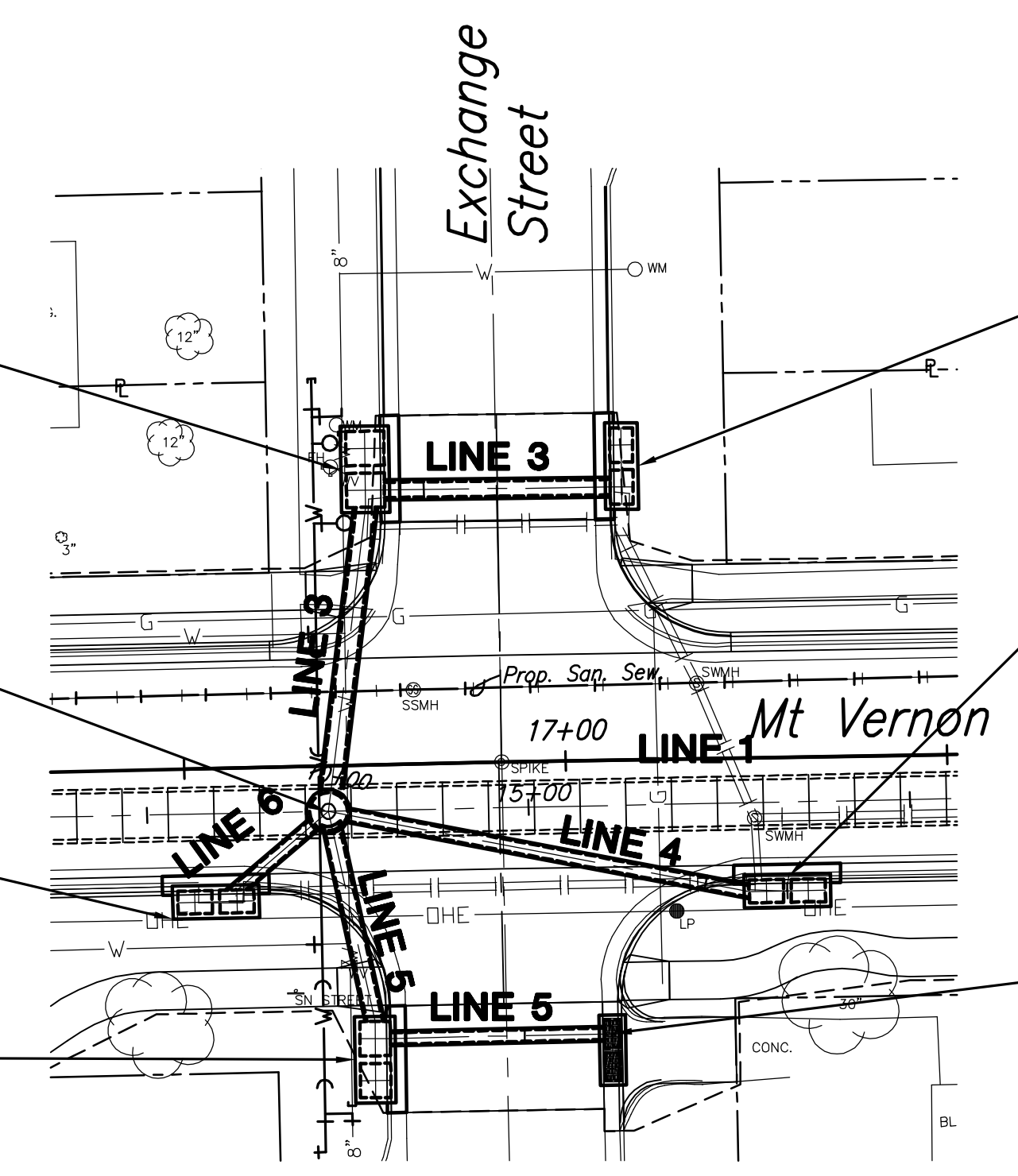

**PLAN-LINE 3, 4, 5, & 6**  
SCALE: 1"=20'

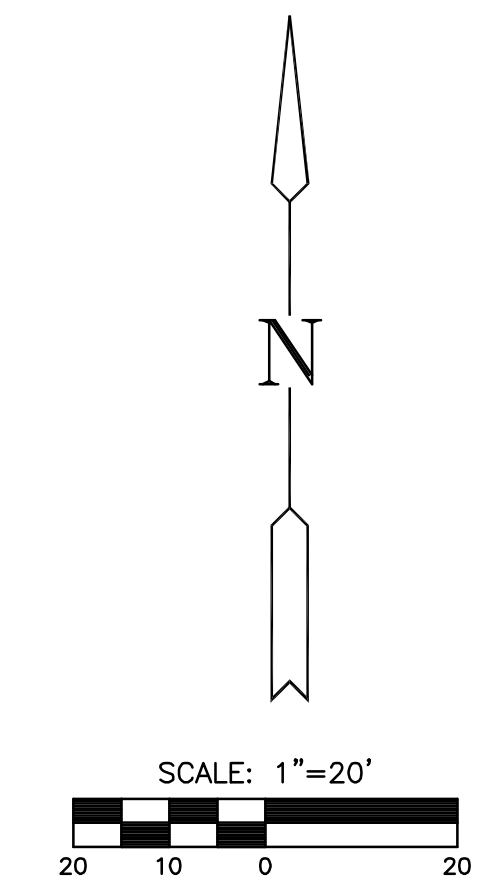

Sta. 10+75.98, Line 3  
@ Sta. 17+07.96, 38.56' Lt.  
Const. Std. Type 1 Curb Inlet  
L=11'-4", W=4'-4"  
Inlet Top=99.94

Sta. 10+61.13, Line 4=  
@ Sta. 17+28.78, 17.50' Rt.  
Const. Std. Type 1 Inlet  
L=10'-", W=4'-4"  
Inlet Top=100.27

Sta. 10+61.56, Line 5  
@ Sta. 17+05.55, 37.99' Rt.  
Const. Driveway Grated Inlet (Double)  
Inlet Top=100.26

**PROFILE-LINE 2**  
SCALE: HORIZ. 1"=20'  
SCALE: VERT. 1"=5'

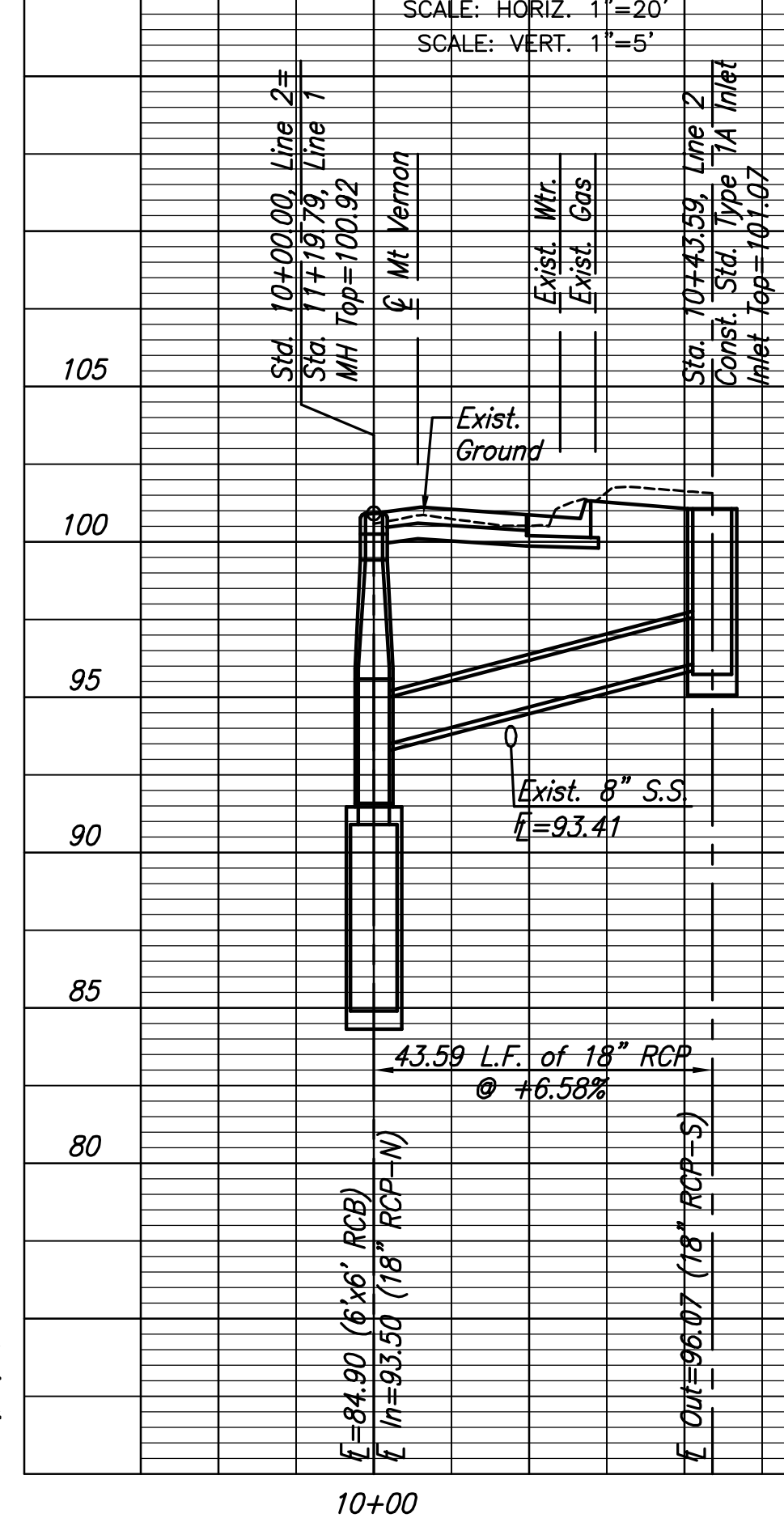

**PROFILE-LINE 3**  
SCALE: HORIZ. 1"=20'  
SCALE: VERT. 1"=5'

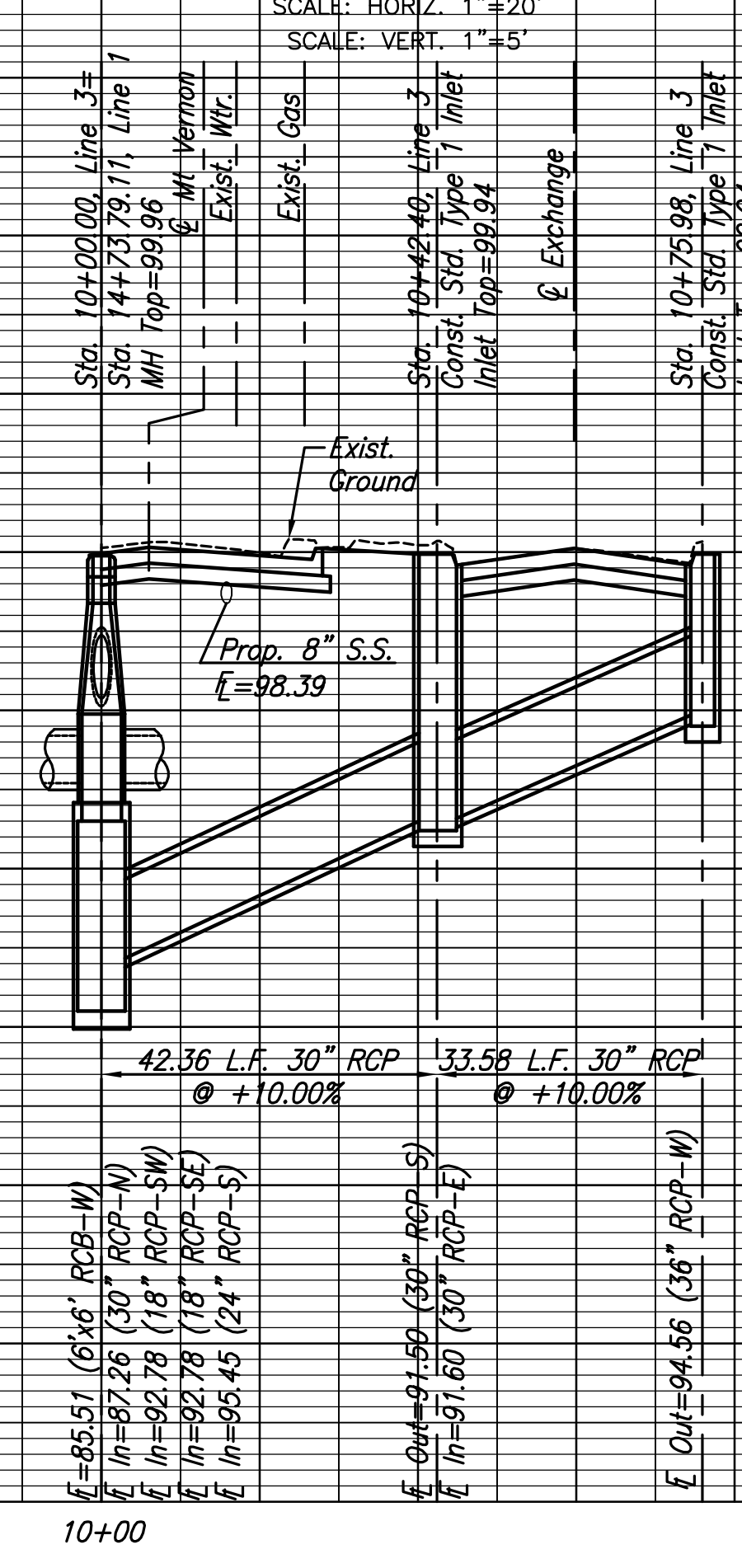

**PROFILE-LINE 4**  
SCALE: HORIZ. 1"=20'  
SCALE: VERT. 1"=5'

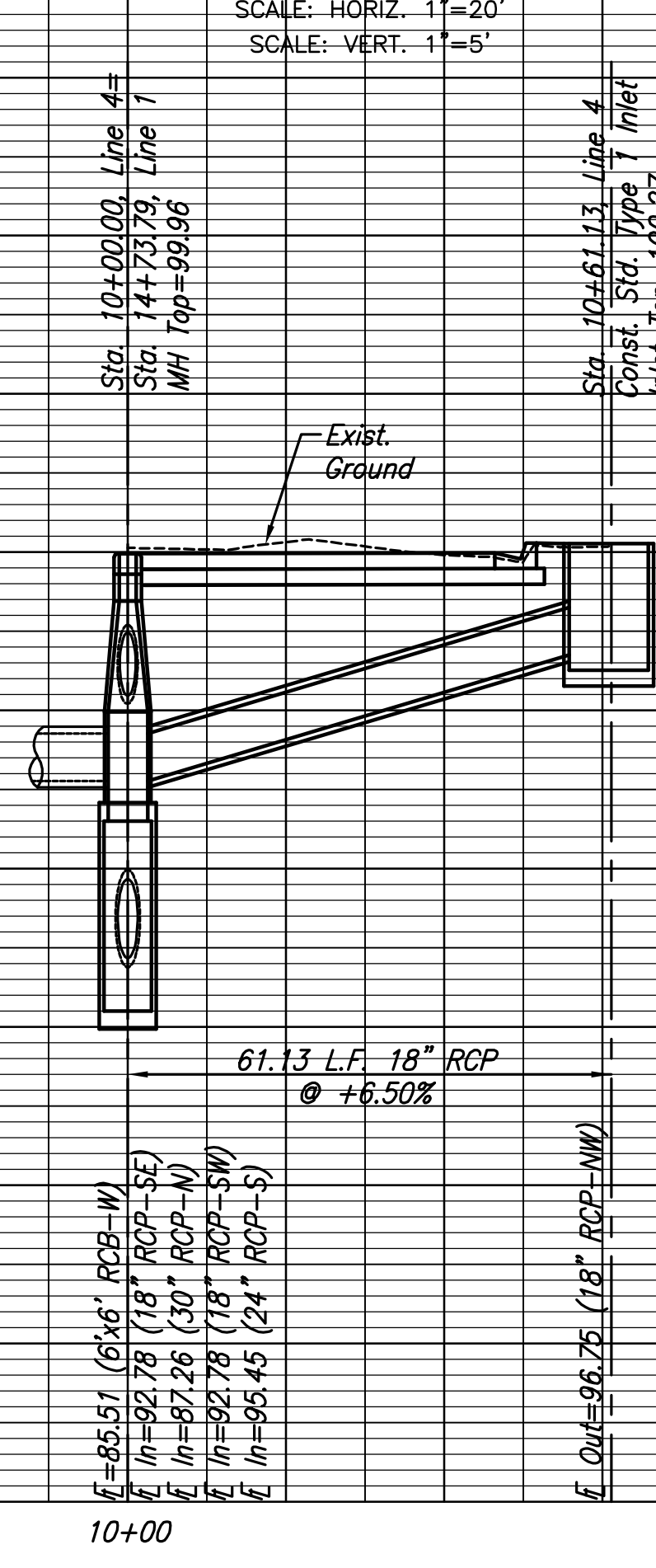

**PROFILE-LINE 5**  
SCALE: HORIZ. 1"=20'  
SCALE: VERT. 1"=5'

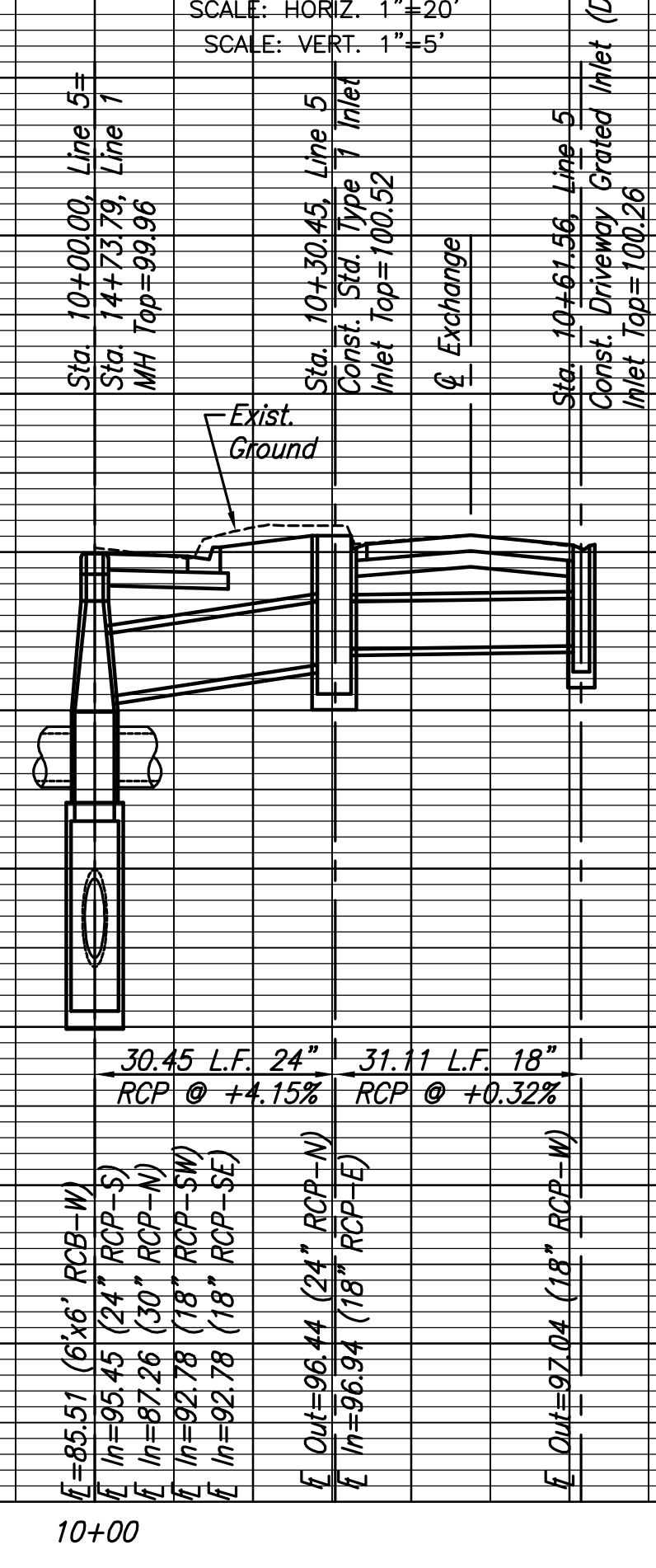

**PROFILE-LINE 6**  
SCALE: HORIZ. 1"=20'  
SCALE: VERT. 1"=5'

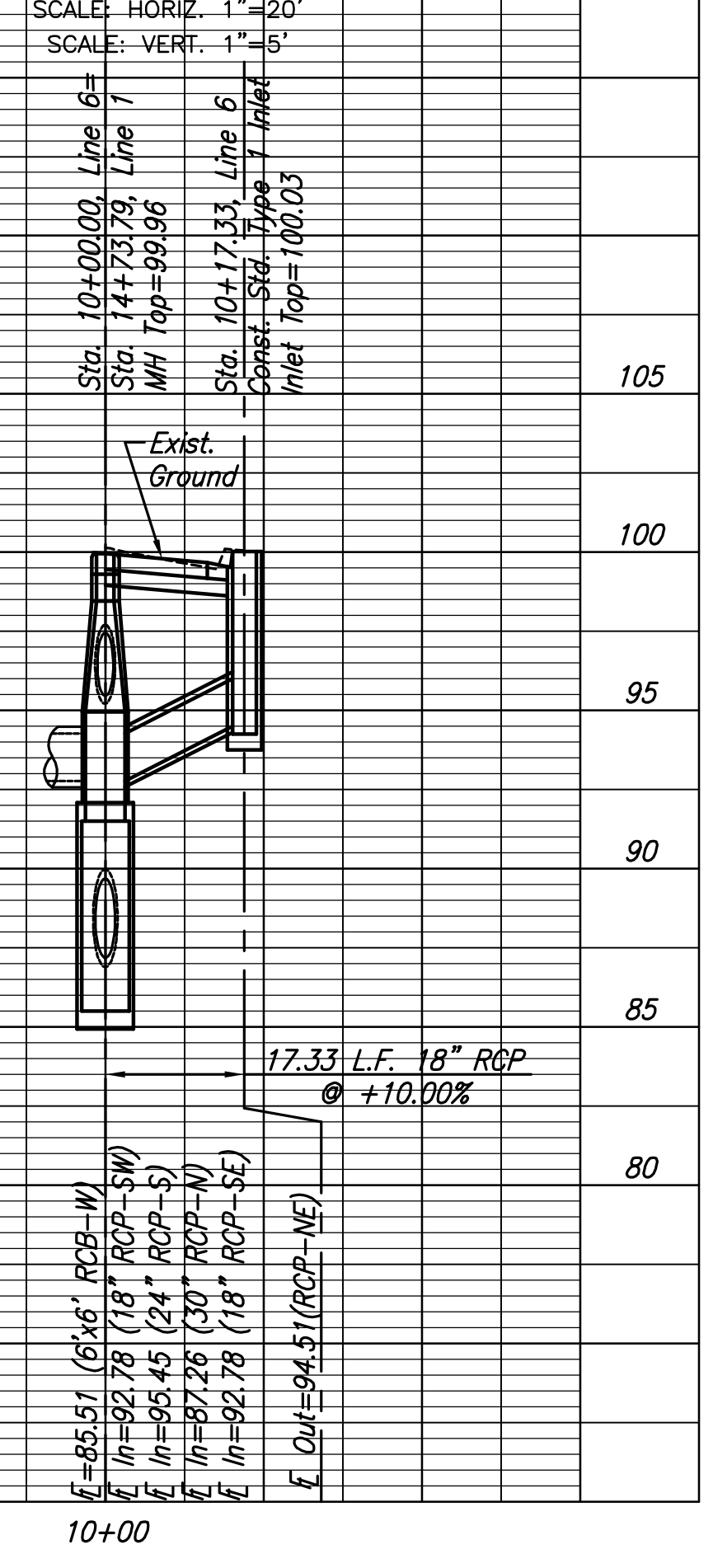

PLOTTED: Thursday, May 27, 2008 @ 04:32PM

J:\CIVIL\05620\DWG\SWS\05620-09.DWG