

B.M. 109.93 City Sta. B.M. in ctr. Island on E West St. 495' N. of iron on E Pawnee east.  
 B.M. 106.25 "A" cut on S.E. cor. Conc. manhole on W side West St. Sta. 33+16.  
 B.M. 104.94 R.R. Spike W. side Bell Pole on E side West St. Sta. 34+85.

NOTE: TO CONTRACTOR  
 Replace asphalt with asphaltic concrete  
 Sand fill all drives

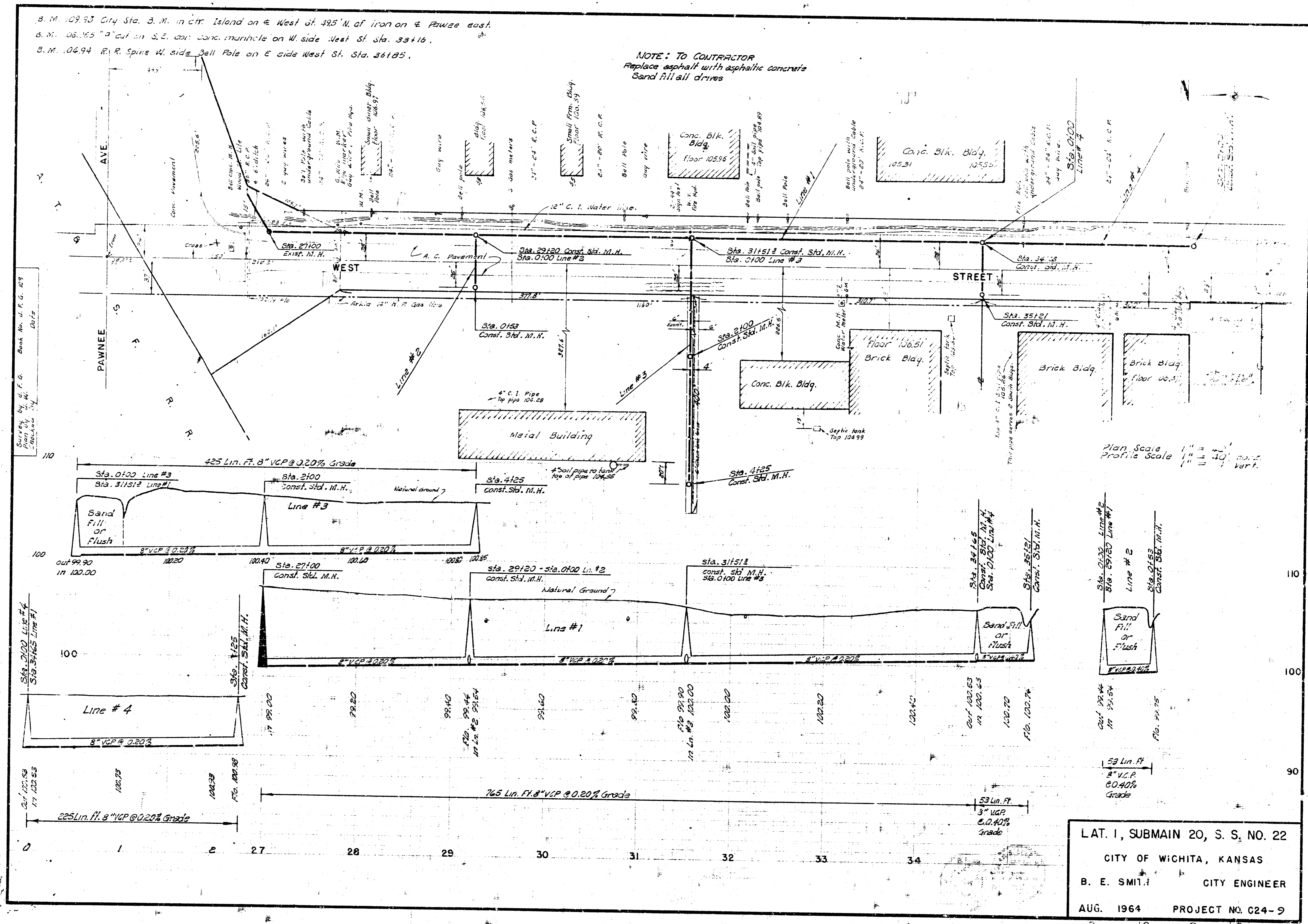

Plan Scale 1" = 40'  
 Profile Scale 1" = 4.0' vert.

LAT. 1, SUBMAIN 20, S. S. NO. 22  
 CITY OF WICHITA, KANSAS  
 B. E. SMITH CITY ENGINEER  
 AUG. 1964 PROJECT NO. C24-9