

B.M. 128.14 N.W. cor. conc. base brick sign "All Pets Hosp." S.S. 23rd E. of Salina

Plan Scale 1"=40'
Profile Scale 1"=4' Vert.

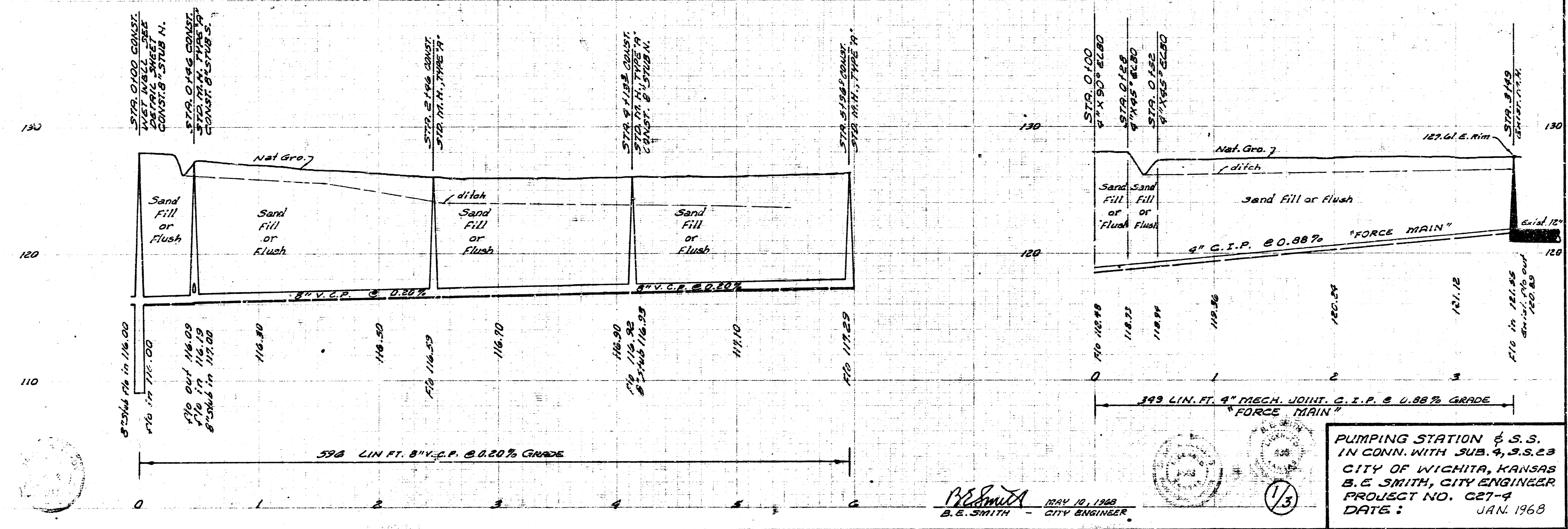

B.E. Smith
B.E. SMITH - MAY 10, 1968
CITY ENGINEER

PUMPING STATION & S.S.
IN CONN. WITH SUB. 4, S.S. 23
CITY OF WICHITA, KANSAS
B.E. SMITH, CITY ENGINEER
PROJECT NO. C27-9
DATE: JAN. 1968

