

B.M. 128.14 N.W. Cor. Conc. Base
For Brick Sign of M. Pets Hosp.
South Side 21st Street and East
of Salina Avenue.

NOTE:
No awards have been made for damages to fences and the
appraisers assume that the utility contractor will remove
where necessary and restore fences in as good condition
as possible.

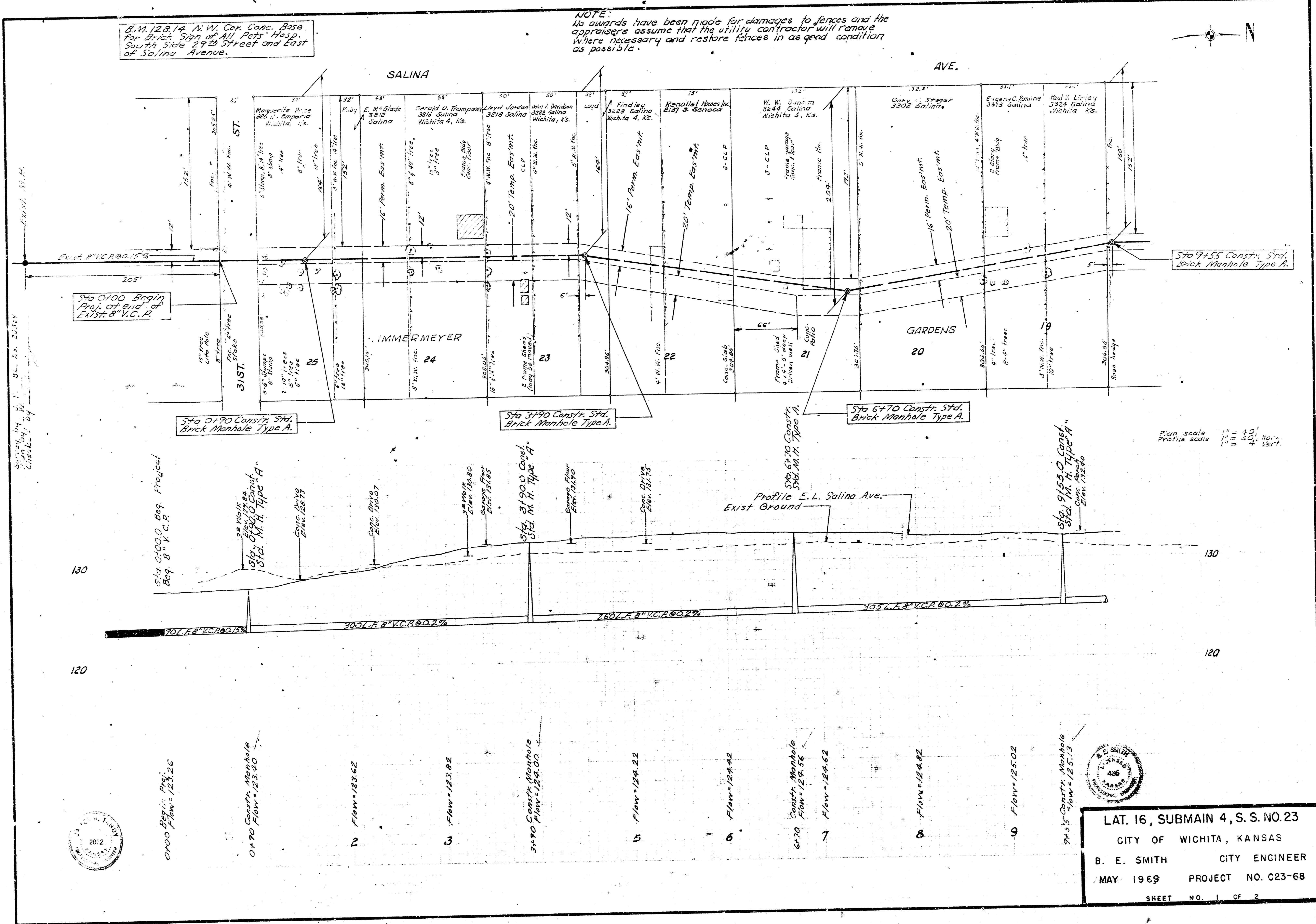

0+00 Exp. Proj.
Flow = 123.26

0+90 Const. Manhole
Flow = 123.40

2 Flow = 123.62

3 Flow = 123.82

3+90 Const. Manhole
Flow = 124.00

5 Flow = 124.22

6 Flow = 124.42

6+70 Const. Manhole
Flow = 124.66

7 Flow = 124.62

8 Flow = 124.82

9 Flow = 125.02

9+55 Const. Manhole
Flow = 125.15



LAT. 16, SUBMAIN 4, S. S. NO. 23
CITY OF WICHITA, KANSAS
B. E. SMITH CITY ENGINEER
MAY 1969 PROJECT NO. C23-68
SHEET NO. 1 OF 2

Plan scale 1" = 20' hor.
Profile scale 1" = 4' vert.

Sta 9+55 Const. Std. Brick Manhole Type A.

Sta 13+20 Const. Std. Brick Manhole Type A. End Project.

Sta 11+40 Const. Std. Brick Manhole Type A.

Plan Scale 1"=40'
Profile Scale Hor. 1"=40' Vert. 1"=4'

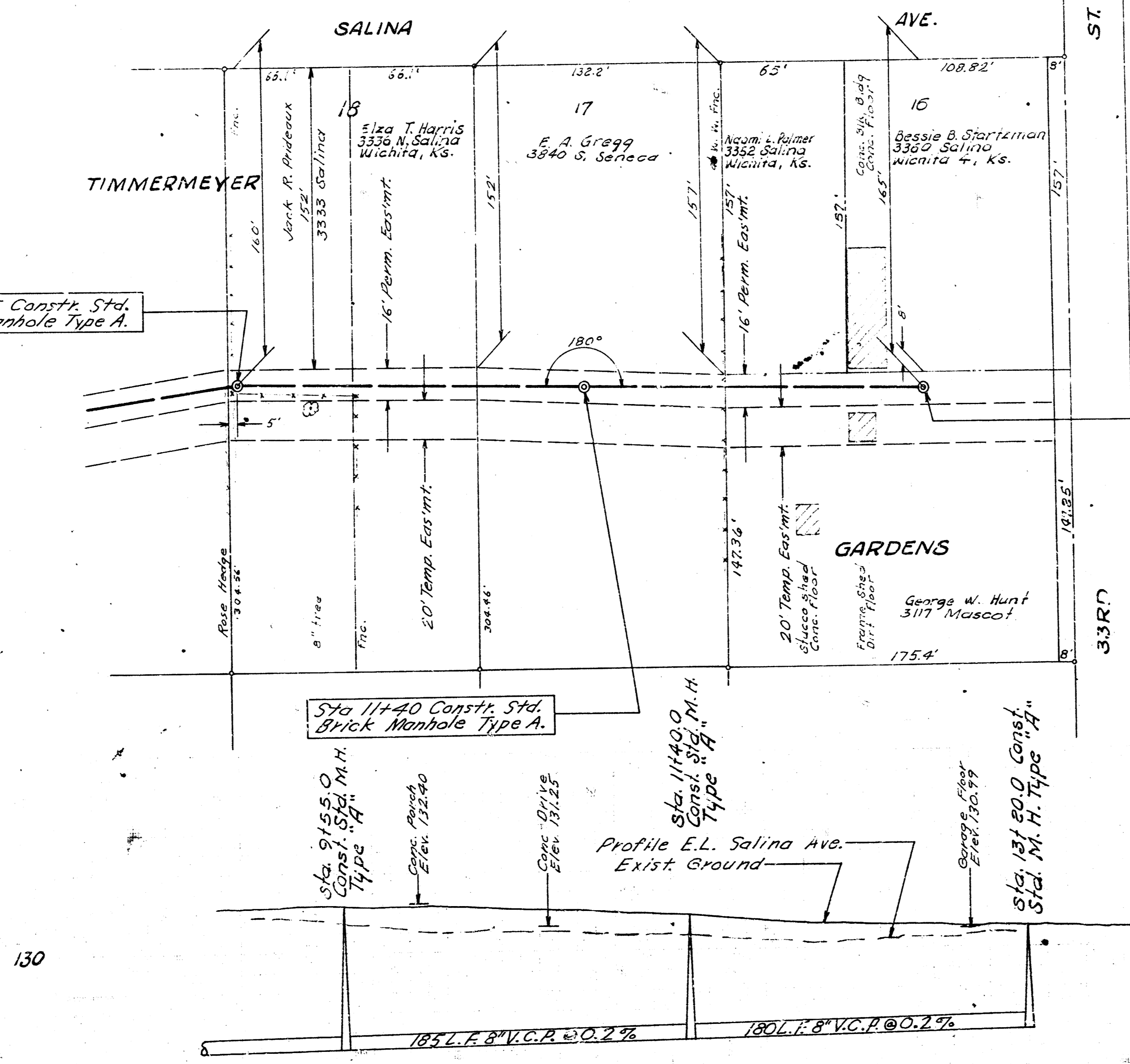

130

120

9 Flow = 125.02

9+55 Const. Manhole Flow = 125.15

10 Flow = 125.22

11 Flow = 125.42

11+40 Const. Manhole Flow = 125.20

12 Flow = 125.62

13 Flow = 125.82
13+20 Const. Manhole Flow = 125.86

LAT. 16, SUBMAIN 4, S.S. NO. 23
PROJECT NO. C23-68
SHEET NO. 2 OF 2