

SEC. 31, TWP. 26, R. 2, E

Plan Scale 1" = 40'
Profile Scale Vert. 1" = 5'
Horiz. 1" = 40'

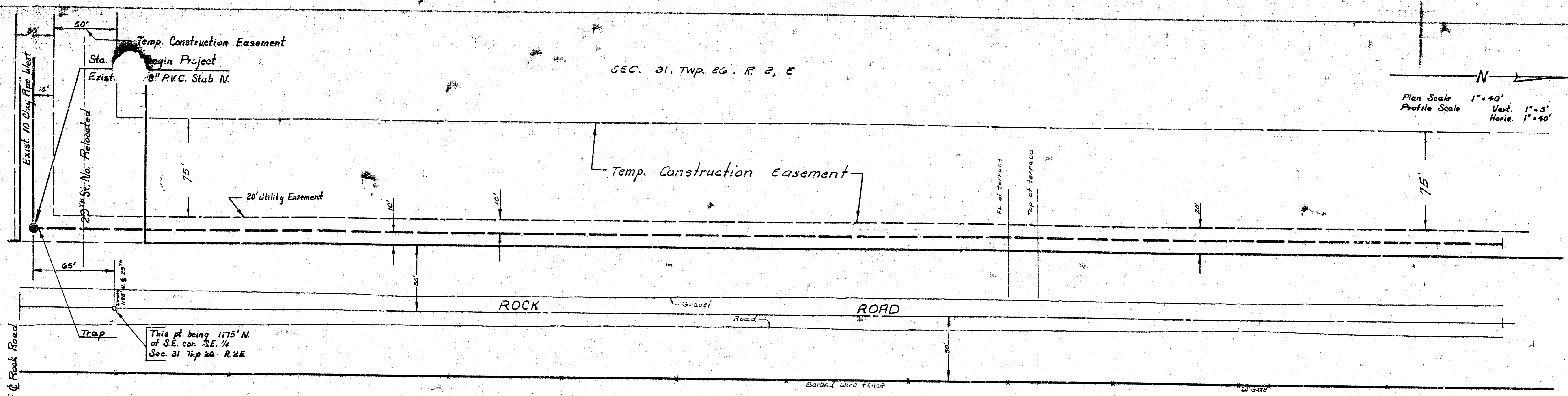

Note to Field Engineer:
Take ties to all irons and replace if disturbed.

Note:
Pipe used for force main as manufactured by Johns-Manville Co. may be J.M. Ring-Tite PVC or approved equal.

B.M. 213.30 ~ Std. S.W. cor. Rock Road & 29th
B.M. 202.23 ~ Std. Rock Road & 33rd, 48' E. & 44' N. 1/4 sec. cor.
B.M. 204.11 ~ Rock Road & 37th, 44' S. & 48' W. of & both

DATE	
SCALE	
PROJECT	
ENGINEER	
CITY	
NO.	

DATE	
SCALE	
PROJECT	
ENGINEER	
CITY	
NO.	

Sta. 0+00 ~ 100' N. of & Exist. 25" St. No. & 60' W. of & Rock Road
Sta. 0+10 ~ 10' E. of & Exist. 10" PVC Stub N.

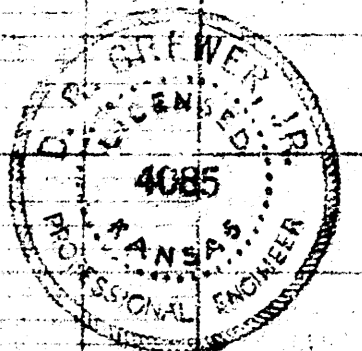
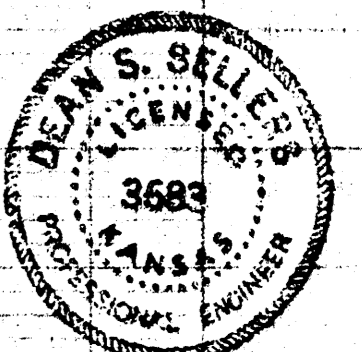
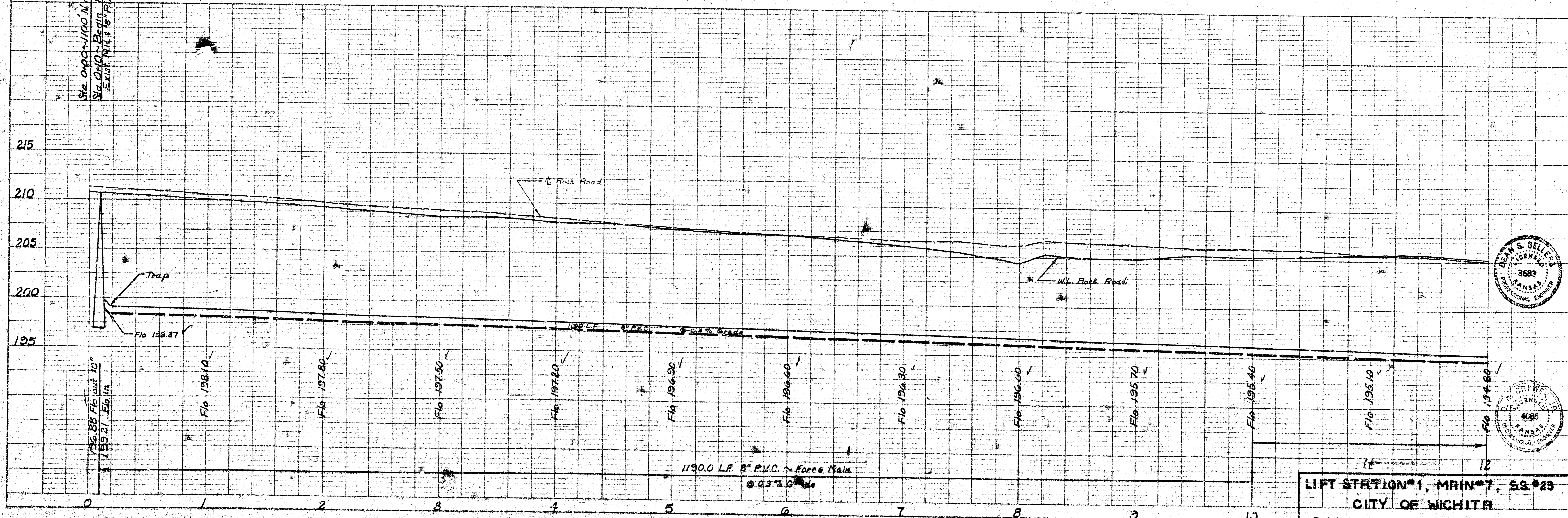

LIFT STATION #1, MRIN #7, SS #23
CITY OF WICHITA
R.W. LINN - CITY ENGINEER
DATE Aug. 1973 PROJ. NO. DBKP 575060

PLAN
 DATE: _____
 DRAWN BY: DLK/FRF
 CHECKED BY: _____
 PROJECT NO.: 573060

PROFILE
 DATE: _____
 DRAWN BY: _____
 CHECKED BY: _____
 PROJECT NO.: 573060

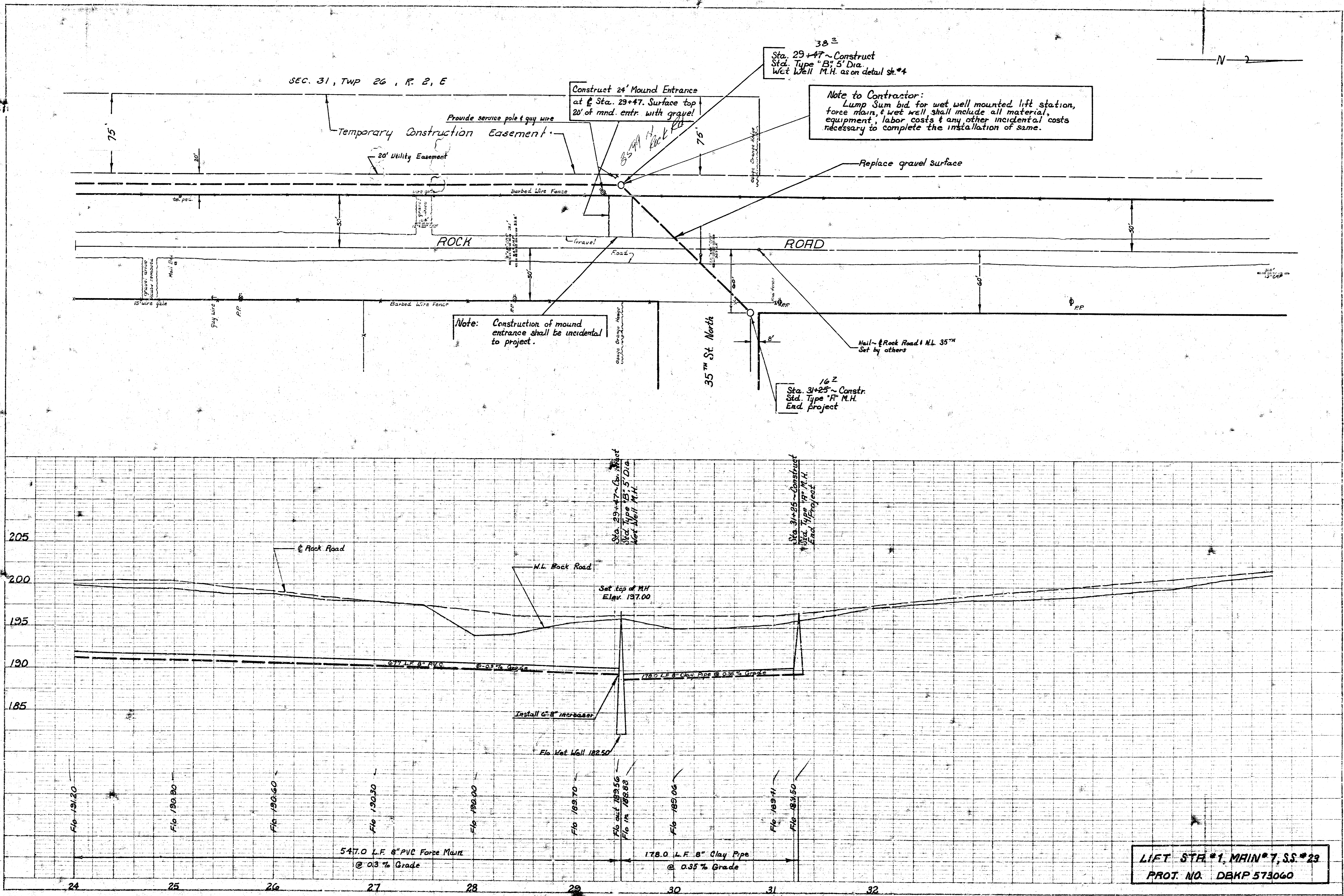

38 Z
 Sta. 29+47 ~ Construct
 Std. Type "B", 5' Dia.
 Wet Well M.H. as on detail sh.#4

Note to Contractor:
 Lump Sum bid for wet well mounted lift station, force main, & wet well shall include all material, equipment, labor costs & any other incidental costs necessary to complete the installation of same.

Note: Construction of mound entrance shall be incidental to project.

16 Z
 Sta. 31+25 ~ Constr.
 Std. Type "R", M.H.
 End Project

LIFT STA #1, MAIN #7, S.S. #23
 PROT. NO. DBKP 573060

Note: Contractor to provide service pole & guy wire & determine location in field for installation. Contact Mr. Steele with K.G.E. (commercial elec.) to determine when electric power will be available.
 Contractor to provide weatherproof disconnect switch as recommended by lift station supplier.

Note: Contractor to provide 1/4" service conduit from disconnect switch on service pole to station entrance. Conduit shall be rigid galv. metallic above grade & rigid non-metallic P.V.C. below grade. Provide equipment ground in P.V.C. conduit.

Note: Contractor to provide 6" discharge pipe

Note: Contractor to provide 6"-8" increaser outside wet well.

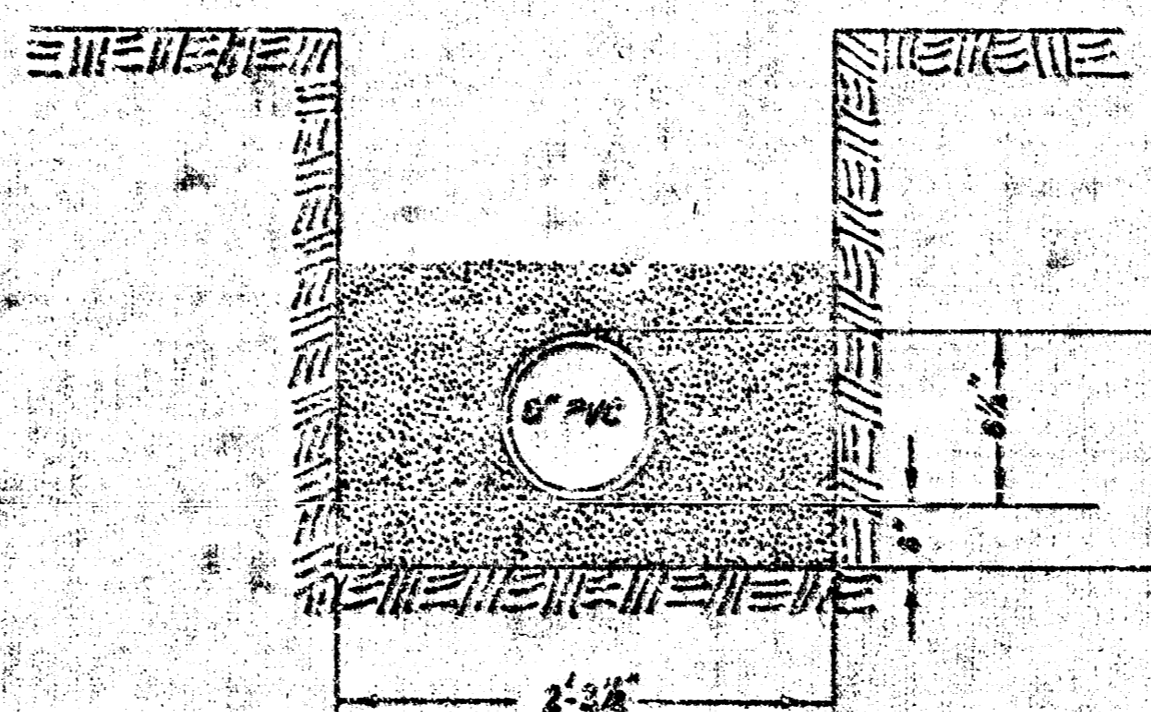
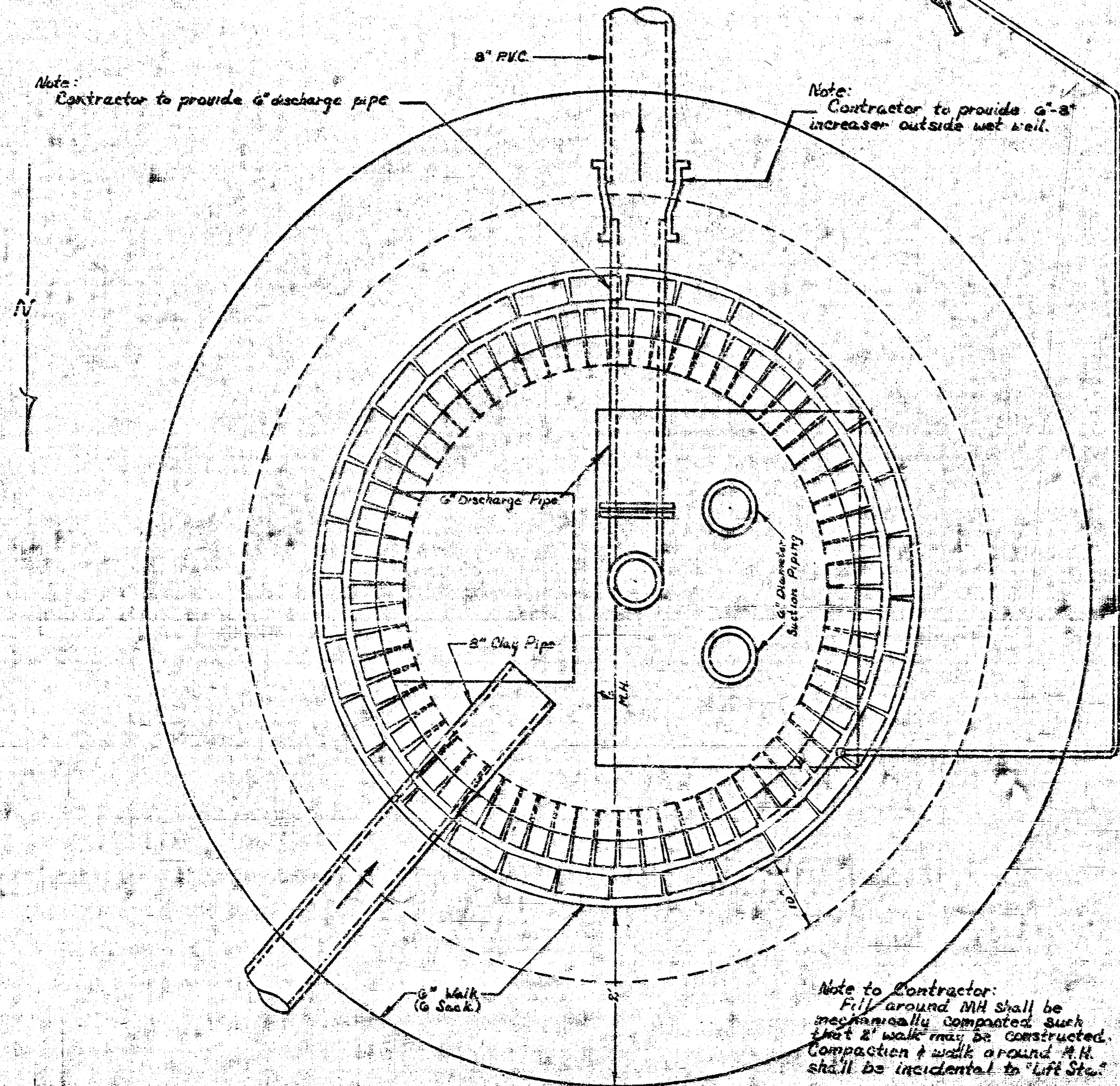

Typical Trench Secti

Note: Contractor shall sand backfill force main trench. Cast of furnishing sand, placing, vibrating & flushing same shall be included in Lump Sum bid of Lift Sta.

Note to Contractor: Fill around MH shall be mechanically compacted such that 2" walls may be constructed. Compaction & work around M.H. shall be incidental to Lift Sta.

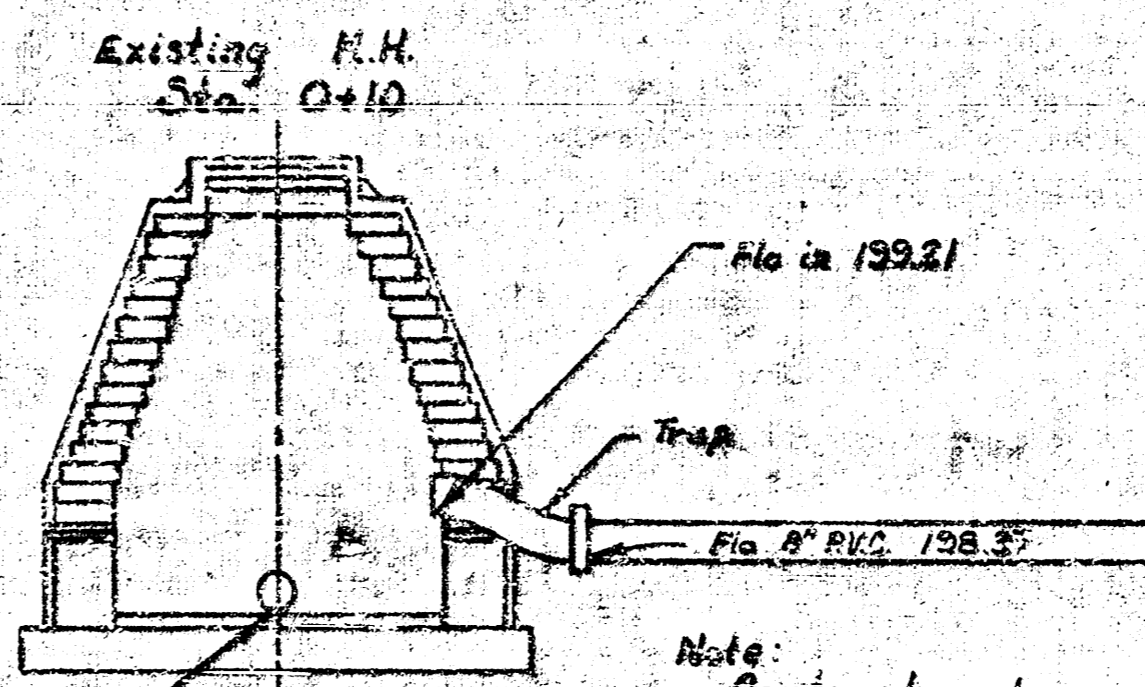

Note: Contractor to provide 8" trap at discharge manhole as shown in detail. Trap shall be included in Lump Sum Bid.

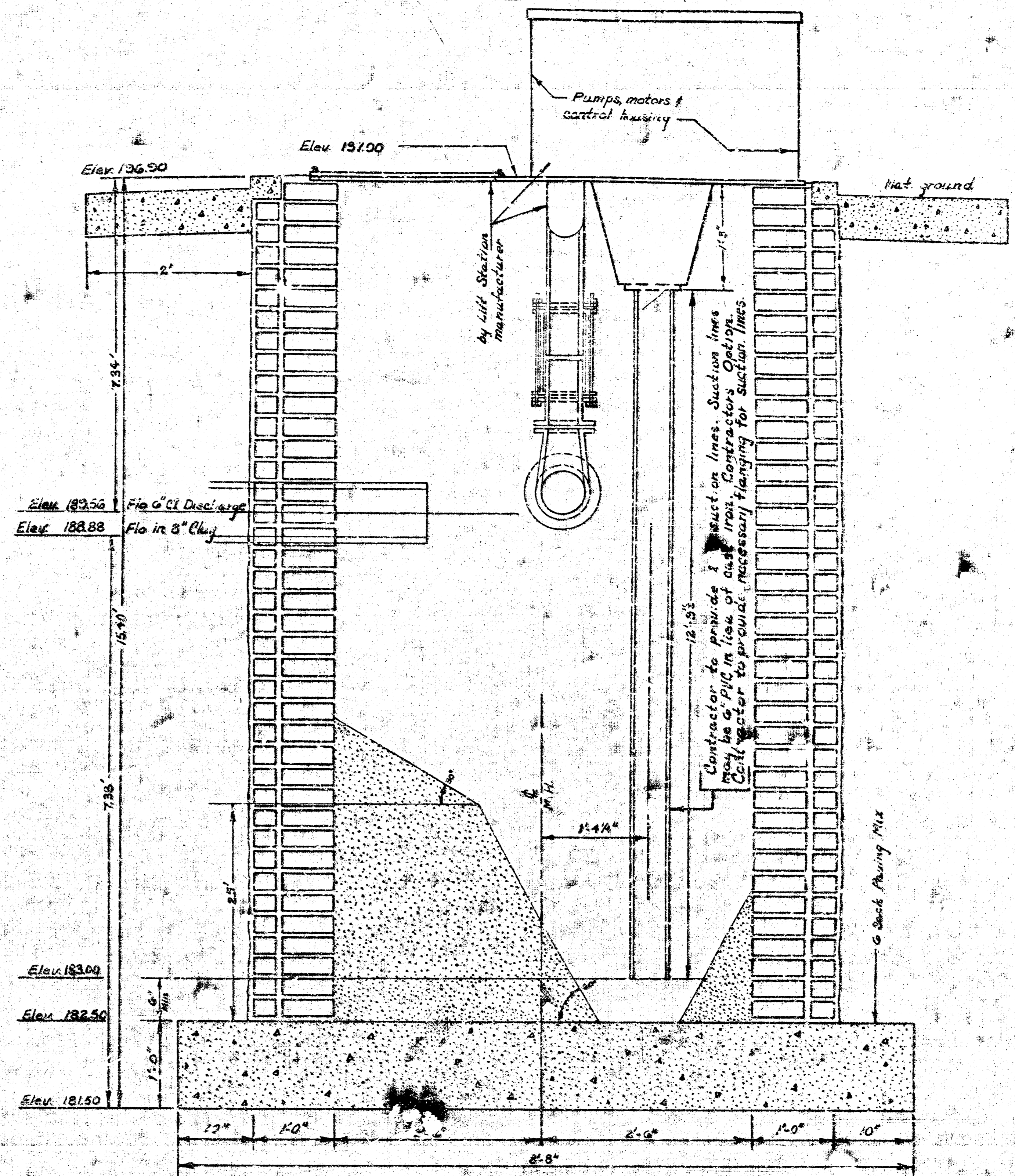

Type "B" 5' Diameter Wet Well

1/8

LIFT STA #1, MAIN #7, S.S. #23
 PROJ. NO. DBKP 573060

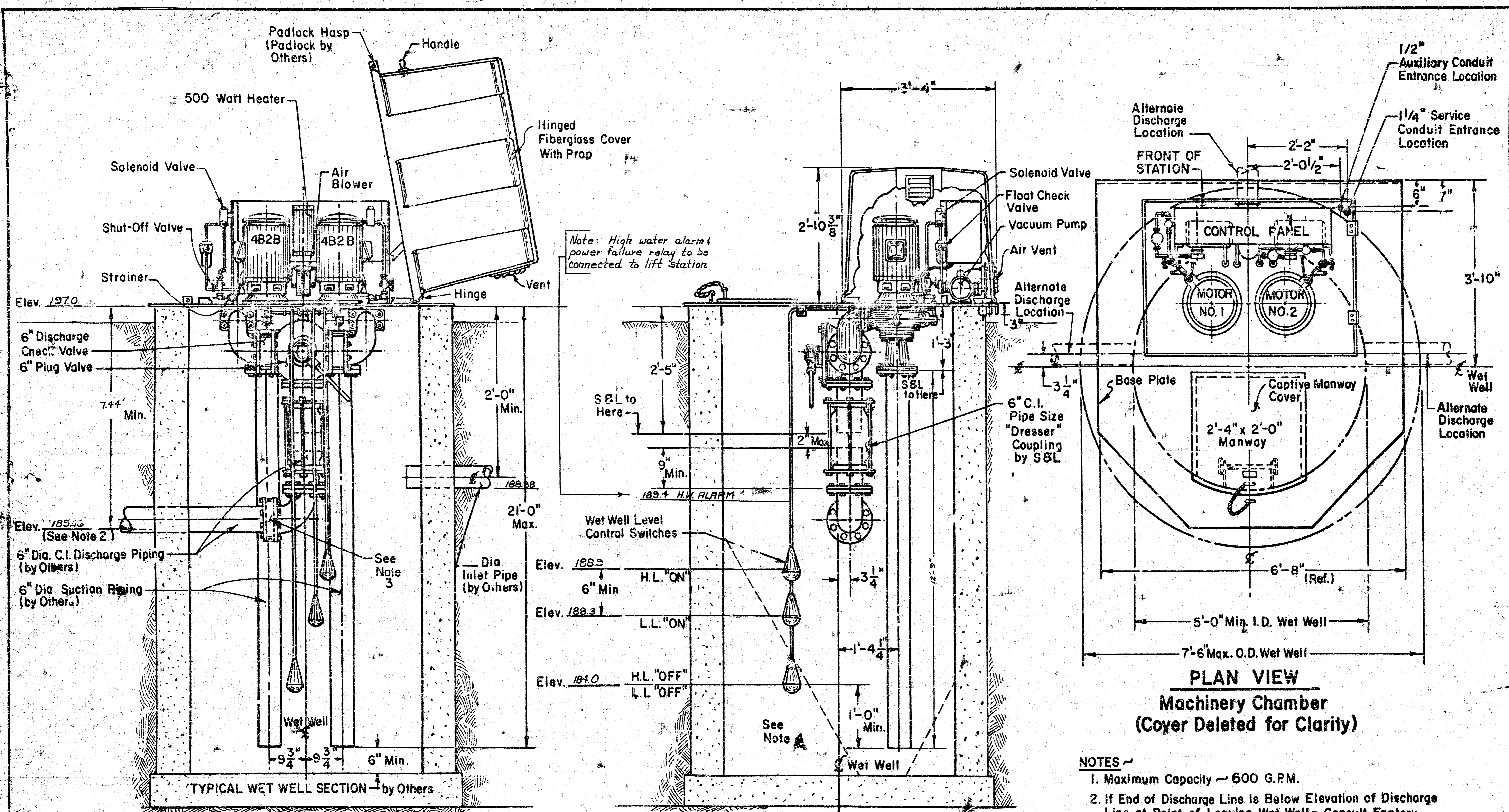

REAR ELEVATION

SIDE ELEVATION

PLAN VIEW
Machinery Chamber
(Cover Deleted for Clarity)

- NOTES**
1. Maximum Capacity — 600 G.P.M.
 2. If End of Discharge Line Is Below Elevation of Discharge Line at Point of Leaving Wet Well — Consult Factory.
 3. If Discharge Line Is Less Than 200 Ft. In Length, A Check Valve May Be Required — Consult Factory.

Note: High water alarm & power failure relay to be connected to lift station

See Note A

See Note 3

PATENTED IN THE U.S.A. & FOREIGN COUNTRIES N71-18
THE DESIGN AND DETAIL OF THIS DRAWING IS THE PROPERTY OF ECODYNE CORPORATION, SMITH & LOVELESS DIVISION AND IS NOT TO BE USED EXCEPT IN CONNECTION WITH OUR WORK. DESIGN AND INVENTION RIGHTS ARE RESERVED.

Ecodyne Corporation Smith & Loveless Division An Affiliate of Trans Union Corporation SIGN & SEAL Santa Fe Trail Lawrence, Kansas 66215		FOR	
WET-Well-MOUNTED SEWAGE PUMPING STATION - 5 FT. - 6 FT. I.D. WET WELLS		DRAWING NO. 86D107	
DESIGNED BY: MASLAM	DATE: 3-17	CHECKED BY: TIENH	DATE: 5-17
APPROVED BY: MARTIN	DATE: 5-17	SCALE: NONE	
LETTER: A	W71-18-1	BY: []	DATE: []
NO. []	DATE: []	APPR'D: []	SCALE: []

LIFT STR.#1, MAIN#7, S.S.#23
PROT. NO. DBKP 573060

5/5