

Pipe Sta 0+00, Line No. 1=
 @ "B" Sta 02+66.94, 410.05' RT.
 Construct MH #1
 City of Wichita Inside drop
 Manhole Type B or C

Remove and Replace Approx.
 1280 SY Asphalt Pavement
 per KDOT Sta. Specifications
 Thickness and Elevations
 to Match Existing

Pipe Sta 3+85.05, Line No. 1=
 Pipe Sta. 0+00, Line No. 2=
 @ "B" Sta 02+67. 25' RT.
 Construct MH #2
 City of Wichita Outside Drop
 Manhole Type B or C
 Install 1-8" stub (and plug) (N)

Remove & Replace
 Asphalt Pavement
 Provide temporary crushed
 rock surfacing as required
 See sheets DO-19-7E & DO-19-74

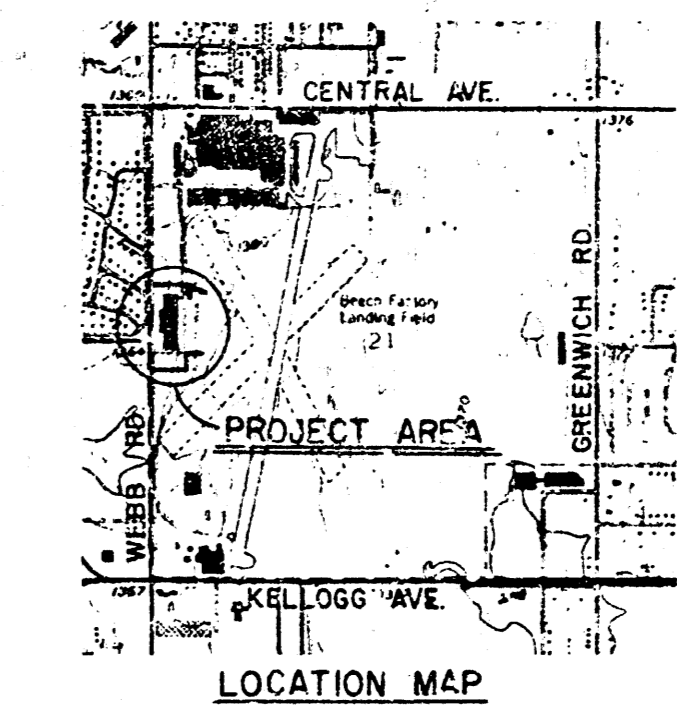

- GENERAL NOTES**
- THE CONTRACTOR SHALL MAINTAIN TRAFFIC THROUGHOUT THE PROJECT AT ALL TIMES. THE CONTRACTOR SHALL PROVIDE TRAFFIC LIGHTS, AND BARRIERS TO ENSURE SAFETY.
 - THE CONTRACTOR SHALL COORDINATE CONSTRUCTION WITH BEECH AIRCRAFT CORPORATION, PLANT ENGINEERING DEPARTMENT.
 - ALL CONSTRUCTION AND MATERIALS TO COMPLY WITH CITY OF WICHITA SPECIFICATIONS AND STANDARDS UNLESS OTHERWISE NOTED.
 - ANY FENCE DAMAGED DURING CONSTRUCTION SHALL BE REPAIRED AND REPLACED TO EXISTING CONDITION.
 - ALL EXCESS EXCAVATION AND DEBRIS SHALL BE REMOVED FROM THE JOB SITE BY THE CONTRACTOR AND DISPOSED OF AS DIRECTED BY THE OWNER.
 - SAND ACCESS SHALL COMPLY WITH THE CITY OF WICHITA STANDARDS SPECIFICATIONS AND SHALL BE FENCED TO 100% OF 20% DRAIN.
 - INSPECTION SHALL BE BY PROFESSIONAL ENGINEERING CONSULTANTS, P.A.
 - ALL MATERIALS FOR MANHOLES SHALL BE EQUIVALENT TO THAT SPECIFIED FOR THE ADJACENT SEWER LINES UNLESS OTHERWISE NOTED AND SHALL BE CONSIDERED SUFFICIENT TO THE PRICE BID FOR MANHOLES.
 - CONCRETE SHALL HAVE A 28-DAY COMPRESSIVE STRENGTH OF 4,000 PSI, 4.5 BAGS CEMENTITY, 5.5 GAL. WATER/CUBIC YARD. CONCRETE SHALL BE AIR ENTRAINMENT 15 TO 20% AGGREGATE SHALL PASS THROUGH 3/4" SIEVE AND NOT BE LESS THAN 10% BY WEIGHT WATER TESTED IN ACCORDANCE WITH ASTM C-136. PERCENTAGE OF MOISTURE BY WEIGHT TESTED SHALL BE LESS THAN 1%. CONCRETE AGGREGATE TO FINER (GRADE 40-SIEVE) RETAINED ON 10/16 SIEVE AND 10/20 SIEVE (NO. 20 SIEVE) SHALL BE SUCH THAT NOT MORE THAN 10% SHALL PASS THE 10 SIEVE, SLUMP 1 TO 3 INCHES.
 - THE CONTRACTOR SHALL ARRANGE FOR THE CITY OF WICHITA TO DO ALL TESTING AND TELEVISION INSPECTION OF THE COMPLETED SEWER LINE. TESTING AND INSPECTION SHALL BE PAID FOR BY THE CONTRACTOR IN ACCORDANCE WITH CITY OF WICHITA SPECIFICATIONS.
 - AT LEAST 24 HOURS PRIOR TO BEGINNING EXCAVATION (INCLUDING WEIGHING AND HOLDING) THE CONTRACTOR SHALL CONTACT THE UTILITY LOCATION SERVICE ("TWO-CALL") AT (316) 947-2889 TO REQUEST THE FOLLOWING UTILITY COMPANIES TO LOCATE ANY EXISTING LINES WITHIN THE PROJECT AREA: GAS SERVICE CO., E.L.F., KOPPELSTEIN WELL TELEPHONE CO., THE WICHITA WATER DEPT., AIR CATALYTIC CORPORATION, AND AREA GAS CO.
 - THE CONTRACTOR SHALL ALSO CALL THE UTILITY COMPANIES LISTED BELOW AT LEAST 48 HOURS PRIOR TO BEGINNING EXCAVATION (INCLUDING WEIGHING AND HOLDING) TO REQUEST LOCATIONS OF EXISTING UTILITIES WITHIN THE PROJECT AREA:
 FREE WARSALL
 BEECH AIRCRAFT CORP.
 841-7729 L. A. FUSION
 841-4008 DISPOSITION
 - THE BURIED UTILITIES AS LOCATED ON THE PLANS ARE APPROXIMATE LOCATIONS ONLY. IT SHOULD BE NOTED THAT OTHER BURIED PIPELINES AND CABLES MAY EXIST WHICH ARE NOT SHOWN ON THE PLANS. THE CONTRACTOR SHALL EXERCISE EXTREME CARE DURING TRENCHING OPERATIONS TO AVOID DAMAGING ALL LINES. ANY LINES DAMAGED SHALL BE REPAIRED OR REPLACED IMMEDIATELY AS RETURNED BY THE LINES AT THE CONTRACTOR'S EXPENSE.
 - CONTRACTOR SHALL SATISFY HIMSELF OF SUBSURFACE SOIL CONDITIONS PRIOR TO EXCAVATION.
 - PRIOR TO BEGINNING CONSTRUCTION, THE CONTRACTOR SHALL EXCAVATE AND VERIFY THE HORIZONTAL AND VERTICAL LOCATION OF THE EXISTING "SANITARY SEWER" PROPOSED IN 1" AND 2" AND 3" AND 4" AND 5" AND 6" AND 8" AND 10" AND 12" AND 14" AND 16" AND 18" AND 20" AND 24" AND 30" AND 36" AND 42" AND 48" AND 54" AND 60" AND 72" AND 78" AND 84" AND 90" AND 96" AND 102" AND 108" AND 114" AND 120" AND 126" AND 132" AND 138" AND 144" AND 150" AND 156" AND 162" AND 168" AND 174" AND 180" AND 186" AND 192" AND 198" AND 204" AND 210" AND 216" AND 222" AND 228" AND 234" AND 240" AND 246" AND 252" AND 258" AND 264" AND 270" AND 276" AND 282" AND 288" AND 294" AND 300" AND 306" AND 312" AND 318" AND 324" AND 330" AND 336" AND 342" AND 348" AND 354" AND 360" AND 366" AND 372" AND 378" AND 384" AND 390" AND 396" AND 402" AND 408" AND 414" AND 420" AND 426" AND 432" AND 438" AND 444" AND 450" AND 456" AND 462" AND 468" AND 474" AND 480" AND 486" AND 492" AND 498" AND 504" AND 510" AND 516" AND 522" AND 528" AND 534" AND 540" AND 546" AND 552" AND 558" AND 564" AND 570" AND 576" AND 582" AND 588" AND 594" AND 600" AND 606" AND 612" AND 618" AND 624" AND 630" AND 636" AND 642" AND 648" AND 654" AND 660" AND 666" AND 672" AND 678" AND 684" AND 690" AND 696" AND 702" AND 708" AND 714" AND 720" AND 726" AND 732" AND 738" AND 744" AND 750" AND 756" AND 762" AND 768" AND 774" AND 780" AND 786" AND 792" AND 798" AND 804" AND 810" AND 816" AND 822" AND 828" AND 834" AND 840" AND 846" AND 852" AND 858" AND 864" AND 870" AND 876" AND 882" AND 888" AND 894" AND 900" AND 906" AND 912" AND 918" AND 924" AND 930" AND 936" AND 942" AND 948" AND 954" AND 960" AND 966" AND 972" AND 978" AND 984" AND 990" AND 996" AND 1002" AND 1008" AND 1014" AND 1020" AND 1026" AND 1032" AND 1038" AND 1044" AND 1050" AND 1056" AND 1062" AND 1068" AND 1074" AND 1080" AND 1086" AND 1092" AND 1098" AND 1104" AND 1110" AND 1116" AND 1122" AND 1128" AND 1134" AND 1140" AND 1146" AND 1152" AND 1158" AND 1164" AND 1170" AND 1176" AND 1182" AND 1188" AND 1194" AND 1200" AND 1206" AND 1212" AND 1218" AND 1224" AND 1230" AND 1236" AND 1242" AND 1248" AND 1254" AND 1260" AND 1266" AND 1272" AND 1278" AND 1284" AND 1290" AND 1296" AND 1302" AND 1308" AND 1314" AND 1320" AND 1326" AND 1332" AND 1338" AND 1344" AND 1350" AND 1356" AND 1362" AND 1368" AND 1374" AND 1380" AND 1386" AND 1392" AND 1398" AND 1404" AND 1410" AND 1416" AND 1422" AND 1428" AND 1434" AND 1440" AND 1446" AND 1452" AND 1458" AND 1464" AND 1470" AND 1476" AND 1482" AND 1488" AND 1494" AND 1500" AND 1506" AND 1512" AND 1518" AND 1524" AND 1530" AND 1536" AND 1542" AND 1548" AND 1554" AND 1560" AND 1566" AND 1572" AND 1578" AND 1584" AND 1590" AND 1596" AND 1602" AND 1608" AND 1614" AND 1620" AND 1626" AND 1632" AND 1638" AND 1644" AND 1650" AND 1656" AND 1662" AND 1668" AND 1674" AND 1680" AND 1686" AND 1692" AND 1698" AND 1704" AND 1710" AND 1716" AND 1722" AND 1728" AND 1734" AND 1740" AND 1746" AND 1752" AND 1758" AND 1764" AND 1770" AND 1776" AND 1782" AND 1788" AND 1794" AND 1800" AND 1806" AND 1812" AND 1818" AND 1824" AND 1830" AND 1836" AND 1842" AND 1848" AND 1854" AND 1860" AND 1866" AND 1872" AND 1878" AND 1884" AND 1890" AND 1896" AND 1902" AND 1908" AND 1914" AND 1920" AND 1926" AND 1932" AND 1938" AND 1944" AND 1950" AND 1956" AND 1962" AND 1968" AND 1974" AND 1980" AND 1986" AND 1992" AND 1998" AND 2004" AND 2010" AND 2016" AND 2022" AND 2028" AND 2034" AND 2040" AND 2046" AND 2052" AND 2058" AND 2064" AND 2070" AND 2076" AND 2082" AND 2088" AND 2094" AND 2100" AND 2106" AND 2112" AND 2118" AND 2124" AND 2130" AND 2136" AND 2142" AND 2148" AND 2154" AND 2160" AND 2166" AND 2172" AND 2178" AND 2184" AND 2190" AND 2196" AND 2202" AND 2208" AND 2214" AND 2220" AND 2226" AND 2232" AND 2238" AND 2244" AND 2250" AND 2256" AND 2262" AND 2268" AND 2274" AND 2280" AND 2286" AND 2292" AND 2298" AND 2304" AND 2310" AND 2316" AND 2322" AND 2328" AND 2334" AND 2340" AND 2346" AND 2352" AND 2358" AND 2364" AND 2370" AND 2376" AND 2382" AND 2388" AND 2394" AND 2400" AND 2406" AND 2412" AND 2418" AND 2424" AND 2430" AND 2436" AND 2442" AND 2448" AND 2454" AND 2460" AND 2466" AND 2472" AND 2478" AND 2484" AND 2490" AND 2496" AND 2502" AND 2508" AND 2514" AND 2520" AND 2526" AND 2532" AND 2538" AND 2544" AND 2550" AND 2556" AND 2562" AND 2568" AND 2574" AND 2580" AND 2586" AND 2592" AND 2598" AND 2604" AND 2610" AND 2616" AND 2622" AND 2628" AND 2634" AND 2640" AND 2646" AND 2652" AND 2658" AND 2664" AND 2670" AND 2676" AND 2682" AND 2688" AND 2694" AND 2700" AND 2706" AND 2712" AND 2718" AND 2724" AND 2730" AND 2736" AND 2742" AND 2748" AND 2754" AND 2760" AND 2766" AND 2772" AND 2778" AND 2784" AND 2790" AND 2796" AND 2802" AND 2808" AND 2814" AND 2820" AND 2826" AND 2832" AND 2838" AND 2844" AND 2850" AND 2856" AND 2862" AND 2868" AND 2874" AND 2880" AND 2886" AND 2892" AND 2898" AND 2904" AND 2910" AND 2916" AND 2922" AND 2928" AND 2934" AND 2940" AND 2946" AND 2952" AND 2958" AND 2964" AND 2970" AND 2976" AND 2982" AND 2988" AND 2994" AND 3000" AND 3006" AND 3012" AND 3018" AND 3024" AND 3030" AND 3036" AND 3042" AND 3048" AND 3054" AND 3060" AND 3066" AND 3072" AND 3078" AND 3084" AND 3090" AND 3096" AND 3102" AND 3108" AND 3114" AND 3120" AND 3126" AND 3132" AND 3138" AND 3144" AND 3150" AND 3156" AND 3162" AND 3168" AND 3174" AND 3180" AND 3186" AND 3192" AND 3198" AND 3204" AND 3210" AND 3216" AND 3222" AND 3228" AND 3234" AND 3240" AND 3246" AND 3252" AND 3258" AND 3264" AND 3270" AND 3276" AND 3282" AND 3288" AND 3294" AND 3300" AND 3306" AND 3312" AND 3318" AND 3324" AND 3330" AND 3336" AND 3342" AND 3348" AND 3354" AND 3360" AND 3366" AND 3372" AND 3378" AND 3384" AND 3390" AND 3396" AND 3402" AND 3408" AND 3414" AND 3420" AND 3426" AND 3432" AND 3438" AND 3444" AND 3450" AND 3456" AND 3462" AND 3468" AND 3474" AND 3480" AND 3486" AND 3492" AND 3498" AND 3504" AND 3510" AND 3516" AND 3522" AND 3528" AND 3534" AND 3540" AND 3546" AND 3552" AND 3558" AND 3564" AND 3570" AND 3576" AND 3582" AND 3588" AND 3594" AND 3600" AND 3606" AND 3612" AND 3618" AND 3624" AND 3630" AND 3636" AND 3642" AND 3648" AND 3654" AND 3660" AND 3666" AND 3672" AND 3678" AND 3684" AND 3690" AND 3696" AND 3702" AND 3708" AND 3714" AND 3720" AND 3726" AND 3732" AND 3738" AND 3744" AND 3750" AND 3756" AND 3762" AND 3768" AND 3774" AND 3780" AND 3786" AND 3792" AND 3798" AND 3804" AND 3810" AND 3816" AND 3822" AND 3828" AND 3834" AND 3840" AND 3846" AND 3852" AND 3858" AND 3864" AND 3870" AND 3876" AND 3882" AND 3888" AND 3894" AND 3900" AND 3906" AND 3912" AND 3918" AND 3924" AND 3930" AND 3936" AND 3942" AND 3948" AND 3954" AND 3960" AND 3966" AND 3972" AND 3978" AND 3984" AND 3990" AND 3996" AND 4002" AND 4008" AND 4014" AND 4020" AND 4026" AND 4032" AND 4038" AND 4044" AND 4050" AND 4056" AND 4062" AND 4068" AND 4074" AND 4080" AND 4086" AND 4092" AND 4098" AND 4104" AND 4110" AND 4116" AND 4122" AND 4128" AND 4134" AND 4140" AND 4146" AND 4152" AND 4158" AND 4164" AND 4170" AND 4176" AND 4182" AND 4188" AND 4194" AND 4200" AND 4206" AND 4212" AND 4218" AND 4224" AND 4230" AND 4236" AND 4242" AND 4248" AND 4254" AND 4260" AND 4266" AND 4272" AND 4278" AND 4284" AND 4290" AND 4296" AND 4302" AND 4308" AND 4314" AND 4320" AND 4326" AND 4332" AND 4338" AND 4344" AND 4350" AND 4356" AND 4362" AND 4368" AND 4374" AND 4380" AND 4386" AND 4392" AND 4398" AND 4404" AND 4410" AND 4416" AND 4422" AND 4428" AND 4434" AND 4440" AND 4446" AND 4452" AND 4458" AND 4464" AND 4470" AND 4476" AND 4482" AND 4488" AND 4494" AND 4500" AND 4506" AND 4512" AND 4518" AND 4524" AND 4530" AND 4536" AND 4542" AND 4548" AND 4554" AND 4560" AND 4566" AND 4572" AND 4578" AND 4584" AND 4590" AND 4596" AND 4602" AND 4608" AND 4614" AND 4620" AND 4626" AND 4632" AND 4638" AND 4644" AND 4650" AND 4656" AND 4662" AND 4668" AND 4674" AND 4680" AND 4686" AND 4692" AND 4698" AND 4704" AND 4710" AND 4716" AND 4722" AND 4728" AND 4734" AND 4740" AND 4746" AND 4752" AND 4758" AND 4764" AND 4770" AND 4776" AND 4782" AND 4788" AND 4794" AND 4800" AND 4806" AND 4812" AND 4818" AND 4824" AND 4830" AND 4836" AND 4842" AND 4848" AND 4854" AND 4860" AND 4866" AND 4872" AND 4878" AND 4884" AND 4890" AND 4896" AND 4902" AND 4908" AND 4914" AND 4920" AND 4926" AND 4932" AND 4938" AND 4944" AND 4950" AND 4956" AND 4962" AND 4968" AND 4974" AND 4980" AND 4986" AND 4992" AND 4998" AND 5004" AND 5010" AND 5016" AND 5022" AND 5028" AND 5034" AND 5040" AND 5046" AND 5052" AND 5058" AND 5064" AND 5070" AND 5076" AND 5082" AND 5088" AND 5094" AND 5100" AND 5106" AND 5112" AND 5118" AND 5124" AND 5130" AND 5136" AND 5142" AND 5148" AND 5154" AND 5160" AND 5166" AND 5172" AND 5178" AND 5184" AND 5190" AND 5196" AND 5202" AND 5208" AND 5214" AND 5220" AND 5226" AND 5232" AND 5238" AND 5244" AND 5250" AND 5256" AND 5262" AND 5268" AND 5274" AND 5280" AND 5286" AND 5292" AND 5298" AND 5304" AND 5310" AND 5316" AND 5322" AND 5328" AND 5334" AND 5340" AND 5346" AND 5352" AND 5358" AND 5364" AND 5370" AND 5376" AND 5382" AND 5388" AND 5394" AND 5400" AND 5406" AND 5412" AND 5418" AND 5424" AND 5430" AND 5436" AND 5442" AND 5448" AND 5454" AND 5460" AND 5466" AND 5472" AND 5478" AND 5484" AND 5490" AND 5496" AND 5502" AND 5508" AND 5514" AND 5520" AND 5526" AND 5532" AND 5538" AND 5544" AND 5550" AND 5556" AND 5562" AND 5568" AND 5574" AND 5580" AND 5586" AND 5592" AND 5598" AND 5604" AND 5610" AND 5616" AND 5622" AND 5628" AND 5634" AND 5640" AND 5646" AND 5652" AND 5658" AND 5664" AND 5670" AND 5676" AND 5682" AND 5688" AND 5694" AND 5700" AND 5706" AND 5712" AND 5718" AND 5724" AND 5730" AND 5736" AND 5742" AND 5748" AND 5754" AND 5760" AND 5766" AND 5772" AND 5778" AND 5784" AND 5790" AND 5796" AND 5802" AND 5808" AND 5814" AND 5820" AND 5826" AND 5832" AND 5838" AND 5844" AND 5850" AND 5856" AND 5862" AND 5868" AND 5874" AND 5880" AND 5886" AND 5892" AND 5898" AND 5904" AND 5910" AND 5916" AND 5922" AND 5928" AND 5934" AND 5940" AND 5946" AND 5952" AND 5958" AND 5964" AND 5970" AND 5976" AND 5982" AND 5988" AND 5994" AND 6000" AND 6006" AND 6012" AND 6018" AND 6024" AND 6030" AND 6036" AND 6042" AND 6048" AND 6054" AND 6060" AND 6066" AND 6072" AND 6078" AND 6084" AND 6090" AND 6096" AND 6102" AND 6108" AND 6114" AND 6120" AND 6126" AND 6132" AND 6138" AND 6144" AND 6150" AND 6156" AND 6162" AND 6168" AND 6174" AND 6180" AND 6186" AND 6192" AND 6198" AND 6204" AND 6210" AND 6216" AND 6222" AND 6228" AND 6234" AND 6240" AND 6246" AND 6252" AND 6258" AND 6264" AND 6270" AND 6276" AND 6282" AND 6288" AND 6294" AND 6300" AND 6306" AND 6312" AND 6318" AND 6324" AND 6330" AND 6336" AND 6342" AND 6348" AND 6354" AND 6360" AND 6366" AND 6372" AND 6378" AND 6384" AND 6390" AND 6396" AND 6402" AND 6408" AND 6414" AND 6420" AND 6426" AND 6432" AND 6438" AND 6444" AND 6450" AND 6456" AND 6462" AND 6468" AND 6474" AND 6480" AND 6486" AND 6492" AND 6498" AND 6504" AND 6510" AND 6516" AND 6522" AND 6528" AND 6534" AND 6540" AND 6546" AND 6552" AND 6558" AND 6564" AND 6570" AND 6576" AND 6582" AND 6588" AND 6594" AND 6600" AND 6606" AND 6612" AND 6618" AND 6624" AND 6630" AND 6636" AND 6642" AND 6648" AND 6654" AND 6660" AND 6666" AND 6672" AND 6678" AND 6684" AND 6690" AND 6696" AND 6702" AND 6708" AND 6714" AND 6720" AND 6726" AND 6732" AND 6738" AND 6744" AND 6750" AND 6756" AND 6762" AND 6768" AND 6774" AND 6780" AND 6786" AND 6792" AND 6798" AND 6804" AND 6810" AND 6816" AND 6822" AND 6828" AND 6834" AND 6840" AND 6846" AND 6852" AND 6858" AND 6864" AND 6870" AND 6876" AND 6882" AND 6888" AND 6894" AND 6900" AND 6906" AND 6912" AND 6918" AND 6924" AND 6930" AND 6936" AND 6942" AND 6948" AND 6954" AND 6960" AND 6966" AND 6972" AND 6978" AND 6984" AND 6990" AND 6996" AND 7002" AND 7008" AND 7014" AND 7020" AND 7026" AND 7032" AND 7038" AND 7044" AND 7050" AND 7056" AND 7062" AND 7068" AND 7074" AND 7080" AND 7086" AND 7092" AND 7098" AND 7104" AND 7110" AND 7116" AND 7122" AND 7128" AND 7134" AND 7140" AND 7146" AND 7152" AND 7158" AND 7164" AND 7170" AND 7176" AND 7182" AND 7188" AND 7194" AND 7200" AND 7206" AND 7212" AND 7218" AND 7224" AND 7230" AND 7236" AND 7242" AND 7248" AND 7254" AND 7260" AND 7266" AND 7272" AND 7278" AND 7284" AND 7290" AND 7296" AND 7302" AND 7308" AND 7314" AND 7320" AND 7326" AND 7332" AND 7338" AND 7344" AND 7350" AND 7356" AND 7362" AND 7368" AND 7374" AND 7380" AND 7386" AND 7392" AND 7398" AND 7404" AND 7410" AND 7416" AND 7422" AND 7428" AND 7434" AND 7440" AND 7446" AND 7452" AND 7458" AND 7464" AND 7470" AND 7476" AND 7482" AND 7488" AND 7494" AND 7500" AND 7506" AND 7512" AND 7518" AND 7524" AND 7530" AND 7536" AND 7542" AND 7548" AND 7554" AND 7560" AND 7566" AND 7572" AND 7578" AND 7584" AND 7590" AND 7596" AND 7602" AND 7608" AND 7614" AND 7620" AND 7626" AND 7632" AND 7638" AND 7644" AND 7650" AND 7656" AND 7662" AND 7668" AND 7674" AND 7680" AND 7686" AND 7692" AND 7698" AND 7704" AND 7710" AND 7716" AND 7722" AND 7728" AND 7734" AND 7740" AND 7746" AND 7752" AND 7758" AND 7764" AND 7770" AND 7776" AND 7782" AND 7788" AND 7794" AND 7800" AND 7806" AND 7812" AND 7818" AND 7824" AND 7830" AND 7836" AND 7842" AND 7848" AND 7854" AND 7860" AND 7866" AND 7872" AND 7878" AND 7884" AND 7890" AND 7896" AND 7902" AND 7908" AND 7914" AND 7920" AND 7926" AND 7932" AND 7938" AND 7944" AND 7950" AND 7956" AND 7962" AND 7968" AND 7974" AND 7980" AND 7986" AND 7992" AND 7998" AND 8004" AND 8010" AND 8016" AND 8022" AND 8028" AND 8034" AND 8040" AND 8046" AND 8052" AND 8058" AND 8064" AND 8070" AND 8076" AND 8082" AND 8088" AND 8094" AND 8100" AND 8106" AND 8112" AND 8118" AND 8124" AND 8130" AND 8136" AND 8142" AND 8148" AND 8154" AND 8160" AND 8166" AND 8172" AND 8178" AND 8184" AND 8190" AND 8196" AND 8202" AND 8208" AND 8214" AND 8220" AND 8226" AND 8232" AND 8238" AND 8244" AND 8250" AND 8256" AND 8262" AND 8268" AND 8274" AND 8280" AND 8286" AND 8292" AND 8298" AND 8304" AND 8310" AND 8316" AND 8322" AND 8328" AND 8334" AND 8340" AND 8346" AND 8352" AND 8358" AND 8364" AND 8370" AND 8376" AND 8382" AND 8388" AND 8394" AND 8400" AND 8406" AND 8412" AND 8418" AND 8424" AND 8430" AND 8436" AND 8442" AND 8448" AND 8454" AND 8460" AND 8466" AND 8472" AND 8478" AND 8484" AND 8490" AND 8496" AND 8502" AND 8508" AND 8514" AND 8520" AND 8526" AND 8532" AND 8538" AND 8544" AND 8550" AND 8556" AND 8562" AND 8568" AND 8574" AND 8580" AND 8586" AND 8592" AND 8598" AND 8604" AND 8610" AND 8616" AND 8622" AND 8628" AND 8634" AND 8640" AND 8646" AND 8652" AND 8658" AND 8664" AND 8670" AND 8676" AND 8682" AND 8688" AND 8694" AND 8700" AND 8706" AND 8712" AND 8718" AND 8724" AND 8730" AND 8736" AND 8742" AND 8748" AND 8754" AND 8760" AND 8766" AND 8772" AND 8778" AND 8784" AND 8790" AND 8796" AND 8802" AND 8808" AND 8814" AND 8820" AND 8826" AND 8832" AND 8838" AND 8844" AND 8850" AND 8856" AND 8862" AND 8868" AND 8874" AND 8880" AND 8886" AND 8892" AND 8898" AND 8904" AND 8910" AND 8916" AND 8922" AND 8928" AND 8934" AND 8940" AND 8946" AND 8952" AND 8958" AND 8964" AND 8970" AND 8976" AND 8982" AND 8988" AND 8994" AND 9000" AND 9006" AND 9012" AND 9018" AND 9024" AND 9030" AND 9036" AND 9042" AND 9048" AND 9054" AND 9060" AND 9066" AND 9072" AND 9078" AND 9084" AND 9090" AND 9096" AND 9102" AND 9108" AND 9114" AND 9120" AND 9126" AND 9132" AND 9138" AND 9144" AND 9150" AND 9156" AND 9162" AND 9168" AND 9174" AND 9180" AND 9186" AND 9192" AND 9198" AND 9204" AND 9210" AND 9216" AND 9222" AND 9228" AND 9234" AND 9240" AND 9246" AND 9252" AND 9258" AND 9264" AND 9270" AND 9276" AND 9282" AND 9288" AND 9294" AND 9300" AND 9306" AND 9312" AND 9318" AND 9324" AND 9330" AND 9336" AND 9342" AND 9348" AND 9354" AND 9360" AND 9366" AND 9372" AND 9378" AND 9384" AND 9390" AND 9396" AND 9402" AND 9408" AND 9414" AND 9420" AND 9426" AND

PLAN
 NOTE BOOK: ALPHABETIC ORDER
 No. _____

PROFILE
 NOTE BOOK: GRADE CHECKED
 No. _____

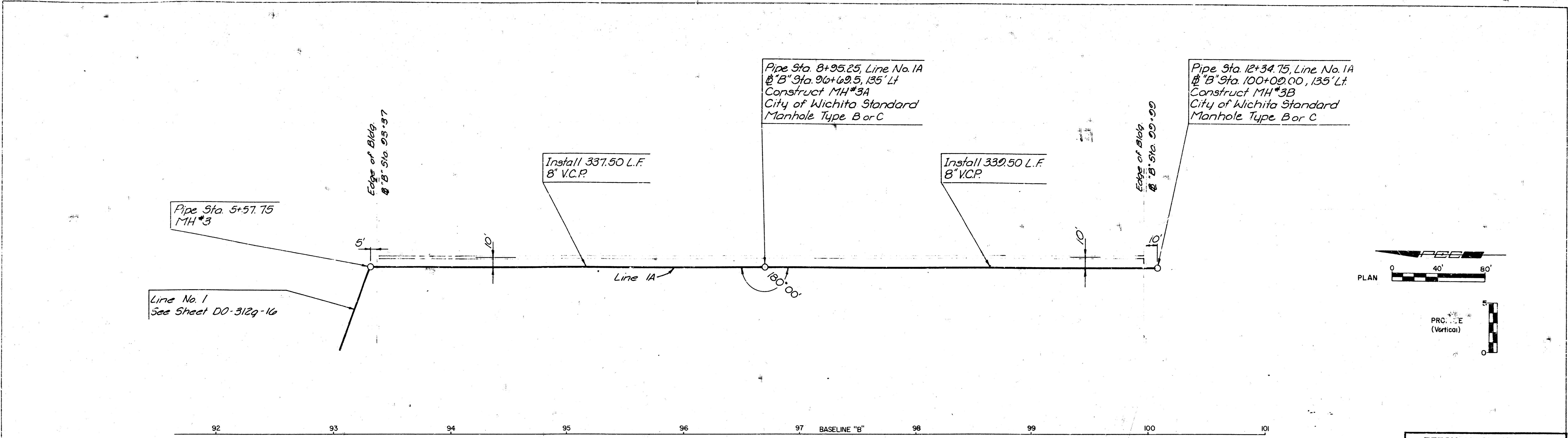

DATE	NATURE OF REVISION	BY	CK'D.	APPR.

NO.	DESCRIPTION
00-312-5	Plant III Utilities
00-312-16	Sanitary Sewer

REFERENCE DRAWINGS

APPROVED	TITLE	DATE

BEECH AIRCRAFT CORP.
 PLANT ENGINEERING DEPT.
 PLANT III EXTENSION
 SANITARY SEWER IMPROVEMENTS

DESIGNED	DATE	CHECKED	APPROVED

SCALE: No. 056-312g-3

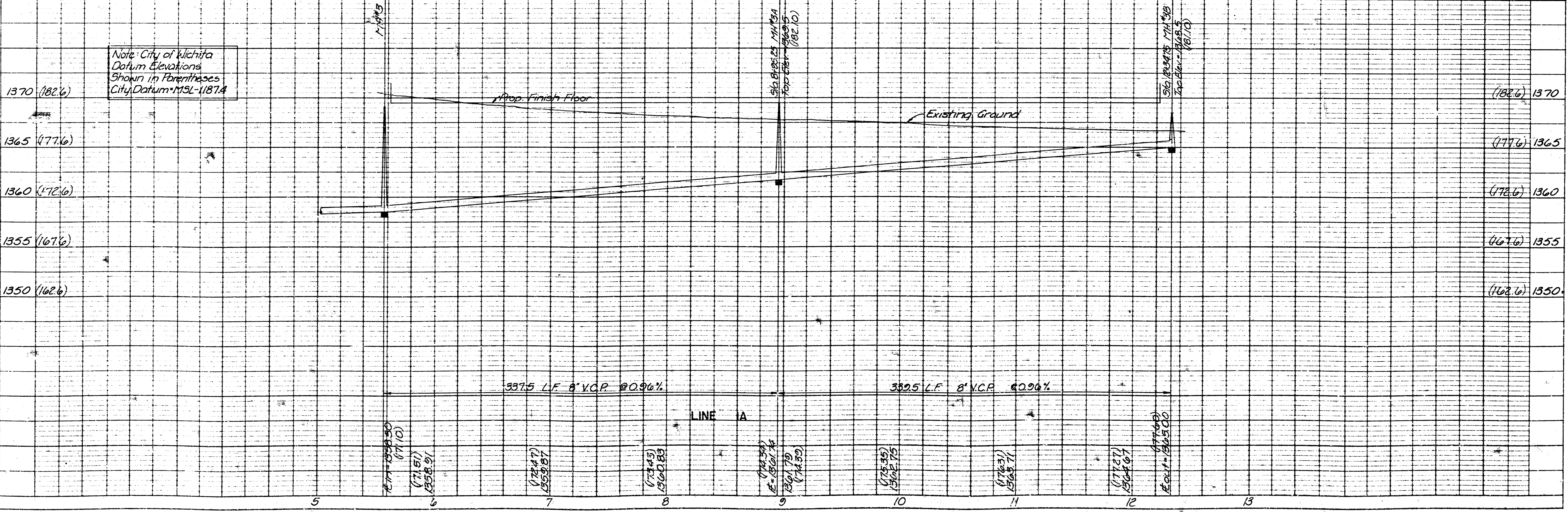

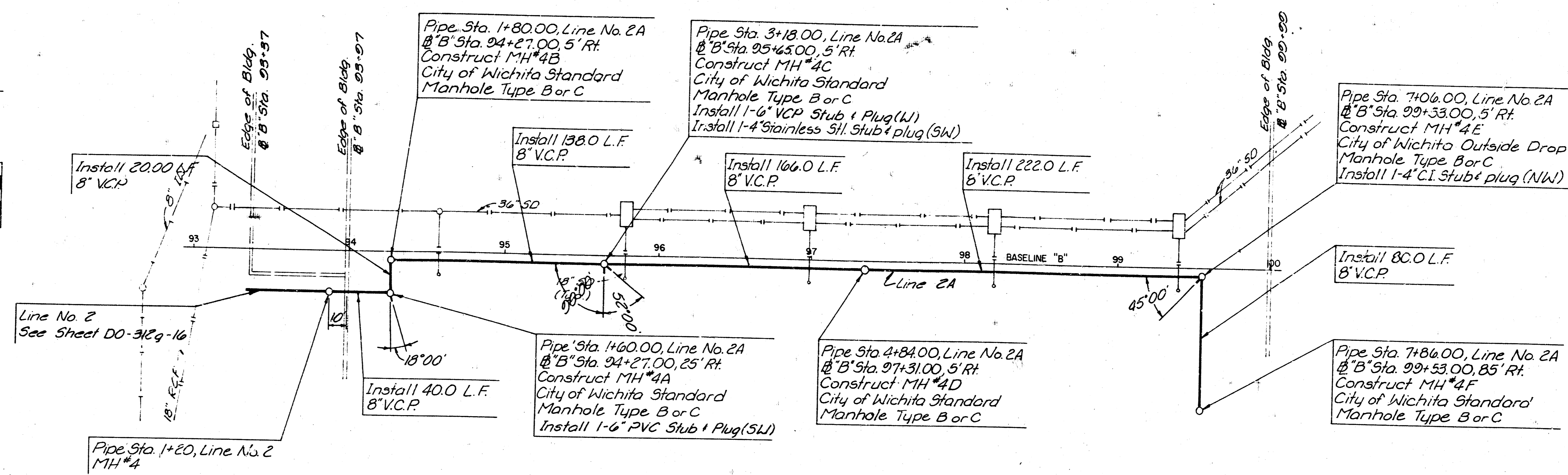
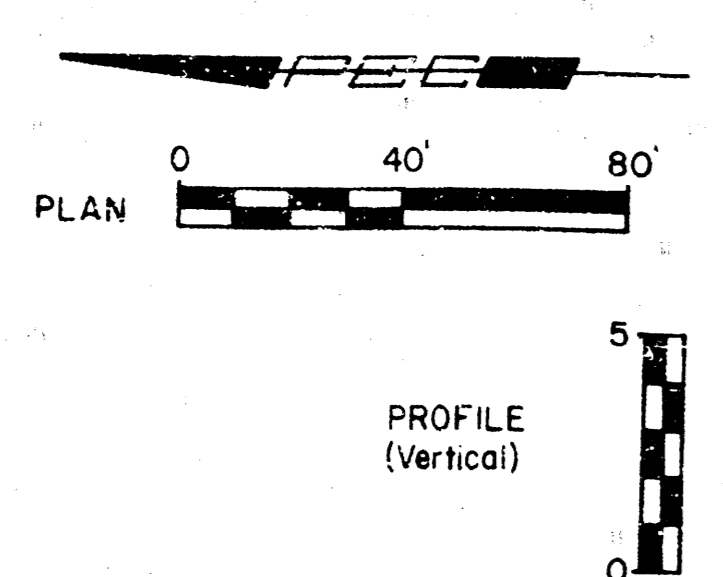

DATE	NATURE OF REVISION	BY	CK'D.	APPR.

00-312-9	Plant III Utilities
00-312-16	Sanitary Sewer
REFERENCE DRAWINGS	

BEECH AIRCRAFT CORP.			
PLANT ENGINEERING DEPT.			
PLANT III EXTENSION			
SANITARY SEWER IMPROVEMENTS			
DESIGNED BY	DATE	CHECKED	APPROVED
DRAWN BY			
SCALE	No. 036-3129-2		

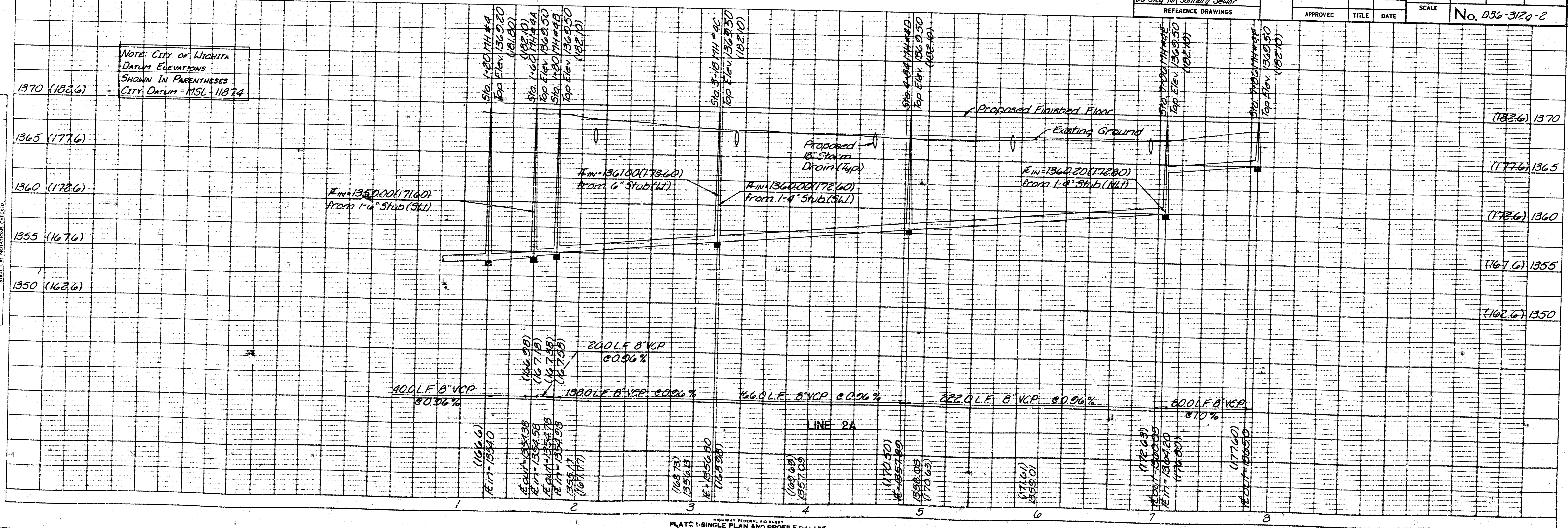

NOTE: CITY OF WICHITA
DATUM ELEVATIONS
SHOWN IN PARENTHESES
CITY DATUM = MSL + 118.74

PLAN SURVEYED
NOTE BOOK, PARTIAL
NO. 10144

PROFILE SURVEYED
NOTE BOOK, PARTIAL
NO. 10144

PLAN	DATE
BY	
CHECKED	
APPROVED	

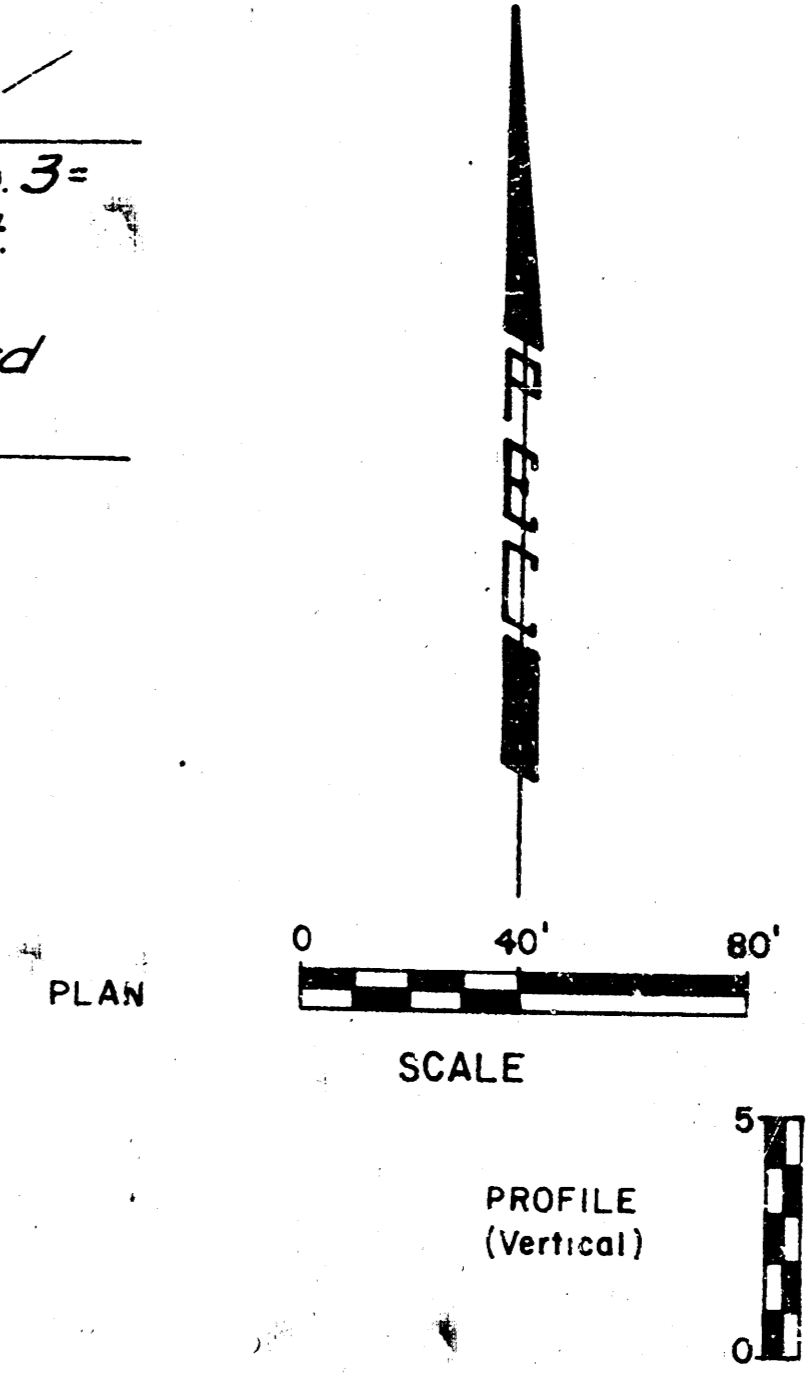
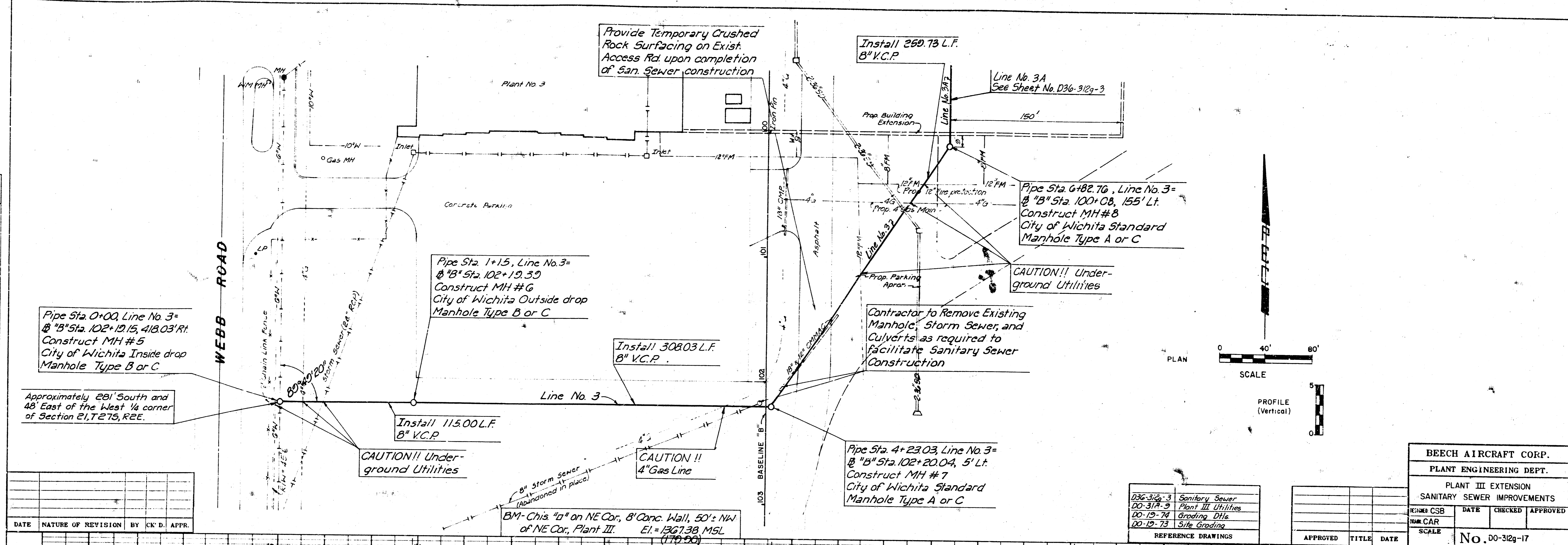

DATE	NATURE OF REVISION	BY	CK'D.	APPR.

136-312-3	Sanitary Sewer
100-312-3	Plant III Utilities
100-19-74	Grading Dtls.
100-19-73	Site Grading

BEECH AIRCRAFT CORP.			
PLANT ENGINEERING DEPT.			
PLANT III EXTENSION			
SANITARY SEWER IMPROVEMENTS			
DESIGNED BY	DATE	CHECKED	APPROVED
SCALE			
No. 00-312g-17			

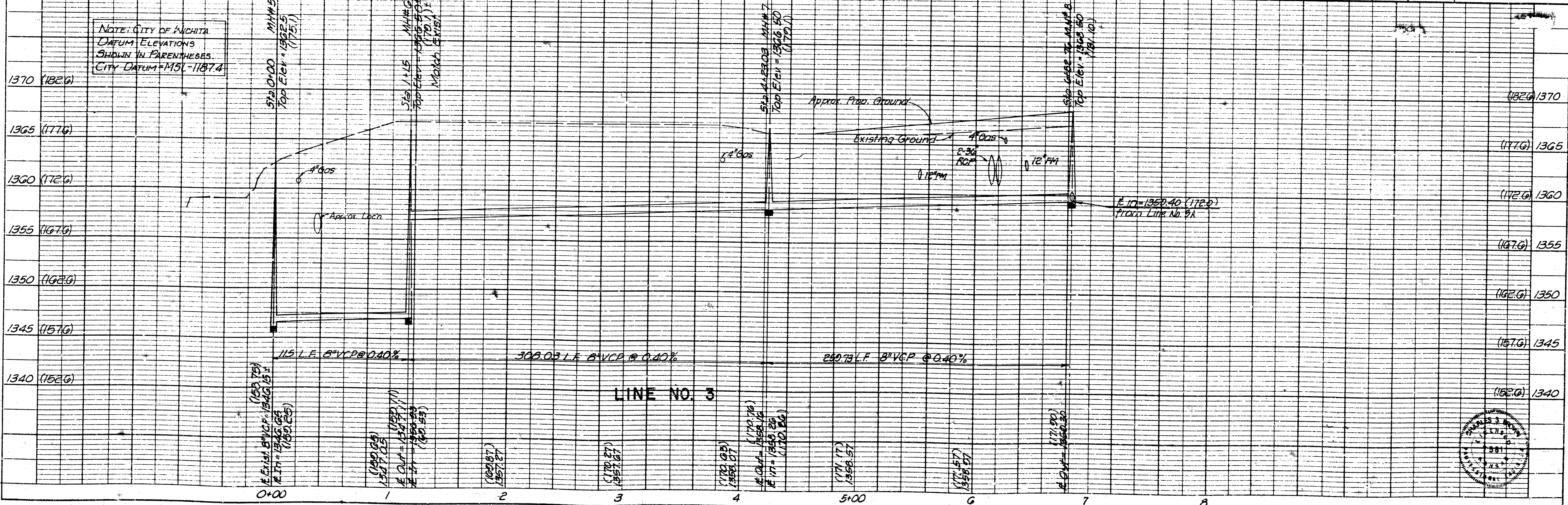

PROFILE	DATE
BY	
CHECKED	
APPROVED	

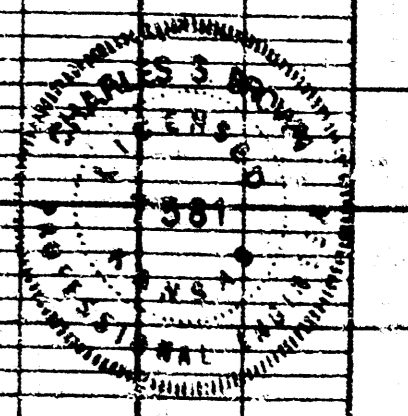

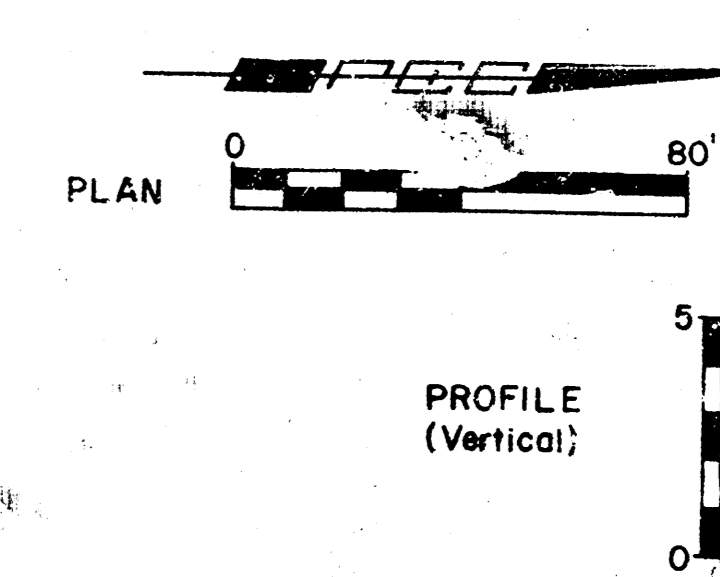
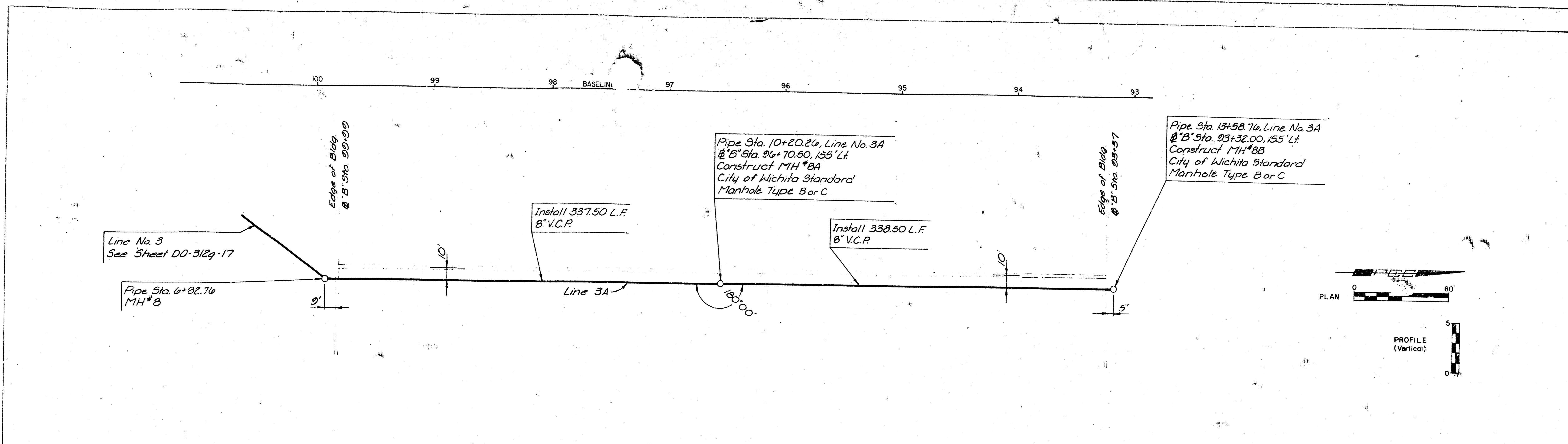

DATE	NATURE OF REVISION	BY	CHK'D.	APPR.

DESIGNED	DATE	CHECKED	APPROVED
DO-312-9 Plant III Utilities			
DO-312-17 Sanitary Sewer			

APPROVED	TITLE	DATE

BEECH AIRCRAFT CORP.			
PLANT ENGINEERING DEPT.			
PLANT III EXTENSION			
SANITARY SEWER IMPROVEMENTS			
SCALE			
			No. DO-312g-1

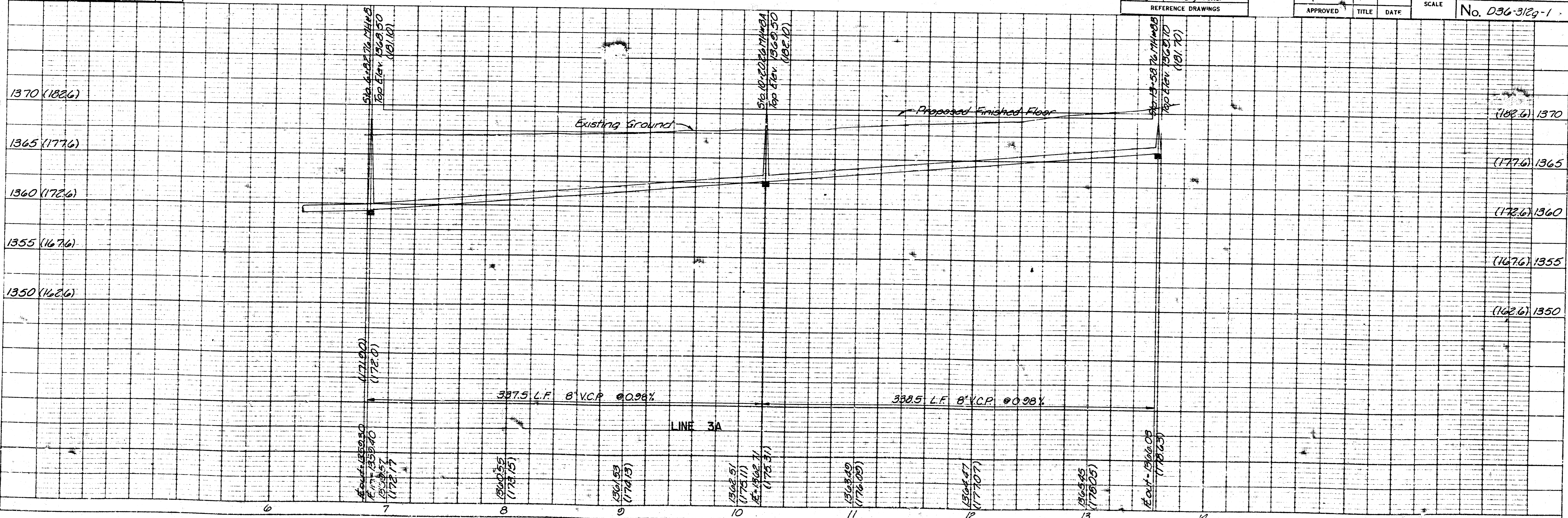

PLATE 1-SINGLE PLAN AND PROFILE-FULL LINE
PRINTED IN U.S.A.