

**B VICINITY MAP**

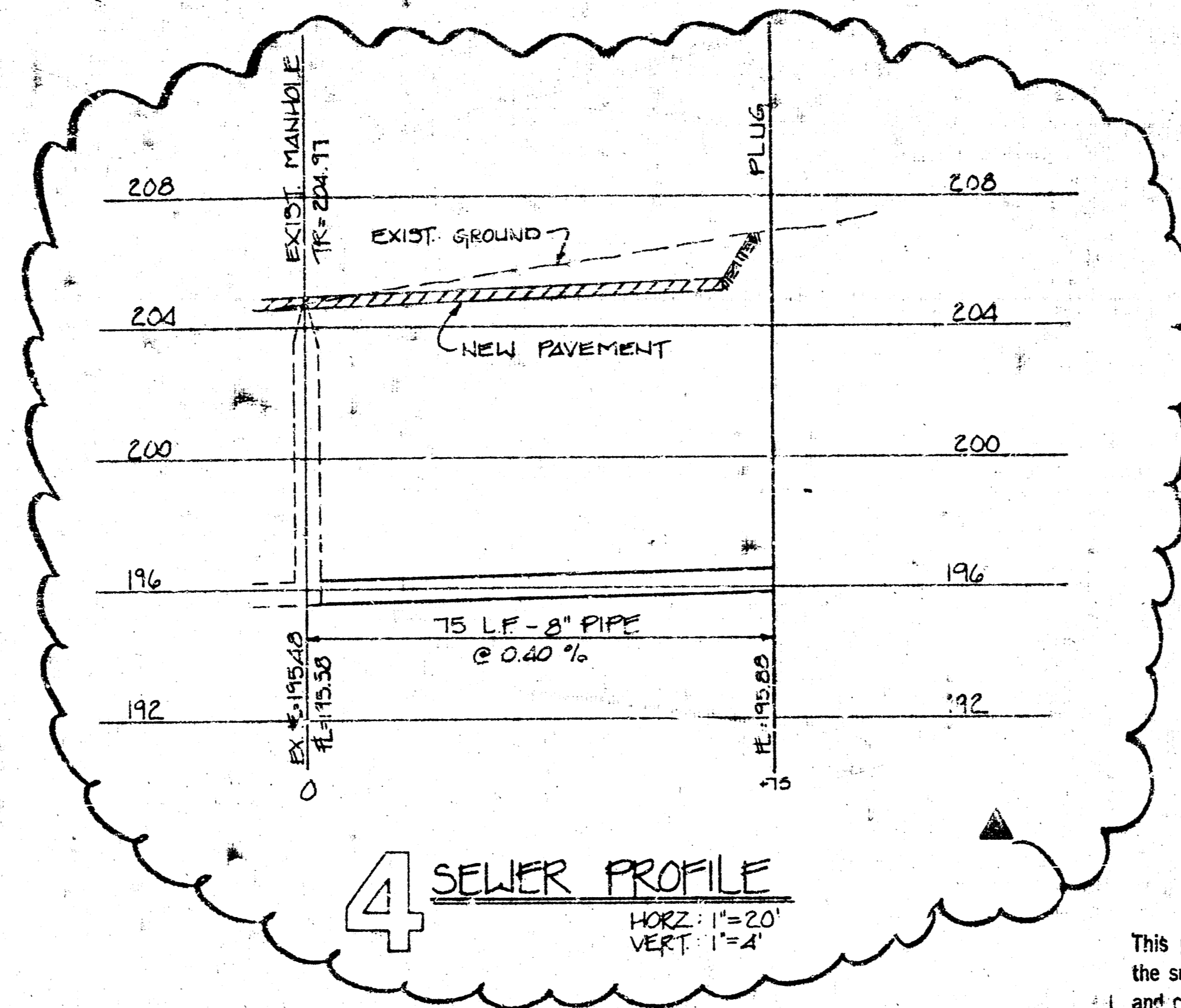

**4 SEWER PROFILE**  
 HORZ: 1"=20'  
 VERT: 1"=4'

- GENERAL NOTES**
1. CONTRACTOR TO COORDINATE PAVEMENT GRADES WITH "FUTURE PAVEMENT" TO PROVIDE FOR POSITIVE DRAINAGE OF PAVEMENT.
  2. REFER TO "ONE BRITTANY PLACE" SPECIFICATIONS, DIVISION 2, FOR EARTHWORK AND PAVEMENT.
  3. ALL DIMENSIONS ARE TO THE FACE OF CURB.
  4. LANDSCAPE FILL MATERIAL-INSTALL FILL TO WITHIN 2" OF TOP OF CURB ELEVATION FROM TOPSOIL MATERIAL, STOCK PILED ADJACENT TO ROCKHILL LANE, MINIMUM TOPSOIL 8".

THE CONTRACTOR SHALL BE RESPONSIBLE FOR PRESERVING PROPERTY IRONS. THE CONTRACTOR SHALL BE REQUIRED TO RE-ESTABLISH ANY PROPERTY IRONS DAMAGED OR DESTROYED BY HIS CONSTRUCTION OPERATIONS. SUCH IRONS SHALL BE RE-ESTABLISHED BY A LICENSED LAND SURVEYOR OR A LICENSED PROFESSIONAL ENGINEER IN ACCORDANCE WITH STATE LAWS.

**NOTE TO CONTRACTOR**  
 This project will be constructed under the supervision of the CITY ENGINEER and conforming to the SPECIFICATIONS of the CITY OF WICHITA. The CONTRACTOR will prepay the City of Wichita for all costs of inspection.

- LEGEND**
- 41% EXIST. SPOT ELEV.
  - 41% NEW SPOT ELEV.
  - NEW CURB & GUTTER

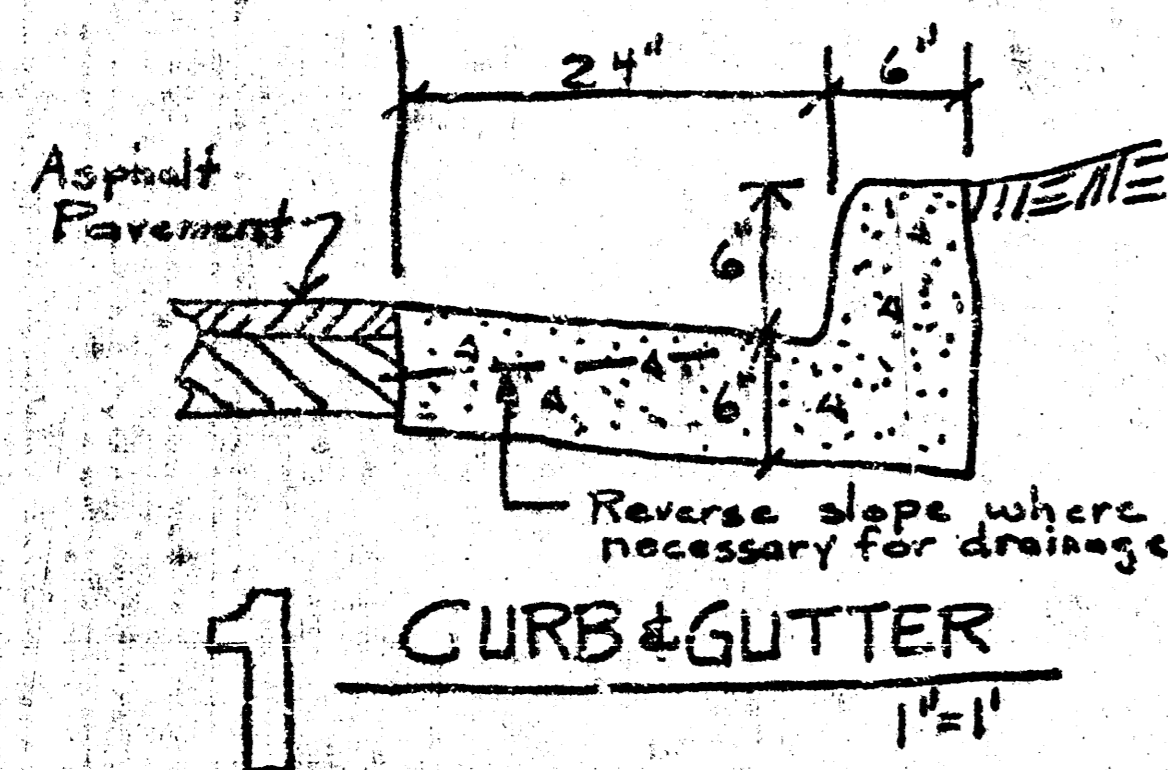

**1 CURB & GUTTER**  
 1"=1'

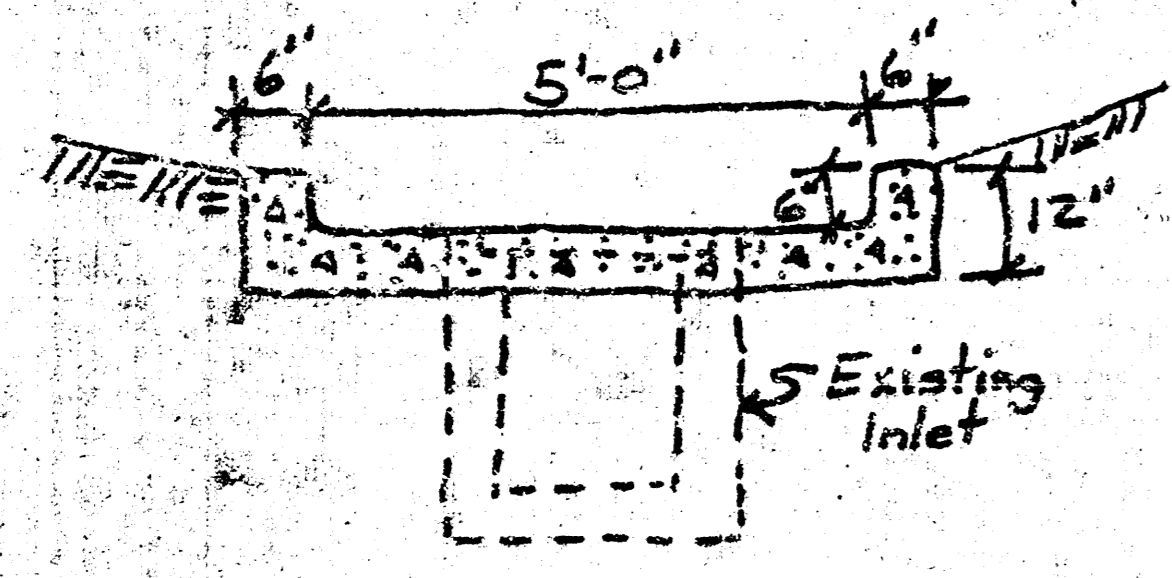

**2 SECTION**

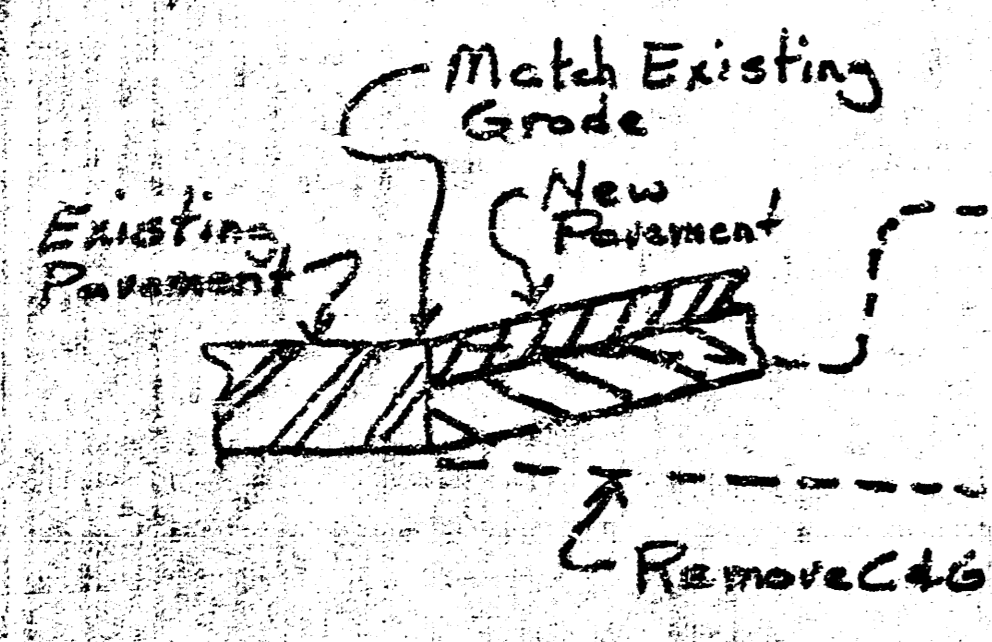

**3 SECTION**

APPROVED AS NOTED  
 By CITY ENGINEER OF WICHITA  
 Sanitary Sewers: *[Signature]*  
 Storm Sewers: *[Signature]*  
 Driveway Approaches: *[Signature]*

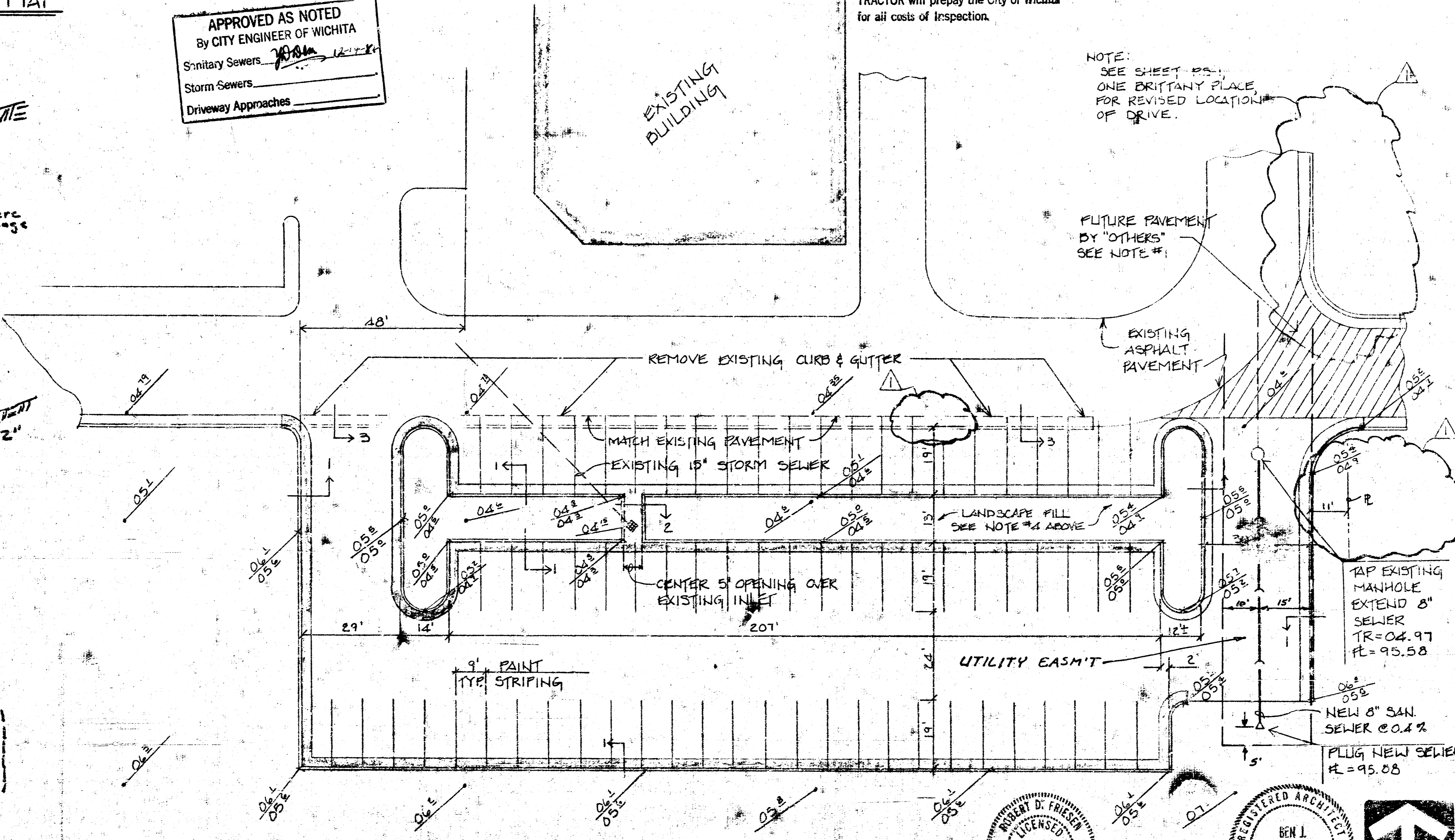

**A PARKING PLAN**  
 1"=20'

**BENCH MARK**  
 CITY DISK @ NE COR WOODLAWN & 21ST. ELEV. 200.65

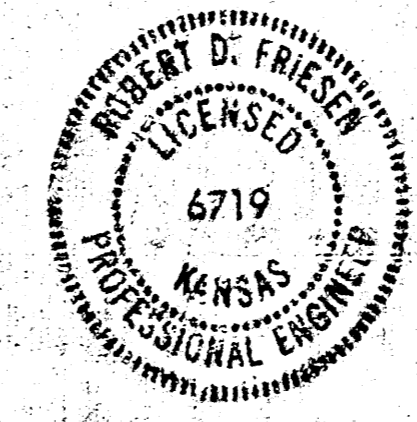

PRINTS ISSUED		
DATE	PURPOSE	NO.
10-22-82	FOR OWNER APPROVAL	2
10-11-82	FOR OWNER	3
11-11-82	TO OWNER & CONTRACTOR	4
12-5-82	TO CONTRACTOR	5

**FOR CONSTRUCTION: 10-11-82**

REVISIONS		
DATE	ITEM	NO.
11-10-82	SHEET NO.	1
12-22-82	SEWER PROFILE	2

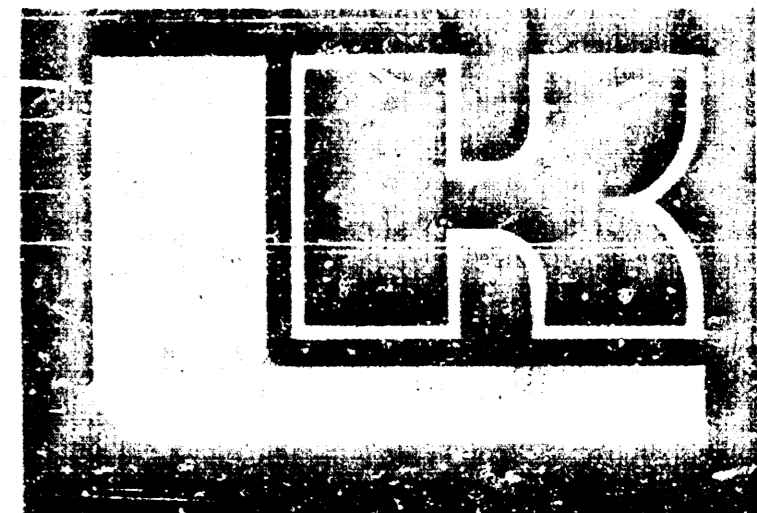

**LAW/KINGDON, P.A.**  
 210 S. MARKET WICHITA, KANSAS 67202  
 PHONE (316) 264-9884  
 ARCHITECTS & ENGINEERS

DRAWN	CHECKED
DPJ	FLW

**BRITTANY CENTER**  
 PROJECT NUMBER: 7195  
 Copyright © 1982 Law/Kingdon, P.A.  
 S.S. EXTENSION AT BRITTANY CENTER LOT 2, BLK 1, NORTHBOROUGH ADDN.  
 168-008 (132)  
 KEY PLAN

**SITE**

**PARKING PLAN**

**SHEET TITLE**  
 TENANT: *[Signature]*  
 SHEET NUMBER: 10  
 SHEETS: 10