

Sanitary Sewer Addition

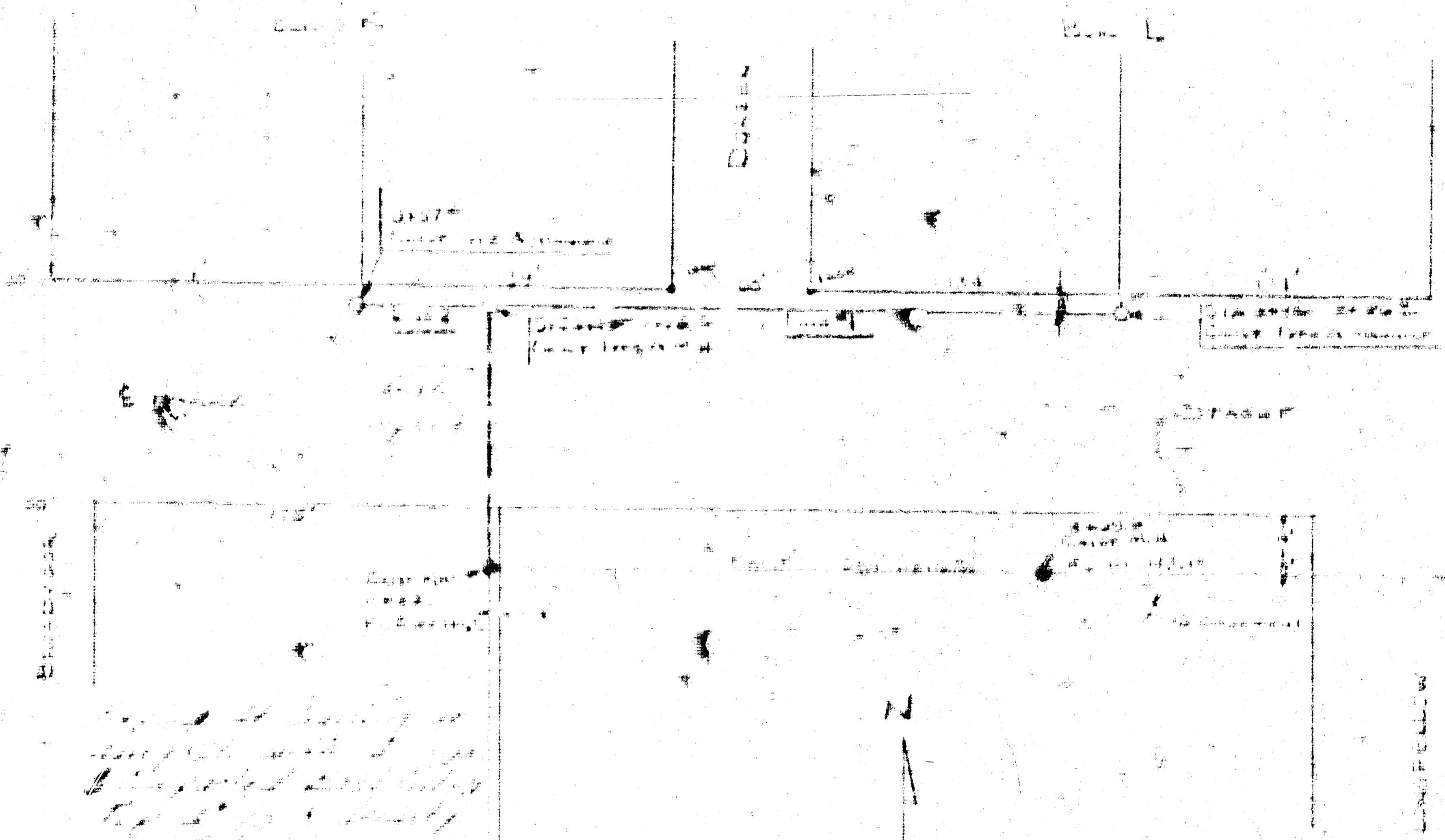

*Handwritten note:*  
 This sewer line is  
 to be installed  
 in the alleyway  
 between lots 10  
 and 11.

**NOTE TO THE OWNER**  
 This project will be completed under  
 the supervision of the CITY ENGINEER  
 and conform to the REGULATIONS  
 of the CITY OF KANSAS. The CON-  
 tract will be awarded by the City of  
 Kansas.

APPROVED AND FILED  
 By the City Engineer of Kansas  
 Date: \_\_\_\_\_  
 Location: \_\_\_\_\_

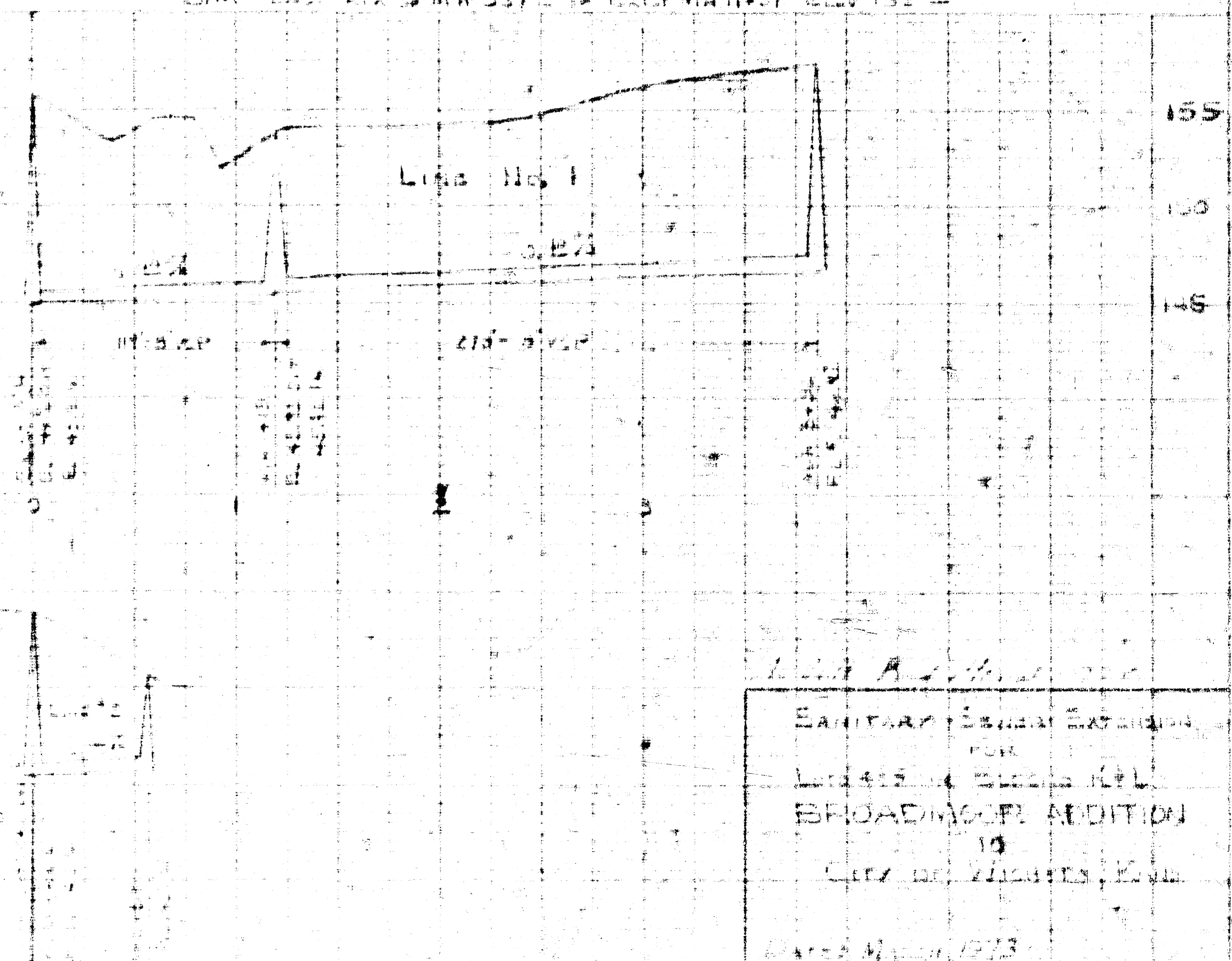

Sanitary Sewer Addition  
 FOR  
 LOTS 10 AND 11  
 BROADMOOR ADDITION  
 10  
 CITY OF KANSAS, KAN.  
 Date: March 1913