

Sta. 0+00 - Connect to Exist. Manhole

Scale: Hor. 1" = 20'  
Ver. 1" = 5'

Sta. 0+93.4 - Const. Std. Type "A" or "C" Manhole with 4" Stub WSW

THE CONTRACTOR SHALL BE RESPONSIBLE FOR PRESERVING PROPERTY IRONS. THE CONTRACTOR SHALL BE REQUIRED TO RE-ESTABLISH ANY PROPERTY IRONS WHICH ARE DAMAGED OR DESTROYED BY HIS CONSTRUCTION OPERATIONS. SUCH IRONS SHALL BE RE-ESTABLISHED BY A LICENSED SURVEYOR OR A LICENSED PROFESSIONAL ENGINEER IN ACCORDANCE WITH STATE LAWS.

**NOTE TO CONTRACTOR**

This project will be constructed under the supervision of the CITY ENGINEER and conforming to the SPECIFICATIONS of the CITY OF WICHITA. The CONTRACTOR will prepay the City of Wichita for all costs of inspection.

APPROVED AS NOTED  
By CITY ENGINEER OF WICHITA  
Sanitary Sewers \_\_\_\_\_  
Storm Sewers \_\_\_\_\_  
Driveway Approaches \_\_\_\_\_

B.M. - City disc 28'E. E. Rock & 51' N. R.R. Tracks  
E1. 199.70

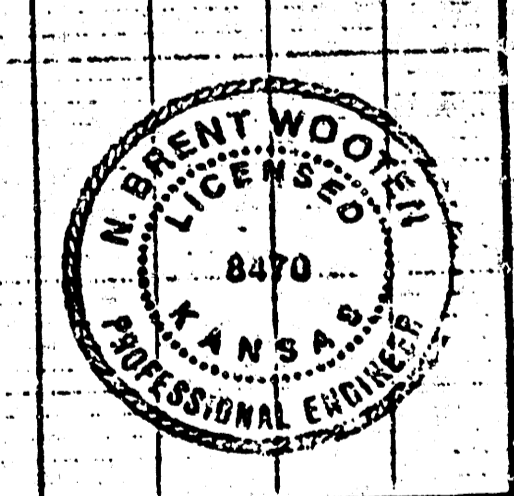
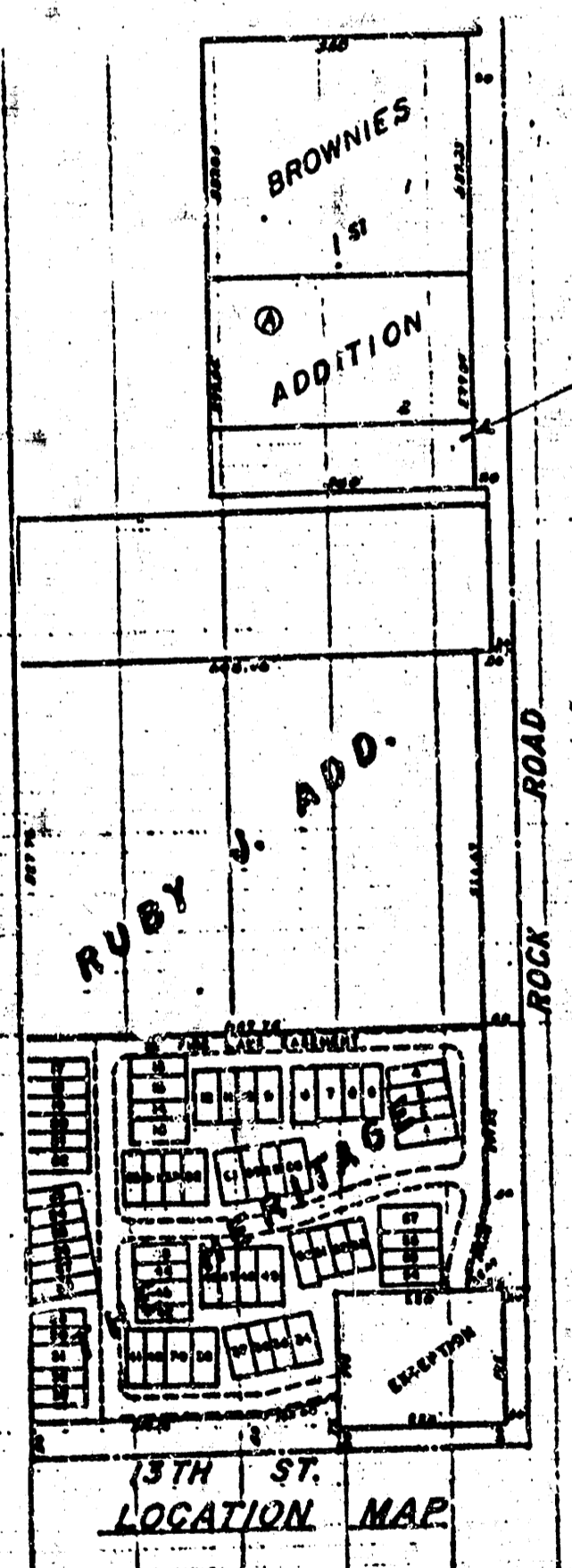
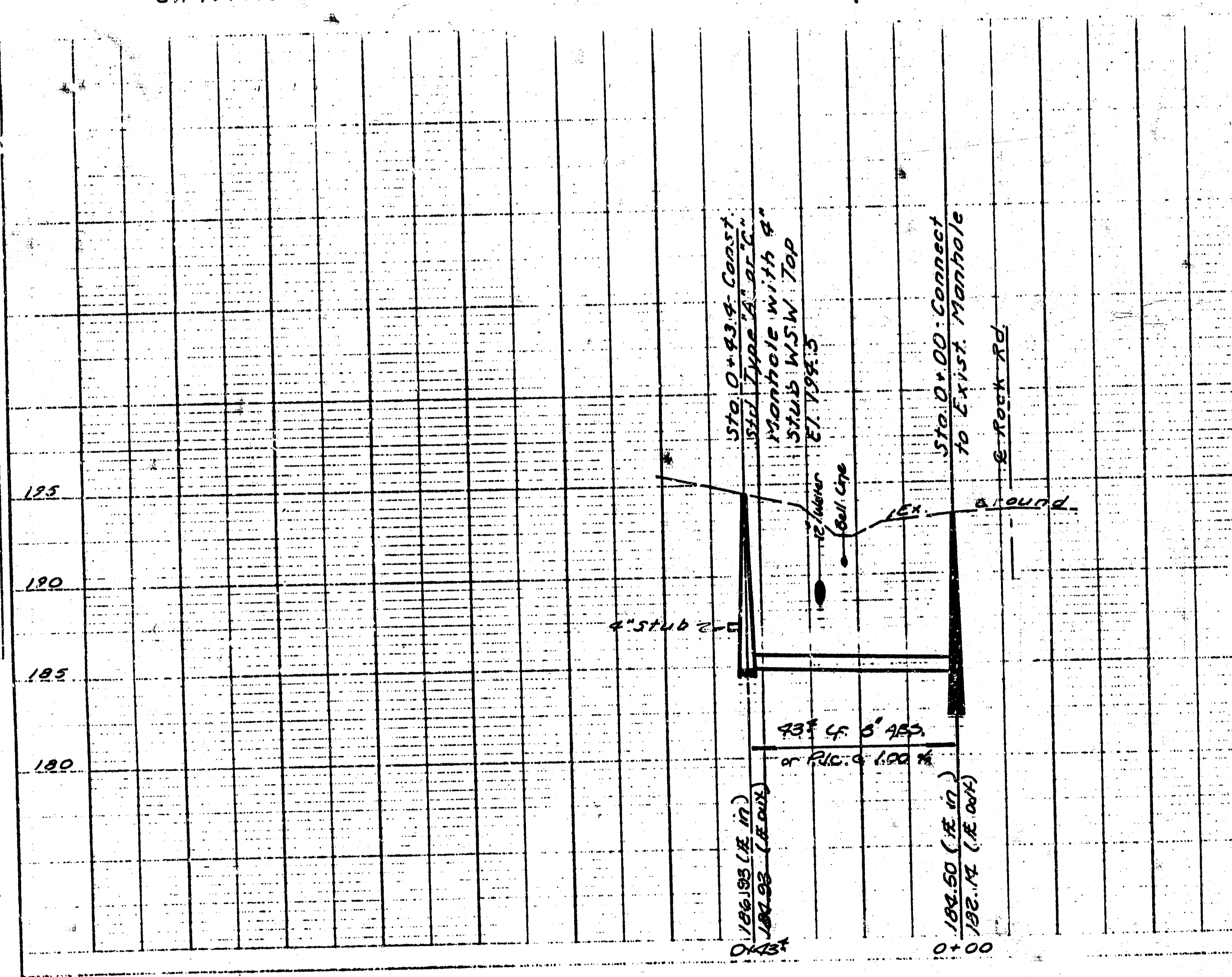

PRIVATE SANITARY SEWER EXTENSION TO SERVE SOUTH 100' OF LOT 2, BLK. A, BROWNIES 1ST ADDITION

PRIVATE CITY PROJ. 46E-76-245-80000-000-000-008

**BAUGHMAN COMPANY, P.A.**  
SURVEYING & ENGINEERING  
316/262-7271 • 330 LAURA • WICHITA, KANSAS 67211