

BENCH MARK: R.R. Spike in Power Pole Located 171.5' North and 18.5' East of Existing Manhole, Station 0+00 This Plan. Elevation = 142.37

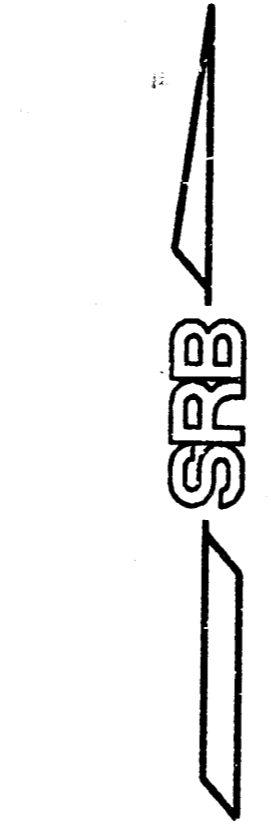

Scale: 1" = 20' Plan
1" = 5' Profile (Vert.)
o = Iron

- All Construction to be in compliance with City of Wichita Specifications.
 - The Contractor shall give all property owners and/or tenants of developed property directly abutting the construction of this project a minimum of ten (10) days advance notice prior to the start of construction.
 - The Contractor shall be responsible for preserving property irons. The Contractor will be required to re-establish any property irons which are damaged or destroyed by his construction operations. Such irons shall be re-established by a licensed land surveyor in accordance with state laws.
 - The Contractor shall maintain one open lane of traffic on Socora at all times during the construction of this project.
 - The Contractor shall be responsible for costs and arrangements for any necessary relocation of the KG&E Gas Meter.
 - Contractor will be required to provide a minimum notice of twenty-four (24) hours to utility companies prior to starting any excavation as follows:
Kansas One-Call 687-2470
- The Contractor must notify the following before construction and in case of an emergency.
- K.P. & L. Gas Service Company 263-7511
Kansas Gas & Electric 264-1141
Arkio Gas Company 942-8350 or 263-8161
Southwestern Bell Telephone Company 1-571-2611
Cablevision 262-4270 or 263-2061
City of Wichita Water Department 268-4908
City of Wichita Sewer Maintenance 268-4071

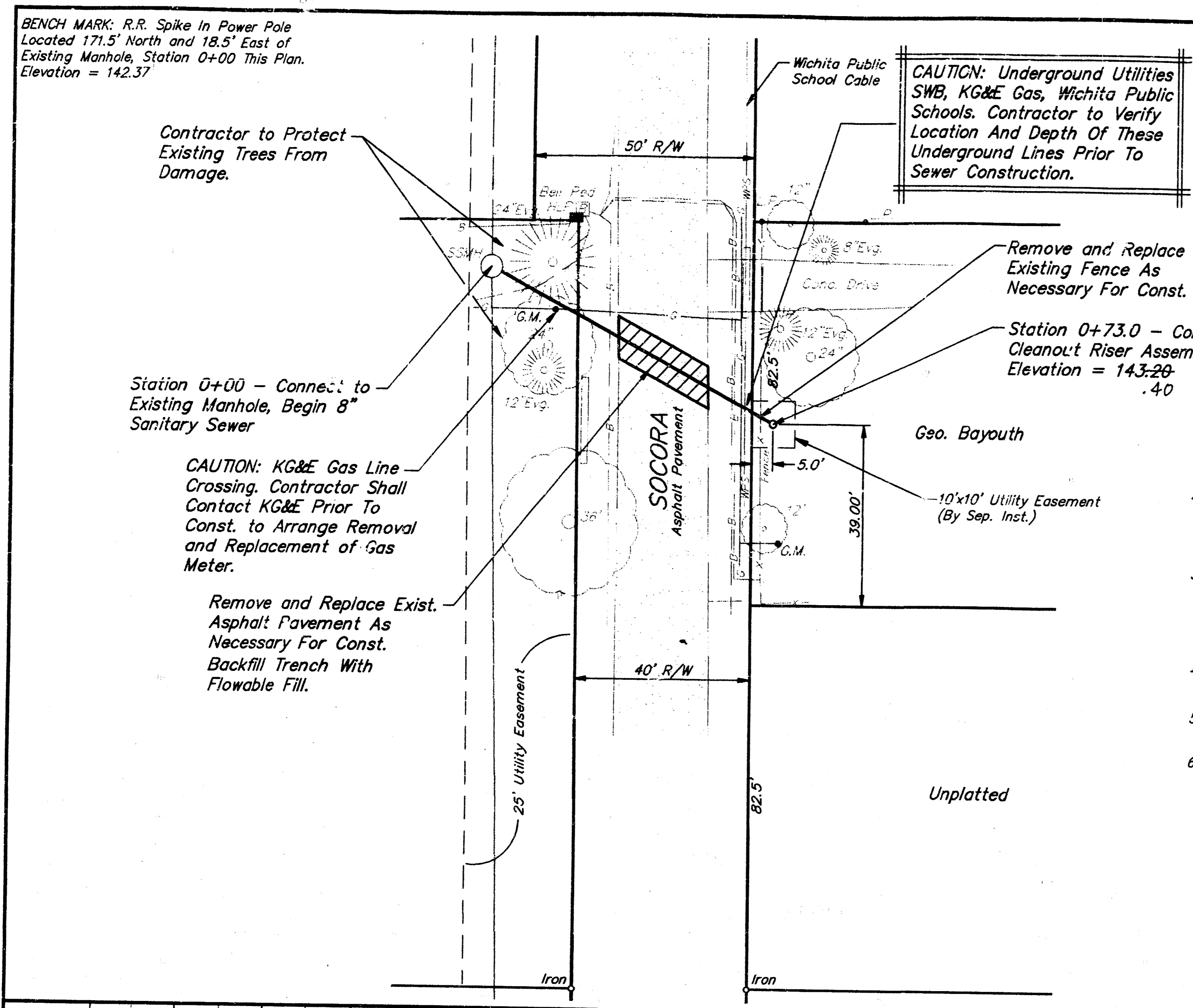
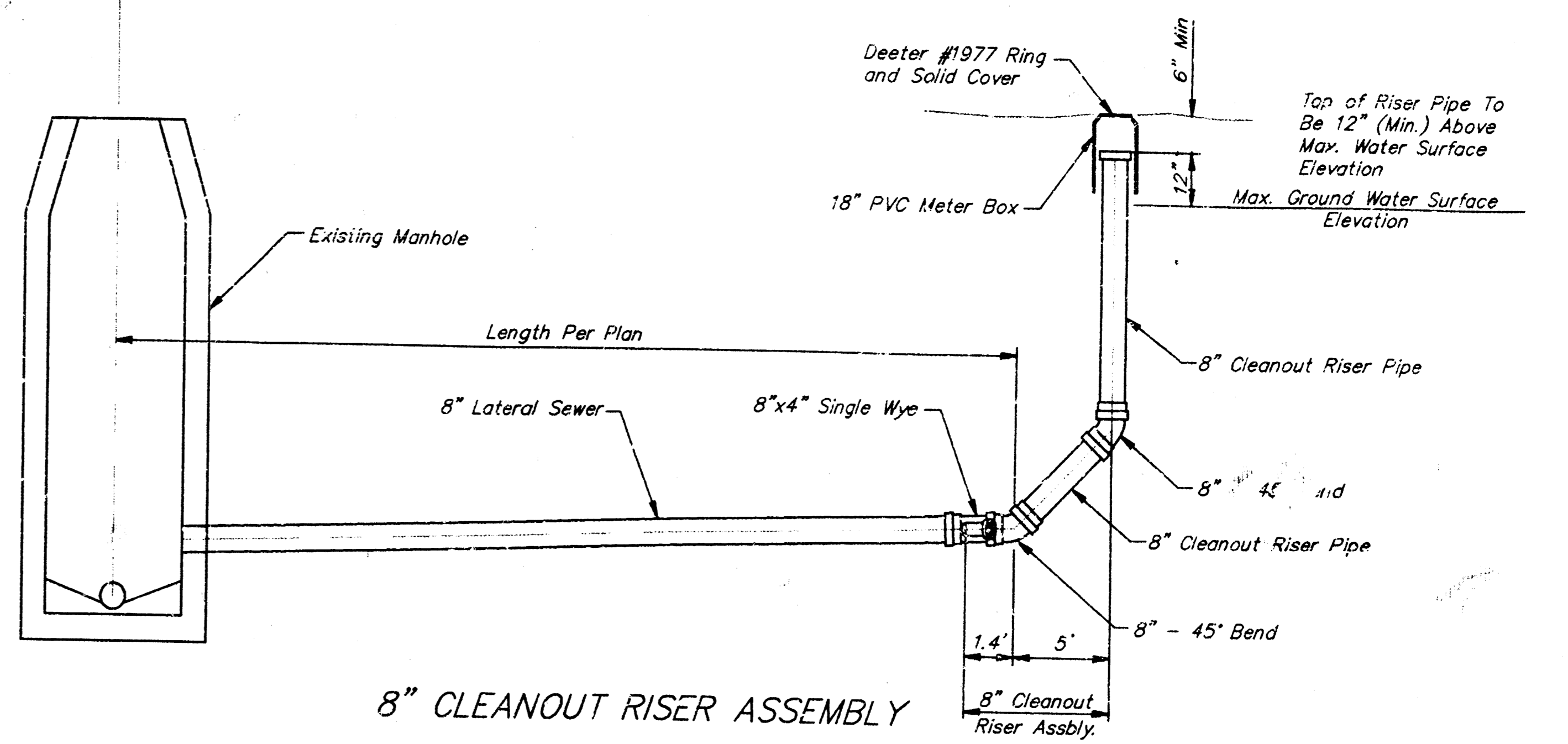

8" CLEANOUT RISER ASSEMBLY

INSPECTION AND TESTING FOR THIS PROJECT TO BE PROVIDED BY A LICENSED CONSULTING ENGINEERING FIRM UNDER CONTRACT WITH THE OWNER/DEVELOPER. SAID INSPECTION TO BE IN ACCORDANCE WITH THE CITY OF WICHITA STANDARD CONSTRUCTION ENGINEERING PRACTICES AND CERTIFIED BY A LICENSED PROFESSIONAL ENGINEER. NO WORK SHALL BE PERFORMED IN DEDICATED EASEMENTS OR PUBLIC RIGHT-OF-WAY BY THE CONTRACTOR WITHOUT SUCH INSPECTIONS. WORK SHALL ANY WORK BE COMMENCED IN DEDICATED EASEMENTS OR PUBLIC RIGHT-OF-WAY WITHOUT WRITTEN AUTHORIZATION BY THE CITY ENGINEER.

APPROVED AS NOTED
By CITY ENGINEER OF WICHITA

Sanitary Sewers VRH 5/20/93

Storm Sewers _____

Driveway Approaches _____

Water Mains _____

Paving _____

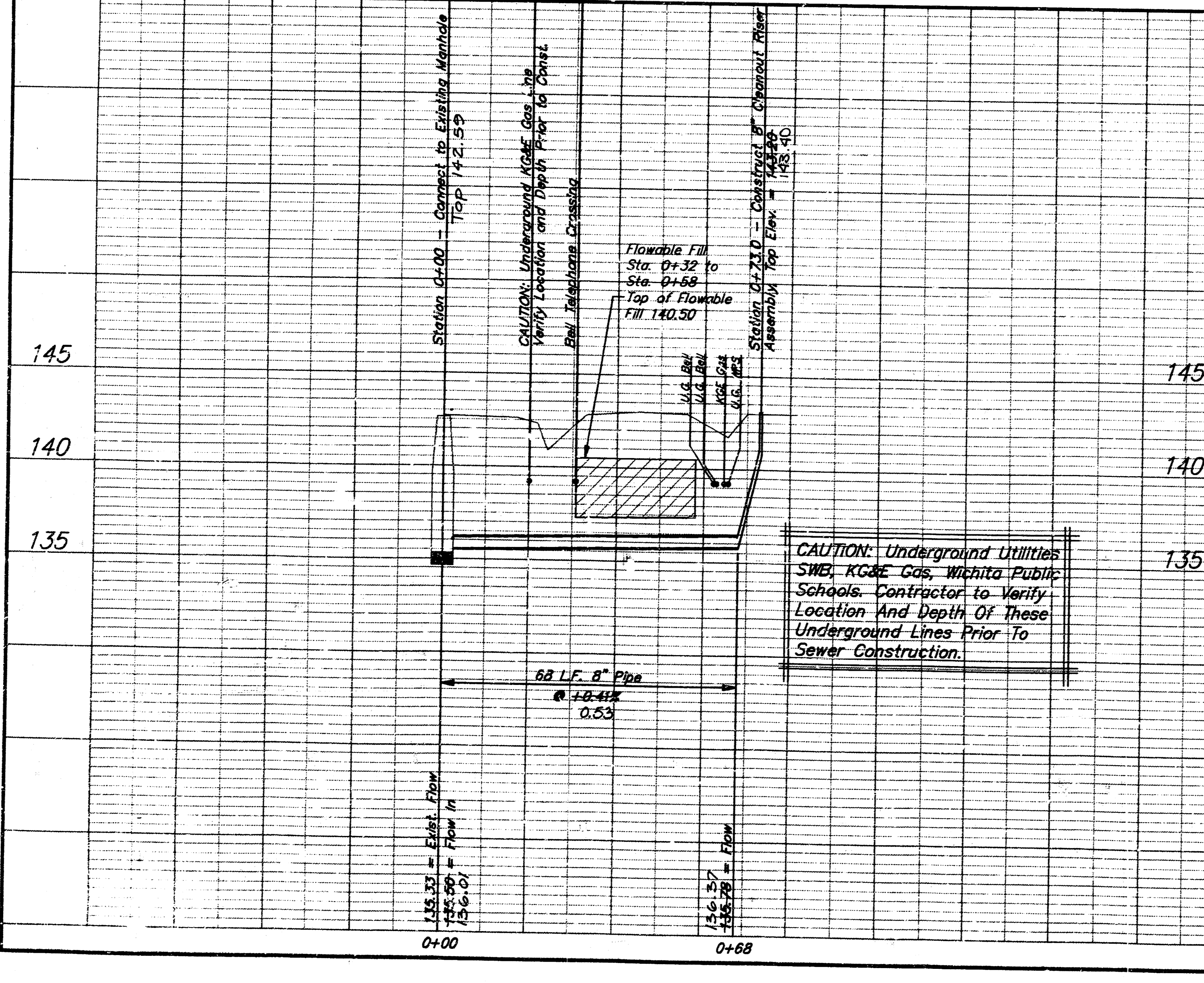
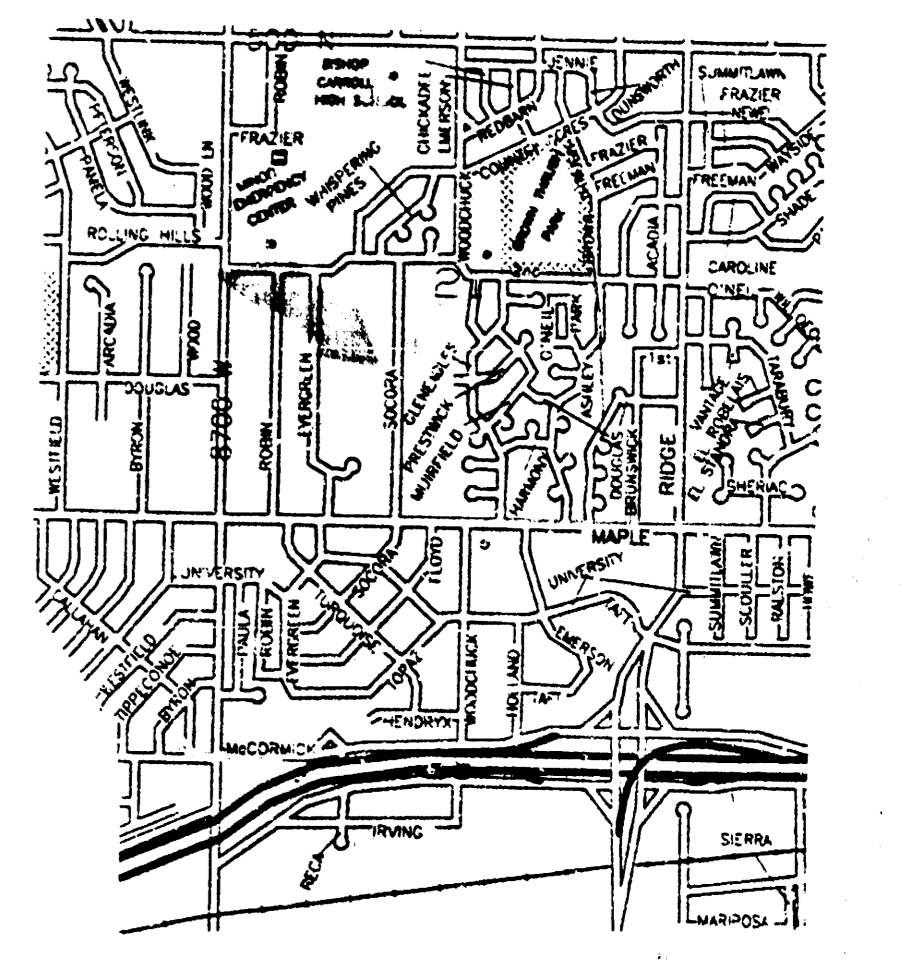

Backed 7-18-93
From SRB As Built

REVISED AS BUILT 6-4-93 SCR

PRIVATE SANITARY SEWER EXTENSION
SERVING 156 SOUTH SOCORA
CITY OF WICHITA, KANSAS

SRB 841 SOUTH HILLSIDE WICHITA, KANSAS 67211 316-652-7754 FAX 652-7932

SAVOY, RUGGLES & BOHM, P.A.
ENGINEERING & SURVEYING

PROJECT NUMBER
392 PPS

DRAWN C. Bohm	DESIGN C. Bohm	REVIEW TCR	DATE 5/18/93	UTILITY TCR	SRB JOB ASE
------------------	-------------------	---------------	-----------------	----------------	----------------

1
1