

DATE	
BY	
PROJECT	
NOTE BOOK	
NO.	

DATE	
BY	
PROJECT	
NOTE BOOK	
NO.	

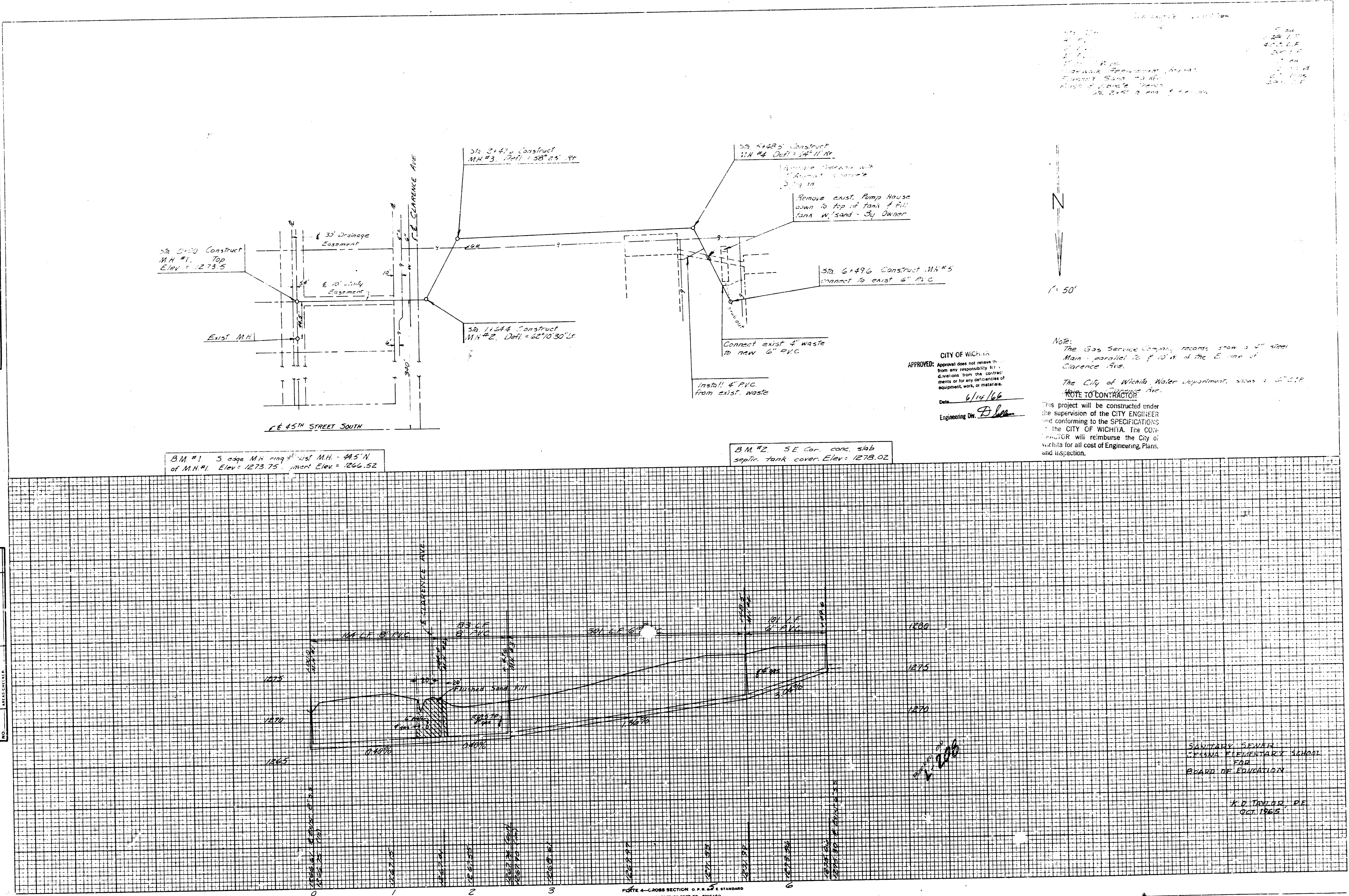

1. 30" Dia. Construct MH #1, Top Elev = 1273.5  
 2. 30" Dia. Construct MH #2, Top Elev = 1273.5  
 3. 30" Dia. Construct MH #3, Top Elev = 1273.5  
 4. 30" Dia. Construct MH #4, Top Elev = 1273.5  
 5. 30" Dia. Construct MH #5, Top Elev = 1273.5  
 6. 30" Dia. Construct MH #6, Top Elev = 1273.5  
 7. 30" Dia. Construct MH #7, Top Elev = 1273.5  
 8. 30" Dia. Construct MH #8, Top Elev = 1273.5  
 9. 30" Dia. Construct MH #9, Top Elev = 1273.5  
 10. 30" Dia. Construct MH #10, Top Elev = 1273.5  
 11. 30" Dia. Construct MH #11, Top Elev = 1273.5  
 12. 30" Dia. Construct MH #12, Top Elev = 1273.5  
 13. 30" Dia. Construct MH #13, Top Elev = 1273.5  
 14. 30" Dia. Construct MH #14, Top Elev = 1273.5  
 15. 30" Dia. Construct MH #15, Top Elev = 1273.5  
 16. 30" Dia. Construct MH #16, Top Elev = 1273.5  
 17. 30" Dia. Construct MH #17, Top Elev = 1273.5  
 18. 30" Dia. Construct MH #18, Top Elev = 1273.5  
 19. 30" Dia. Construct MH #19, Top Elev = 1273.5  
 20. 30" Dia. Construct MH #20, Top Elev = 1273.5  
 21. 30" Dia. Construct MH #21, Top Elev = 1273.5  
 22. 30" Dia. Construct MH #22, Top Elev = 1273.5  
 23. 30" Dia. Construct MH #23, Top Elev = 1273.5  
 24. 30" Dia. Construct MH #24, Top Elev = 1273.5  
 25. 30" Dia. Construct MH #25, Top Elev = 1273.5  
 26. 30" Dia. Construct MH #26, Top Elev = 1273.5  
 27. 30" Dia. Construct MH #27, Top Elev = 1273.5  
 28. 30" Dia. Construct MH #28, Top Elev = 1273.5  
 29. 30" Dia. Construct MH #29, Top Elev = 1273.5  
 30. 30" Dia. Construct MH #30, Top Elev = 1273.5  
 31. 30" Dia. Construct MH #31, Top Elev = 1273.5  
 32. 30" Dia. Construct MH #32, Top Elev = 1273.5  
 33. 30" Dia. Construct MH #33, Top Elev = 1273.5  
 34. 30" Dia. Construct MH #34, Top Elev = 1273.5  
 35. 30" Dia. Construct MH #35, Top Elev = 1273.5  
 36. 30" Dia. Construct MH #36, Top Elev = 1273.5  
 37. 30" Dia. Construct MH #37, Top Elev = 1273.5  
 38. 30" Dia. Construct MH #38, Top Elev = 1273.5  
 39. 30" Dia. Construct MH #39, Top Elev = 1273.5  
 40. 30" Dia. Construct MH #40, Top Elev = 1273.5  
 41. 30" Dia. Construct MH #41, Top Elev = 1273.5  
 42. 30" Dia. Construct MH #42, Top Elev = 1273.5  
 43. 30" Dia. Construct MH #43, Top Elev = 1273.5  
 44. 30" Dia. Construct MH #44, Top Elev = 1273.5  
 45. 30" Dia. Construct MH #45, Top Elev = 1273.5  
 46. 30" Dia. Construct MH #46, Top Elev = 1273.5  
 47. 30" Dia. Construct MH #47, Top Elev = 1273.5  
 48. 30" Dia. Construct MH #48, Top Elev = 1273.5  
 49. 30" Dia. Construct MH #49, Top Elev = 1273.5  
 50. 30" Dia. Construct MH #50, Top Elev = 1273.5  
 51. 30" Dia. Construct MH #51, Top Elev = 1273.5  
 52. 30" Dia. Construct MH #52, Top Elev = 1273.5  
 53. 30" Dia. Construct MH #53, Top Elev = 1273.5  
 54. 30" Dia. Construct MH #54, Top Elev = 1273.5  
 55. 30" Dia. Construct MH #55, Top Elev = 1273.5  
 56. 30" Dia. Construct MH #56, Top Elev = 1273.5  
 57. 30" Dia. Construct MH #57, Top Elev = 1273.5  
 58. 30" Dia. Construct MH #58, Top Elev = 1273.5  
 59. 30" Dia. Construct MH #59, Top Elev = 1273.5  
 60. 30" Dia. Construct MH #60, Top Elev = 1273.5  
 61. 30" Dia. Construct MH #61, Top Elev = 1273.5  
 62. 30" Dia. Construct MH #62, Top Elev = 1273.5  
 63. 30" Dia. Construct MH #63, Top Elev = 1273.5  
 64. 30" Dia. Construct MH #64, Top Elev = 1273.5  
 65. 30" Dia. Construct MH #65, Top Elev = 1273.5  
 66. 30" Dia. Construct MH #66, Top Elev = 1273.5  
 67. 30" Dia. Construct MH #67, Top Elev = 1273.5  
 68. 30" Dia. Construct MH #68, Top Elev = 1273.5  
 69. 30" Dia. Construct MH #69, Top Elev = 1273.5  
 70. 30" Dia. Construct MH #70, Top Elev = 1273.5  
 71. 30" Dia. Construct MH #71, Top Elev = 1273.5  
 72. 30" Dia. Construct MH #72, Top Elev = 1273.5  
 73. 30" Dia. Construct MH #73, Top Elev = 1273.5  
 74. 30" Dia. Construct MH #74, Top Elev = 1273.5  
 75. 30" Dia. Construct MH #75, Top Elev = 1273.5  
 76. 30" Dia. Construct MH #76, Top Elev = 1273.5  
 77. 30" Dia. Construct MH #77, Top Elev = 1273.5  
 78. 30" Dia. Construct MH #78, Top Elev = 1273.5  
 79. 30" Dia. Construct MH #79, Top Elev = 1273.5  
 80. 30" Dia. Construct MH #80, Top Elev = 1273.5  
 81. 30" Dia. Construct MH #81, Top Elev = 1273.5  
 82. 30" Dia. Construct MH #82, Top Elev = 1273.5  
 83. 30" Dia. Construct MH #83, Top Elev = 1273.5  
 84. 30" Dia. Construct MH #84, Top Elev = 1273.5  
 85. 30" Dia. Construct MH #85, Top Elev = 1273.5  
 86. 30" Dia. Construct MH #86, Top Elev = 1273.5  
 87. 30" Dia. Construct MH #87, Top Elev = 1273.5  
 88. 30" Dia. Construct MH #88, Top Elev = 1273.5  
 89. 30" Dia. Construct MH #89, Top Elev = 1273.5  
 90. 30" Dia. Construct MH #90, Top Elev = 1273.5  
 91. 30" Dia. Construct MH #91, Top Elev = 1273.5  
 92. 30" Dia. Construct MH #92, Top Elev = 1273.5  
 93. 30" Dia. Construct MH #93, Top Elev = 1273.5  
 94. 30" Dia. Construct MH #94, Top Elev = 1273.5  
 95. 30" Dia. Construct MH #95, Top Elev = 1273.5  
 96. 30" Dia. Construct MH #96, Top Elev = 1273.5  
 97. 30" Dia. Construct MH #97, Top Elev = 1273.5  
 98. 30" Dia. Construct MH #98, Top Elev = 1273.5  
 99. 30" Dia. Construct MH #99, Top Elev = 1273.5  
 100. 30" Dia. Construct MH #100, Top Elev = 1273.5

CITY OF WICHITA  
 APPROVED: \_\_\_\_\_  
 Date: 6/14/66  
 Engineering: D. B. [Signature]

NOTE:  
 The Gas Service Company records show a 2" steel  
 Main, parallel to & 10' N. of the E. line of  
 Clarence Ave.  
 The City of Wichita Water Department, shows a 2" S.P.  
 Main, parallel to & 10' N. of the E. line of  
 Clarence Ave.  
 NOTE TO CONTRACTOR:  
 This project will be constructed under  
 the supervision of the CITY ENGINEER  
 and conforming to the SPECIFICATIONS  
 of the CITY OF WICHITA. The CITY  
 ENGINEER will reimburse the City of  
 Wichita for all cost of Engineering, Plans,  
 and Inspection.

SANITARY SEWER  
 WICHITA ELEMENTARY SCHOOL  
 BOARD OF EDUCATION  
 K. D. TULLER, DE.  
 OCT. 1965