

Notes:
 Contact Carl May Maintenance Foreman
 Davis Mfg. Co. for assistance in locating
 buried utilities. Also contact S.W. Bell and
 K&E.
 Contractor shall protect existing utilities.
 Contractor shall only close one lane of
 concrete drive at any time. The trench shall
 be backfilled, compacted and rodded at the
 end of the day.

PLAN
 SHEET NO. 101
 DATE 8-7-79
 PROJECT NO. 101
 DRAWN BY [Signature]
 CHECKED BY [Signature]
 APPROVED BY [Signature]

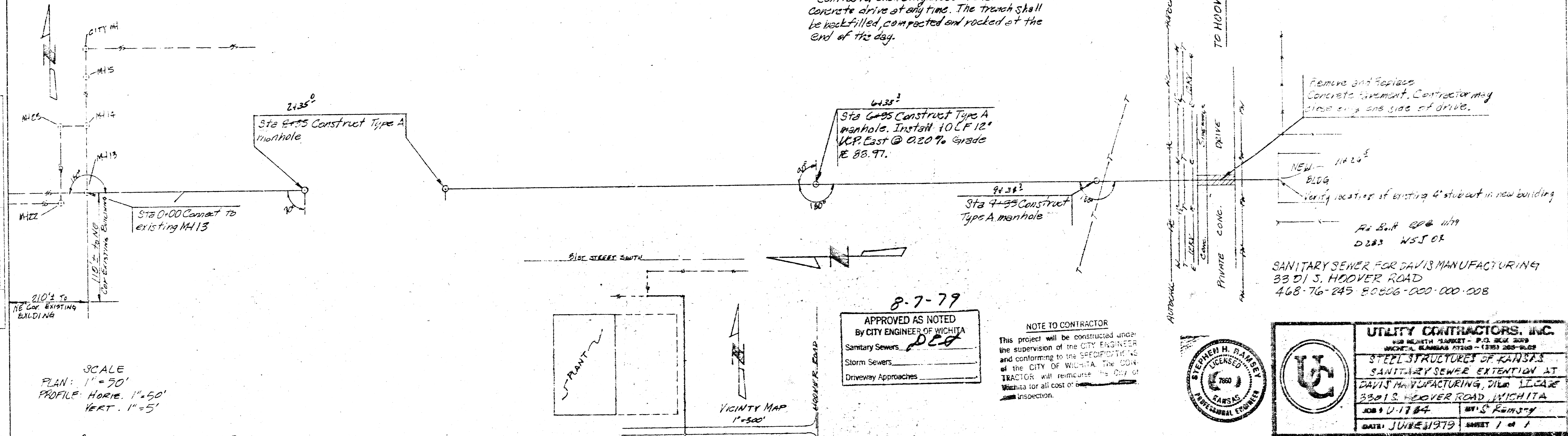

SCALE
 PLAN: 1" = 50'
 PROFILE: HORIZ. 1" = 50'
 VERT. 1" = 5'

BM: Top of Ring Existing MH13 ELEV. 97.92

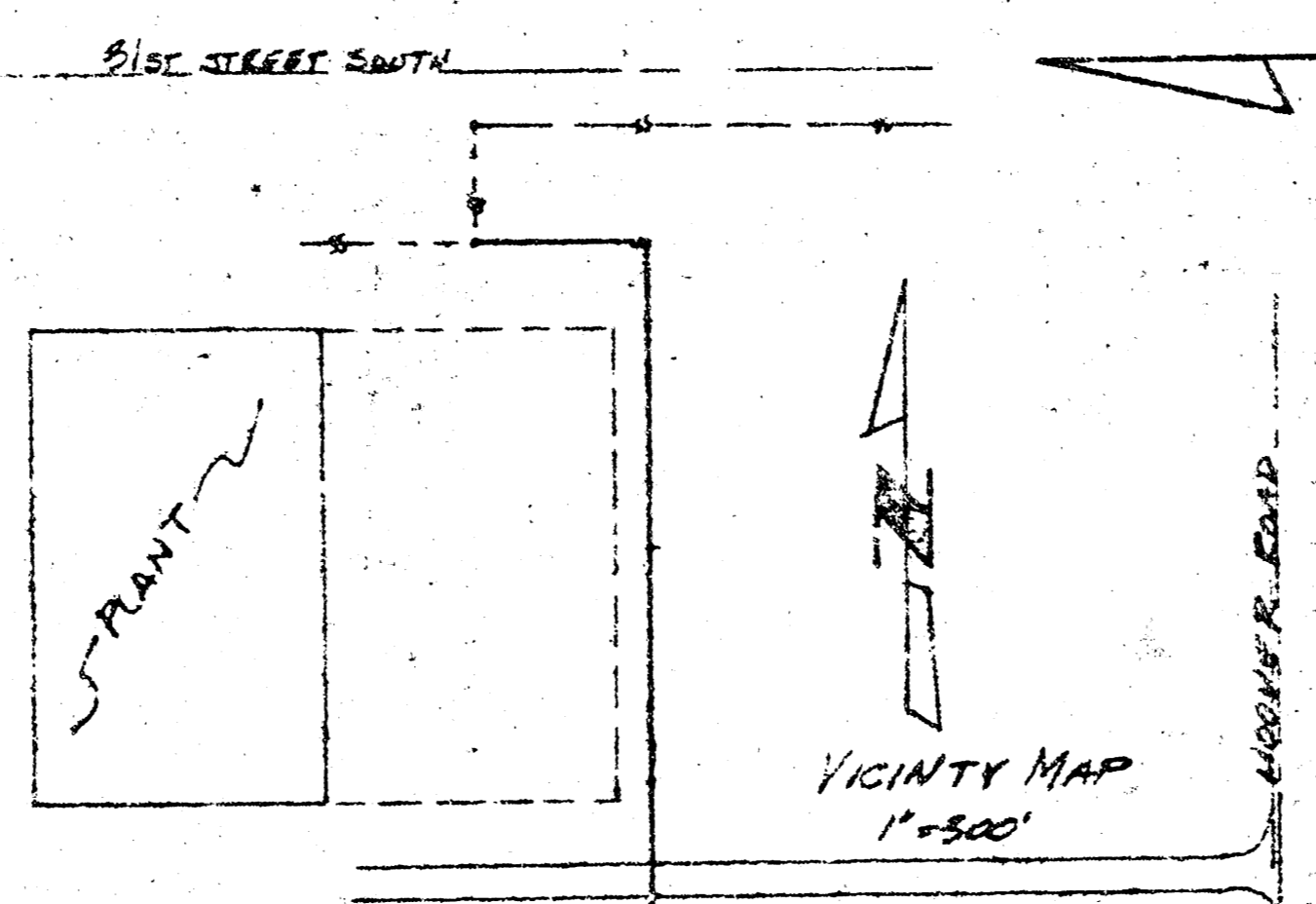

8-7-79
 APPROVED AS NOTED
 By CITY ENGINEER OF WICHITA
 Sanitary Sewers [Signature]
 Storm Sewers
 Driveway Approaches

NOTE TO CONTRACTOR
 This project will be constructed under
 the supervision of the CITY ENGINEER
 and conforming to the SPECIFICATIONS
 of the CITY OF WICHITA. The CON-
 TRACTOR will reimburse the City of
 Wichita for all cost of
 inspection.

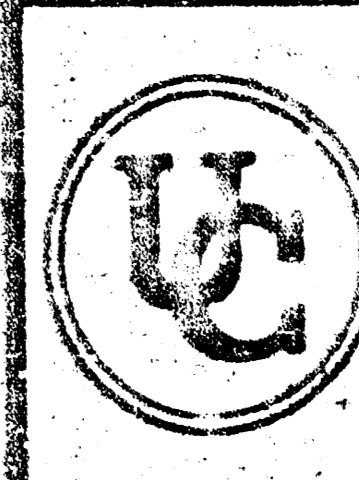
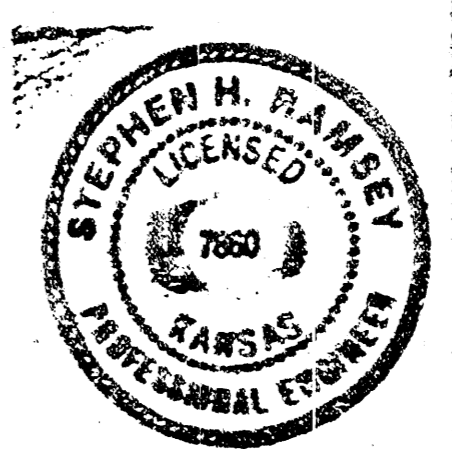

UTILITY CONTRACTORS, INC.
 100 HEALTH MARKET - P.O. BOX 2009
 WICHITA, KANSAS 67208 - (316) 265-9128
 SPECIALTIES OF KANSAS
 SANITARY SEWER EXTENSION AT
 DAVIS MANUFACTURING, DILL LILACE
 3301 S. HOOVER ROAD, WICHITA
 JOB # U-1784
 DATE: JUN 21 1979 SHEET 1 of 1

PROFILE
 SHEET NO. 102
 DATE 8-7-79
 PROJECT NO. 101
 DRAWN BY [Signature]
 CHECKED BY [Signature]
 APPROVED BY [Signature]

