

PLAN  
 CITY OF WICHITA  
 SANITARY SEWER  
 PROJECT NO. 1000  
 DATE 7/31/85

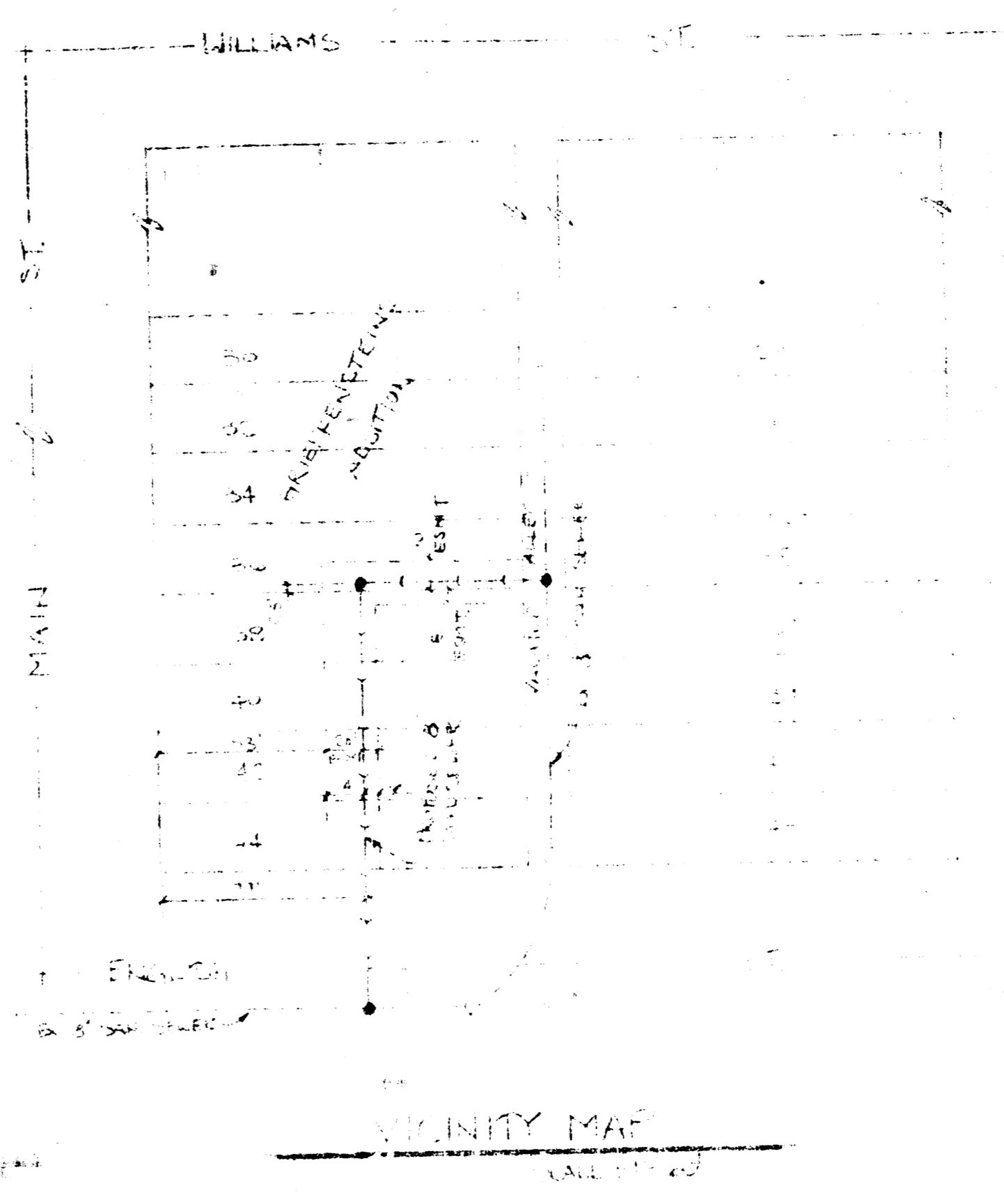

- NOTES:
- Contractor to verify location and elevation of sanitary sewer lines, and other existing utilities prior to construction of new sanitary sewer lines.
  - For plugging and abandoning existing sanitary sewer lines and manholes, refer to "City of Wichita" details and specifications.
  - Contractor to field locate and maintain existing sewer line in service throughout construction. Reconnect sewer as required.
  - Contractor to coordinate with City of Wichita to remove and replace existing pavement within English Street Right-of-Way.
  - All existing pavement (except English Street) must have curbs, gutters, and parking areas, etc. to be removed "by other" prior to sewer construction.
  - All construction and materials to be in accordance with "City of Wichita" standards and specifications.

SEWER WORK  
 ELEVATION IN FEET  
 SEE PROFILE FOR ELEVATIONS  
 SEE PLAN FOR MANHOLE LOCATIONS  
 SEE SPECIFICATIONS FOR MATERIALS

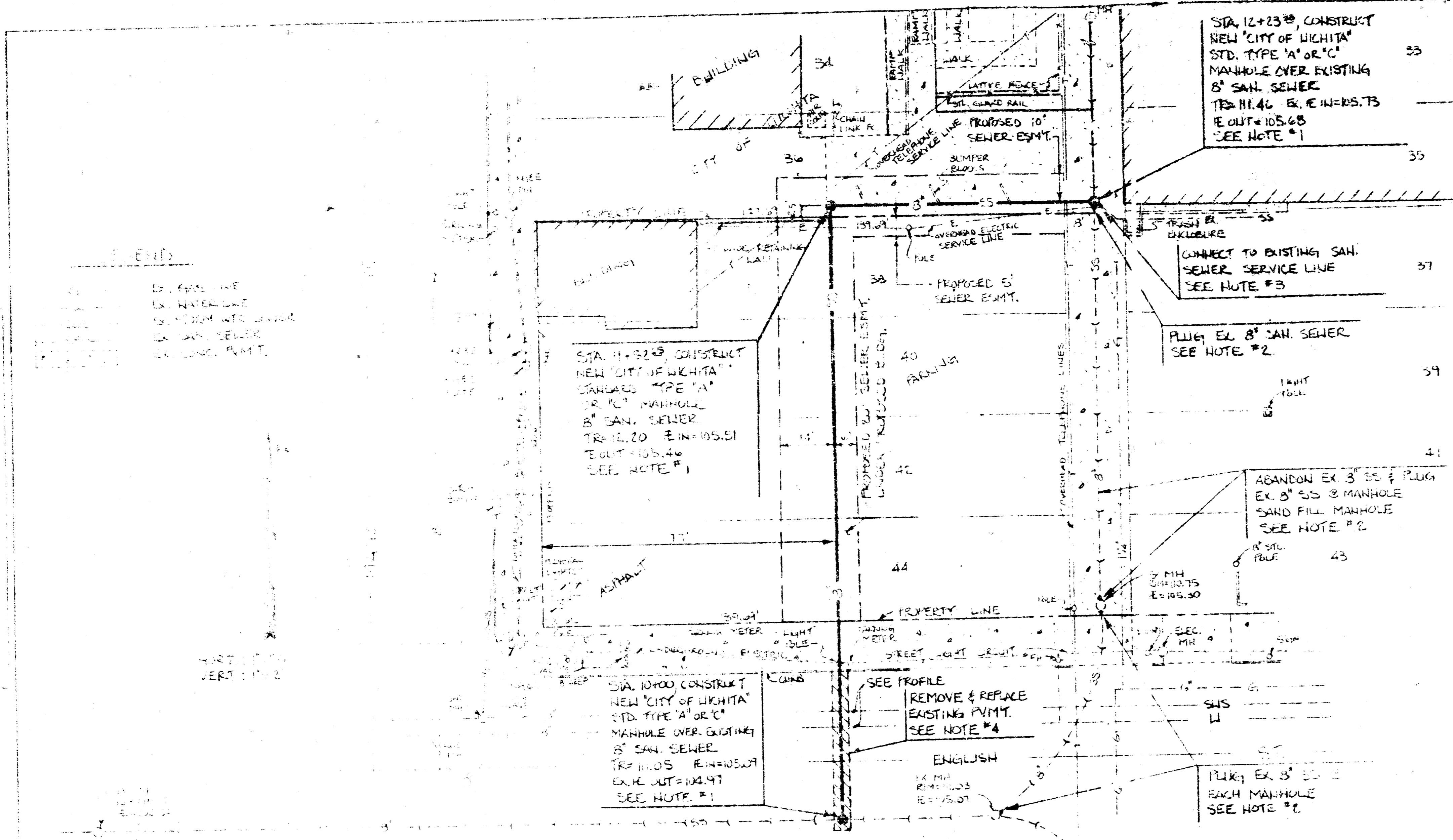

APPROVED TO PROCEED  
 BY CITY ENGINEER OF WICHITA  
 Signature: *EJB 7/31/85*  
 Date: 7/31/85

NOTE TO CONTRACTOR  
 This project will be constructed under the supervision of the CITY ENGINEER and contractor shall be responsible to the CITY OF WICHITA. CONTRACTOR will pay the City of Wichita for all tests and plan review, construction and paving per contract.

LAW/KINGDON, INC.  
 ARCHITECTS & ENGINEERS  
 548 W. 10TH ST., WICHITA, KANSAS 67203  
 PHONE (316) 266-2222 Copyright © 1985

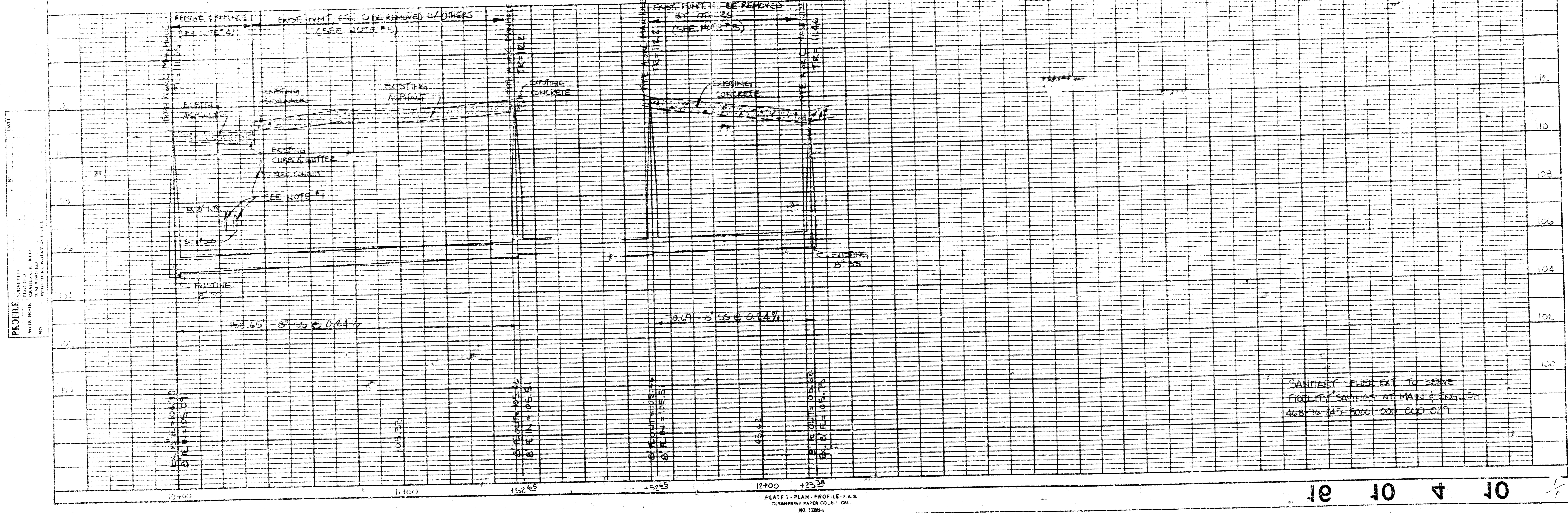

SANITARY SEWER EX. TO SERVICE  
 EXIST. MANHOLE AT MAIN & ENGLISH  
 SEE PLAN FOR MANHOLE LOCATIONS

PLATE 1: PLAN, PROFILE, & A.S.  
 CLEARPRINT PAPER CO., INC. CAL.  
 NO. 1200-1

10 10 4 10

FILMED FROM THE BEST AVAILABLE COPY....