

21ST ST. NORTH

GENERAL NOTES

Contractor shall verify locations of existing utility lines prior to beginning trenching operations.
Street & Walk & Drive to be replaced as per city specs.
Contractor to contact property owner affected by drive reconstruction prior to construction.
Contractor to contact Res. Use Rease-Cas Service Co. prior to construction for gas line location & depth.

Scale: Hor. 1"=20'
Ver. 1"=5'

BLK. I, GARDNERS RIVERLAWN ADD.

Remove & Replace
33 S.Y. Conc. Pymt.
4' 10" S.F. Conc. Drive
& 10' L.F. Conc. Curb.
Saw Cut Pymt.

Sta. 0+00 Const.
Std. Type "A" Manhole
on Exist. 8" San.
Sewer.

Exist. 8" Sanitary
Sewer.

COOLIDGE
(Conc. Pymt.)

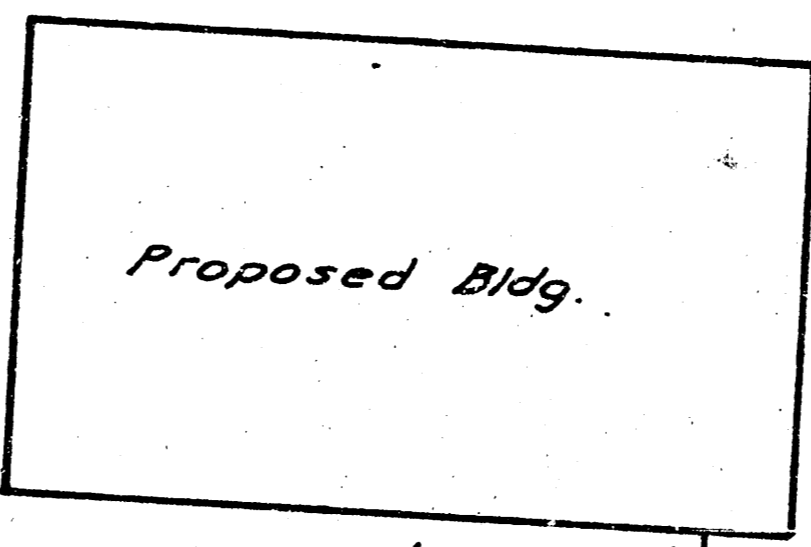

Sewer
Casement.

Sta. 0+61.9 Const.
Std. Type "A" Manhole
with 8" Stub West

NOTE: CONTRACTOR
This project is a construction project
under the authority of the City Engineer
of the City of Wichita, Kansas. The
contractor shall be responsible for
obtaining all necessary permits from
the City of Wichita and the State
Department of Transportation.
3-26-82
APPROVED AS NOTED
By CITY ENGINEER OF WICHITA
Sanitary Sewers
Storm Sewers
Driveway Approaches

B.M. City disc 3' S. back walk W.
& 7' E. back walk S. SW
Cor. 21st & Amidon E112789

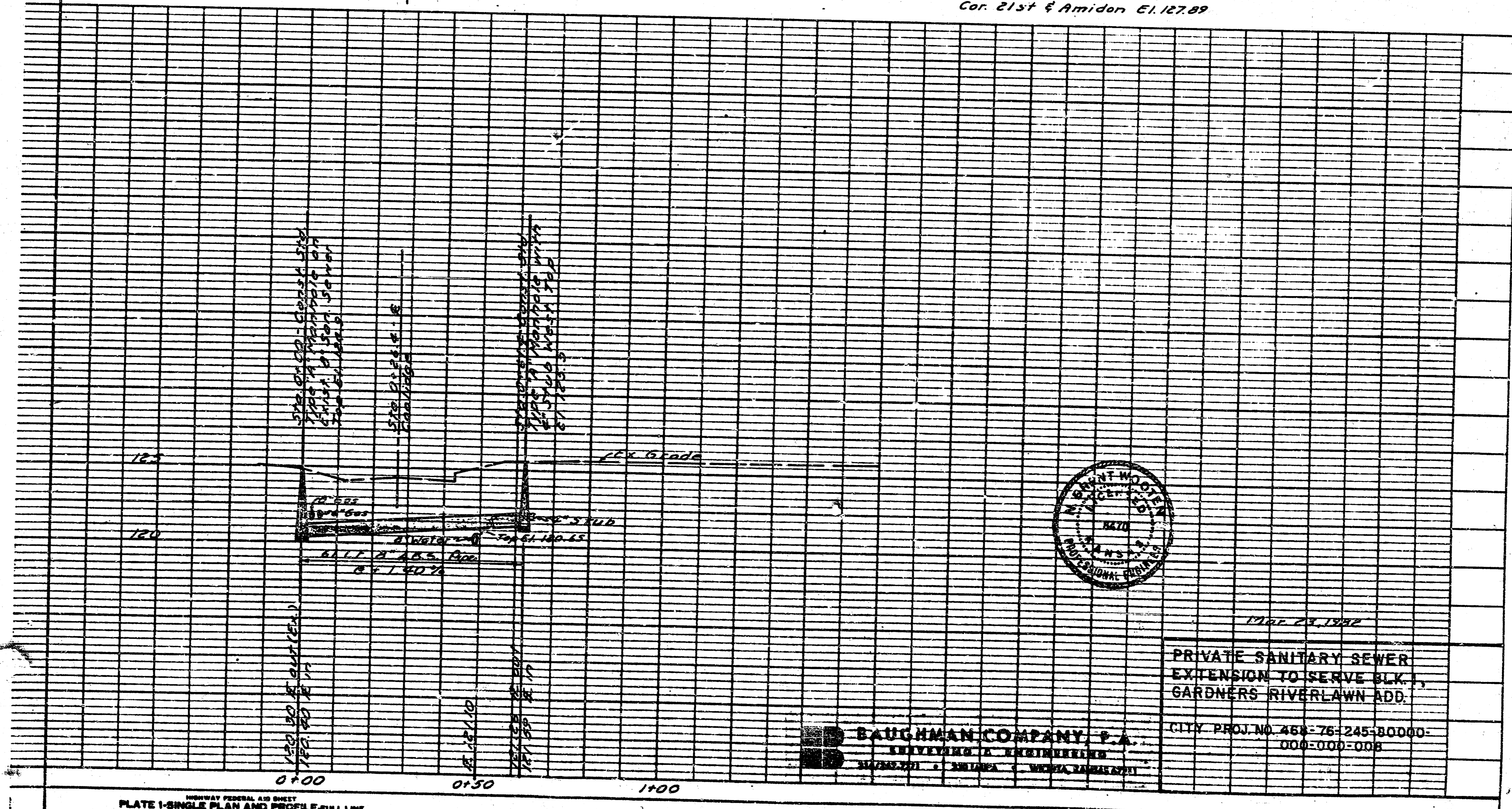

AVAILABLE COPY...
FILMED FROM THE BEST



BAUGHMAN COMPANY, P.A.
ENGINEERS & ARCHITECTS
SUITES 201 & 202 • 21ST ST. • WICHITA, KANSAS 67201

PRIVATE SANITARY SEWER
EXTENSION TO SERVE BLK. I,
GARDNERS RIVERLAWN ADD.
CITY PROJ. NO. 488-76-245-80000
000-000-000