

Bench Marks: City of Wichita Dist. 44' West and 56' North of Centerline of Woodlawn and Central. Elevation 192.27 City Datum

NE cor sidewalk @ Sta. 0+10, 70' Left, Elevation 193.94

Saw, Remove & Rep. Urbs, Asphalt, and Decor. as necessary. Rock as necessary.

Station 0+00 Remove 4" Slab and begin Const. Service to 501 N. Woodlawn is to be reconnected to new 8" San Sewer. (See Note 4)

Saw 4.0"± from back of Curb; Remove & Replace Concrete Pavement, as Necessary for Construction. (5' Concrete 44" curb per detail this sheet)

CAUTION: Existing K.P.L. Gas Serv. Co. Service Line Crossing

CAUTION: Existing K.G. & E. Underground Primary & Secondary Lines (Crosses @ 3 Locations)

KAPAUN Sta. 0+71, 4" Tap (501 N. Woodlawn)

EXISTING BUILDING Do not disturb Trees

EXISTING BUILDING FIRST

Remove & Replace Concrete Walk to the Nearest Joint.

5' x 10' Add. Sewer Com't. (Film 1013, Page 62)

ADDITION Remove & Replace 4" Cast Iron Pipe Roof Drain as necessary

Remove & Replace 8" Asphalt Pavement as necessary

EXISTING ASPHALT

ADDITION

Station 1+48.0 Construct Std. Manhole, Top Elevation 194.2 194.04 @ 6" Slab Northwest. (Ring offset 0.8' S.W.)

LOCATION MAP

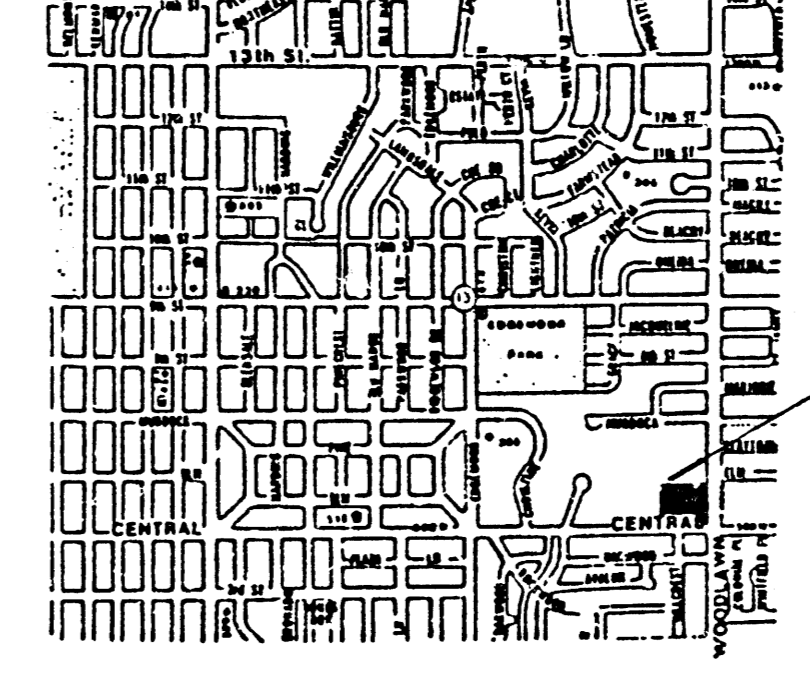

APPROVED AS NOTED BY CITY ENGINEER OF WICHITA

San Sewers  
Storm Sewers  
Driveway Approaches  
Water Mains

LEGEND For Existing Lines  
-ss- San Sewer  
-sus- Storm Sewer  
-E- K.G. & E. Lines  
-T- S.L. Bell Lines  
-G- K.P.L. Gas Lines

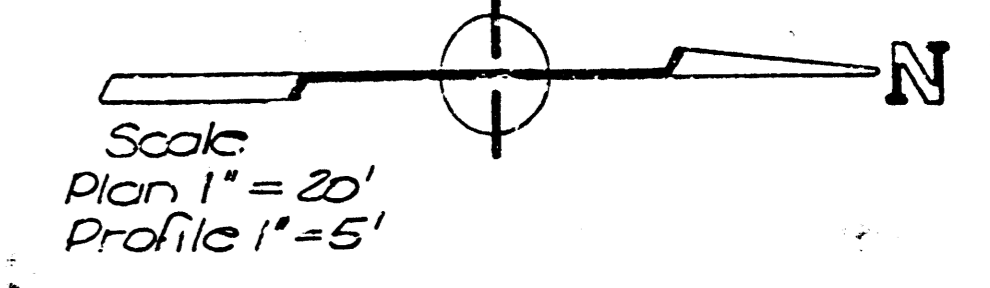

GENERAL NOTES

- Existing utilities and their locations, as shown on the plans, represent the best information obtainable for design. It shall be the Contractor's responsibility to contact the utility companies to verify locations and depths at least 48 hours prior to any excavation.
- The Contractor shall protect trees adjacent to the project from damage.
- The Contractor shall notify property owners or tenants of the buildings adjacent to the project a minimum of 10 days prior to construction, and make arrangements for the closing of the driveway for construction.
- The Contractor shall maintain continuous flow of sewage through construction. Active building sewer lines are to be reconnected to the sewer. All work involved with building sewer lines and connections shall conform to the applicable section of the Standard Specifications.

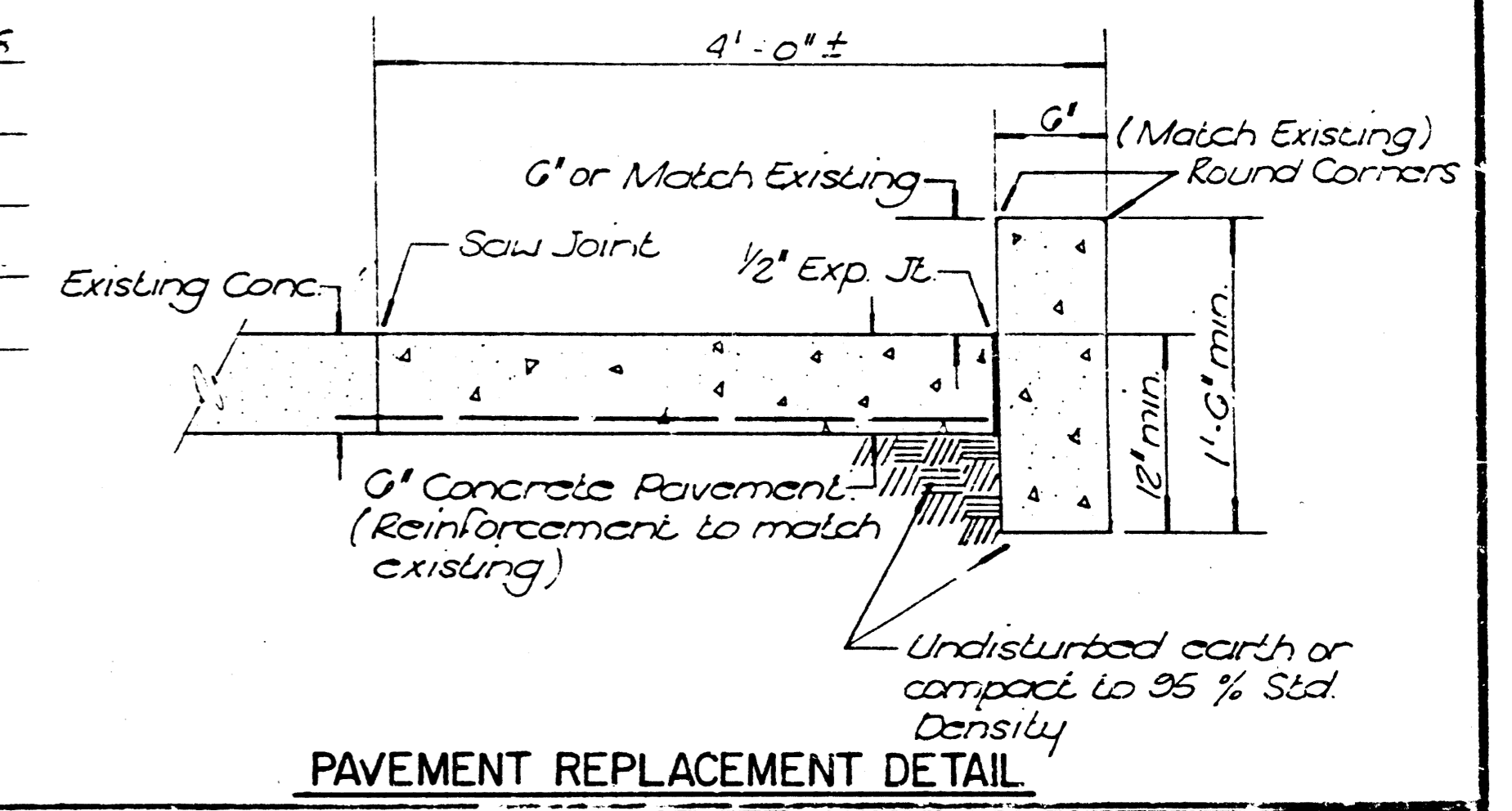

NOTE TO CONTRACTOR  
INSPECTION AND TESTING FOR THIS PROJECT IS TO BE PROVIDED BY THE LICENSED CONSULTING ENGINEERING FIRM IN CONTRACT WITH THE OWNER. ALL WORK SHALL BE IN ACCORDANCE WITH THE CITY OF WICHITA STANDARD SPECIFICATIONS FOR CONSTRUCTION. THE ENGINEER'S RESPONSIBILITY IS LIMITED TO THE DESIGN AND CONSTRUCTION OF THE SANITARY SEWER SYSTEM SHOWN ON THESE PLANS. THE CONTRACTOR SHALL BE RESPONSIBLE FOR OBTAINING ALL NECESSARY PERMITS AND FOR OBTAINING ALL NECESSARY INFORMATION FROM THE CITY OF WICHITA. THE CONTRACTOR SHALL BE RESPONSIBLE FOR OBTAINING ALL NECESSARY INFORMATION FROM THE CITY OF WICHITA. THE CONTRACTOR SHALL BE RESPONSIBLE FOR OBTAINING ALL NECESSARY INFORMATION FROM THE CITY OF WICHITA.

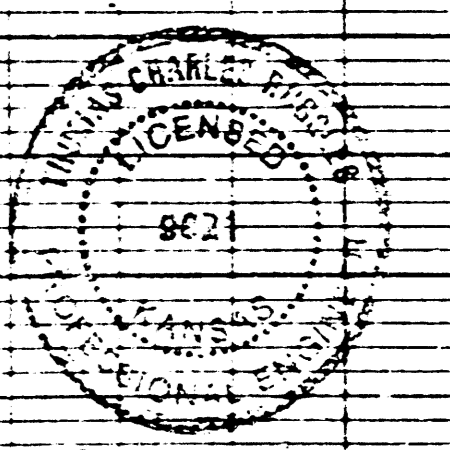
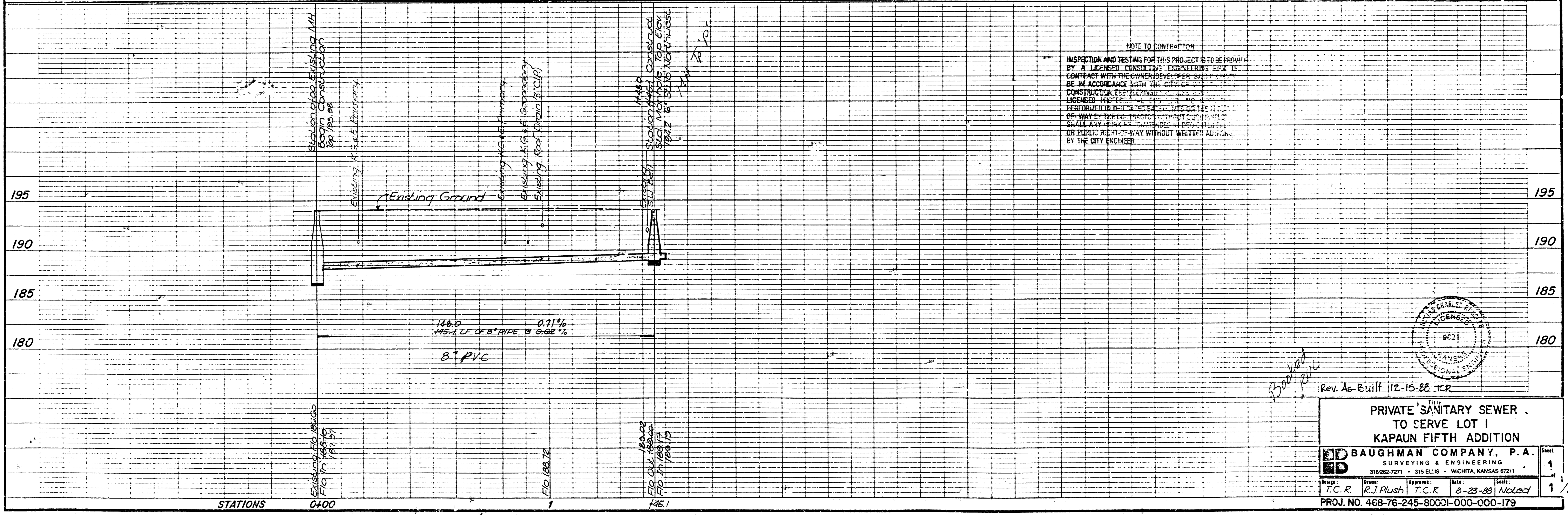

Rev. As-Built 11-2-88 TCR

PRIVATE SANITARY SEWER TO SERVE LOT 1 KAPAUN FIFTH ADDITION

BAUGHMAN COMPANY, P.A.  
SURVEYING & ENGINEERING  
316262-7271 • 315 ELLIS • WICHITA, KANSAS 67211

Design: T.C.R. Drawn: R.J. Plush Approved: T.C.R. Date: 8-23-88 Scale: Noted

Proj. No. 468-76-245-80001-000-000-179

FILMED FROM THE BEST AVAILABLE COPY

Bench Mark: City of Wichita Disc. 44' West and 56' North of Centerline of Woodlawn and Central. Elevation 192.27 City Datum

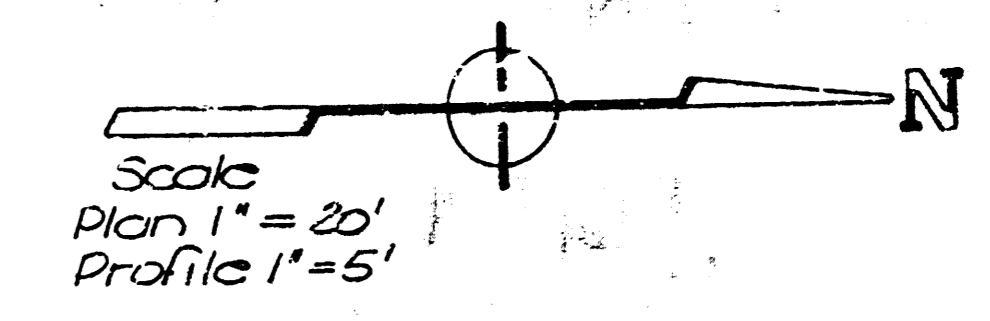

DATE	BY	REVISION

DATE	BY	REVISION

Soil, Remove & Replace Curb, Asphalt, and Decorative Rack as necessary

Station 0400 Remove 4" Stub and begin Const. Service to 50' N. Woodlawn is to be reconnected to new 8" San. Sewer. (See Note 4)

Soil 4.0'± From back of Curb; Remove & Replace Concrete Pavement, as Necessary for Construction. (5" Concrete 4 1/2" Curb; per detail this sheet)

CAUTION: Existing KPL Gas Serv. Co. Service Line Crossing

CAUTION: Existing K.G. & E. Under ground Primary & Secondary Lines (Crosses @ 3 Locations)

KAPAUN FIFTH

Remove & Replace Concrete Walk to the Nearest Joint.

ADDITION Remove & Replace 4" Cast Iron Pipe Roof Drain as necessary

Remove & Replace 5" Asphalt Pavement as necessary

Station 145.1 Construct Std. Manhole, Top Elevation 194.2 6" Stub Northwest.

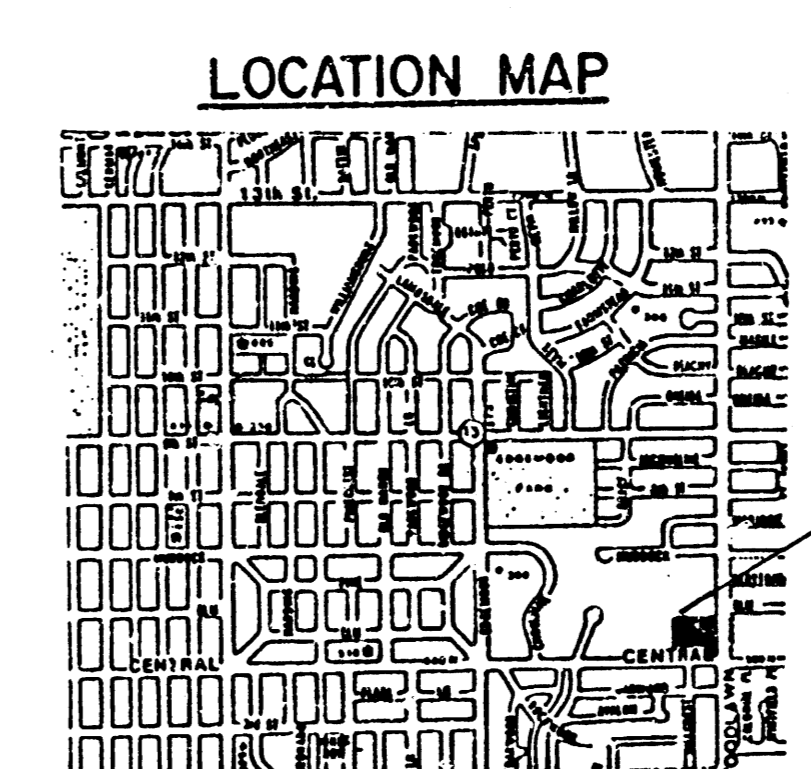

PROJECT VICINITY

GENERAL NOTES

- Existing utilities and their locations, as shown on the plans, represent the best information obtainable for design. It shall be the Contractor's responsibility to contact the utility companies to verify locations and depths at least 48 hours prior to any excavation.
- The Contractor shall protect trees adjacent to the project from damage.
- The Contractor shall notify property owners or tenants of the buildings adjacent to the project a minimum of 10 days prior to construction, and make arrangements for the closing of the driveway for construction.
- The Contractor shall maintain continuous flow of sewage through construction. Active building sewer lines are to be reconnected to the sewer. All work involved with building sewer lines and connections shall conform to the applicable section of the Standard Specifications.

APPROVED AS NOTED  
By CITY ENGINEER OF WICHITA  
Sanitary Sewers *[Signature]*  
Storm Sewers \_\_\_\_\_  
Driveway Approaches \_\_\_\_\_  
Water Mains \_\_\_\_\_  
Pavement \_\_\_\_\_

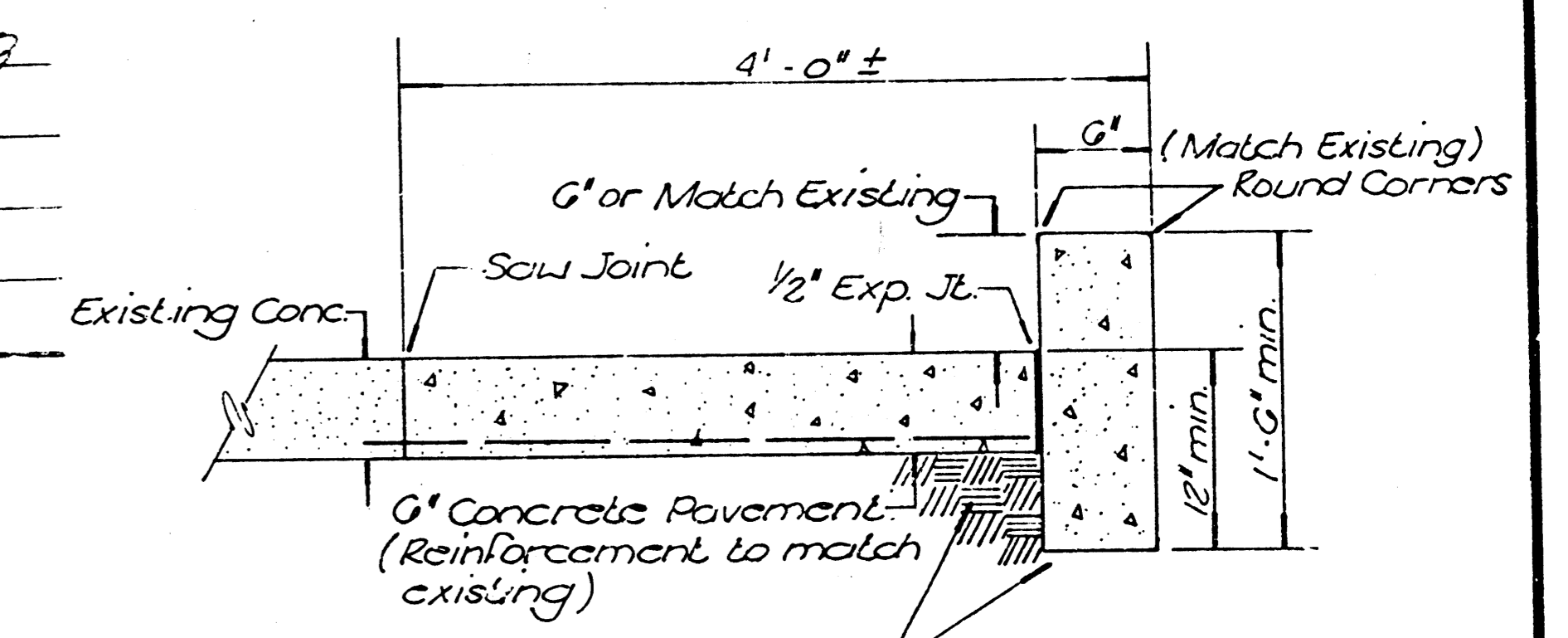
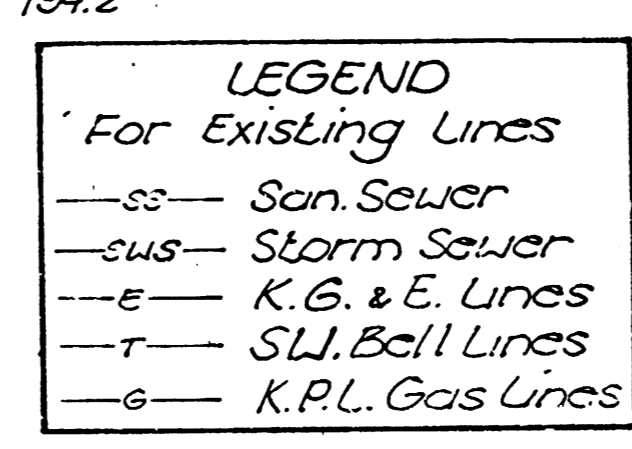

PAVEMENT REPLACEMENT DETAIL

NOTE TO CONTRACTOR  
INSPECTION AND TESTING FOR THIS PROJECT IS TO BE PROVIDED BY A LICENSED CONSULTING ENGINEERING FIRM IN CONTRACT WITH THE OWNER AND UNDER THE SUPERVISION OF THE CITY ENGINEER OF WICHITA. ALL INSPECTIONS SHALL BE IN ACCORDANCE WITH THE CITY OF WICHITA'S CONSTRUCTION ENGINEERING PRACTICES AND PROCEDURES. LICENSED PROFESSIONAL ENGINEERS WHO WORK ON THIS PROJECT SHALL BE RESPONSIBLE FOR THE ACCURACY OF THE DATA AND SHALL BE RESPONSIBLE FOR THE CORRECTNESS OF THE DESIGN. ANY WORK SHALL BE DONE IN ACCORDANCE WITH THE CITY OF WICHITA'S STANDARD SPECIFICATIONS FOR PUBLIC WORKS WITHOUT WRITTEN AUTHORIZATION BY THE CITY ENGINEER.

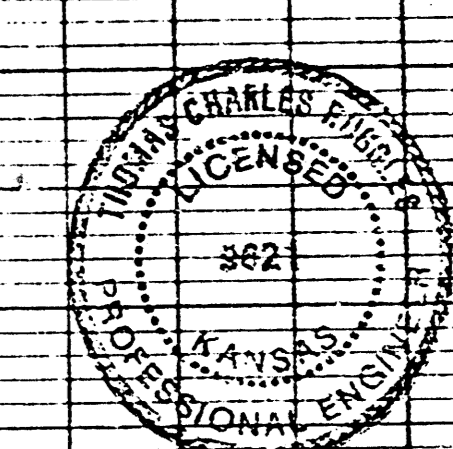

PRIVATE SANITARY SEWER TO SERVE LOT 1 KAPAUN FIFTH ADDITION

BAUGHMAN COMPANY, P.A.  
SURVEYING & ENGINEERING  
316262-7271 • 315 ELLIS • WICHITA, KANSAS 67211

Design: T.C.R. R.J. Plush Date: 8-23-88 Noted: T.C.R.

PROJ. NO. 468-76-245-80001-000-000-179

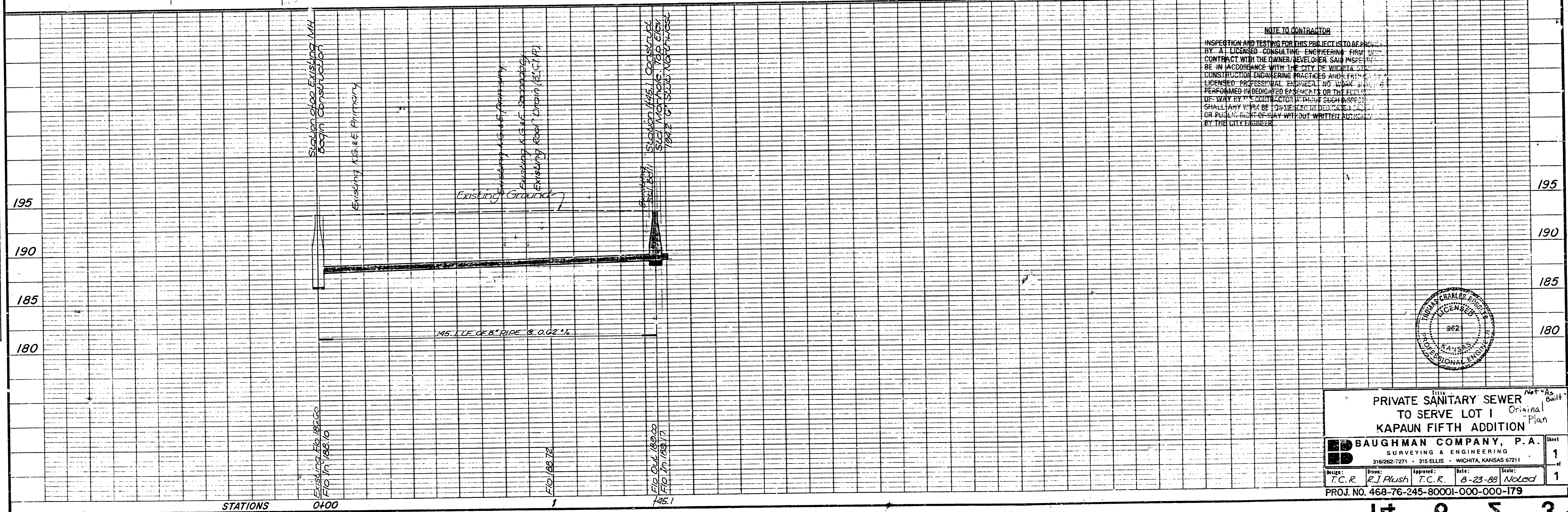

14 0 5 3 2/2

FILMED FROM THE BEST AVAILABLE COPY