

BENCH MARK: 15. Rim Manhole Sta. 0+00  
Elev = 117.46 City Datum

SCALE 1" = 20' PLAN  
1" = 5' PROFILE

PLAN  
REVISED  
BY  
DATE

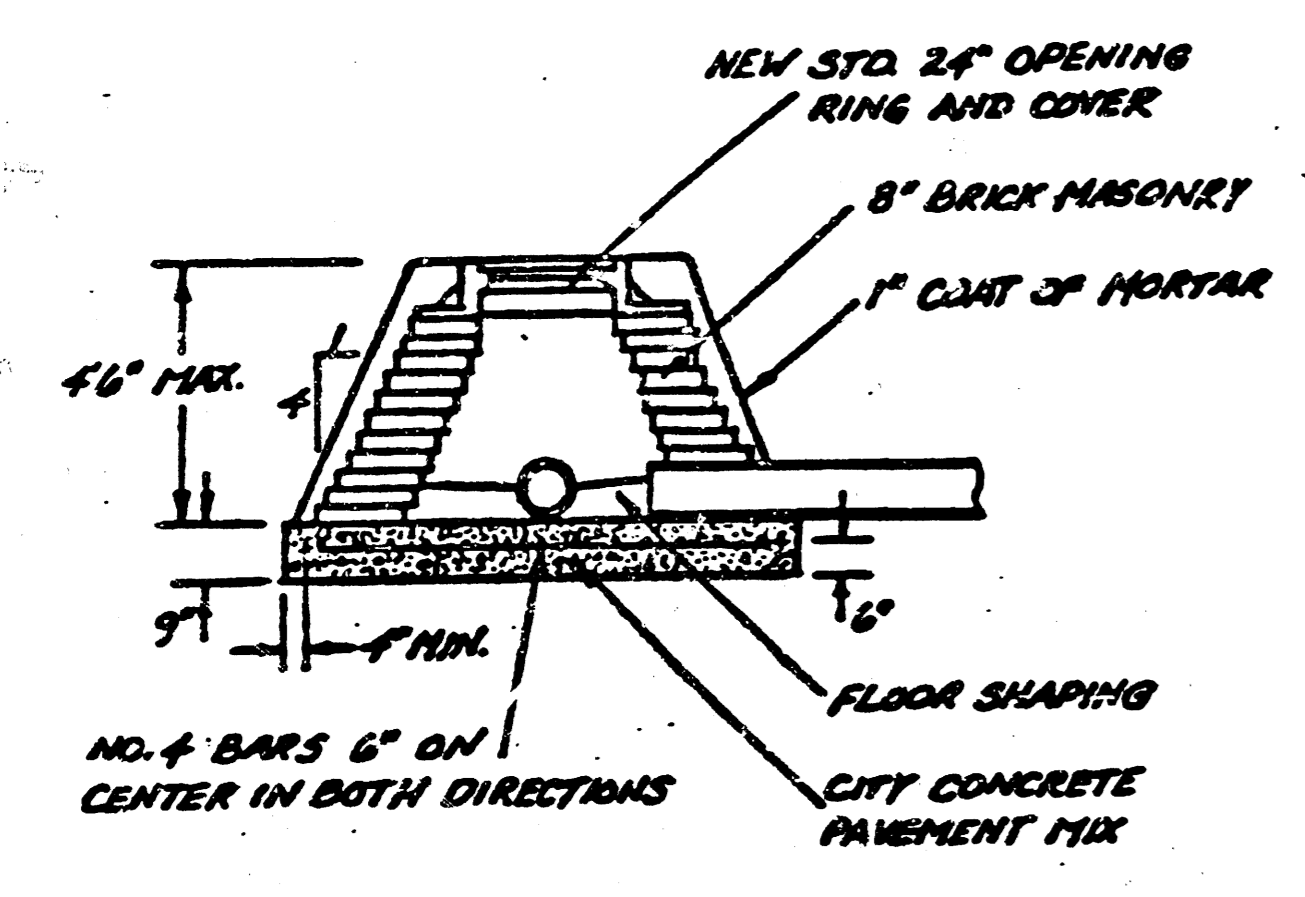

SPECIAL MANHOLE "TYPE A"

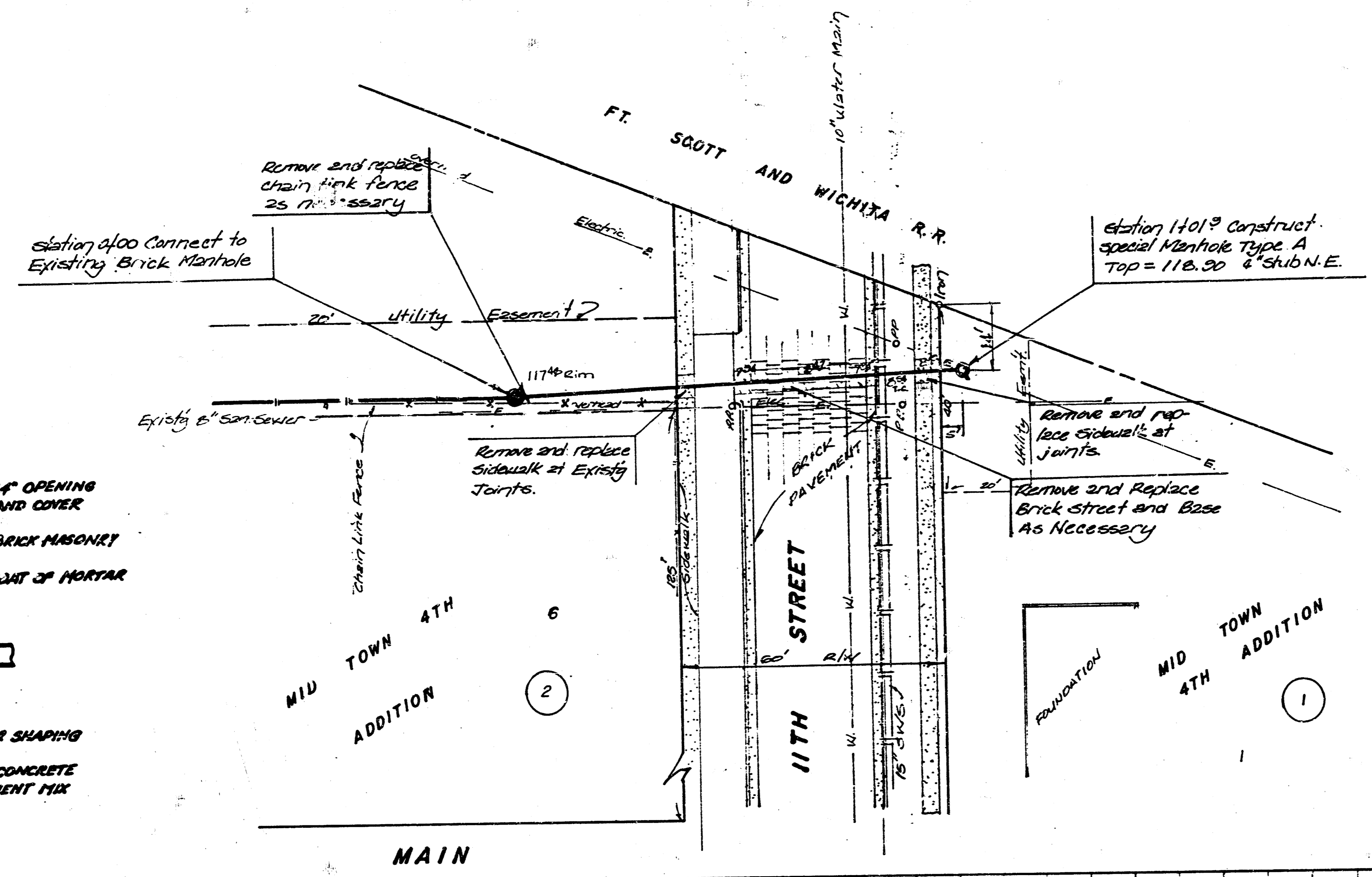

MAIN

**GENERAL NOTES**

The contractor shall remove and replace the concrete curb and gutter, brick pavement with base, and concrete sidewalk as per City of Wichita Standard Specifications.

The contractor shall contact the property owner of Lot 6 prior to beginning any construction.

The contractor shall adequately barricade 11th Street to traffic during construction.

The contractor shall use precaution when excavating over the water line and the storm sewer and shall expose both and verify the elevations for clearance depths.

The contractor shall contact the utility companies prior to construction in order to verify any other possible underground utility lines with the R.W. areas.

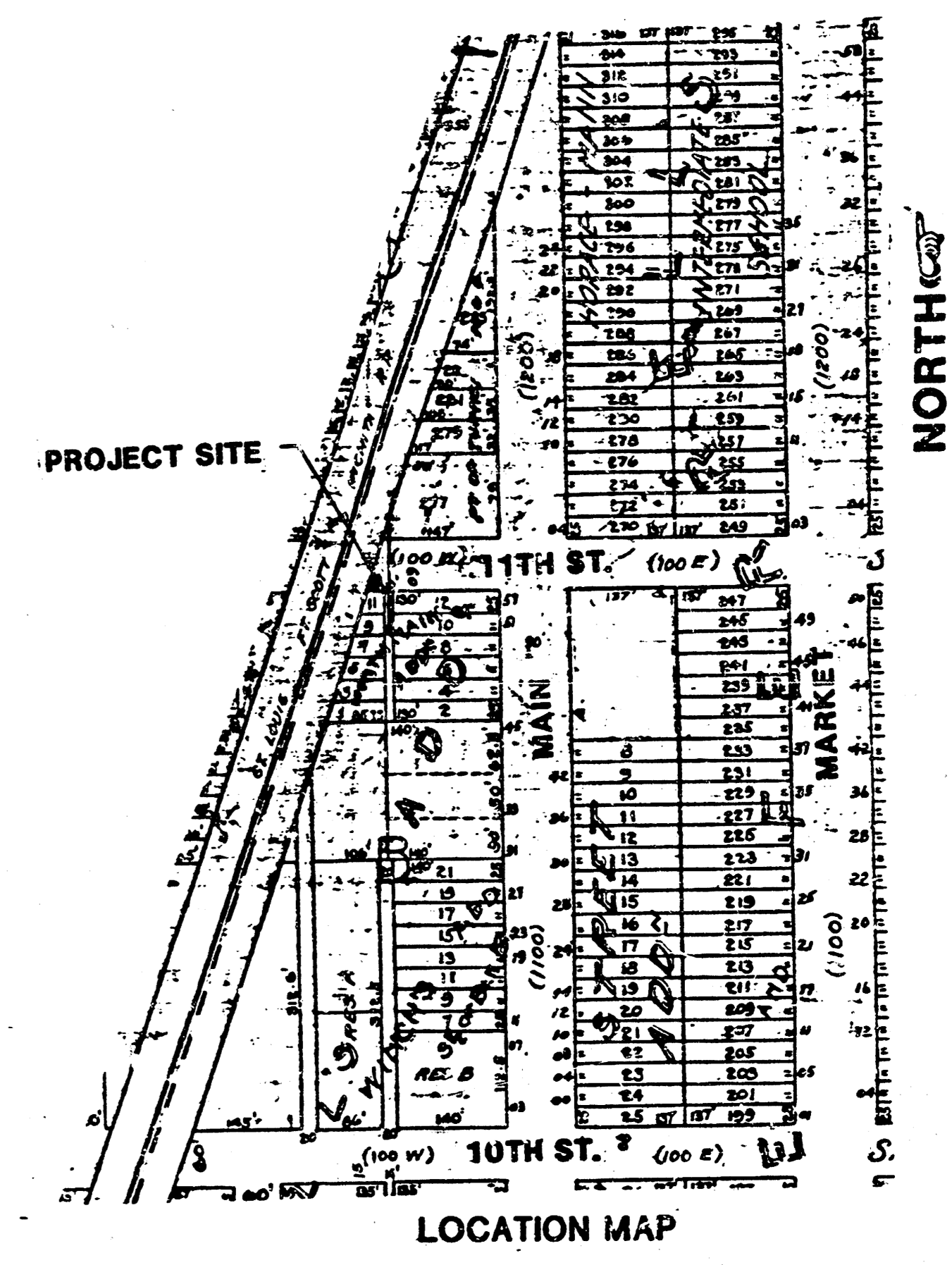

PROFILE  
REVISED  
BY  
DATE

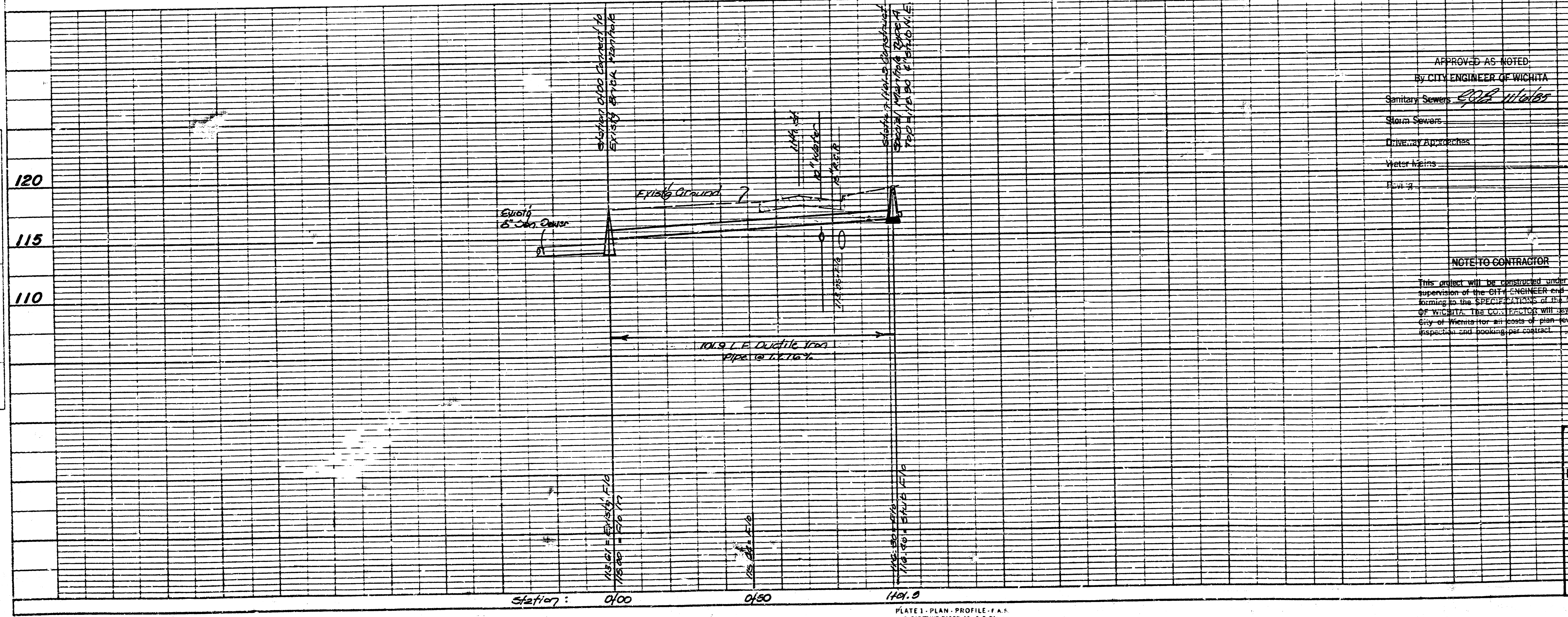

APPROVED AS NOTED  
BY CITY ENGINEER OF WICHITA  
Sanitary Sewers *2022 11/10/85*  
Storm Sewers  
Driveway Approaches  
Water Mains  
Flow

**NOTE TO CONTRACTOR**  
This project will be constructed under the supervision of the CITY ENGINEER and conforming to the SPECIFICATIONS of the CITY OF WICHITA. The CONTRACTOR will pay the City of Wichita for all costs of plan-review, inspection and looking-out contract.

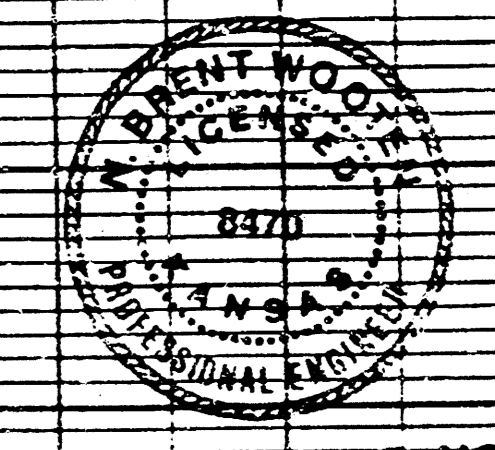

5-NOV-85

PRIVATE SANITARY EXTENSION TO SERVE  
PART OF LOT 1, MID TOWN 4TH ADDITION

CITY OF WICHITA, KS  
PROJECT NUMBER  
468-78-245-300014000-000-045

BAUGHMAN COMPANY, P.A.  
SURVEYING & ENGINEERING  
316267211 330 DURAN WICHITA, KANSAS 67211

PLATE 1, PLAN, PROFILE, P.A.S.  
CLEARPRINT PAPER CO., & C.O.  
NO. 10004

11 5 5 41

FILMED FROM THE BEST AVAILABLE COPY