

ITEM #3-M35:  
DRAWING SHEET M2.7 - RE: ROOM F201: DELETE VENT LINE SIZE DESIGNATION OF 2 1/2" V.T.R. AND INSERT 2" V.T.R.

ITEM #3-M36:  
DRAWING SHEET M2.8 - RE: PLAN NOTE 19: INSERT PLUMBING FIXTURE DESIGNATION OF P-15.

ITEM #3-M37:  
DRAWING SHEET SE-3 - REVIS. ALL REFERENCES TO ENGINEERED SANITARY SEWER SLOPE OF .0073 TO READ .0056.

ITEM #3-M38:  
DRAWING SHEET SE-3 - REVISE CERTAIN ENGINEERED SANITARY SEWER FLOW LINE DESIGNATIONS AS HEREIN INDICATED:  
MANHOLE #A FLOW LINE ELEVATION IN AND OUT = 153.11  
MANHOLE #B FLOW LINE ELEVATION IN AND OUT = 151.43  
MANHOLE #C FLOW LINE ELEVATION IN AND OUT = 149.75  
MANHOLE #D FLOW LINE ELEVATION IN AND OUT = 148.07  
MANHOLE #E FLOW LINE ELEVATION IN = 146.39  
MANHOLE #E FLOW LINE ELEVATION OUT = 146.29

ITEM #3-M39:  
DRAWING SHEET SE-3 - DELETE FLOW LINE ELEVATION REFERENCE AT MANHOLE #G READING; "F.L. EL. 144.15".

ITEM #3-M40:  
DELETE ENTIRE PARAGRAPH ENTITLED "SEWER SERVICE", PAGE 15-49 OF SPECIFICATIONS AND INSERT THE FOLLOWING:  
"SANITARY SEWER SERVICE:

THE SANITARY SEWER SERVICE SHALL COMMENCE FIVE (5) FEET FROM THE BUILDING AND SHALL BE INSTALLED IN VITRIFIED CLAY-SEWER TILE WITH PLASTIC JOINTS. INSTALL PIPING ON FIRM SOLID EARTH WITH HOLES EXCAVATED FOR BELLS.

THE BUILDING SEWER SHALL PITCH AT A MINIMUM SLOPE OF 1/8" PER FOOT. THE ENGINEERED SANITARY SEWER SHALL COMMENCE AT MANHOLE #A AND TERMINATE WITH MANHOLE #G AS SHOWN ON SHEET SE-3 OF DRAWINGS. THE ENGINEERED SEWER SHALL PITCH AT SLOPES INDICATED ON SHEET SE-3 OF DRAWINGS.

THE FOLLOWING REQUIREMENTS PERTAIN SOLELY TO THE ENGINEERED SANITARY SEWER:

THE CONTRACTOR SHALL FURNISH A SURETY BOND TO THE CITY GUARANTEEING THE PERFORMANCE OF THE WORK AS PROVIDED IN THE PLANS AND SPECIFICATIONS. THE CONTRACTOR ALSO SHALL FURNISH A SURETY BOND TO THE STATE OF KANSAS GUARANTEEING THE PAYMENT OF ALL MATERIALS, LABOR, MACHINERY AND DAMAGE TO PROPERTY OR PERSONS. A CASHIERS CHECK, ESCROW ACCOUNT, OR IRREVOCABLE LETTER OF CREDIT MAY BE USED IN LIEU OF THE SURETY BOND GUARANTEEING PERFORMANCE OF THE WORK.

THE CONTRACTOR SHALL PROVIDE A GUARANTEE IN THE AMOUNT OF 15% OF THE COST OF THE WORK GUARANTEEING AND SECURING THE CORRECTION OF ANY DEFECT IN MATERIAL OR WORKMANSHIP, LATENT IN CHARACTER, AND NOT DISCERNIBLE AT THE TIME OF FINAL INSPECTION; AND GUARANTEE AGAINST ANY DAMAGE TO SUCH WORK BY REASON OF SETTLING OF THE GROUND, BASE, OR FOUNDATION THEREOF.

ADDENDUM NUMBER 3

JOB #01613.00

ITEM #3-M40 CONT'D:

THIS GUARANTEE SHALL BE HELD BY THE CITY FOR A PERIOD OF 18 MONTHS AFTER THE COMPLETION OF THE IMPROVEMENTS AND SHALL PROVIDE THAT THE DEPOSIT MAY BE APPLIED BY THE CITY FOR ANY AMOUNTS INCURRED IN CORRECTION OF DEFECTS. THIS GUARANTEE MAY BE A CASHIERS CHECK, ESCROW ACCOUNT, OR IRREVOCABLE LETTER OF CREDIT IN FAVOR OF THE CITY.

THIS WORK SHALL BE SUBJECT TO INSPECTION BY THE CITY AGENCY RESPONSIBLE FOR SETTING AND ENFORCING THE APPLICABLE DESIGN AND CONSTRUCTION STANDARDS OF THE REQUIRED IMPROVEMENT. THE COST ATTRIBUTABLE TO ALL INSPECTIONS REQUIRED BY THIS REGULATION SHALL BE CHARGED TO AND PAID BY THE CONTRACTOR. BEFORE ANY REQUIRED INSPECTIONS TAKE PLACE, THE CONTRACTOR MAY BE REQUIRED TO POST A DEPOSIT WITH THE CITY OR AGENCY ENTRUSTED TO KEEP SUCH SECURITY TO COVER THE COST OF SUCH INSPECTIONS. THE CONTRACTOR SHALL GIVE AT LEAST FORTY-EIGHT (48) HOURS WRITTEN NOTIFICATION TO THE CITY PRIOR TO THE PERFORMANCE OF ALL PHASES OF THIS WORK.

AFTER NOTICE IS RECEIVED, THE CITY MAY CONDUCT AN ON-SITE INSPECTION TO DETERMINE THAT THE WORK COMPLIES WITH THE APPROVED ENGINEERING PLANS AND SPECIFICATIONS. IF IN THE OPINION OF THE CITY, SUCH WORK DOES NOT COMPLY WITH SUCH FINAL DRAWINGS, THE CITY SHALL HAVE AUTHORITY TO ORDER THAT ALL SUCH WORK SHALL BE TERMINATED UNTIL SUCH TIME AS NECESSARY STEPS ARE TAKEN TO CORRECT ANY DEFECTS OR DEFICIENCIES. UPON THE CORRECTION OF SUCH DEFECTS OR DEFICIENCIES, THE CONTRACTOR SHALL AGAIN NOTIFY THE CITY AS PROVIDED ABOVE.

UPON COMPLETION OF ALL WORK REQUIRED, THE CONTRACTOR SHALL NOTIFY THE CITY, WHO SHALL THEREUPON CONDUCT A FINAL INSPECTION. THE FINAL INSPECTION SHALL INCLUDE A TELEVISED INSPECTION OF THE SEWER; THIS WILL BE PERFORMED BY THE CITY AT THE CONTRACTOR'S EXPENSE. IF SUCH FINAL INSPECTION INDICATES THAT THERE ARE ANY DEFECTS OR DEFICIENCIES IN THIS WORK, OR IF THERE ARE ANY DEVIATIONS FROM THE FINAL ENGINEERING PLANS AND SPECIFICATIONS, THE CITY SHALL NOTIFY THE CONTRACTOR IN WRITING OF SUCH DEFECTS, DEFICIENCIES OR DEVIATIONS AND THE CONTRACTOR SHALL, AT HIS SOLE COST AND EXPENSE, CORRECT SUCH DEFECTS OR DEVIATIONS WITHIN SIX (6) MONTHS OF THE DATE OF NOTIFICATION. WHEN SUCH DEFECTS, DEFICIENCIES OR DEVIATIONS HAVE BEEN CORRECTED, THE CONTRACTOR SHALL NOTIFY THE CITY THAT THE WORK IS AGAIN READY FOR FINAL INSPECTION. AFTER THE FINAL INSPECTION IS MADE AND BEFORE ACCEPTANCE OF THE IMPROVEMENT BY THE CITY, THE CONTRACTOR SHALL FILE AN AFFIDAVIT WITH THE CITY WHICH IS EXECUTED BY THE CONTRACTOR, CERTIFYING THAT ALL OBLIGATIONS INCURRED IN THE CONSTRUCTION OF THE IMPROVEMENT INVOLVED HAVE BEEN PROPERLY PAID AND SETTLED.

ITEM #3-M41:

DRAWING SHEET M3.1 - HEATING WATER CONVERTOR DETAIL. CHANGE HWS AND HWR PIPE SIZES TO FIVE (5) INCH. CHANGE AIR CONTROL TANK SIZE TO R-5. ADD PRESSURE RELIEF VALVE IN 1 1/2" PIPE TO EXPANSION TANKS, SET FOR 30 PSI, AND PIPE TO FLOOR DRAIN. SUPPORT FOR CONVERTOR BY THE GENERAL CONTRACTOR.

ITEM #3-M42:

DRAWING SHEET M3.1 - ENLARGED EQUIPMENT ROOM PLAN. CHANGE SINGLE FUEL OIL PUMP TO TWO PUMPS, ONE FOR STANDBY OPERATION, INSTALL CHECK VALVES

ADDENDUM NUMBER 3

JOB #01613.00

ITEM #3-M63:

DRAWING SHEET M3.10 - ROOF HOOD SCHEDULE AND FAN SCHEDULE. ADD THE FOLLOWING NOTE AT BOTTOM OF EACH SCHEDULE: "PROVIDE HINGED CURB BASE OR HOOD FOR EASY ACCESS TO CONTROLS DAMPERS WHERE CONTROL DAMPER BY T.C.C."

ITEM #3-M64:

DRAWING SHEET SE-3 - RE: APPROXIMATELY 30' FT. OF ENGINEERED SANITARY SEWER PIPING BETWEEN MANHOLES NO. 'F' AND 'G':  
A) DELETE SIZE DESIGNATION OF 10" AND INSERT 8"  
B) THIS SECTION OF PIPING SHALL BE ENCASED IN CONCRETE; CONCRETE SHALL EXTEND A MINIMUM OF 6" BEYOND PIPE IN ALL DIRECTIONS.

ITEM #3-M65:

SPECIFICATION PAGE 15-03 - DELETE LINES 01 THROUGH 35. ADD THE FOLLOWING BACK TO LINE 01 - "1" FRAME MOTORS NOT PERMITTED ON 1 H.P. OR LARGER. ALL MOTORS SHALL HAVE CAST IRON END BELLS.

ITEM #3-M66:

SPECIFICATION PAGE 15-15, LINE 43 - CHANGE LINE TO READ "ON PIPE SIZES 2" AND UNDER".

ITEM #3-M67:

SPECIFICATION PAGE 15-18, LINE 10 - ADD AT START OF LINE "SPECIALTIES FOR DOUBLE SUCTION PUMPS - MUESSCO #711 COMBINATION..."

ITEM #3-M68:

SPECIFICATION PAGE 15-18, LINE 27 - CHANGE "CLOSE GRAINED CAST IRON PUMP BOWL" TO "ALL BRONZE PUMP BOWL".

ITEM #3-M69:

SPECIFICATION PAGE 15-21 - ADD THE FOLLOWING SUB-PARAGRAPH AFTER LINE 42:

"POWER FACTOR CORRECTION CAPACITORS SHALL BE PROVIDED AS FOLLOWS:

(1) - MAIN CHILLER DRIVE MOTOR SHALL BE SUPPLIED WITH CONDENSERS AS REQUIRED TO CORRECT THE POWER - FACTOR OF THE INDIVIDUAL MOTOR TO 95% (LAGGING) ± 3%. THE MECHANICAL CONTRACTOR SHALL SECURE PERFORMANCE DATA ON EACH INDIVIDUAL MOTOR AND CONDENSER. PROVIDE OPERATING CURRENT VALUES ON THE CONDENSER, AND ON THE MOTOR, AND TOTAL LINE CURRENT FOR THE COMBINATION. PROVIDE VOLTAGE READING AT TIME OF DISCONNECTING MOTOR. IN NO EVENT SHALL THE CONDENSER CURRENT EXCEED THE "NO-LOAD" VALUE OF THE MOTOR CURRENT. HEATING ELEMENT RATINGS SHALL BE ADJUSTED AND AS NECESSARY, TO PROVIDE THERMAL PROTECTION TO THE MOTOR. IN THE EVENT THE VOLTAGE READING AT THE TIME OF DISCONNECTING THE UNIT EXCEEDS A SAFE VALUE, THE CONDENSER RATING SHALL BE CHANGED TO PROVIDE SAFE VOLTAGES, AS WELL AS PROVIDING A POWER FACTOR WITHIN THE SPECIFIED LIMIT. ALL CONDENSERS SHALL BE RATED FOR OPERATION ON 480 VOLT SYSTEM AND FURNISHED BY THE EQUIPMENT MANUFACTURER.

(2) - EACH CAPACITOR SHALL BE SUITABLE FOR ENERGIZING AT TEMPERATURES AS LOW AS -10 DEGREES F. AND FOR CONTINUOUS OPERATION IN AMBIENT TEMPERATURES NOT EXCEEDING 115 DEGREES F. WHEN INSTALLED AND UNRESTRICTED VENTILATION AND ENERGIZED UP TO 100 PERCENT OF RATED VOLTAGE. EACH CAPACITOR SHALL CONSIST OF A NUMBER OF FLATTENED ROLLS OF DEAD-SOFT ANNEALED ALUMINUM FOIL BETWEEN SHEETS OF LOW

ADDENDUM NUMBER 3

JOB #01613.00

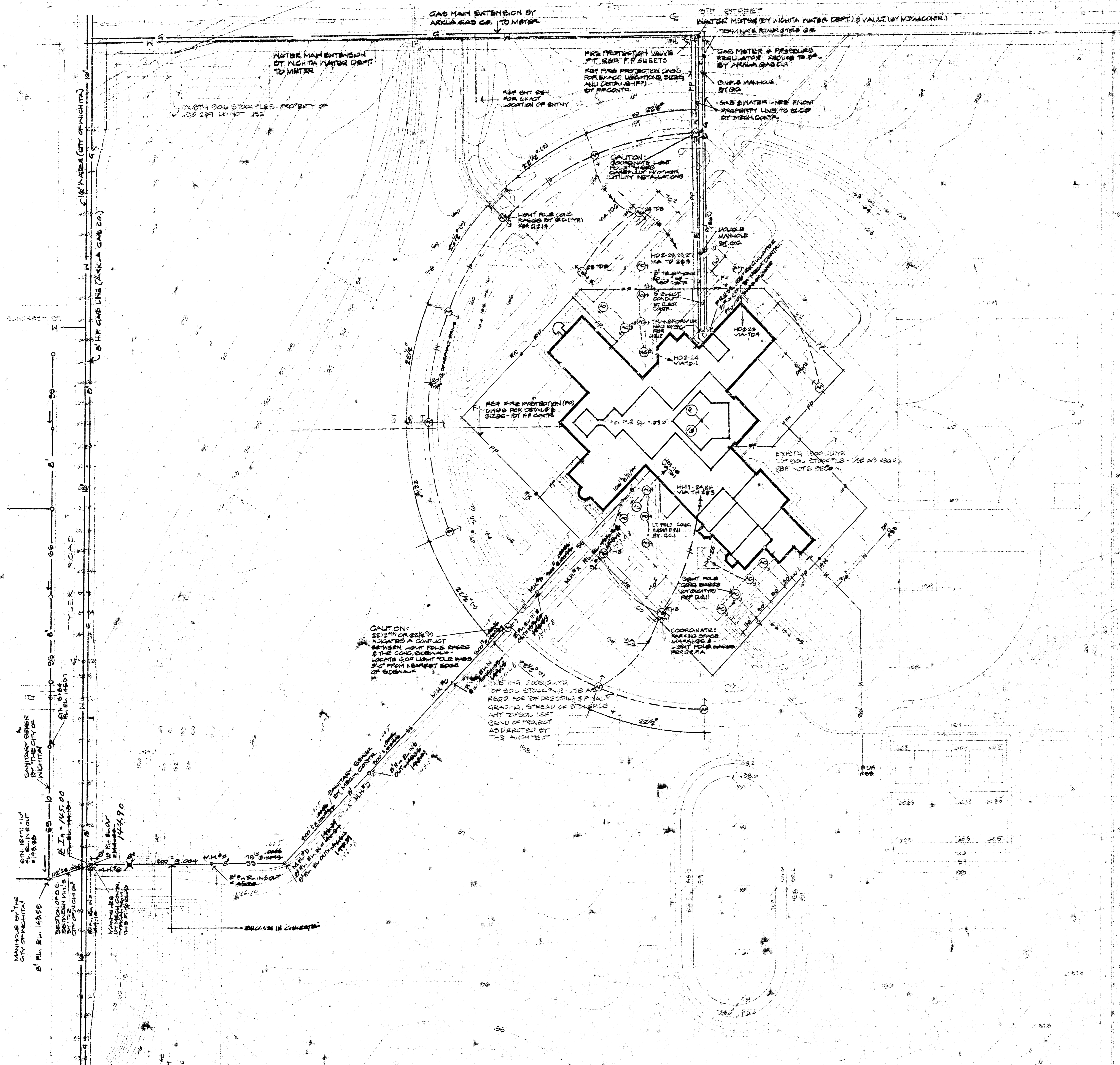

- SITE PLAN - SYMBOLS**
- PROPERTY LINE
  - SETBACK LINE / OR EASEMENT
  - EXISTING CONTOUR
  - NEW CONTOUR
  - WATER LINE
  - SANITARY OWNER
  - STORM WATER OWNER
  - OVERHEAD ELECTRIC POWER LINE
  - UNDERGROUND ELECTRIC POWER LINE
  - OVERHEAD TELEPHONE LINE
  - UNDERGROUND TELEPHONE LINE
  - FIRE PROTECTION SERVICE
  - GAS LINE
  - FIRE HYDRANT

- ⊙ B-2 BOLT TEST BORING
- ⊙ F FINDER POLE
- ⊙ T TELEPHONE POLE
- ⊙ BM BENCH MARK
- ⊙ L LIGHT POLE
- ⊙ H FIRE HYDRANT
- ⊙ V VALVE

**GENERAL NOTES:**  
 BENCH MARK - CITY OF WICHITA DEL & S CORNER OF 19th STREET AND TYLER ROAD - ELEV. 91.91'  
 FIRE PROTECTION - REFER SHEETS PP-1 THRU PP-6 FOR ADDITIONAL FIRE PROTECTION SYSTEM INFORMATION  
 CONCRETE LIGHT POLE BASES BY GC PER D-211 & D-214 - COORDINATE V ELECTRICAL

**APPROVED AS NOTED**  
 By CITY ENGINEER OF WICHITA  
 Sanitary Sewers: *[Signature]*  
 Storm Sewers: \_\_\_\_\_  
 Driveway Approval: \_\_\_\_\_

**NOTE TO CONTRACTOR**  
 This project will be constructed under the supervision of the CITY ENGINEER and conforming to the SPECIFICATIONS of the CITY OF WICHITA. The CONTRACTOR will reimburse the City of Wichita for all cost of Engineering, Plans, and Inspection.

*[Handwritten Signature]* 706049



Sanitary Sewer for Northwest High School

NORTHWEST HIGH SCHOOL